

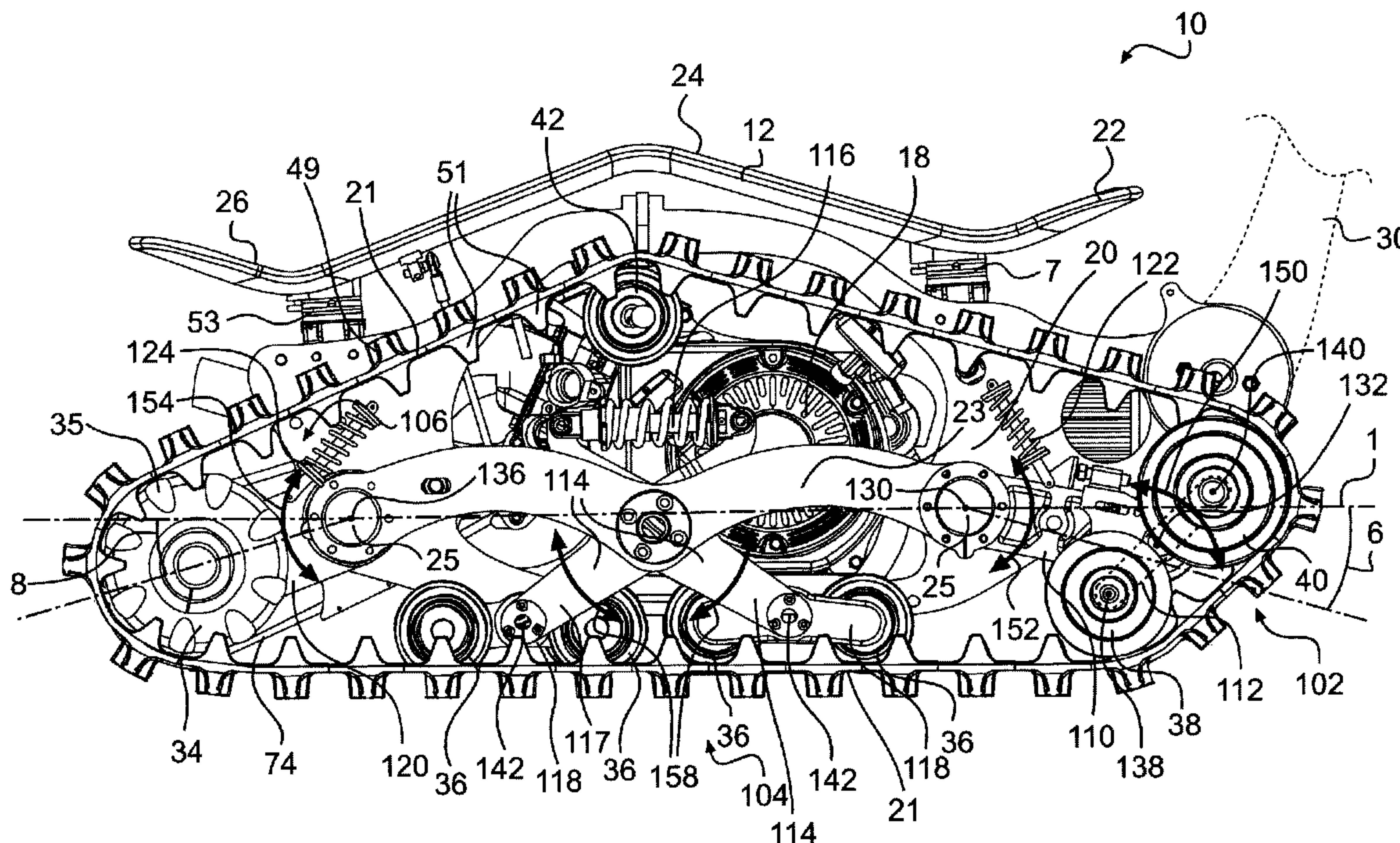

(22) Date de dépôt/Filing Date: 2011/04/13
(41) Mise à la disp. pub./Open to Public Insp.: 2012/10/13

(51) Cl.Int./Int.Cl. *B62D 55/104* (2006.01),
B62D 51/00 (2006.01)
(71) Demandeur/Applicant:
FAIRHEAD, RYAN J., CA
(72) Inventeur/Inventor:
FAIRHEAD, RYAN J., CA
(74) Agent: OSLER, HOSKIN & HARCOURT LLP

(54) Titre : DISPOSITIF DE SUSPENSION POUR VEHICULE CHENILLE PERSONNEL
(54) Title: SUSPENSION ASSEMBLY FOR PERSONAL TRACKED VEHICLE



(57) **Abrégé/Abstract:**

A suspension assembly for a personal tracked vehicle comprises a first swing arm pivotally connectable to a frame of the vehicle. The first swing arm has a first end and a second end. A second swing arm is pivotally connectable to the first swing arm. The second swing arm has a first end and a second end. At least one damper is connected to the first and second swing arms. At least one first idler wheel is rotatably connected to the first end of the first swing arm. At least one second idler wheel is rotatably connected to the first end of the second swing arm. The at least one first and second idler wheels are adapted to be in contact with a same track of the vehicle. Suspensions and personal tracked vehicles are also presented.



ABSTRACT

A suspension assembly for a personal tracked vehicle comprises a first swing arm
5 pivotally connectable to a frame of the vehicle. The first swing arm has a first end and a
second end. A second swing arm is pivotally connectable to the first swing arm. The
second swing arm has a first end and a second end. At least one damper is connected to
the first and second swing arms. At least one first idler wheel is rotatably connected to the
first end of the first swing arm. At least one second idler wheel is rotatably connected to
10 the first end of the second swing arm. The at least one first and second idler wheels are
adapted to be in contact with a same track of the vehicle. Suspensions and personal
tracked vehicles are also presented.

SUSPENSION ASSEMBLY FOR PERSONAL TRACKED VEHICLE

TECHNICAL FIELD

[0001] The present invention relates to suspension assemblies for personal tracked vehicles.

5 BACKGROUND

[0002] Personal tracked vehicles allow their users, and in some cases a passenger, to travel over rough (and in many cases unimproved) terrain. The best known example of a personal tracked vehicle is a snowmobile. Other types include all-terrain vehicles outfitted with (usually four) tracks instead of wheels and stand-up personal tracked
10 vehicles (such as the one shown in United States Patent No. 7,575,075).

[0003] Most convention personal tracked vehicles include a suspension system (or suspension systems) associated with their track or tracks. These suspension systems are designed to absorb at least some of the shocks produced by the vehicle traveling over the irregularities in the terrain. As the vehicle travels over the terrain, the irregularities
15 produce displacements and deflections in its suspension system.

[0004] Given the length of time that snowmobiles have been in existence, probably the most advanced suspensions systems in these types of vehicles are found on these vehicles. In a snowmobile, it is the rear suspension system that supports (in all mass-produced vehicles) a single endless track used to propel the vehicle. The endless
20 track is tensioned and encircles a pair of parallel slide rails, a plurality of idler wheels and at least one drive wheel or sprocket. A shock absorbing mechanism involving compression springs, hydraulic dampers, and/or other shock absorbing elements urges the slide rails and the chassis (also known as a frame) of the snowmobile apart, against the weight supported above the suspension, in a static condition. The snowmobile suspension
25 typically is a four bar linkage. These are only the generally characteristics of a modern snowmobile rear suspension. As those skilled in the art know, there are many detailed differences between the various conventional rear snowmobile suspension systems.

[0005] Owing to differences in their construction, other kinds of personal tracked vehicles do not use the same types of suspensions systems to support their tracks as do snowmobiles. Snowmobile rear suspensions are not directly applicable on these vehicles. The conversion kits used to convert standard 4-wheeled ATVs into 4-tracked
5 vehicles (with one track replacing each wheel), typically use the suspension system already on the ATV (used with the wheel) alone, but in some cases do add components to such systems. In any event, they are different than snowmobile track suspension systems.

[0006] Different from either are stand-up personal tracked vehicles. Stand-up personal tracked vehicles are the most recent additional to this class of vehicles. As was
10 discussed above, an example of such vehicle is disclosed in United States Patent No. 7,575,075, issued to Fairhead on Aug. 18, 2009, incorporated by reference herein in its entirety. In such a vehicle, there is no seat. There is merely a platform on which the rider stands when using the vehicle. A pair of tracks (one on each side of the vehicle, below the platform) propels the vehicle. The engine is disposed below the platform
15 laterally between the tracks. The user initiates vehicle turns by shifting their weight toward the right or the left, which causes one track to be driven faster than the other. Stand-up tracked vehicles are lighter, smaller and far more compact than snowmobiles and ATVs. For reasons including these, suspension systems similar to the ones used in snowmobiles or ATVs are not appropriate to such vehicles.

20 [0007] While the vehicle of the '075 U.S. Patent did have an adequate suspension system, as is typically the case with these types of vehicles (see snowmobiles for example), improvements in suspension systems are always possible.

SUMMARY

[0008] It is therefore an object of the present invention to provide a suspension
25 assembly for some types of personal tracked vehicles (particularly stand-up personal tracked vehicles), being an improvement, at least in some respects, over at least some of the prior art.

[0009] It is also an object of the present invention to provide a personal tracked vehicle (particularly stand-up personal tracked vehicles) incorporated such suspension assembly.

[0010] In one aspect, embodiments of the present invention provide a suspension
5 assembly for a personal tracked vehicle. The suspension assembly has: A first swing arm adapted to be pivotally connected to a frame of the vehicle, the first swing arm having a first end and a second end. A second swing arm is pivotally connected to the first swing arm, the second swing arm having a first end and a second end. At least one damper is connected to the first and second swing arms. At least one first idler wheel is rotatably
10 connected to the first end of the first swing arm, the at least one first idler wheel being adapted to be in contact with a corresponding one of the tracks of the vehicle. At least one second idler wheel is rotatably connected to the first end of the second swing arm, the at least one second idler wheel being adapted to be in contact with the one of the tracks of the vehicle.

[0011] It should be understood that in the present context, a swing arm may be
15 pivotally connected to another component (e.g. the frame, another swing arm, etc.) either directly or indirectly (i.e. through a third component such as a linking element). Both of these constructions are intended to be encompassed by language indicating that the swing arm is “connected” or “adapted to be connected” to another component of the vehicle.
20 As an example, in some embodiments, the first swing arm is adapted to be pivotally connected to at least one longitudinal arm, and the at least one longitudinal arm is fixedly connected to the frame of the vehicle. Further, in some embodiments, irrespective of whether the connection is direct or indirect, the second swing arm is pivotally connected to the first swing arm at a pivot point disposed about half-length of the first and second
25 swing arms.

[0012] It should also be understood that in the present context, the language “at least one damper connected to the first and second swing arms” does not require a single damper, multiple dampers are intended to be included. Further, when there are multiple dampers present, it is not required that any particular damper interconnect the first and

the second swing arms. No such interconnection is required. The first and the second arms need not be interconnected at all. It may simply be that there is a first damper connected to the first swing arm and a second damper connected to the second swing arm (the other end of such dampers may, for example, be directly or indirectly connected to a fixed point on the frame or may be connected to some other movable component of the vehicle suspension. Of course, in some embodiments, the at least one damper does interconnect the second ends of the first and second swing arms. In some embodiments, irrespective of to where the at least one damper is connected, the at least one damper is a shock absorber.

10 [0013] In should also be understood that in the present context, the language “At least one first idler wheel rotatably connected to the first end of the first swing arm” and other similar language is intended to cover both direct connections and indirect connections (such as where the idler wheel is rotatably connected to a component that is itself connected (whether fixed or movably) to the end of the swing arm. Thus, for example, in some embodiments, there is at least one connecting arm to which the idler wheels are rotatably connected, and the at least one connecting arm is pivotally connected to the first end of one of the swing arms. Further, in some embodiments at least one of the at least one first idler wheel and the at least one second idler wheel includes two idler wheels. In some such embodiments, both of the at least one first idler wheel and the at least one second idler wheel include two idler wheels.

[0014] Embodiments of the invention also provide a personal dual tracked vehicle (being either a straddle seat vehicle or a stand-up vehicle) including the suspension system of this aspect. In particular, a personal stand-up dual tracked vehicle has a frame. An engine is connected to the frame. A platform is connected to the frame for accommodating a user thereon. A pair of tracks is operatively connected to the engine. A pair of suspension assemblies movably supports each of the pair of tracks. Each of the pair of suspension assemblies includes: a first swing arm pivotally connected to the frame, the first swing arm having a first end and a second end; a second swing arm pivotally connected to the first swing arm, the second swing arm having a first end and a second end; at least one damper connected to the first and second swing arms; at least one

first idler wheel rotatably connected to the first end of the first swing arm, the at least one first idler wheel contacting one of the pair of tracks; and at least one second idler wheel rotatably connected to the first end of the second swing arm, the at least second one idler wheel contacting the one of the pair of tracks. In some such embodiments the suspension assemblies are middle suspensions assemblies (i.e. suspensions assemblies that are intermediate a front suspension assembly(ies) and a rear suspension assembly(ies) on either side of the vehicle.

[0015] In a second aspect, embodiments of the present invention provide a suspension assembly for a personal tracked vehicle. The suspension assembly has: A swing arm is adapted to be pivotally connected to a frame of the vehicle, the swing arm having an end. A drive wheel is adapted to be operatively connected to an engine of the vehicle, the drive wheel being rotatably connected to the end of the swing arm, the drive wheel being adapted to contact one of the tracks of the vehicle. At least one damper is connected to the swing arm, the at least one damper being adapted to be connected to the frame of the vehicle.

[0016] As was the case with the first aspect, it should be understood that in the present context, components that are physically connected to one another (as opposed to operatively connected to one another) may be either directly connected to each other or indirectly connected to each other via other components. Both of these constructions are intended to be encompassed by language indicating that one component is “connected” or “adapted to be connected” to another.

[0017] In some embodiments, the drive wheel is a right drive wheel adapted to contact a right track of the vehicle. And, the suspension assembly also has a left drive wheel adapted to contact a left track of the vehicle. The left drive wheel is rotatably connected to the end of the swing arm.

[0018] In some embodiments, the suspension assembly is a rear suspension assembly of the vehicle.

[0019] Embodiments of the invention also provide a personal stand-up dual tracked vehicle including the suspension system of this aspect. The vehicle has a frame. An engine is connected to the frame. A platform is connected to the frame for accommodating a user thereon. A pair of tracks operatively is connected to the engine. A
5 suspension assembly movably supports at least one of the pair of tracks. The suspension assembly includes: a swing arm pivotally connected to the frame, the swing arm having an end; and a drive wheel operatively connected to the engine, the drive wheel being rotatably connected to the end of the swing arm, the drive wheel contacting the one of the pair of tracks; and at least one damper connected to the swing arm and to the frame.

10 [0020] In some embodiments, the pair of tracks is a left track and a right track, the drive wheel is a right drive wheel, and the right drive wheel contacts the right track; and the vehicle further includes a left drive wheel contacting the left track of the vehicle, the left drive wheel being rotatably connected to the end of the swing arm, the left drive wheel being independently operatively connected to the engine from the right drive
15 wheel.

[0021] In some embodiments, the suspension assembly is a rear suspension assembly of the vehicle.

[0022] In a third aspect, embodiments of the present invention provide a suspension assembly for a personal tracked vehicle. The suspension assembly has a swing
20 arm adapted to be pivotally connected to a frame of the vehicle, the swing arm having an end. The suspension assembly also has at least one connecting arm pivotally connected to the end of the swing arm; a first idler wheel rotatably connected to one end of the at least one connecting arm, the first front idler wheel contacting one of the pair of tracks; a second idler wheel rotatably connected to another end of at least one connecting arm, the
25 second front idler wheel contacting the one of the pair of tracks; and at least one damper connected to the swing arm, the at least one damper being adapted to be connected to the frame.

[0023] As was the case with the first and second aspects, it should be understood that in the present context, components that are physically connected to one another (as

opposed to operatively connected to one another) may be either directly connected to each other or indirectly connected to each other via other components. Both of these constructions are intended to be encompassed by language indicating that one component is “connected” or “adapted to be connected” to another.

5 [0024] In some embodiments, when the vehicle is in operative condition on flat level ground without a user, a point of rotation of the first idler wheel is closer to the ground than a point of rotation of the second idler wheel. In some embodiments the first idler wheel and the second idler wheel are horizontally offset from one another to create an angle of attack for the one of the pair of tracks. In some embodiments the first idler
10 wheel has a diameter smaller than the second idler wheel.

[0025] Embodiments of the invention also provide a personal stand-up dual tracked vehicle including the suspension system of this aspect. The vehicle has a frame. An engine is connected to the frame. One of a straddle seat and a platform is connected to the frame for accommodating a user thereon. A pair of tracks is operatively connected
15 to the engine. A suspension assembly movably supports at least one of the pair of tracks. The suspension assembly includes a swing arm pivotally connected to the frame, the swing arm having an end; at least one connecting arm pivotally connected to the end of the swing arm; a first idler wheel rotatably connected to one end of the at least one connecting arm, the first idler wheel being in contact with the one of the pair of tracks; a
20 second idler wheel rotatably connected to another end of the at least one connecting arm, the second idler wheel being in contact with the one of the pair of tracks; and at least one damper connected to the swing arm, the at least one damper being connected to the frame.

[0026] In some embodiments the pair of tracks is a left track and a right track, the
25 suspension assembly is a left front suspension assembly, the swing arm is a left front swing arm, and the first and second idler wheels are first and second left idler wheels; and the vehicle further includes: a right front suspension assembly movably supporting the right track, the right front suspension assembly including: a right front swing arm pivotally connected to the frame; at least one connecting arm pivotally connected to the

end of the right front swing arm; a first right idler wheel rotatably connected to an end of the at least one connecting arm, the first right idler wheel contacting the right track; a first left idler wheel rotatably connected to another end of the at least one connecting arm, the first left idler wheel contacting the left track; and at least one damper connected to the
5 right swing arm and to the frame.

[0027] In should be understood that the above three aspects are not mutually exclusive, nor are they mutually required. Thus, some embodiments, for example, combine the first and second aspects above, others combine the first and third aspects above, others combined the second and third aspects above, still others combine the first,
10 second, and third aspects above, yet others have only one of the first, second, and third aspects above.

[0028] For purposes of this application, terms related to spatial orientation such as forwardly, rearwardly, upwardly, downwardly, left, and right, are as they would normally be understood by a rider of the vehicle standing thereon in a normal riding position.

15 [0029] For purposes of this application, a 'personal track vehicle' should be understood as a tracked vehicle accommodating one or two person for recreational use. Such personal tracked vehicles may include snowmobiles, tracked ATVs, or stand-up tracked vehicles. For example, snow groomers, tanks, earth movers or bulldozers are not personal tracked vehicles.

20 [0030] Embodiments of the present invention each have at least one of the above-mentioned objects and/or aspects, but do not necessarily have all of them. It should be understood that some aspects of the present invention that have resulted from attempting to attain the above-mentioned objects may not satisfy these objects and/or may satisfy other objects not specifically recited herein.

25 [0031] Additional and/or alternative features, aspects, and advantages of embodiments of the present invention will become apparent from the following description, the accompanying drawings, and the appended claims.

BRIEF DESCRIPTION OF THE DRAWINGS

[0032] For a better understanding of the present invention, as well as other aspects and further features thereof, reference is made to the following description which is to be used in conjunction with the accompanying drawings, where:

5 [0033] Figure 1 is a perspective view taken from a front, right side of a vehicle having an embodiment of a suspension and track tensioning assembly with a handlebar shown partially in dotted lines;

[0034] Figure 2 is a right side elevation view of the vehicle of FIG. 1 with tracks removed for clarity;

10 [0035] Figure 3 is a top plan view of a drive assembly of the vehicle of FIG. 1;

[0036] Figure 4A is a front elevation view of the vehicle of FIG. 1 with the platform of the vehicle in a first position;

[0037] Figure 4B is a front elevation view of the vehicle of FIG. 1 with the platform of the vehicle in a second position;

15 [0038] Figure 4C is a front elevation view of the vehicle of FIG. 1 with the platform of the vehicle in a third position;

[0039] Figure 5 is a right side elevation view of the vehicle of FIG. 1 with the handlebar shown partially in dotted lines; and

20 [0040] Figure 6 is a top plan view of the embodiment of the suspension and track tensioning assembly of the vehicle of FIG. 1 with tracks of the vehicle shown in dotted lines for clarity.

DETAILED DESCRIPTION

[0041] Although a personal stand-up dual tracked vehicle is being described herein, it is contemplated that other embodiments include other different kinds of

personal tracked vehicles, such as a platform single tracked vehicle or a straddle dual tracked vehicle.

[0042] Referring to FIGs. 1 and 2, a personal tracked vehicle 10 will be described. The vehicle 10 has right and left tracks 14 and 16 over which a platform 12 is
5 mounted. The platform 12 extends from near the front to near the rear of each of the tracks 14, 16, and is disposed slightly toward the rear of the tracks 14, 16. It is contemplated that the platform 12 could be disposed centrally between the front and rear of the tracks 14, 16, or in other positions with respect to the tracks 14, 16. A drive engine 18 is located between the tracks 14, 16 below the platform 12. The engine 18 is disposed
10 inside a housing 20 (best shown in FIG. 2). In this embodiment, the housing 20 is a frame of the vehicle 10. In other embodiments, the housing 20 could constitute part of the frame of the vehicle 10. In yet other embodiments, the housing 20 could be separate from the frame. The housing 20 is made of steel and has a plurality of apertures for reducing its weight. It is contemplated that the housing 20 could be made of a different material. For
15 example, the housing 20 could be made of aluminum. The platform 12 is pivotally connected to the top of the housing 20. As will be described below, pivoting the platform 12 results in steering the vehicle 10. It is contemplated that the platform 12 could be fixed to the housing 20 and that steering could be achieved by a control located on the vehicle 10. The platform 12 will be described in greater detail below.

20 [0043] The right track 14 and the left track 16 are mounted to the housing 20 such that the engine 18 is positioned between the tracks 14, 16 substantially in the center of the vehicle 10. A positioning of the engine 18 and other components between the tracks 14, 16 below the platform 12 allows the vehicle 10 to have a center of gravity disposed generally low for increased stability while riding the vehicle 10.

25 [0044] A handlebar 30 (shown in FIG. 2) with a throttle control 28 controls the engine 18. The handlebar 30 extends upwards so that the throttle control 28 is at a level of hands of the user when the user is in the standing position and the handlebar 30 is vertically upright. Alternatively, the vehicle 10 may also be provided with a cable

- 11 -

connected to the throttle control instead of the handlebar 30. It is contemplated that the engine 18 could be offset from the center of the vehicle 10.

[0045] The vehicle 10 also includes a suspension and track tensioning assembly 100, which will be described in greater detail below.

5 [0046] Still referring to Figs. 1 and 2, the tracks 14 and 16 each include an endless belt 21. A width of the endless belts 21 is larger than a width of platform 12 to provide a stable footing. It is contemplated that the platform 12 could be wider than the endless belts 21. The endless belts 21 are made of a fibre reinforced polymer material such as rubber. It is contemplated that the endless belts 21 could be made of a different
10 material. The endless belts 21 are provided with a plurality of transversal traction elements 49 on an outer surface 17 thereof, and two rows of aligning members 51 on an inner surface 19 thereof. It is contemplated that the traction elements 49 and the aligning members 51 could have shapes and layouts different from the ones shown in the Figures. The tracks 14, 16 contact each idler wheel 36, 38, 40 and 42. The right track 14 contacts a
15 right drive wheel 34, and the left track 16 contacts a left drive wheel 32. The idler wheels 36, 38, 40 and 42 are standard track wheels configured to cooperate with the aligning members 51 of the tracks 14, 16 so as to ensure that the tracks 14, 16 do not accidentally dislodge from the idler wheels 36, 38, 40 and 42. The drive wheels 32, 34 are operatively connected to track drives 58, 60 for driving the tracks 14, 16 in motion. The track drives
20 58, 60 will be described in greater detail below. As will be described below, the drive wheels 32, 34 and the idler wheels 36, 38, 40 are movable with respect to the housing 20 as they also are part of the suspension and track tensioning assembly 100. The idler wheels (left and right for the left and right tracks 16, 14 respectively) 42, however, are fixed with respect to the housing 20 by a bracket (not shown) mounted to the housing 20.
25 The idler wheels 42 enable the tracks 14, 16 to pass vertically above the engine 18. The idler wheels 42 contact a central portion of the inner surface 19 of the endless belt 21 defined between the two rows of alignment members 51. It is contemplated that the idler wheels 42 could contact other parts of the endless belts 21.

[0047] Still referring to Figs. 1 and 2, the platform 12 has a forward portion 22, a rearward portion 26 and a central portion 24. The platform 12 has a right side 33 and a left side 31(both shown in FIG. 4A). The forward portion 22 and the rearward portion 26 are upraised compared to the central portion 24. The forward portion 22 is positioned
5 with respect to the central portion 24 at an angle 2 of 120 degrees. It is contemplated that the angle 2 could have a different value, greater than 90 degrees. The rearward portion 26 is positioned with respect to the central portion 24 at an angle 4 of 120 degrees. It is contemplated that the angle 4 could have a different value, greater than 90 degrees. It is also contemplated that the angles 2 and 4 could have different values from each other.

10 [0048] The forward portion 22 and the rearward portion 26 act as front and rear foot rests, respectively. The forward portion 22 and the rearward portion 26 may be provided with a lining that prevents the feet from easily slipping out of their position on the forward portion 22 and the rearward portion 26. When riding the vehicle 10, the user places his/her feet on the forward and rearward portions 22, 26 such that the central
15 portion 24 is disposed between his/her legs. The user usually twists his/her torso with respect to his/her legs so as to be perpendicular to the longitudinal axis 15 and to look forward, similar to what one would do while riding a skateboard. The positioning of the feet on the forward and rearward portions 22 and 26 at angles on opposite sides of the platform 12 permits the user to control the tilting of the board while minimizing chances
20 that the user becomes unbalanced.

[0049] The central portion 24 is arched upwards to provide a clearance for the tracks 14, 16 and room for the engine 18. In the Figures, the central portion 24 is shown to have an apex. However, it is contemplated that the central portion 24 could have a curved shape, or be flat.

25 [0050] The platform 12 is mounted to the housing 20 by left and right front pivoting connectors 7 and left and right rear pivoting connectors 53. The platform 12 is selectively tiltable between a first position where the right side 33 of the platform 12 is below a left side 31 of the platform 12 (shown FIG. 4A) and a second position where the left side 31 of the platform 12 is lower than the right side 33 of the platform 12 (shown

FIG. 4C). The connectors 7 and 53 are spring biased such that the platform 12 is biased towards a horizontal position where both left and right sides 31, 33 of the platform 12 are horizontally aligned (shown FIG. 4B). Depending on a position of the platform 12 as determined by the weight the user is applying to the left or right sides 31, 33 of the platform 12, a transmission 52 steers the vehicle 10 by selectively driving one track 14, 16 faster than the other 16, 14. It is contemplated that the vehicle 10 could not be capable to drive one track 14, 16 faster than the other 16, 14. The transmission 52 will be described in greater detail below.

[0051] Turning now to FIG. 3, the transmission 52 and the track drives 58, 60 will be described.

[0052] The transmission 52 includes two variable continuous transmissions, namely the right track drive 58 and the left track drive 60. The use of continuously variable transmissions allows the user to smoothly steer the vehicle 10. It is contemplated that the transmission 52 could not have continuously variable transmissions.

[0053] The transmission 52 can selectively activate the drive track 58, 60 to drive the tracks 14, 16 at the same speed or with one track 14, 16 faster than the other 16, 14. The transmission 52 is selectively operable between a left drive bias mode, and a right drive bias mode. In the left drive bias mode, the left track 16 is driven faster than the right track 14. In the right drive bias mode, the right track 14 is driven faster than the left track 16. A differential 56 selectively operates the transmission 52 between its left and right drive bias modes by moving the differential 56 between a first and second position, respectively. The differential 56 is connected to the platform 12 by a tension cable 54. The cable 54 moves in response to the tilting of the platform 12, which in turn moves the differential 56 between the first and second position. When the differential 56 is moved between its first and second position, the transmission 52 is operated between its left bias and right bias modes respectively. Thus, when the platform 12 is tilted to the right, the transmission 52 is operated towards the left drive bias and when the platform 12 is tilted to the left, the transmission 52 is operated towards the right drive bias. By coupling the transmission 52 to the platform 12, the user operates and steers the vehicle 10 using a

plurality of intuitive movements, similar to when the user shifts his/her body weight to operate a skateboard or a snow board. By tilting the platform 12 toward the right or left sides 33, 31 by shifting the user's body weight, the vehicle 10 can execute sharper turns with less likelihood of the user falling off the vehicle 10. The cable 54 is spring biased to ensure that it is always under tension to ensure that the tilting motion of platform 12 is accurately translated into the shifting between the right and left drive biases. It is contemplated that the cable 54 could not be spring loaded.

[0054] The right track drive 58 operates the right track 14 via the right drive wheel 34. A chain 50 is operatively connected to the transmission 52 which is in turn is operatively connected to the engine 18. The right track drive 58 includes a pulley 62, a belt 64, a variable diameter pulley 66, a cog 72 and the drive chain 74. The pulley 62 is operatively connected to the engine 18. The drive chain 74 is operatively connected to the right drive wheel 34 for entraining the right track 14. The variable diameter pulley 66 is operatively connected to the cog 72. The variable diameter pulley 66 includes two sheaves (or cones) 68 and 70 disposed in a facing relationship. Bringing the sheaves 68 and 70 toward each other has the effect of increasing an effective diameter of the pulley 66 which in turn speeds up the right track 14 by speeding up the variable diameter pulley 66, the cog 72 and the drive chain 74. In an opposite fashion, moving the sheaves 68 and 70 away from each other has the effect of decreasing an effective diameter of the variable diameter pulley 66, which in turn slows down the right track 14 by slowing down the variable diameter pulley 66, the cog 72 and the drive chain 74.

[0055] The left track drive 60 operates the left track 16 via the left drive wheel 32. A chain 74 is operatively connected to the transmission 52. The left track drive 60 includes a pulley 76, a belt 78, a variable diameter pulley 80, a cog 82 and a drive chain 50. The drive chain 50 is operatively connected to the left drive wheel 32 for entraining the left track 16. The variable diameter pulley 80 includes two sheaves (or cones) 84 and 86 disposed facing each other. The variable diameter pulley 80 operates in a manner similar to the one of the variable diameter pulley 66, and will not be described herein again.

[0056] The variable diameter pulleys 80 and 66 are coaxially aligned and adjacent to one another, such that the sheaves 70 and 84 are adjacent to one another. The sheaves 70 and 84 are connected to the differential 56. The differential 56 consists of a gear like member 96 which has a groove dimensioned to engage both sheaves 70 and 84 simultaneously. The member 96 is rotatably mounted to a shaft 94 which is operatively connected to a cam 92. The shaft 94 is movable between a first position in the direction of arrow 88 and a second position in the direction of arrow 90. The cam 92 is operatively connected to the cable 54. Thus, moving the cable 54 causes the cam 92 to move, which in turn moves the member 96 in the directions 88 or 90. When the member 96 is moved in the direction 88, the diameter of variable diameter pulley 66 increases and the diameter of variable diameter pulley 80 decreases, which in turn causes the drive chain 74 to slow down and the drive chain 50 to speed up, corresponding to the left drive bias. When the member 96 is moved in direction 90, the diameter of the variable diameter pulley 66 decreases and the diameter of variable diameter pulley 80 increases, which in turn causes the drive chain 74 to speed up and the drive chain 50 to slow down, corresponding to the right drive bias. Hence, the transmission 52 and differential 56 can be selectively operated between the left and right drive bias simply by moving the cable 54.

[0057] Turning now to FIGs. 5 and 6, the suspension and track tensioning assembly 100 will be described.

[0058] The suspension and track tensioning assembly 100 comprises left and right front suspensions assemblies 102, left and right middle suspension assemblies 104, and a single rear suspension assembly 106. It is contemplated that the suspension and track tensioning assembly 100 could include only one front suspension assembly 102. It is also contemplated that the middle suspension assemblies 104 and/or the rear suspension assembly 106 could be omitted. It is contemplated that the suspension and track tensioning assembly 100 could include two rear suspension assemblies 106.

[0059] The left and right middle suspension assemblies 104 are disposed on external sides of the tracks 16, 14 so as to create a compartment 109 that houses the engine 18, the transmission 52 and other components laterally between them below the

idler wheels 42. The front suspension assemblies 102 are disposed forward of the compartment 109, and the rear suspension assembly 106 is disposed rearward of the compartment 109.

[0060] A front transversal tube 25 and a rear transversal tube 27 extend
5 transversally through the vehicle 10. The front suspension assemblies 102 are pivotally connected to the front transversal tube 25, and the rear suspension assembly 106 is pivotally connected to the rear transversal tube 27. It is contemplated that the front suspension assemblies 102 and/or the rear suspension assembly 106 could be directly connected to the housing 20. A bushing bearing (not shown) is disposed between the
10 front and rear suspension assemblies 102, 106 and the transversal tubes 25, 27. The transversal tubes 25, 27 are made of steel. It is contemplated that the transversal tubes 25, 27 could be made of aluminum, composite material, or even plastic. It is contemplated that the bearing could be replaced by another type of bearing, such as a ball bearing.

[0061] A right longitudinal arm 23 extends fixedly between right ends of the front
15 and rear transversal tubes 25, 27 to support the right middle suspension assembly 104. A left longitudinal arm 23 extends fixedly between left ends of the front and rear transversal tubes 25, 27 to support the left middle suspension assembly 104. The left longitudinal arms 23 being a mirror image of the right longitudinal arms 23, only reference to the right longitudinal arm 23 will be made. The right longitudinal arm 23 supports the right middle
20 suspension 104 about half length thereof. The right longitudinal arm 23 is bolted to the front and rear transversal tubes 25, 27. The right longitudinal arm 23 is made of aluminum. It is contemplated that the right longitudinal arm 23 could be made of steel or a composite material. It is contemplated that the right longitudinal arm 23 could be press-fit to the front and rear transversal tubes 25, 27. It is contemplated that the right
25 longitudinal arm 23 could be made of two arms fixedly connected to each other at a location of the middle suspension assemblies 104. It is also contemplated that the right longitudinal arm 23 could be omitted and the right middle suspensions 104 could be connected to the housing 20 directly. It is contemplated that the vehicle 10 could have a pair of adjacent right longitudinal arms 23 sandwiching the right middle suspension
30 assembly 104. The two right longitudinal arms 23 could then be bolted to each other

along their length, and an aperture located about mid-length of the right longitudinal arms 23 could accommodate the right middle suspension assembly 104.

[0062] Still referring to FIGs. 5 and 6, the front suspension assemblies 102 will be now described in detail. The left front suspension assembly 102 being a mirror image of the right front suspension assembly 102, only the right front suspension assembly 102 will be described herein.

[0063] The right front suspension assembly 102 includes a front swing arm 110, front arm 112 (shown in FIG. 6), front transversal arms 111, 113 (shown in FIG. 6) and the front idler wheels 38, and 40. The front swing arm 110, the front arm 112, and the front transversal arms 111, 113 are all made of aluminum. The front idler wheels 38, 40 are made of plastic. It is contemplated that the front swing arm 110, the front arms 111, 112, 113 and the front idler wheels 38, 40 could be made of different materials. For example, some or all of the swing arms 110, 11, 113 could be made of plastic, carbon fibre, or fibreglass, and the idler wheels 38, 40 could be made of metal or of a metal covered with rubber.

[0064] The front swing arm 110 has one end pivotally connected to the front transversal tube 25 at pivot point 130, and the other end pivotally connected to the front arm 112 about pivot point 132. The front swing arm 110 is free to rotate about the pivot point 130, but it is contemplated that the front swing arm 110 could have one or more stoppers so as to restrict its motion past predetermined angular limits.

[0065] An upper end of the front arm 112 is fixedly connected to the front transversal arm 113. The front transversal arm 113 is press-fit to the front arm 112. It is contemplated that the front transversal arm 113 could be bolted to or integrally formed with the front arm 112. The front transversal arm 113 receives two front idler wheels 40 at each end thereof, so that the front idler wheels 40 runs onto side portions of the inner surface 19 of the endless belt 21. As best seen in FIG. 6, the front idler wheels 40 are in contact with outer sides of the alignment members 51. It is contemplated that the front idler wheels 40 could run on a different portion of the endless belt 21. It is contemplated that a connection between the front swing arm 110 and the front arm 112 could be fixed.

[0066] A lower end of the front arm 112 is fixedly connected to a front transversal arm 111 which receives two front idler wheels 38 at each end thereof. The front transversal arm 111 is similar to the front transversal arm 113 and will not be described herein in detail. Similar to the front idler wheels 40, the front idler wheels 38
5 are positioned on the inner surface 19 of the endless belt 21 to contact with outer sides of the alignment members 51. It is contemplated that the front idler wheels 38, 40 could run on a different portion of the endless belt 21.

[0067] The front idler wheels 38, 40 are rotatable with respect to the front arm 112 about respective pivot points 138, 140. The front idler wheel 38 is vertically below
10 the front idler wheel 40, so that the pivot point 138 is vertically below the pivot point 140. The front idler wheel 40 has a diameter greater than the idler wheel 38. The arrangement with the two front idler wheels 38, 40 and a difference of diameters between the front idler wheels 38, 40 allows the right front suspension assembly 102 to accommodate various slopes of the ground on which the vehicle 10 operates by providing
15 the right track 14 with an angle of attack. It is contemplated that the front suspension assemblies 102 could have only one or more than two idler wheels. It is also contemplated that the front idler wheels 38, 40 could have the same diameter.

[0068] A front shock absorber 122 (shown in FIGs. 2 and 5) has one end pivotally connected to the front swing arm 110 and another end pivotally connected to the housing
20 20. The front shock absorber 122 transmits the weight of the user to the right front suspension assembly 102, especially when the user leans forward on the forward portion 22 of the platform 12. It is contemplated the front suspension assemblies 102 could have more than one front shock absorber 122. It is also contemplated that the front shock absorber 122 could be disposed somewhere else on the vehicle 10. For example, the front
25 shock absorber 122 could be disposed between the platform 12 and the housing 20, or between the platform 12 and the right longitudinal arm 23. It is contemplated that the shock absorber 122 could not be directly connected to the housing 20 and/or the front swing arm 110.

[0069] When the vehicle 10 is at rest on a flat ground, the front swing arm 110 is disposed at an angle 6 with respect to a horizontal 1. The angle 6 is disposed below the horizontal 1 so as to maintain tension in the right track 14. When the front swing arm 110 is positioned above the horizontal 1, the right track 14 is less tensioned than when
5 disposed below the horizontal 1. This situation may occur when the vehicle 10 is driven on a sudden sharp irregularity. As the ground presents irregularities, the front idler wheels 38, 40 rotate in directions 150 (upwards for a raised irregularity and downward for a lowered irregularity), and the front swing arm 110 in directions 152 (upwards for a raised irregularity and downward for a lowered irregularity) to accommodate these
10 irregularities. When the vehicle 10 encounters a small irregularity, the front arm 112 only pivots about the front swing arm 110 in the directions 150 and the front swing arm 110 stays unmoved. However, when the vehicle 10 encounters a bigger irregularity, the front swing arm 110 pivots about the front longitudinal arm 23 in the directions 152.

[0070] Still referring to FIGs. 5 and 6, the rear suspension assembly 106 will be
15 described in detail.

[0071] The rear suspension assembly 106 includes a pair of rear swing arms 120 (left and right), a rear transversal arm 121 and the left and right drive wheels 32, 34. The rear swing arms 120 and the rear transversal arm 121 are made of aluminum. The drive wheels 32, 34 are made of plastic. It is contemplated that the rear swing arm 120, the rear
20 transversal arm 121, and the drive wheels 32, 34 could be made of different materials. For example, the swing arms 120 and/or the rear transversal arm 121 could be made of plastic or a composite material, the drive wheels 32, 34 could be made of metal or metal covered with rubber. It is contemplated that the rear suspension assembly 106 could have more than one drive wheel. It is also contemplated that the pair of rear swing arms 120
25 could include only one arm. A left side of the rear suspension 106 being a mirror image of a right side of the rear suspension 106, only the right side will be described herein.

[0072] The rear swing arm 120 has one end pivotally connected to the rear transversal tube 27 at pivot point 136, and the other end fixedly connected to the rear transversal arm 121. The rear swing arm 120 is free to rotate about the pivot point 136,

but it is contemplated that the rear swing arm 120 could have one or more stoppers so as to restrict its motion past a predetermined angular limit. The pivot point 136 of the rear swing arm 120 is horizontally aligned with the pivot point 130 of the front swing arm 110 along the horizontal 1. It is contemplated, however, that the pivot point 136 could be
5 higher or lower than the pivot point 130. The pivot point 136 of the rear swing arm 120 is longitudinally offset from the pivot point 130 of the front swing arm 110. It is contemplated, that the pivot point 136 could be longitudinally aligned with the pivot point 130.

[0073] The rear transversal arm 121 is rotatably connected to the right drive
10 wheel 34 of the right track 14, so that the right drive wheel 34 can rotate on its axis when driven by the belt 74. The rear transversal arm 121 is press-fit to the rear swing arm 120. It is contemplated that the rear transversal arm 121 could be bolted to or integrally formed with the rear swing arm 120. The rear transversal arm 121 positions the right drive wheel 34 so that the right drive wheel 34 runs on the central portion of the inner
15 surfaces 19 of the endless belts 21 defined between the two rows of alignment members 51. The right drive wheel 34 has notches 35 on each side thereof that mate with inner sides of the alignment members 51. It is contemplated that the right drive wheel 34 could run on a different portion of the endless belt 21.

[0074] Left and right rear shock absorbers 124 (only the right one being shown in
20 FIGs. 2 and 5) has one end pivotally connected to the rear swing arm 120 and another end pivotally connected to the housing 20. The rear shock absorbers 124 transmit the weight of the user to the rear suspension assembly 106, especially when the user leans on the rearward portion 26 of the platform 12. It is contemplated that the rear suspension assembly 106 could only have one or more than two rear shock absorbers 124. It is
25 contemplated that the rear shock absorber 124 could be placed somewhere else on the vehicle 10. It is contemplated that the rear shock absorber 124 could not be directly connected to the housing 20 and/or to the rear swing arm 120.

[0075] When the vehicle 10 is at rest on a flat ground, the rear swing arm 120 is disposed at an angle 6 with respect to the horizontal 1. The angle 8 is disposed below the

horizontal 1 so as to maintain a tension in the right track 14. When the rear swing arm 120 is positioned above the horizontal 1, the right track 14 is less tensioned than when disposed below the horizontal 1. This situation may occur when the vehicle 10 is driven on a sudden sharp irregularity. As the ground presents irregularities, the rear swing arm
5 120 rotates in directions 154 (upwards for a raised irregularity and downward for a lowered irregularity) to accommodate these irregularities.

[0076] Still referring to FIGs. 5 and 6, the middle suspension assemblies 104 will be described in detail. The left middle suspension assembly 104 being a mirror image of the right middle suspension assembly 104, only the right middle suspension assembly 104
10 will be described herein.

[0077] The right middle suspension assembly 104 includes a pair of swing arms 114 and the idler wheels 36. The swing arms 114 are made of aluminum, and the idler wheels 36 are made of plastic. It is contemplated that the swing arms 114 and the idler wheels 36 could be made of different materials.

15 [0078] The swing arms 114 of the pair of swing arms 114 are pivotally connected to each other at pivot point 134. It is contemplated that the swing arms 114 could be indirectly connected to each other via, for example, a static link. The pivot point 134 is disposed about half length of each swing arm 114, so that the swing arms 114 form an X. It is contemplated that the pivot point 134 could be disposed toward a top or a bottom of
20 each of the swing arms 114. A shock absorber 116 extends between upper ends 115 of the swing arms 114. Lower ends 117 of the swing arms 114 are pivotally connected to the idler wheels 36. Each lower end 117 is pivotally connected to a L-shaped arm 118 at pivot points 142. Ends of the L-shaped arms 118 have an idler wheel 36 rotatably connected thereto, such that the right middle suspension 104 includes a total of four idler
25 wheels 36. The idler wheels 36 run on the inner surface 19 of the endless belt 21 between the two rows of alignment members 51. It is contemplated that the idler wheels 36 could run on a different portion of the endless belt 21. It is contemplated that the right middle suspension 104 could include less or more than four idler wheels 36. It is contemplated that the right middle suspension 104 could include only one swing arm 114, and that the

shock absorber 116 could be connected to the swing arm 114 and the housing 20. It is contemplated that the L-shaped arm 118 could include two arms, each arm being connected to an idler wheel 36. It is contemplated that the middle suspension assembly 104 could have more than one shock absorber 116. It is also contemplated that the shock absorbers 116 could be connected somewhere on the swing arms 114.

[0079] As the ground presents an irregularity, the idler wheels 36 rotate in directions 156 (upwards for a raised irregularity and downward for a lowered irregularity), and the swing arms 114 in directions 158 (upwards for a raised irregularity and downward for a lowered irregularity) to accommodate these irregularities. The shock absorber 116 is so dimensioned that for a small irregularity of the ground, it acts as a solid link and the arms 118 would only pivot about the swing arms 114 in the directions 156, but is also dimensioned to compress and expand when the vehicle 10 encounters a bigger irregularity, so that the swing arms 114 pivot in the directions 158.

[0080] Modifications and improvements to the above-described embodiments of the present invention may become apparent to those skilled in the art. The foregoing description is intended to be exemplary rather than limiting. The scope of the present invention is therefore intended to be limited solely by the scope of the appended claims.

What is claimed is:

1. A suspension assembly for a personal tracked vehicle, the suspension assembly comprising:
 - 5 a first swing arm adapted to be pivotally connected to a frame of the vehicle, the first swing arm having a first end and a second end;
a second swing arm pivotally connected to the first swing arm, the second swing arm having a first end and a second end;
at least one damper connected to the first and second swing arms;
 - 10 at least one first idler wheel rotatably connected to the first end of the first swing arm, the at least one first idler wheel being adapted to be in contact with a corresponding one of the tracks of the vehicle; and
at least one second idler wheel rotatably connected to the first end of the second swing arm, the at least one second idler wheel being adapted to be in contact with the one
 - 15 of the tracks of the vehicle.
2. The suspension assembly of claim 1, wherein the second swing arm is pivotally connected to the first swing arm at a pivot point disposed about half-length of the first and second swing arms.
20
3. The suspension assembly of claim 1, wherein the at least one damper interconnects the second ends of the first and second swing arms.
4. The suspension assembly of claim 1, wherein the at least one damper is a shock
25 absorber.
5. The suspension assembly of claim 1, wherein at least one of the at least one first idler wheel and the at least one second idler wheel includes two idler wheels; and
further comprising at least one connecting arm to which each of the two idler
30 wheels are rotatably connected, the at least one connecting arm being pivotally connected to the first end of a corresponding one of the first and second swing arms.

6. The suspension assembly of claim 1, wherein the first swing arm is adapted to be pivotally connected to at least one longitudinal arm, the at least one longitudinal arm being connected to the frame of the vehicle.

5

7. A personal stand-up dual tracked vehicle comprising:

a frame;

an engine connected to the frame;

a platform connected to the frame for accommodating a user thereon;

10

a pair of tracks operatively connected to the engine; and

a pair of suspension assemblies movably supporting each of the pair of tracks, each of the pair of suspension assemblies including:

a first swing arm pivotally connected to the frame, the first swing arm having a first end and a second end;

15

a second swing arm pivotally connected to the first swing arm, the second swing arm having a first end and a second end;

at least one damper connected to the first and second swing arms;

at least one first idler wheel rotatably connected to the first end of the first swing arm, the at least one first idler wheel contacting one of the pair of tracks; and

20

at least one second idler wheel rotatably connected to the first end of the second swing arm, the at least one second idler wheel contacting the one of the pair of tracks.

8. The vehicle of claim 7, wherein the second swing arm of each of the pair of suspension assemblies is pivotally connected to the first swing arm of that one of the pair of suspension assemblies at a pivot point disposed about half-length of the first and second swing arms.

9. The vehicle of claim 7, wherein the at least one damper of each of the pair of suspension assemblies interconnects the second ends of the first and second swing arms of that one of the pair of suspension assemblies.

30

10. The vehicle of claim 7, wherein the at least one damper of each of the pair of suspension assemblies is a shock absorber.

5 11. The vehicle of claim 7, wherein, for each of the pair of suspension assemblies, at least one of the at least one first idler wheel and the at least one second idler wheel includes two idler wheels; and

each of the suspension assemblies further including at least one connecting arm to which each of the two idler wheels of that suspension assembly are rotatably connected, 10 the at least one connecting arm being pivotally connected to the first end of a corresponding one of the first and second swing arms of that suspension assembly.

12. The vehicle of claim 1, further comprising a pair of longitudinal arms connected to the frame; and

15 wherein the first swing arm of each of the pair of suspension assemblies is pivotally connected to one of the pair of longitudinal arms.

13. A suspension assembly for a personal tracked vehicle, the suspension assembly comprising:

20 a swing arm adapted to be pivotally connected to a frame of the vehicle, the swing arm having an end;

a drive wheel adapted to be operatively connected to an engine of the vehicle, the drive wheel being rotatably connected to the end of the swing arm, the drive wheel being adapted to contact one of the tracks of the vehicle; and

25 at least one damper connected to the swing arm, the at least one damper being adapted to be connected to the frame.

14. The suspension assembly of claim 13, wherein the drive wheel is a right drive wheel adapted to contact a right track of the vehicle; and

30 further comprising a left drive wheel adapted to contact a left track of the vehicle, the left drive wheel being rotatably connected to the end of the swing arm.

15. The suspension assembly of claim 13, wherein the suspension assembly is a rear suspension assembly of the vehicle.
- 5 16. A personal stand-up dual tracked vehicle comprising:
a frame;
an engine connected to the frame;
a platform connected to the frame for accommodating a user thereon;
a pair of tracks operatively connected to the engine; and
10 a suspension assembly movably supporting at least one of the pair of tracks, the suspension assembly including:
a swing arm pivotally connected to the frame, the swing arm having an end; and
a drive wheel operatively connected to the engine, the drive wheel being
15 rotatably connected to the end of the swing arm, the drive wheel contacting the one of the pair of tracks; and
at least one damper connected to the swing arm and to the frame.
17. The vehicle of claim 16, wherein
20 the pair of tracks is a left track and a right track;
the drive wheel is a right drive wheel;
the right drive wheel contacts the right track; and
further comprising a left drive wheel contacting the left track of the vehicle, the
left drive wheel being rotatably connected to the end of the swing arm, the left drive
25 wheel being independently operatively connected to the engine from the right drive wheel.
18. The vehicle of claim 16, wherein the suspension assembly is a rear suspension assembly of the vehicle.

- 27 -

19. The vehicle of claim 16, wherein the suspension assembly is a rear suspension assembly; and

further comprising:

5 a pair of front suspension assemblies, each one of the pair of front suspension assemblies including:

a front swing arm pivotally connected to the frame, the front swing arm having an end;

at least one connecting arm pivotally connected to the end of the front swing arm;

10 a first front idler wheel rotatably connected to one end of the at least one connecting arm, the first front idler wheel contacting one of the pair of tracks;

a second front idler wheel rotatably connected to another end of the at least one connecting arm, the second front idler wheel contacting the one of the pair of tracks; and

15 at least one damper connected to the front swing arm and to the frame.

20. A suspension assembly for a personal tracked vehicle, the suspension assembly comprising:

20 a swing arm adapted to be pivotally connected to a frame of the vehicle, the swing arm having an end;

at least one connecting arm pivotally connected to the end of the swing arm;

a first idler wheel rotatably connected to one end of the at least one connecting arm, the first front idler wheel contacting one of the pair of tracks;

25 a second idler wheel rotatably connected to another end of at least one connecting arm, the second front idler wheel contacting the one of the pair of tracks; and

at least one damper connected to the swing arm, the at least one damper being adapted to be connected to the frame.

21. The suspension assembly of claim 20, wherein, when the vehicle is in operative condition on flat level ground without a user, a point of rotation of the first idler wheel is closer to the ground than a point of rotation of the second idler wheel.

30

22. The suspension assembly of claim 20, wherein the first idler wheel and the second idler wheel are horizontally offset from one another to create an angle of attack for the one of the pair of tracks.

5

23. The suspension assembly of claim 20, wherein the first idler wheel has a diameter smaller than the second idler wheel.

24. A personal stand-up dual tracked vehicle comprising:

10

a frame;

an engine connected to the frame;

a platform connected to the frame for accommodating a user thereon;

a pair of tracks operatively connected to the engine; and

a suspension assembly movably supporting at least one of the pair of tracks, the

15

suspension assembly including:

a swing arm pivotally connected to the frame, the swing arm having an end;

at least one connecting arm pivotally connected to the end of the swing arm;

20

a first idler wheel rotatably connected to one end of the at least one connecting arm, the first idler wheel being in contact with the one of the pair of tracks;

a second idler wheel rotatably connected to another end of the at least one connecting arm, the second idler wheel being in contact with the one of the pair of tracks; and

25

at least one damper connected to the swing arm, the at least one damper being connected to the frame.

25. The vehicle of claim 24, wherein

the pair of tracks is a left track and a right track;

30

the suspension assembly is a left front suspension assembly;

the swing arm is a left front swing arm;

the first and second idler wheels are first and second left idler wheels; and further comprising:

a right front suspension assembly movably supporting the right track, the right front suspension assembly including:

5 a right front swing arm pivotally connected to the frame; at least one connecting arm pivotally connected to the end of the right front swing arm;

a first right idler wheel rotatably connected to an end of the at least one connecting arm, the first right idler wheel contacting the right track;

10 a first left idler wheel rotatably connected to another end of the at least one connecting arm, the first left idler wheel contacting the left track; and

at least one damper connected to the right swing arm and to the frame.

26. The vehicle of claim 25, further comprising left and right middle suspension assemblies, each of the left and right middle suspension assemblies including:

15 a first swing arm pivotally connected to a frame of the vehicle, the first swing arm having a first end and a second end;

a second swing arm pivotally connected to the first swing arm, the second swing arm having a first end and a second end;

at least one damper connected to the first and second swing arms;

20 at least one first idler wheel rotatably connected to the first end of the first swing arm, the at least one first idler wheel contacting a corresponding one of the left and right track; and

25 at least one second idler wheel rotatably connected to the first end of the second swing arm, the at least one second idler wheel contacting the corresponding one of the left and right track.

27. The vehicle of claim 26, further comprising a rear suspension assembly including:

a rear swing arm pivotally connected to the frame, the rear swing arm having an end;

- 30 -

left and right drive wheels operatively connected to the engine, the left and right drive wheels being rotatably connected to the end of the rear swing arm, the left drive wheel contacting the left track, the right drive wheel contacting the right track; and at least one damper connected to the rear swing arm and to the frame.

5

28. The vehicle of claim 27, wherein the left drive wheel and the right drive wheel are each independently operatively connected to the engine from the other.

29. The vehicle of claim 28, wherein the engine is disposed laterally between the left and right middle suspension assemblies, and longitudinally between the left and right front suspension assemblies and the rear suspension assembly.

30. The vehicle of claim 29, further comprising:
a left longitudinal arm connected to the frame, the left longitudinal arm having a front end and a rear end;

a right longitudinal arm connected to the frame, the right longitudinal arm having a front end and a rear end; and
wherein:

the left middle suspension assembly is pivotally connected to the left longitudinal arm;

the right middle suspension assembly is pivotally connected to the right longitudinal arm;

the left front suspension assembly is pivotally connected to the front end of the left longitudinal arm;

the right front suspension assembly is pivotally connected to the front end of the right longitudinal arm; and

the rear suspension assembly is pivotally connected to the rear ends of the left and right longitudinal arms.

31. The vehicle of claim 30, wherein each of the left longitudinal arm and the right longitudinal arm includes at least one portion arched upwardly.

30

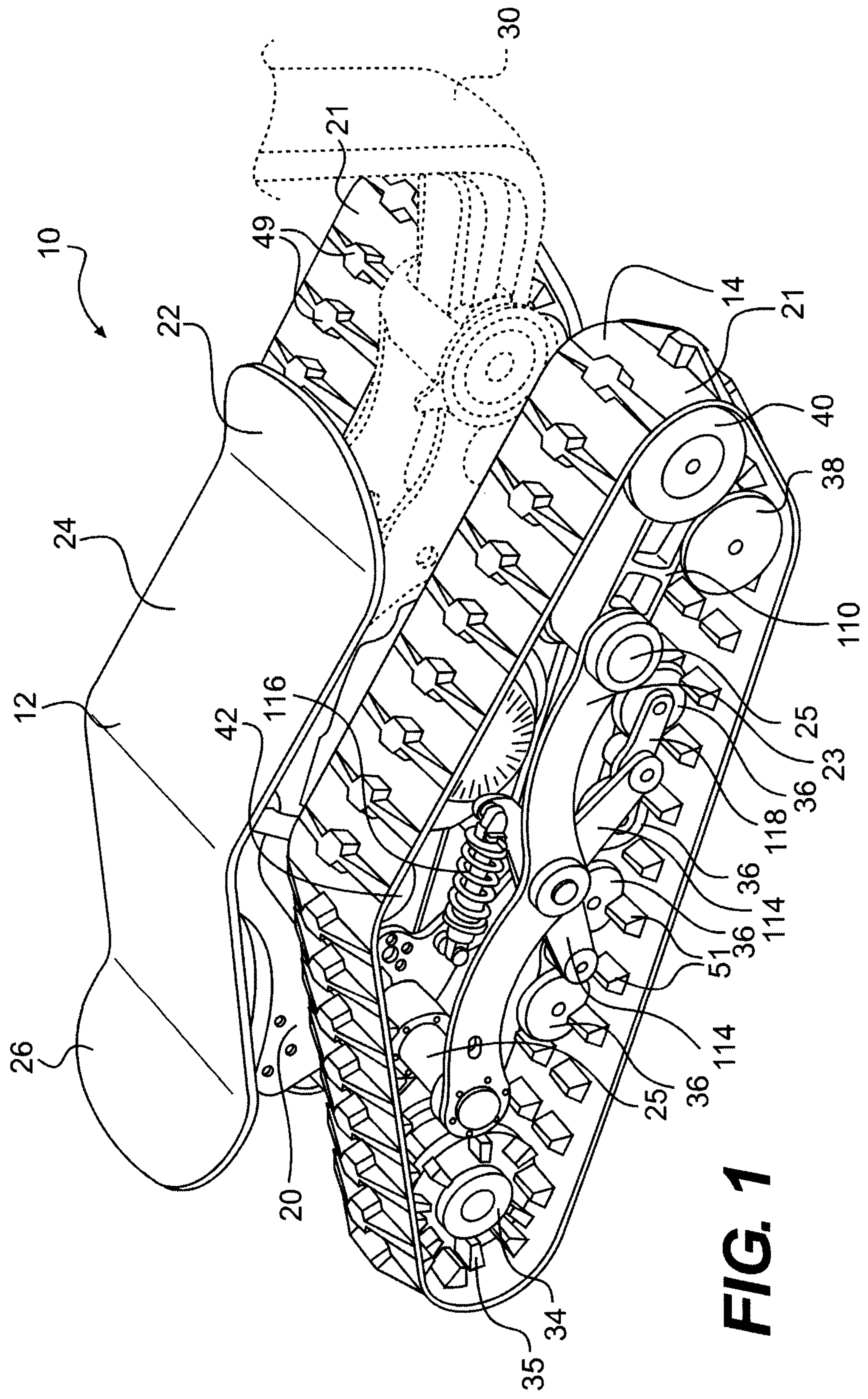
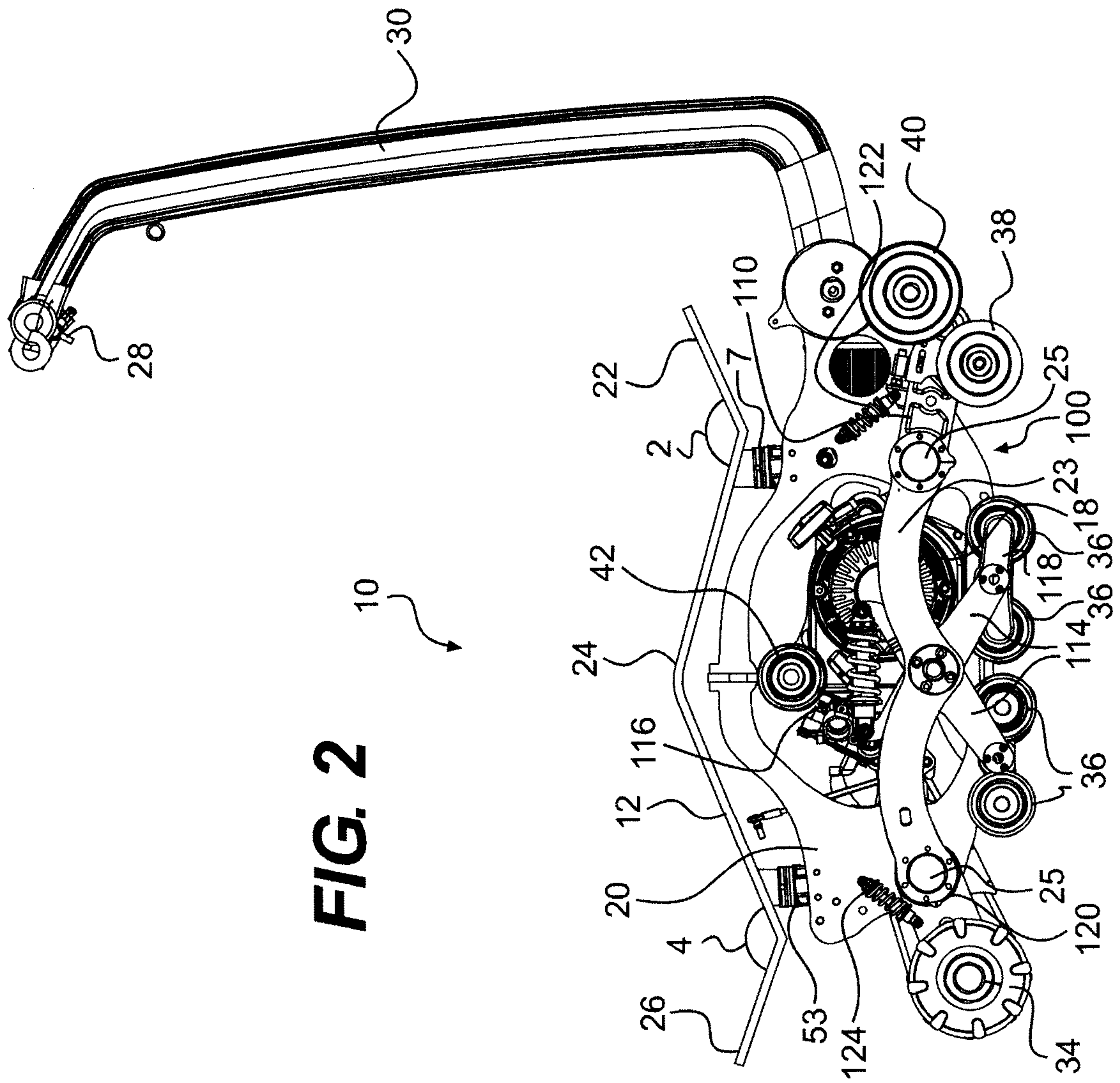

FIG. 1



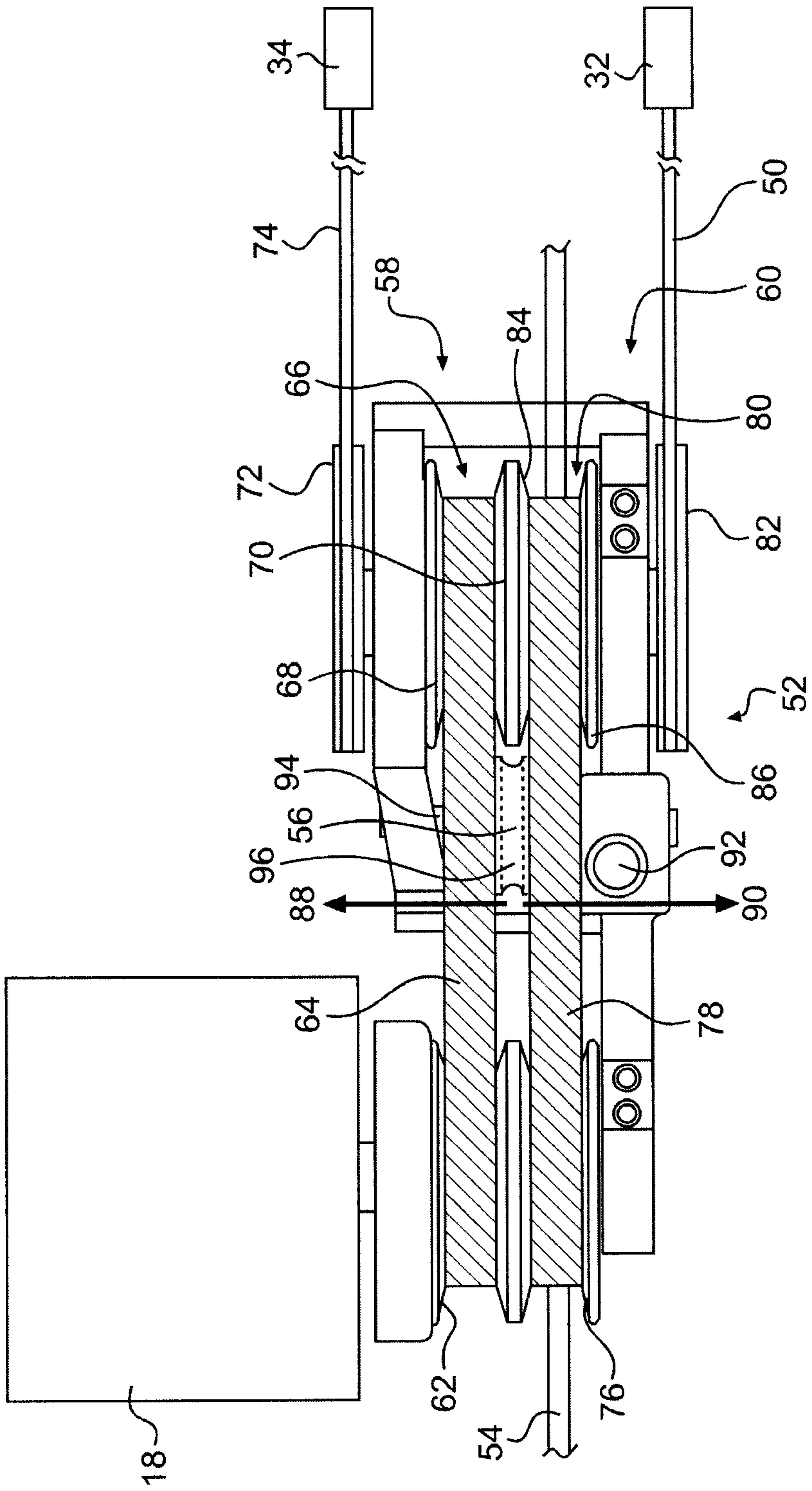

FIG. 3

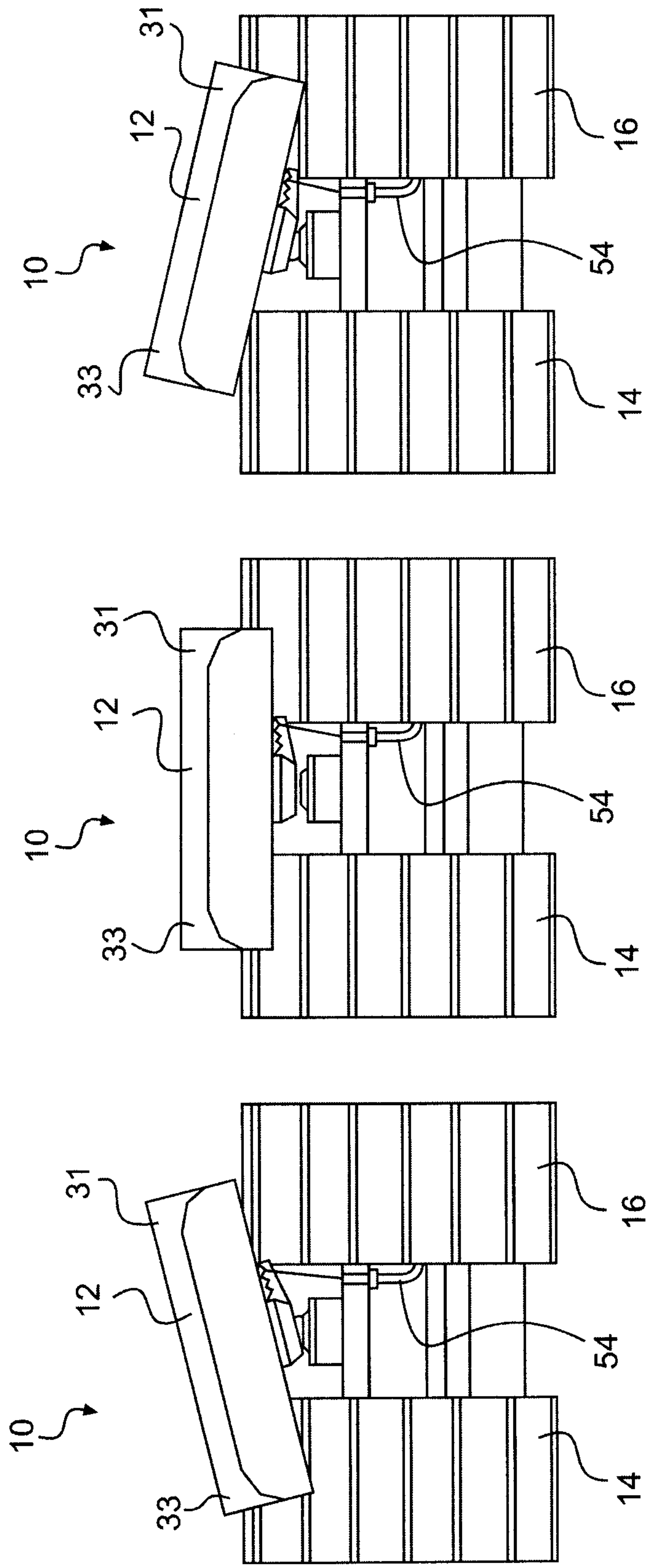

FIG. 4C

FIG. 4B

FIG. 4A

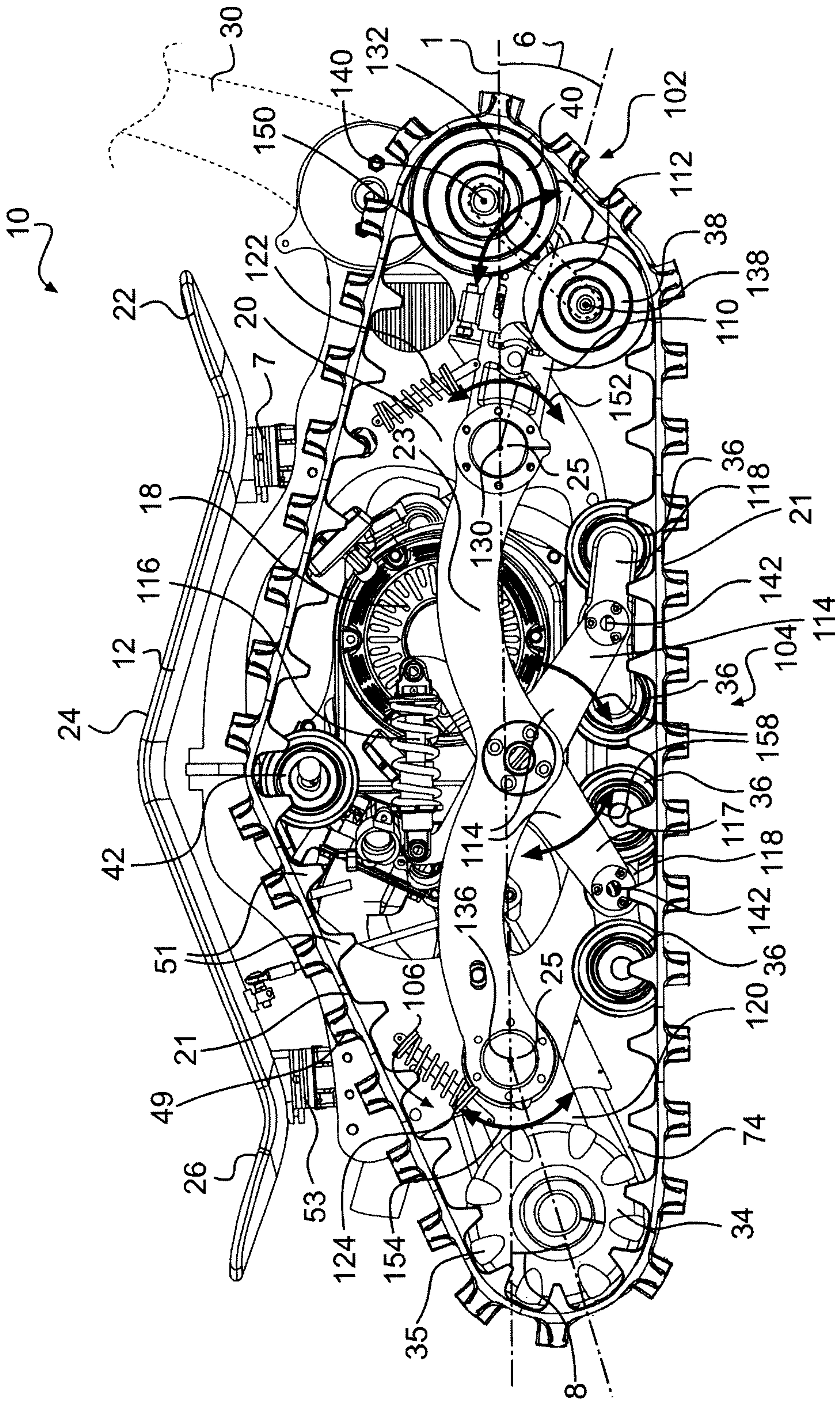

FIG. 5

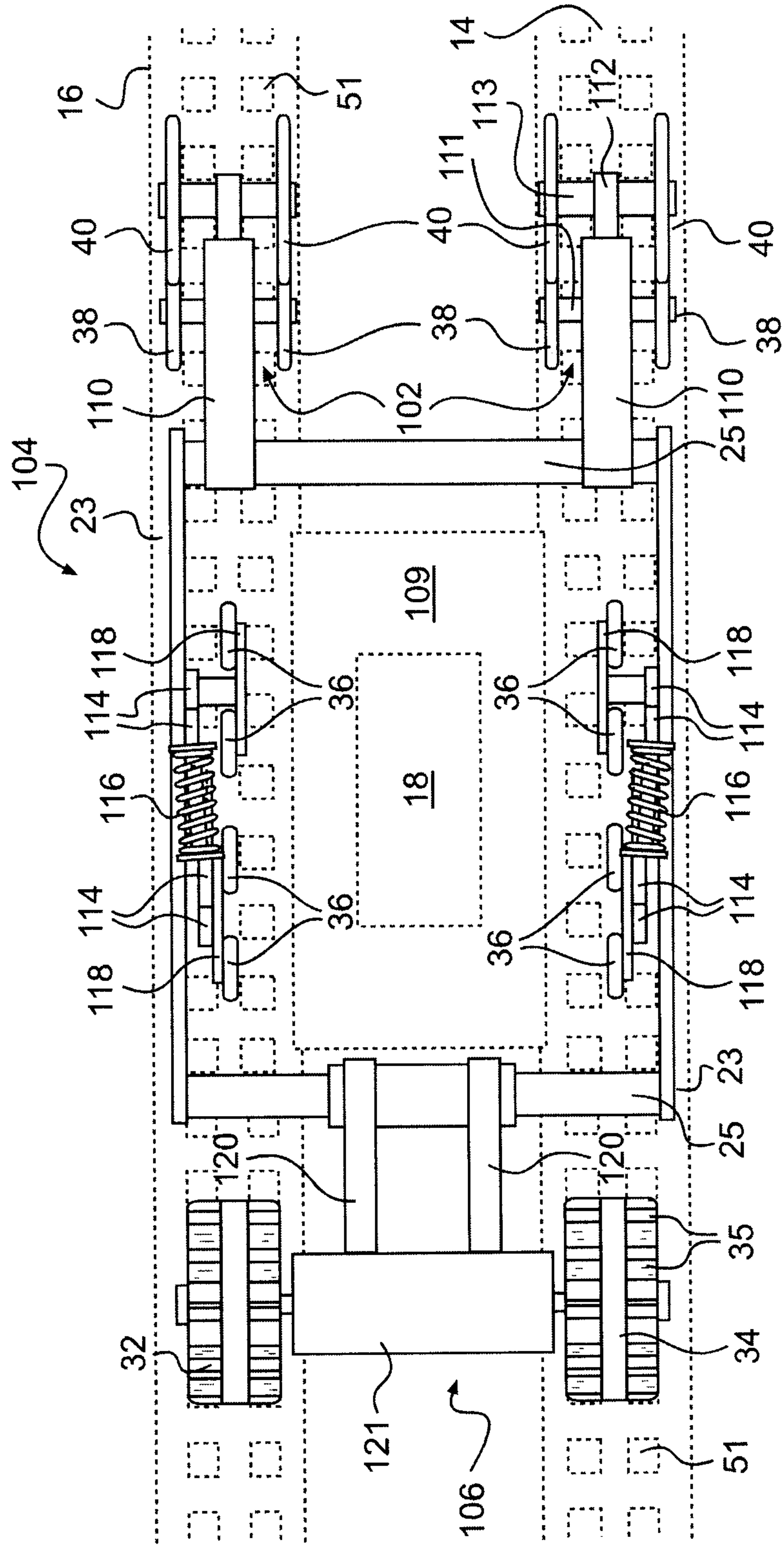

FIG. 6

