



US011358661B2

(12) **United States Patent**
Laugen et al.

(10) **Patent No.:** **US 11,358,661 B2**
(45) **Date of Patent:** **Jun. 14, 2022**

(54) **TAPERED SHORT TUNNEL FOR A SNOWMOBILE**

(56) **References Cited**

U.S. PATENT DOCUMENTS

(71) Applicant: **Polaris Industries Inc.**, Medina, MN (US)

3,850,353 A 11/1974 Foulds
6,109,217 A * 8/2000 Hedlund F28F 1/12
123/41.01

(72) Inventors: **Jesse J. Laugen**, Roseau, MN (US);
Cody S. Kofstad, Warroad, MN (US);
Lyle J. Dahlgren, Roseau, MN (US);
Luc C. Wilson, White Bear Lake, MN (US)

6,371,233 B2 4/2002 Ishii
6,585,465 B1 7/2003 Hammond et al.
6,920,952 B2 7/2005 Bertrand et al.
7,328,943 B2 2/2008 Johnson et al.
7,380,629 B2 6/2008 Vaisanen
7,753,154 B2 7/2010 Maltais
8,381,857 B1 2/2013 Sampson et al.
9,027,992 B2 5/2015 Kawatani et al.
D813,091 S * 3/2018 Tharp D12/7
10,215,083 B2 2/2019 Vezina et al.
10,300,990 B2 5/2019 Vezina
10,435,117 B1 10/2019 Cifers et al.
10,597,105 B2 3/2020 Lefebvre et al.
10,676,157 B2 6/2020 Vigen
10,730,576 B2 8/2020 Labbe et al.

(73) Assignee: **Polaris Industries Inc.**, Medina, MN (US)

(*) Notice: Subject to any disclaimer, the term of this patent is extended or adjusted under 35 U.S.C. 154(b) by 196 days.

(Continued)

(21) Appl. No.: **16/723,789**

(22) Filed: **Dec. 20, 2019**

OTHER PUBLICATIONS

(65) **Prior Publication Data**

Canadian Office Action regarding Application No. 3,103,308, dated Feb. 24, 2022.

US 2021/0188376 A1 Jun. 24, 2021

(51) **Int. Cl.**

B62D 55/084 (2006.01)
B62D 55/07 (2006.01)
B62M 27/02 (2006.01)
B60N 2/01 (2006.01)

Primary Examiner — Minnah L Seoh

Assistant Examiner — Hosam Shabara

(74) *Attorney, Agent, or Firm* — Harness, Dickey & Pierce, P.L.C.

(52) **U.S. Cl.**

CPC **B62D 55/0847** (2013.01); **B62D 55/07** (2013.01); **B62M 27/02** (2013.01); **B60N 2/012** (2013.01); **B62M 2027/028** (2013.01)

(57) **ABSTRACT**

A tapered short tunnel for use on a tracked vehicle, such as a snowmobile. The tapered short tunnel has a tapered distal end having a width less than a width of an endless track used on the snowmobile. This tapered portion reduces the snowmobile from catching or grabbing snow in a snow trench, thereby enabling the snowmobile to traverse deeper snow.

(58) **Field of Classification Search**

CPC **B62D 55/07**; **B62D 55/0847**; **B62M 27/02**; **B62M 2027/027**; **B62M 2027/028**; **B60N 2/012**

USPC 180/9.25, 190, 182, 184
See application file for complete search history.

17 Claims, 15 Drawing Sheets

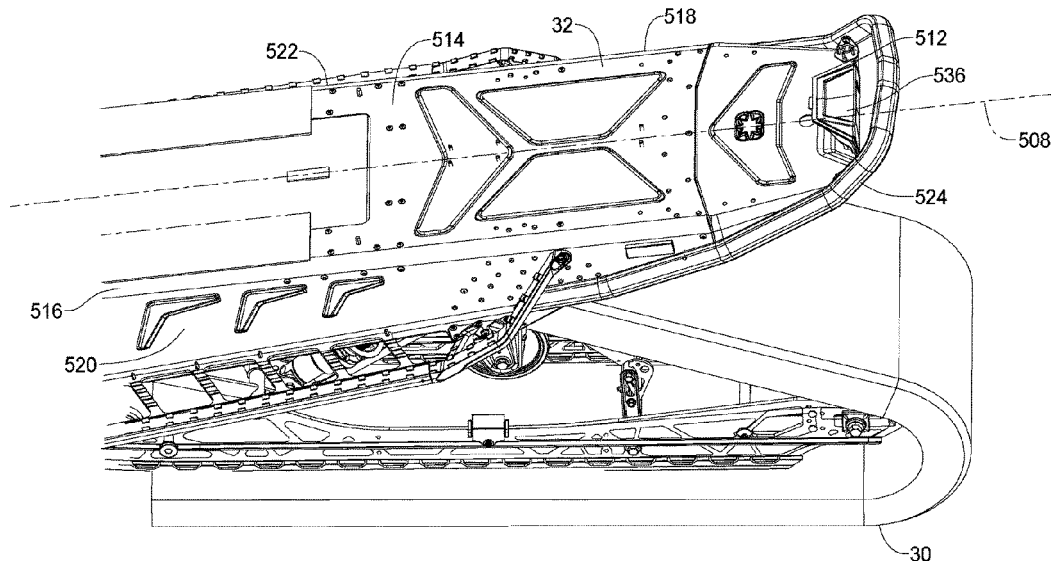

(56)

References Cited

U.S. PATENT DOCUMENTS

| | | | |
|--------------|------|---------|--------------------------|
| 10,744,953 | B2 | 8/2020 | Labbe et al. |
| 10,787,216 | B2 | 9/2020 | Visenzi |
| 10,822,054 | B2 * | 11/2020 | Lemieux B62M 27/02 |
| 10,850,806 | B2 | 12/2020 | Labbe et al. |
| 10,899,415 | B2 | 1/2021 | Mangum et al. |
| 2003/0150658 | A1 | 8/2003 | Nakano et al. |
| 2006/0043131 | A1 | 3/2006 | Graham |
| 2010/0147916 | A1 | 6/2010 | Roberts et al. |
| 2015/0210355 | A1 | 7/2015 | Labbe et al. |
| 2021/0039749 | A1 | 2/2021 | Labbe et al. |

* cited by examiner

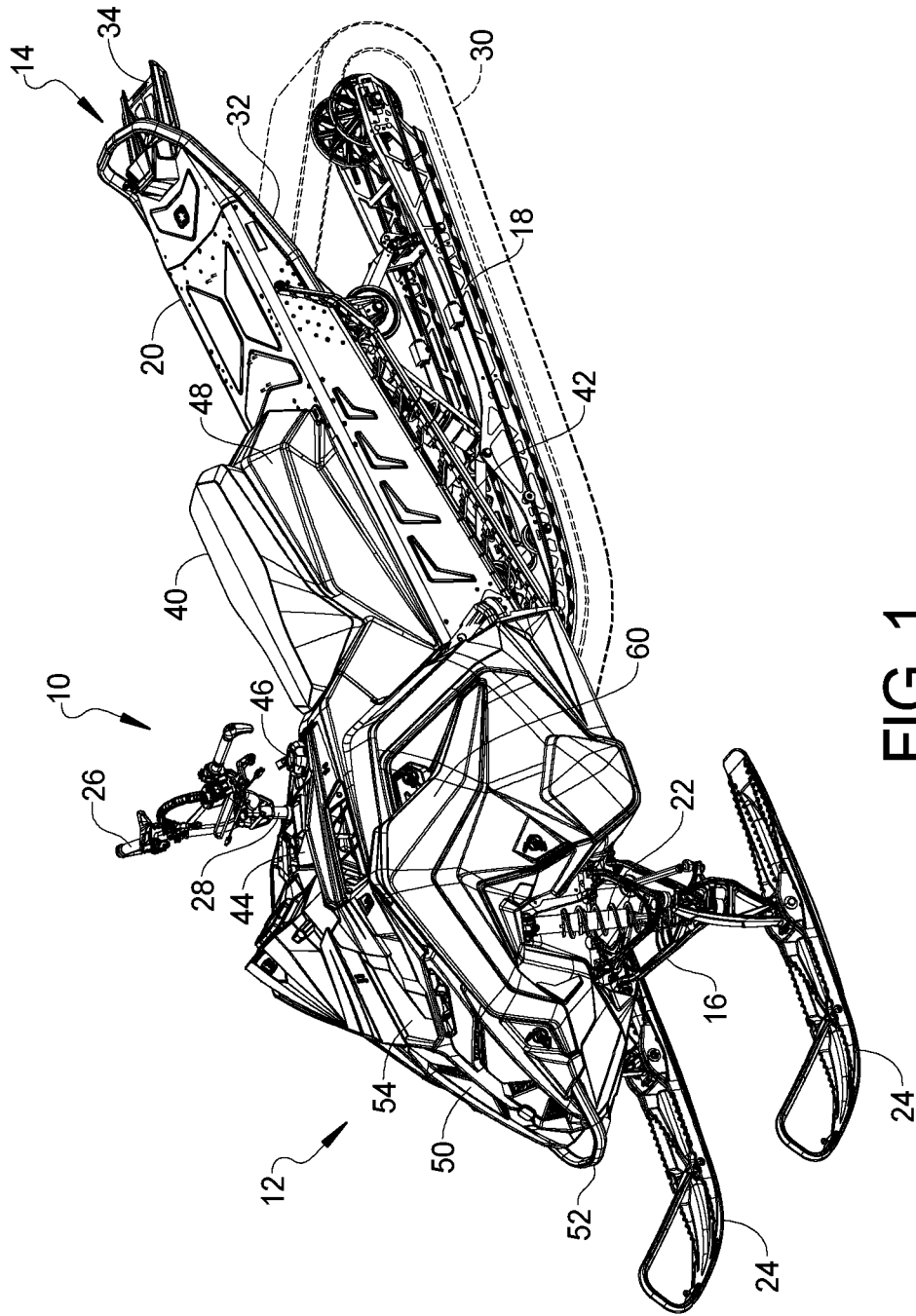

FIG. 1

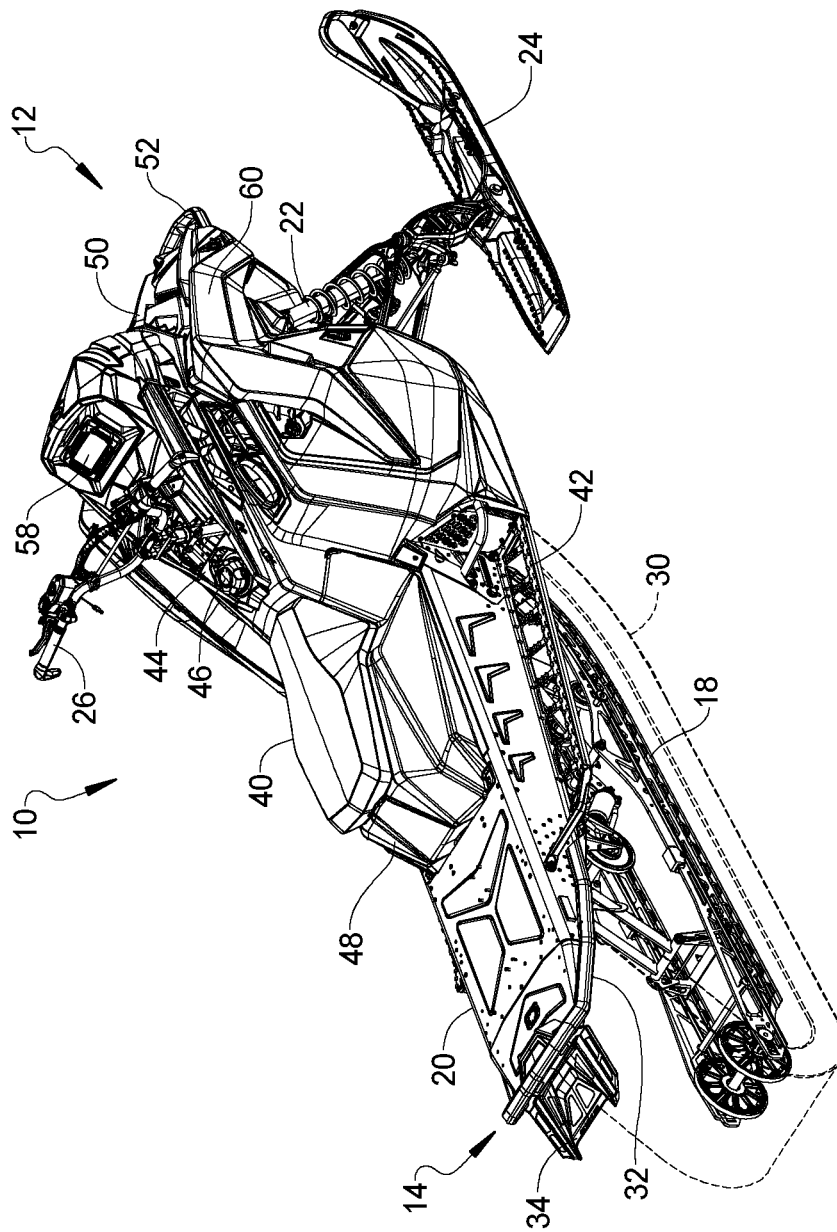

FIG. 2

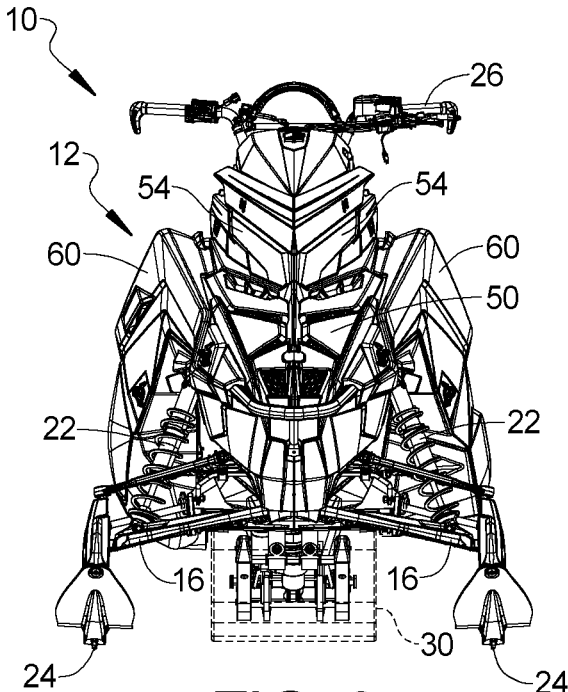

FIG. 3

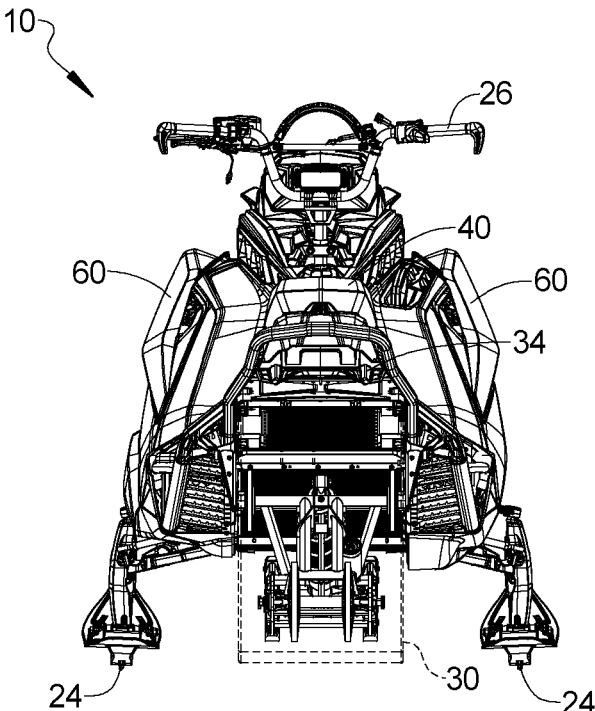

FIG. 4

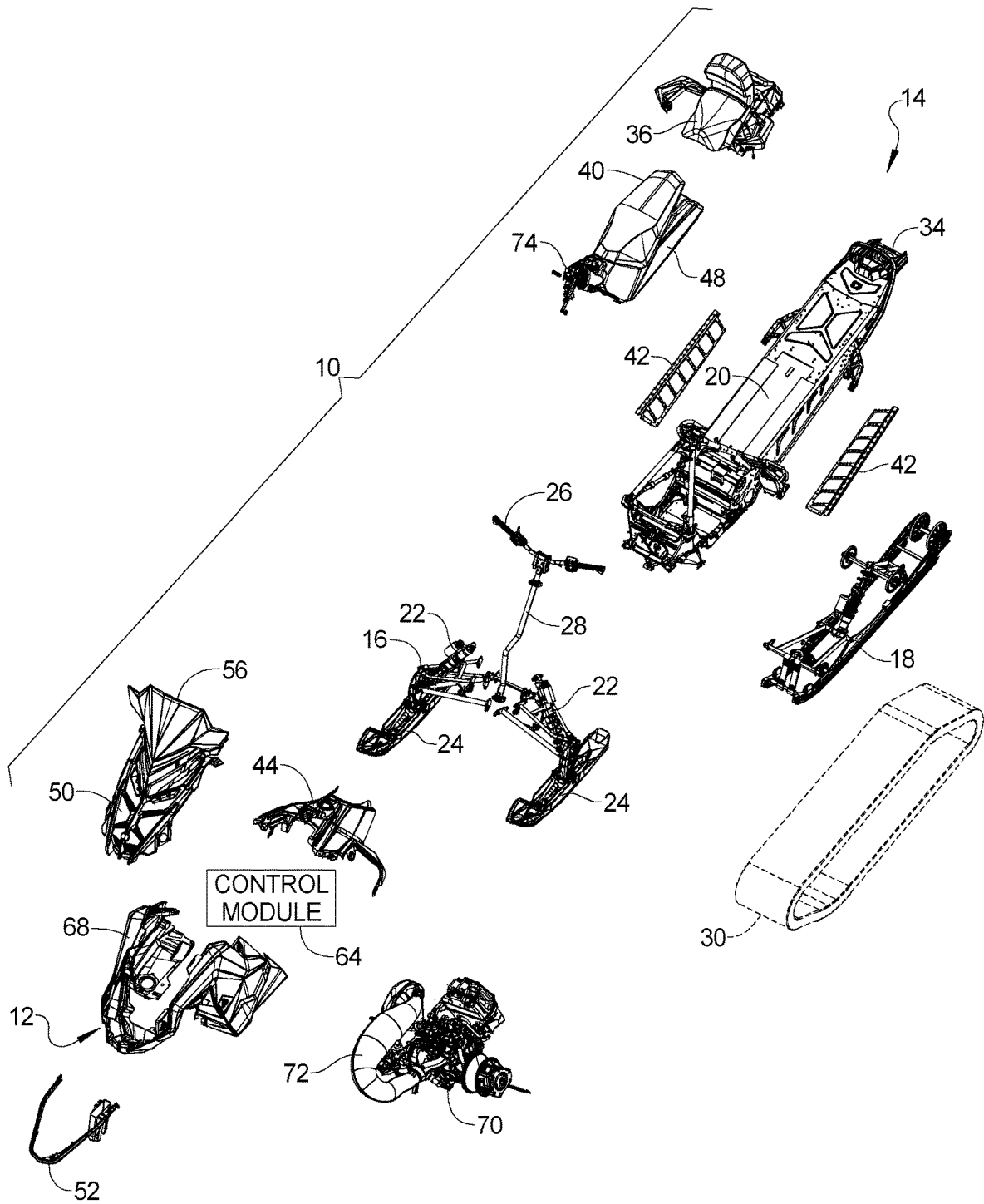

FIG. 6

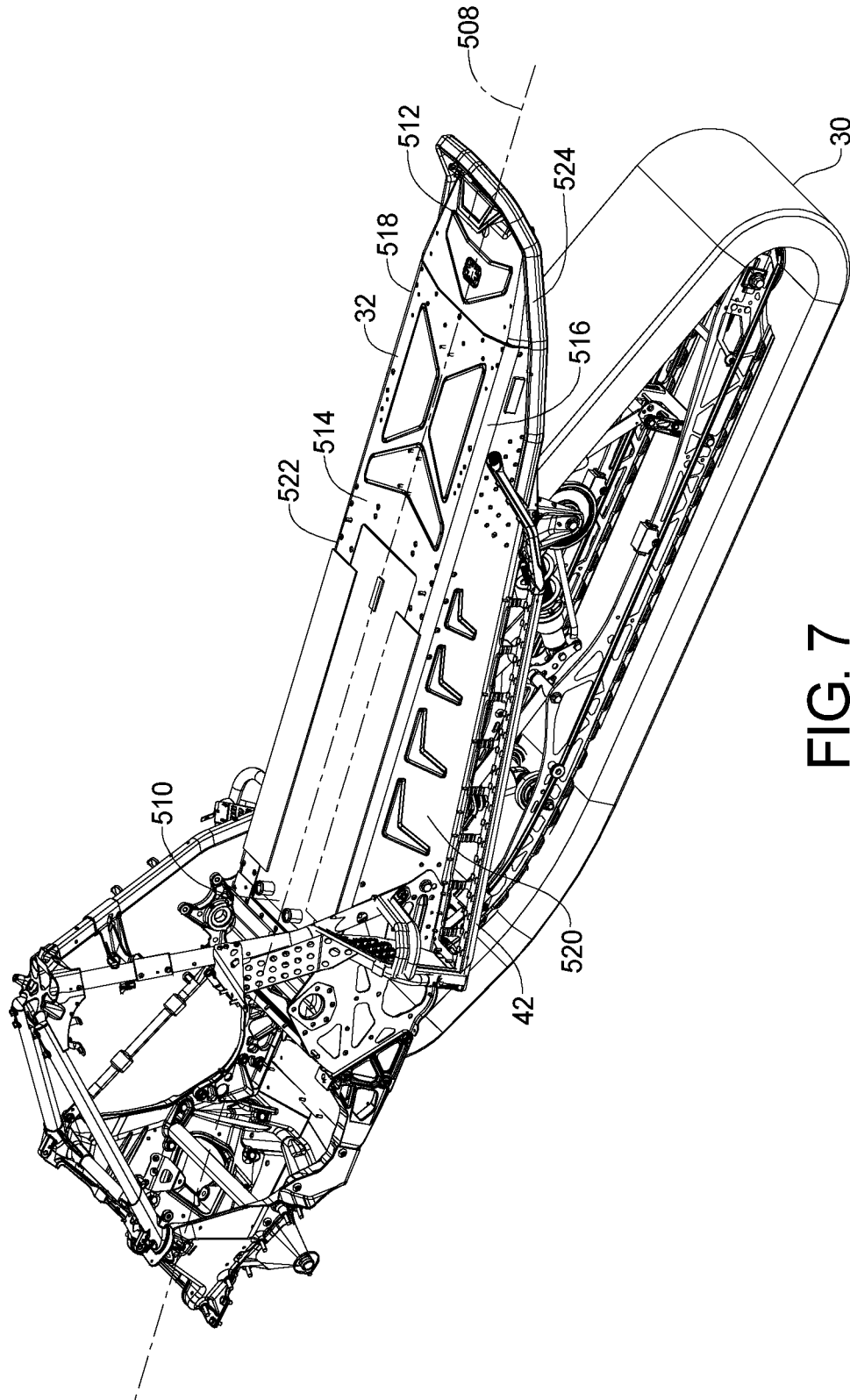

FIG. 7

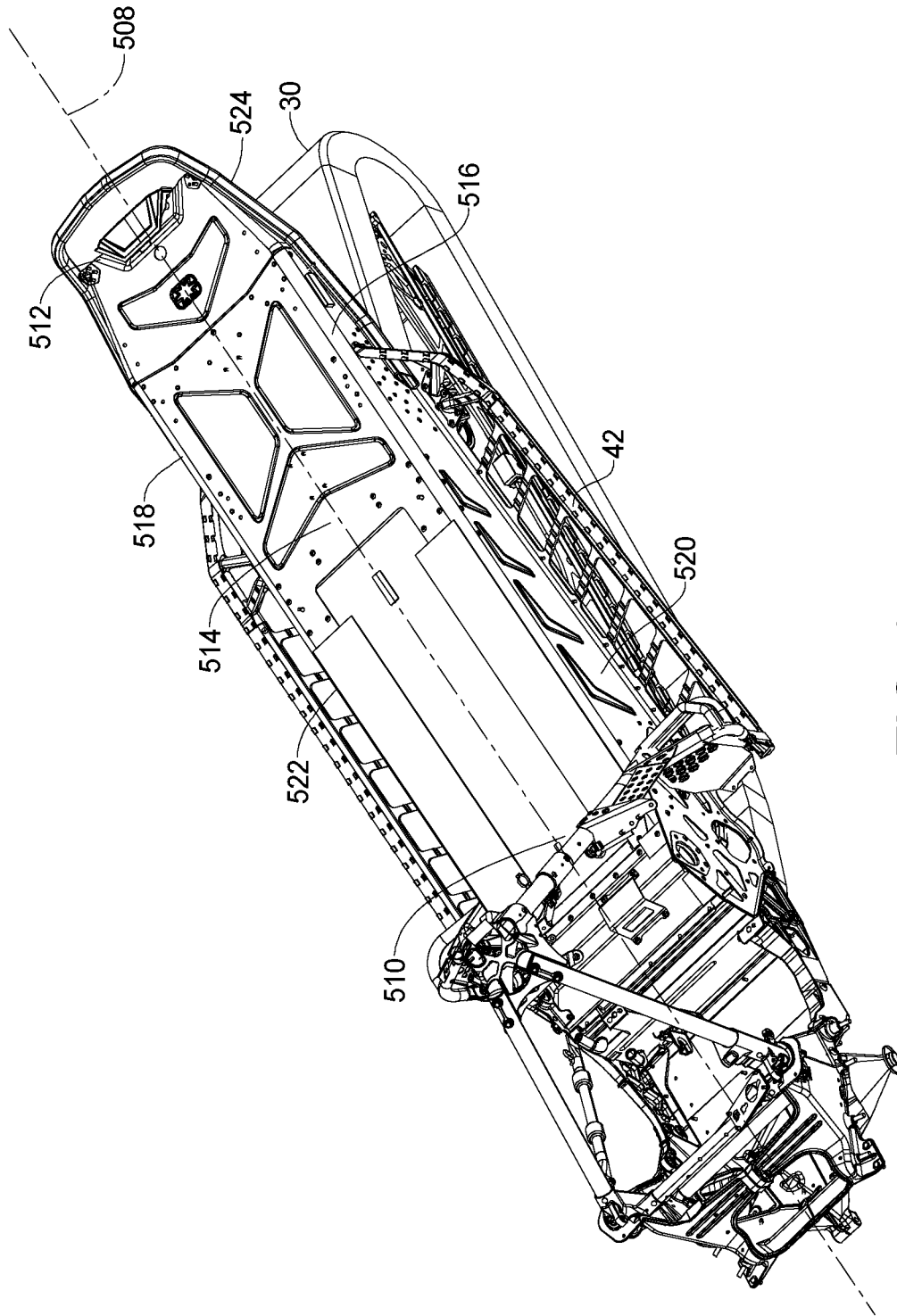

FIG. 8

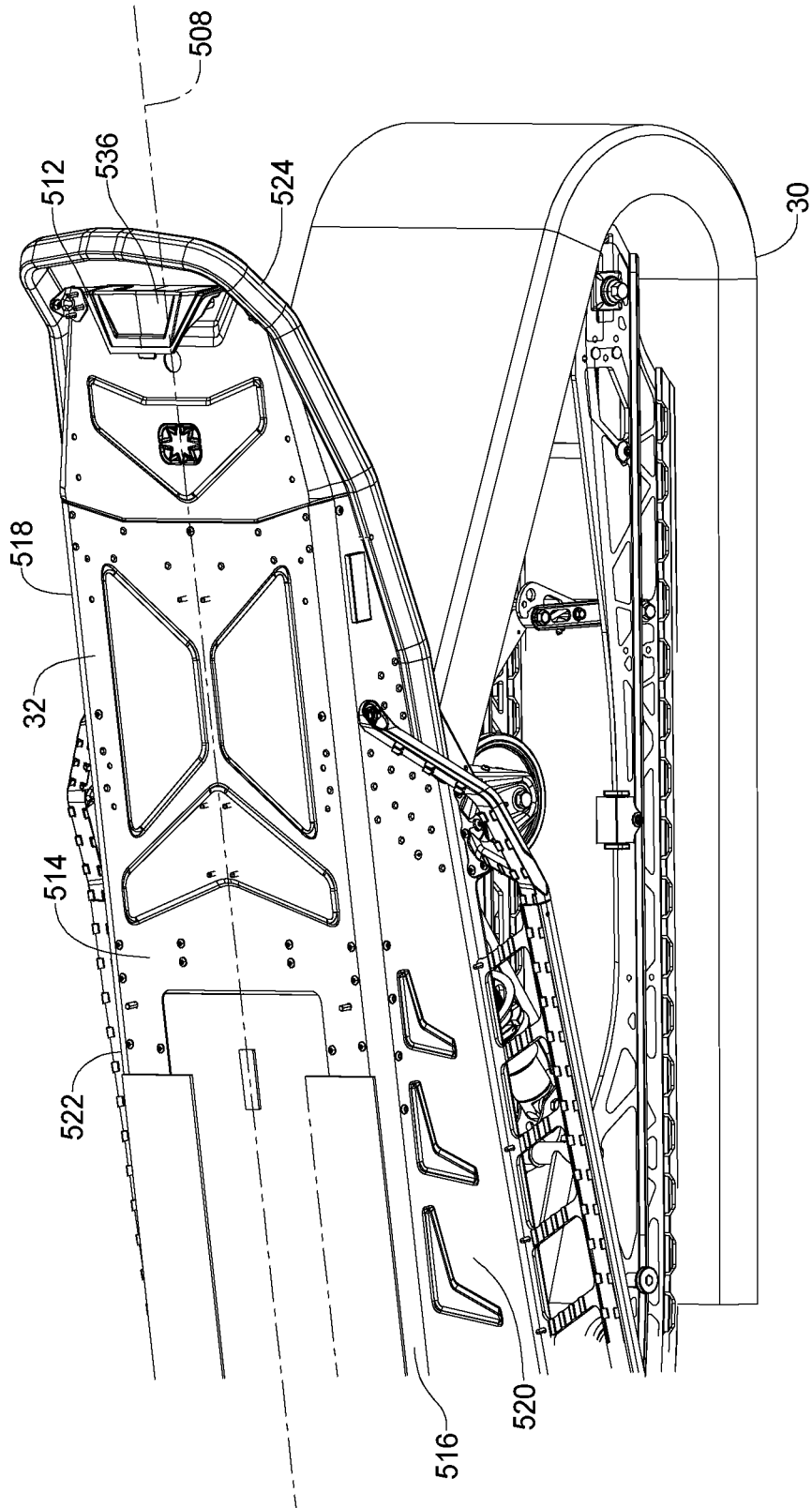

FIG. 9

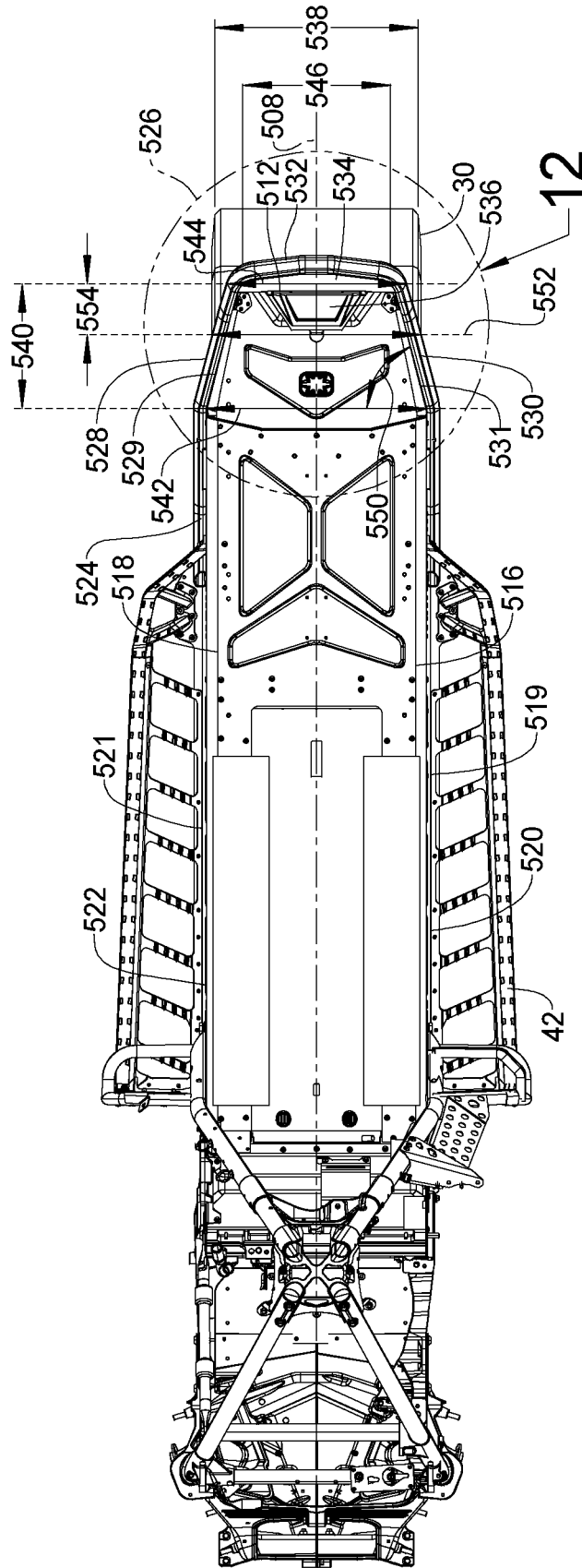

FIG. 11

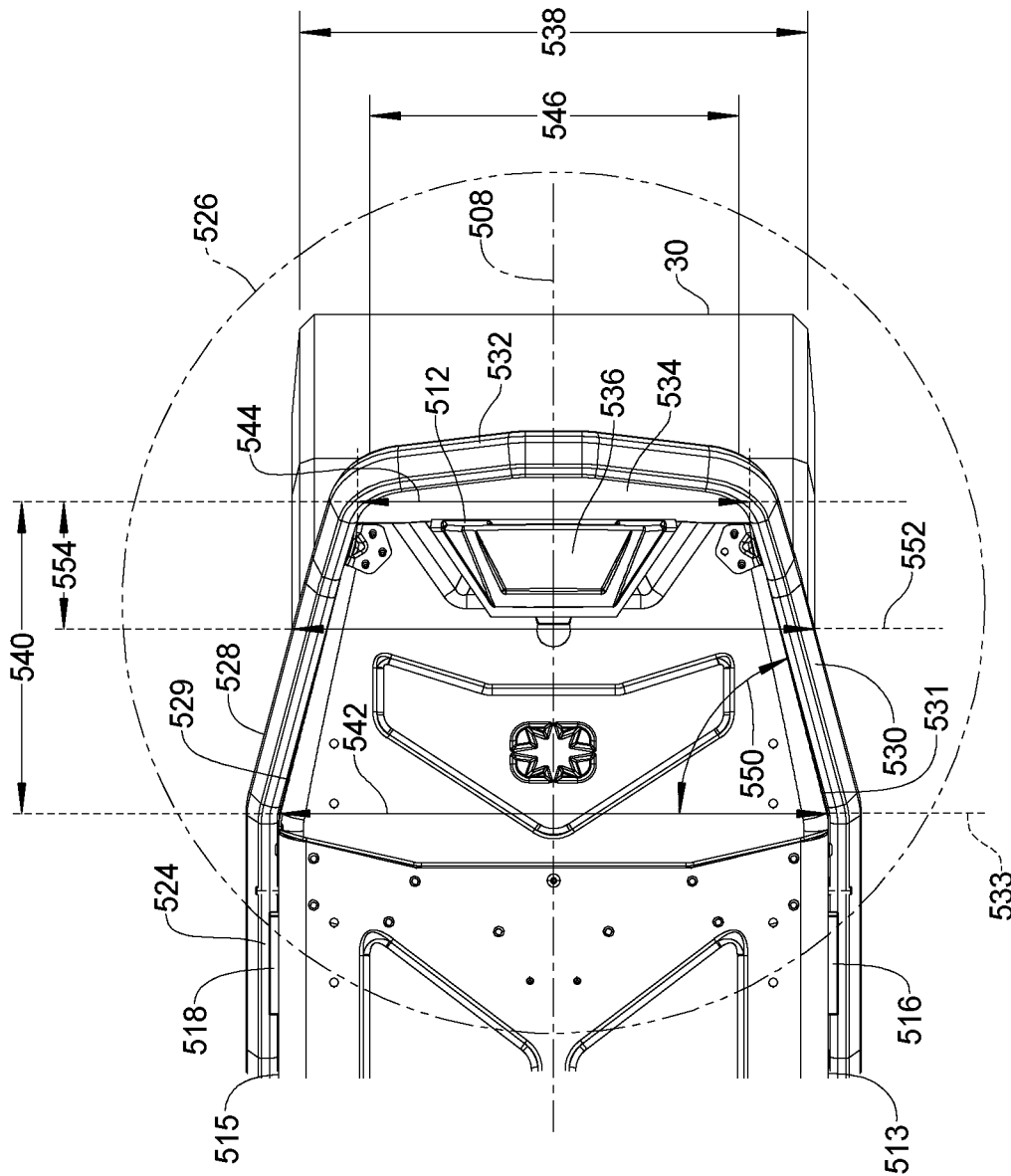

FIG. 12

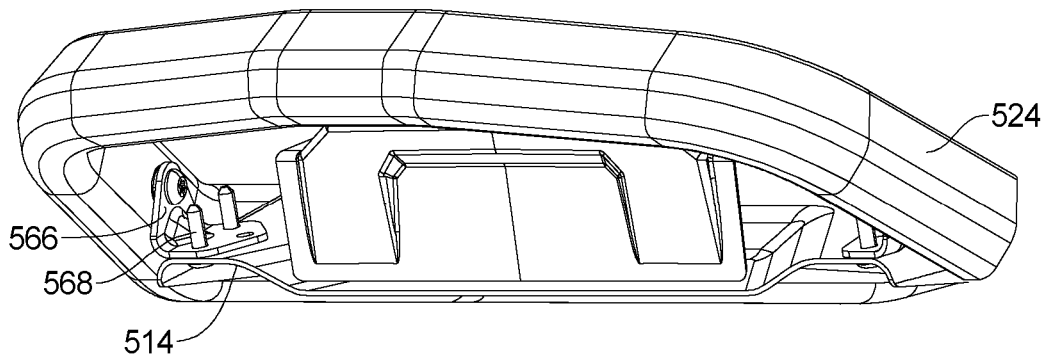

FIG. 13A

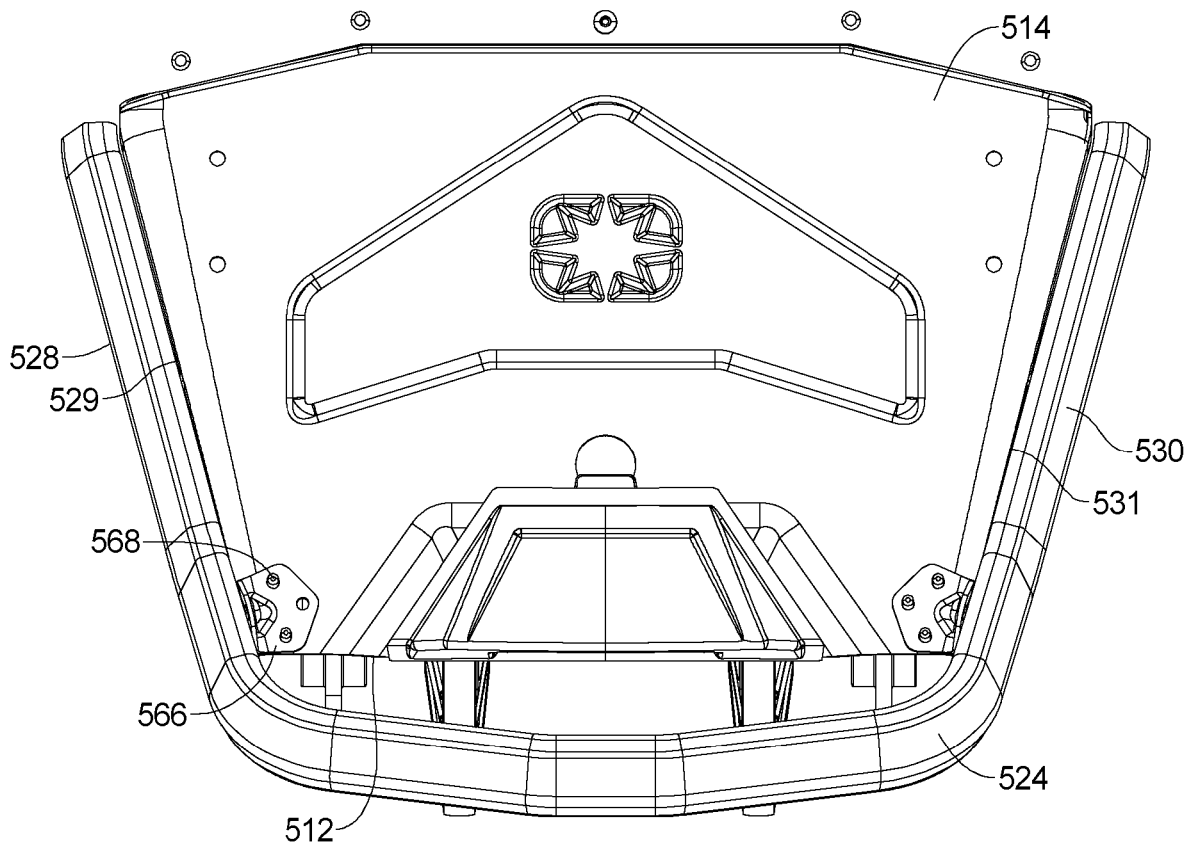

FIG. 13B

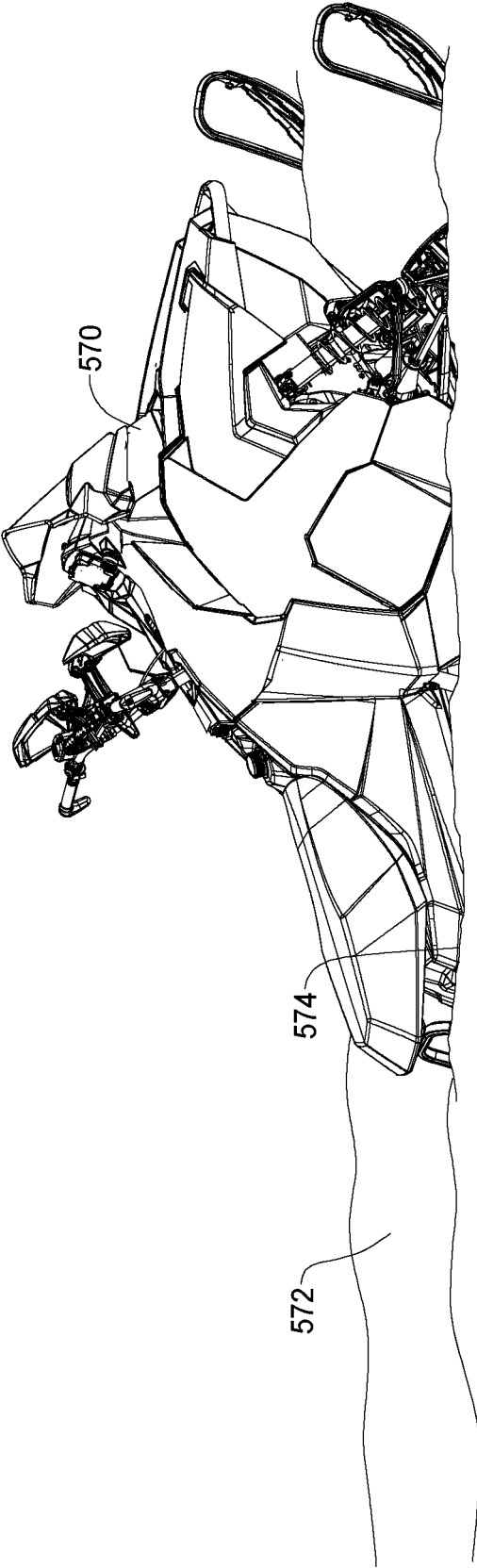

FIG. 14
PRIOR
ART

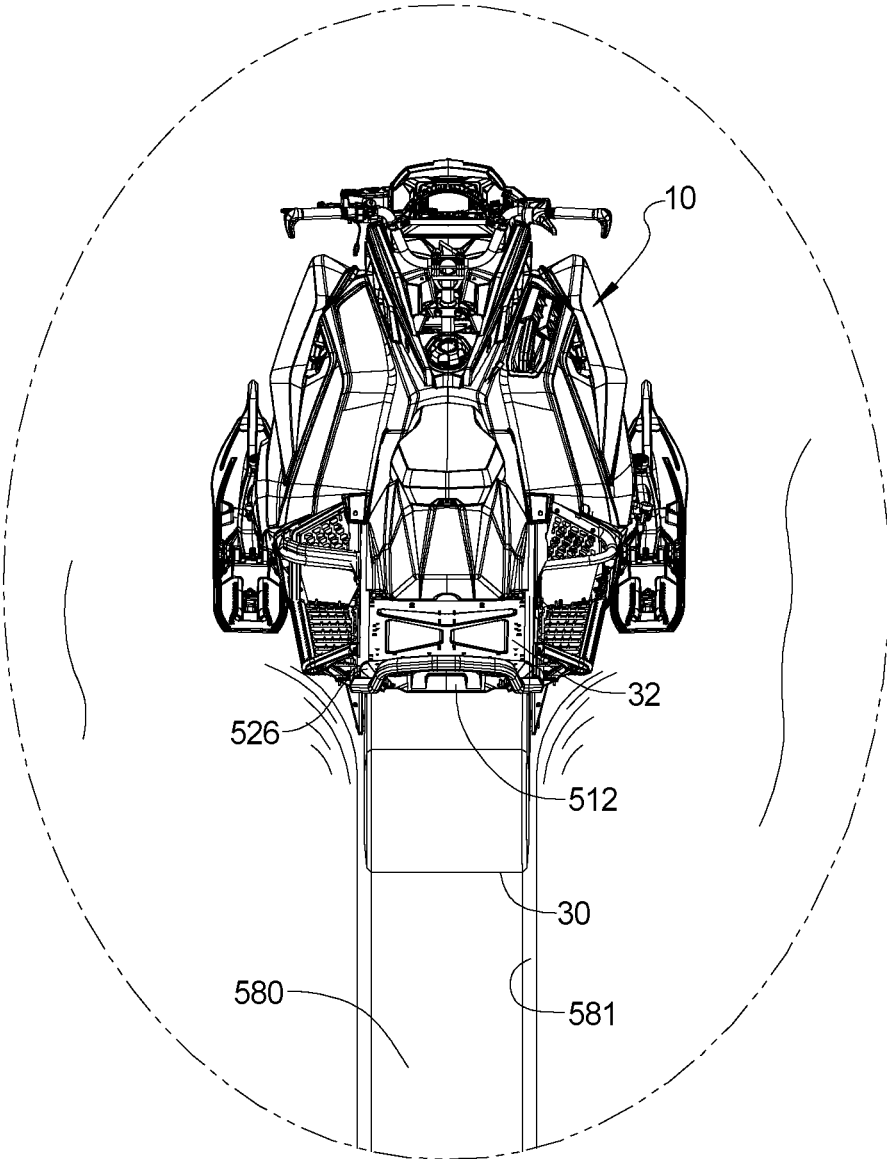

FIG. 16

1

TAPERED SHORT TUNNEL FOR A SNOWMOBILE

CROSS-REFERENCE TO RELATED APPLICATIONS

This application includes related subject matter similar to that disclosed in concurrently filed: (1.) U.S. patent application Ser. No. 16/723,754; U.S. patent application Ser. No. 16/723,745; and U.S. patent application Ser. No. 16/723,834. The entire disclosures of each of the above applications are incorporated herein by reference.

FIELD

The present disclosure relates to a tunnel that partially covers a track of a tracked vehicle and, more particularly, to a tapered short tunnel for use on a tracked vehicle, such as a snowmobile.

BACKGROUND

This section provides background information related to the present disclosure which is not necessarily prior art.

Tracked vehicles, such as a snowmobile, generally include a pair of front skis for steering and a rear endless track for driving or propelling the snowmobile. A chassis, or body, of the snowmobile includes a tunnel that is positioned over the track to support a seat and prevent snow from hitting the snowmobile occupants.

Snowmobiles can traverse various terrain and conditions. In deep powder snow that occurs frequently on mountain terrain, it is not uncommon to be riding in several feet of powder snow. Such riding can result in forming a deep trench or trenching in the snow because of the track. Such trenching can cause the rear of the snowmobile to fall into the trench.

Because the tunnel is generally covering the track about the top and sides of the track, the tunnel is wider than the track. This width of the tunnel can cause catching or grabbing at the rear of the tunnel in the sidewall of the trench that is formed by the track. Such a catching or grabbing results because the track is narrower than the tunnel. Such catching or grabbing can cause the snowmobile to stick or get stuck in the trench, thereby stopping the snowmobile. Accordingly, there is a need to provide an improved tunnel that reduces or eliminates anchoring or sticking in deep trenches, thereby enabling the snowmobile to efficiently traverse such terrain without getting stuck.

SUMMARY

This section provides a general summary of the disclosure, and is not a comprehensive disclosure of its full scope or all of its features.

A snowmobile tunnel is configured to cover at least a portion of an endless track that has a track width. The snowmobile tunnel includes a top plate that extends along a longitudinal axis from a first proximal end to a second distal end. The top plate has a first side edge and an opposed second side edge. A first sidewall extends from the first side edge of the top plate. A second sidewall extends from the second side edge of the top plate. The snowmobile tunnel includes a distal tapered portion that has a tunnel width less than the track width.

A snowmobile to traverse terrain. The snowmobile includes at least one front ski that is configured to steer the

2

snowmobile. The snowmobile further includes an endless track having a track width and configured to propel the snowmobile. The at least one ski and the endless track are coupled to a chassis that includes a tunnel. The tunnel partially covers at least a portion of the track. The tunnel includes a top plate that extends along a longitudinal axis from a first proximal end to a second distal end. The top plate has a first side edge and an opposed second side edge. A first sidewall extends from the first side edge of the top plate. A second sidewall extends from the second side edge of the top plate. The tunnel includes a distal tapered portion that has a tunnel width less than the track width.

Further areas of applicability will become apparent from the description provided herein. The description and specific examples in this summary are intended for purposes of illustration only and are not intended to limit the scope of the present disclosure.

DRAWINGS

The drawings described herein are for illustrative purposes only of selected embodiments and not all possible implementations, and are not intended to limit the scope of the present disclosure.

FIG. 1 is a perspective view of an exemplary snowmobile in accordance with the present disclosure;

FIG. 2 is another perspective view of the snowmobile of FIG. 1;

FIG. 3 is a front view of the snowmobile of FIG. 1;

FIG. 4 is a rear view of the snowmobile of FIG. 1;

FIG. 5 is a top view of the snowmobile of FIG. 1;

FIG. 6 is an exploded view of the snowmobile of FIG. 1;

FIG. 7 is a rear perspective view illustrating a tunnel of the snowmobile, in accordance with the present disclosure;

FIG. 8 is another perspective view of the tunnel of the present disclosure;

FIG. 9 is a side perspective view of the tunnel of the present disclosure;

FIG. 10 is a side view of the tunnel and track assembly;

FIG. 11 is a top view of the tunnel;

FIG. 12 is an enlarged top view of a tapered portion of the tunnel relative to the track;

FIG. 13A is a perspective view of an attachment of a bumper to the tunnel;

FIG. 13B is a top view of the attachment of the bumper to the tunnel;

FIG. 14 is an environmental prior art view of a snowmobile caught in a trench;

FIG. 15 is a prior art environmental view of the snowmobile of FIG. 14, shown illustrated within the trench; and

FIG. 16 is an environmental view of the tunnel of the present disclosure, illustrated within a snow trench.

Corresponding reference numerals indicate corresponding parts throughout the several views of the drawings.

DETAILED DESCRIPTION

Example embodiments will now be described more fully with reference to the accompanying drawings.

With initial reference to FIGS. 1-6, an exemplary vehicle in accordance with the present disclosure is illustrated. Although the vehicle is illustrated as a snowmobile 10, numerous aspects of the present disclosure may be included with any other suitable vehicle as well. The snowmobile 10 may be any suitable type of snowmobile, such as any suitable trail snowmobile, sport trail snowmobile, touring snowmobile, performance snowmobile, utility snowmobile

(such as any snowmobile suitable for search and/or rescue, law enforcement, military operations, etc.), crossover snowmobile, mountain snowmobile, youth snowmobile, etc.

The snowmobile **10** generally includes a front end **12** and a rear end **14**. At the front end **12** is a front suspension **16**. At the rear end **14** is a rear suspension **18**. The front suspension **16** and the rear suspension **18** support a chassis **20**.

The front suspension **16** includes shock absorbers **22**, each one of which is connected to a ski **24**. The shock absorbers **22** may be any dampening devices suitable for absorbing shock resulting from the skis **24** passing over uneven terrain. The skis **24** are steered in part by a suitable steering device, such as handlebars **26**.

Coupled to the rear suspension **18** is a belt or track **30**, which is an endless or continuous belt or track **30**. Rotation of the track **30** propels the snowmobile **10**. The track **30** is circulated through a tunnel **32** defined at least in part by the chassis **20**. The tunnel **32** is tapered at the rear end **14**, as described in detail herein. Mounted at the rear end **14** is a flap **34**, which blocks snow and other debris from being "kicked-up" by the track **30**.

Mounted to the chassis **20** and atop the tunnel is a seat **40** for the operator of the snowmobile **10**. On both sides of the chassis **20** or tunnel **32** are footrests **42**, upon which the operator may rest his or her feet when seated on the seat **40**. The seat **40** is positioned to allow the driver to grasp the handlebars **26** for steering the snowmobile **10**. The handlebars **26** are mounted to a steering rod **28**, which protrudes out from within the center console **44**. At the center console **44** is a fuel cap **46** of a fuel tank **48**. Any suitable accessory **36** (see FIG. 6) may be mounted to the chassis **20** behind the seat **40**.

At the front end **12** of the snowmobile **10** is a hood assembly **50**, which is mounted on top of a nose pan **68**. Mounted to the hood assembly **50** and protruding from a forwardmost end thereof, is a front bumper **52**. The hood assembly **50** houses headlights **54**. An optional windshield **56** is connected to an uppermost portion of the hood assembly **50**. Associated with the hood assembly **50** is a display **58** viewable by the operator when seated on the seat **40**. Mounted to opposite sides of the hood assembly are body panels **60**, which are advantageously interchangeable.

With particular reference to FIG. 6, the snowmobile **10** further includes an engine assembly **70**. The engine assembly **70** generates power for driving the track **30**. The engine assembly **70** may include any suitable engine, such as an electric, 2-stroke, and 4-stroke engine. Coupled to the engine assembly **70** is an exhaust assembly **72**. Any suitable exhaust assembly may be used. Oil for the engine assembly **70** is stored in an oil tank assembly **74**, which may be arranged proximate to the seat **40**.

The snowmobile **10** further includes any suitable control module **64**. The control module **64** may be arranged at any suitable location, such as within the hood assembly **50**, beneath the center console **44**, or within any suitable control mounted to the handlebars **26**. The term "control module" may be replaced with the term "circuit." The term "control module" may refer to, be part of, or include processor hardware (shared, dedicated, or group) that executes code and memory hardware (shared, dedicated, or group) that stores code executed by the processor hardware. The code is configured to provide the features of the control module described herein. The term memory hardware is a subset of the term computer-readable medium. The term computer-readable medium, as used herein, does not encompass transitory electrical or electromagnetic signals propagating

through a medium (such as on a carrier wave). The term computer-readable medium is therefore considered tangible and non-transitory. Non-limiting examples of a non-transitory computer-readable medium are nonvolatile memory devices (such as a flash memory device, an erasable programmable read-only memory device, or a mask read-only memory device), volatile memory devices (such as a static random access memory device or a dynamic random access memory device), magnetic storage media (such as an analog or digital magnetic tape or a hard disk drive), and optical storage media (such as a CD, a DVD, or a Blu-ray Disc).

Referring to FIGS. 7-9, the tunnel **32** is illustrated in various perspective views. The tunnel **32** extends along a longitudinal axis **508** from a first proximal end **510** to a second distal end **512**. The tunnel **32** has an overall length of about 1733 mm, with a range of lengths between about 1733 mm to about 2100 mm. The tunnel **32** includes an upper substantially planar or top plate **514** bounded by the first proximal end **510** and the opposed second distal end **512** and a first side edge **516** and an opposed second side edge **518**. Extending at about 90° from the top plate **514** is a first tapered sidewall **520** and extending at about 90° from the second side edge **518** is a second tapered sidewall **522**. The tunnel **32** is formed from aluminum or other appropriate substantially light rigid material, such as composite material. The tunnel is shaped to substantially cover the track **30** and support the seat **40** and fuel tank **48**. The top plate **514** and the sidewalls **520** and **522** can be formed separately and attached to one another, such as by welding, riveting, fasteners, adhesives, etc. Alternatively, the tunnel **32** can be bent or shaped to form an integral one-piece construct.

Attached to the tunnel **32** are the footrests **42** that are attached to the first tapered sidewall **520** and the second tapered sidewall **522**. Extending rearward from the footrests **42** is a bumper **524** that is attached to the tunnel **32** with fasteners, such as screws, rivets, or bonding. As illustrated in FIGS. 10-12, the tunnel **32** includes a distal tapered portion **526**. The distal tapered portion **526** of the tunnel **32** provides tapering both along the plane of the upper top plate **514** and along the first and second tapered sidewalls **520** and **522**. As illustrated in FIGS. 10-12, the bumper **524** extends around the perimeter of the distal tapered portion **526** from the footrests **42**. The bumper **524** extends out beyond the tunnel **32** and includes first and second angled portions **528** and **530** that attach to and follow corresponding angled portions **529** and **531** of the tunnel **32**. An upturned end portion **532** extends beyond the second distal end **512** of the tunnel **32** to define a handle **534**. Positioned adjacent to the upturned end **532** is a rear tail light **536** that is attached atop the tunnel **32**.

As noted in FIG. 12, the track **30** has a width **538**. The width of the track **30** can vary between about 304.8 mm to about 609.6 mm, and the illustrated track is about 381 mm in width. The length **540** of the tapered portion **526** of the tunnel **32** along longitudinal axis **508** is constant at about 231.14 mm for the noted track **30** having a width of about 381 mm. This results in the tapered portion **526** being about 11% to about 14% of the overall length of the tunnel **32**. The taper of the tunnel **32** starts at a transition line or plane **533** with a tunnel width of about 398.78 mm, identified by reference numeral **542**, having an overall assembly width that includes the bumper **524** of about 447.04 mm. A second width **544** at the distal end **512** of the tunnel **32** includes a width of about 289.56 mm and an overall assembled width, including the bumper **524** of about 350.52 mm. A rearward-most width **546** of the bumper **524** is about 325.12 mm.

A first portion **513** of the first side edge **516** is parallel to a first portion **515** of the second side edge **518** up to the

transition line or plane **533** having the width **542**. First portions **519** and **521** of the first and second sidewalls **520** and **522** are also parallel to one another along the first portions **513** and **515** of the first and second side edges **516** and **518**. These edges **516** and **518** and sidewall portions **519** and **521** are also parallel to the longitudinal axis **508**. At this point **533**, near the upper track support wheel **548** location, the tunnel **32** begins to taper inward toward the longitudinal axis **508** at an angle of about 75° , identified by reference numeral **550**. As noted in FIG. **12**, the distal end **512** of the tunnel **32** does not extend beyond the track **30** and is, thus, shorter than the distalmost end of the track **30**. The rearwardmost portion of the bumper **524** also does not extend beyond the track **30**, as illustrated in FIG. **12**.

At intersection line or plane **552**, the tapered tunnel portion **526** and the bumper **524** crosses over, or intersects, the track **30**, as illustrated in FIG. **12**. In other words, the intersection line or plane **552** is a line or plane perpendicular to axis **508** and where the tunnel width including the bumper **524** width is about 381 mm corresponding to the track width. This intersection line **552** extends a distance of about 80 mm from the second distal end **512** of the tunnel **32**, identified by reference numeral **554**. Thus, the tunnel **32**, including the assembly with the bumper **524**, crosses over the track **30** before the second distal end **512**. Such a configuration reduces anchoring or sticking of the tunnel **32**, particularly the rear of the tunnel **32**, relative to a deep snow trench, further discussed herein.

Turning to FIG. **10**, the side view of the distal tapered portion **526** is illustrated. At the transition line or plane **533** where the tunnel **32** begins to taper relative to the longitudinal axis **508** of the top plate **514**, a height **556** of the tunnel sidewall is about 137.5 mm. At the second distal end **512** of the tunnel **52** at the second width **544**, the height of the tunnel sidewall is about 9.5 mm, identified by reference numeral **558**. This results in a 14.5-to-1 reduction in sidewall height along the length **540**. This height reduction is achieved by having a lower edge **560** extending at an angle **562** of about 11.8° relative to the top plate **514**. This substantial reduction in height, as well as providing a substantially thin (i.e. 9.5 mm or less than 10 mm) distal end **512** substantially reduces catching or grabbing snow by the tunnel **32** that can act as an anchor in a deep snow trench. At the intersection line or plane **552** where the tunnel **32** intersects or crosses over the track **30**, the height of the sidewall **564** is about 58 mm at the track crossover area.

As illustrated in FIG. **10**, since the transition line or plane **533** of the tapered portion **526** of the tunnel **32** begins near or adjacent to the upper track wheel mounting **548**, this helps prevent impingement of the tunnel **32** onto the track **30**. Additionally, the rear suspension track support wheel **549** can travel along an arc **551** to the dashed area identified by reference numeral **553** during full suspension travel. Since this full range of travel occurs substantially below the lower edge **560** at the intersection line or plane **552**, substantially no impingement between the tunnel **32** and the track **30** occurs in this crossover or intersection point **552**. This enables the track **30** to be wider than the tunnel **32** at the distal end of the tunnel **32** without causing impingement between the tunnel **32** and the track **30**, while also providing the benefit of eliminating the rear of the tunnel **32** from grabbing or sticking in snow, particularly in deep trenches.

Turning to FIGS. **13A-13B**, it is further noted that the rear of the bumper **524** is attached above the tunnel **32** using an L-bracket **566** that is positioned atop the upper top plate **514**. The bumper **524** is attached by way of fasteners **568**, such as screws or rivets, to retain the bumper **524** above the distal

end **512** of the tunnel **32**. This, again, eliminates any area at the distalmost end **512** of the tunnel **32** that could catch or grab snow or that could act as an anchor to provide additional drag on the snowmobile **10**, causing the snowmobile **10** to potentially get stuck in a trench, further discussed herein.

Turning to FIGS. **14-15**, a prior art snowmobile **570** is illustrated stuck within a deep snow trench **572**. As illustrated in FIG. **14**, a rear **574** of the snowmobile **570** has fallen into the deep snow trench **572**. As illustrated in FIG. **15**, this causes the tunnel **576**, particularly the rear of tunnel **576**, that has two substantially opposed parallel sidewalls **577** and a width wider than a track **578** to act as an anchor and grab the snow along the sidewall **571** of the snow trench **572**. Such a condition can slow down the snowmobile **570** to a point where the snowmobile **570** becomes stuck in the snow trench **572**.

Turning to FIG. **16**, the present snowmobile **10** having the tapered tunnel **32** is illustrated, where the tapered tunnel **32** is shown within a snow trench **580**, where the distal tapered portion **526** being both tapered along the top plate **514**, as well as on the sidewalls **520** and **522**, does not cut into a sidewall **581** of the snow trench **580** since the distal end **512** is narrower than the track **30** and, thus, narrower than the trench **580**. This enables the snowmobile **10** to traverse very deep snow while substantially reducing the chance that the snowmobile **10** becomes stuck in the snow trench **580**.

The foregoing description of the embodiments has been provided for purposes of illustration and description. It is not intended to be exhaustive or to limit the disclosure. Individual elements or features of a particular embodiment are generally not limited to that particular embodiment, but, where applicable, are interchangeable and can be used in a selected embodiment, even if not specifically shown or described. The same may also be varied in many ways. Such variations are not to be regarded as a departure from the disclosure, and all such modifications are intended to be included within the scope of the disclosure.

What is claimed is:

1. A snowmobile tunnel configured to cover at least a portion of an endless track having a track width, the snowmobile tunnel comprising:

a top plate extending along a longitudinal axis from a first proximal end to a second distal end, the top plate having a first side edge and an opposed second side edge;

a first sidewall extending from the first side edge of the top plate; and

a second sidewall extending from the second side edge of the top plate;

wherein the snowmobile tunnel includes a distal tapered portion having a tunnel width less than the track width; wherein a first portion of the first side edge and a first portion of the second side edge extends substantially parallel to the longitudinal axis and defines a first tunnel width;

wherein a second portion of the first side edge and a second portion of the second side edge each taper toward the longitudinal axis to define a second tunnel width at the second distal end, the second tunnel width being less than the first tunnel width.

2. The snowmobile tunnel of claim 1, wherein the second tunnel width is less than the track width.

3. The snowmobile tunnel of claim 1, wherein the distal tapered portion extends between a transition plane having the first width and the second distal end having the second

7

width, wherein an intersection plane that intersects the track is between the transition plane and the first distal end.

4. A snowmobile tunnel configured to cover at least a portion of an endless track having a track width, the snowmobile tunnel comprising:

a top plate extending along a longitudinal axis from a first proximal end to a second distal end, the top plate having a first side edge and an opposed second side edge;

a first sidewall extending from the first side edge of the top plate; and

a second sidewall extending from the second side edge of the top plate;

wherein the snowmobile tunnel includes a distal tapered portion having a tunnel width less than the track width;

wherein the first sidewall and the second sidewall extend substantially perpendicular from the top plate.

5. The snowmobile tunnel of claim 1, wherein the second portion of the first side edge and the second portion of the second side edge angle at about 75° from a line perpendicular to the longitudinal axis.

6. The snowmobile tunnel of claim 1, wherein the first sidewall and the second sidewall taper from a transition plane to the second distal end.

7. A snowmobile tunnel configured to cover at least a portion of an endless track having a track width, the snowmobile tunnel comprising:

a top plate extending along a longitudinal axis from a first proximal end to a second distal end, the top plate having a first side edge and an opposed second side edge;

a first sidewall extending from the first side edge of the top plate; and

a second sidewall extending from the second side edge of the top plate;

wherein the snowmobile tunnel includes a distal tapered portion having a tunnel width less than the track width;

wherein the first sidewall and the second sidewall taper from a transition plane to the second distal end;

wherein the second distal end has a tunnel height of less than about 10 millimeters.

8. The snowmobile tunnel of claim 1, further comprising a tunnel bumper extending about the distal tapered portion, the tunnel bumper attached above the top plate at the second distal end to reduce an overall height of the tunnel at the second distal end.

9. The snowmobile of claim 1, wherein the second distal end is proximal a distalmost end of the endless track.

10. A snowmobile to traverse terrain, the snowmobile comprising:

at least one front ski configured to steer the snowmobile; an endless track having a track width and configured to propel the snowmobile; and

a chassis to which the at least one ski and the endless track are coupled to, the chassis including a tunnel partially covering at least a portion of the track, the tunnel including,

a top plate extending along a longitudinal axis from a first proximal end to a second distal end,

the top plate having a first side edge and an opposed second side edge,

a first sidewall extending from the first side edge of the top plate, and

a second sidewall extending from the second side edge of the top plate;

wherein the tunnel includes a distal tapered portion having a tunnel width less than the track width;

8

wherein a first portion of the first side edge and a first portion of the second side edge extends substantially parallel to the longitudinal axis and defines a first tunnel width, wherein a second portion of the first side edge and a second portion of the second side edge each taper toward the longitudinal axis to define a second tunnel width at the second distal end, the second tunnel width being less than the first tunnel width.

11. The snowmobile of claim 10, wherein the second tunnel width is less than the track width.

12. A snowmobile to traverse terrain, the snowmobile comprising:

at least one front ski configured to steer the snowmobile; an endless track having a track width and configured to propel the snowmobile; and

a chassis to which the at least one ski and the endless track are coupled to, the chassis including a tunnel partially covering at least a portion of the track, the tunnel including,

a top plate extending along a longitudinal axis from a first proximal end to a second distal end,

the top plate having a first side edge and an opposed second side edge,

a first sidewall extending from the first side edge of the top plate, and

a second sidewall extending from the second side edge of the top plate;

wherein the tunnel includes a distal tapered portion having a tunnel width less than the track width;

wherein the distal tapered portion extends between a transition plane having the first width and the second distal end having the second width, wherein an intersection plane that intersects the track is between the transition plane and the first distal end.

13. The snowmobile of claim 10, wherein the second distal end is proximal a distalmost end of the endless track.

14. The snowmobile of claim 10, further comprising a tunnel bumper extending about the distal tapered portion, the tunnel bumper attached above the top plate at the second distal end to reduce an overall height of the tunnel at the second distal end.

15. A snowmobile to traverse terrain, the snowmobile comprising:

at least one front ski configured to steer the snowmobile; an endless track having a track width and configured to propel the snowmobile; and

a chassis to which the at least one ski and the endless track are coupled to, the chassis including a tunnel partially covering at least a portion of the track, the tunnel including,

a top plate extending along a longitudinal axis from a first proximal end to a second distal end,

the top plate having a first side edge and an opposed second side edge,

a first sidewall extending from the first side edge of the top plate, and

a second sidewall extending from the second side edge of the top plate;

wherein the tunnel includes a distal tapered portion having a tunnel width less than the track width,

further comprising a tunnel bumper extending about the distal tapered portion, the tunnel bumper attached above the top plate at the second distal end to reduce an overall height of the tunnel at the second distal end;

wherein the tunnel bumper is attached above the top plate with an L-shaped bracket.

16. The snowmobile of claim 10, wherein the first sidewall and the second sidewall taper from a transition plane to the second distal end.

17. A snowmobile to traverse terrain, the snowmobile comprising: 5
at least one front ski configured to steer the snowmobile;
an endless track having a track width and configured to propel the snowmobile; and
a chassis to which the at least one ski and the endless track are coupled to, the chassis including a tunnel partially 10
covering at least a portion of the track, the tunnel including,
a top plate extending along a longitudinal axis from a first proximal end to a second distal end,
the top plate having a first side edge and an opposed 15
second side edge,
a first sidewall extending from the first side edge of the top plate, and
a second sidewall extending from the second side edge of the top plate; 20
wherein the tunnel includes a distal tapered portion having a tunnel width less than the track width,
wherein the distal tapered portion has a length that is about 11% to about 14% of a total length of the tunnel
between the first proximal end to the second distal end. 25

* * * * *