



US006966395B2

(12) **United States Patent**
Schuehmacher et al.

(10) **Patent No.:** **US 6,966,395 B2**
(45) **Date of Patent:** **Nov. 22, 2005**

(54) **SNOWMOBILE WITH A TURBOCHARGED FOUR-STROKE ENGINE**

(75) Inventors: **Bruno Schuehmacher**, Richmond (CA); **Sylvain Matte**, St-Denis de Brompton (CA); **Louis Lefebvre**, Valcourt (CA)

(73) Assignee: **Bombardier Recreational Products Inc.**, Valcourt (CA)

(*) Notice: Subject to any disclaimer, the term of this patent is extended or adjusted under 35 U.S.C. 154(b) by 320 days.

(21) Appl. No.: **09/987,202**

(22) Filed: **Nov. 13, 2001**

(65) **Prior Publication Data**

US 2002/0084125 A1 Jul. 4, 2002

Related U.S. Application Data

(60) Provisional application No. 60/247,052, filed on Nov. 13, 2000.

(51) **Int. Cl.**⁷ **B60K 13/04**

(52) **U.S. Cl.** **180/185; 180/309; 180/68.3**

(58) **Field of Search** 180/9.25, 68.3, 180/185, 180, 309, 190; 123/563

(56) **References Cited**

U.S. PATENT DOCUMENTS

3,849,086	A	*	11/1974	Johnson	48/189.4
3,881,455	A	*	5/1975	Belsanti	123/563
4,249,626	A	*	2/1981	Fields et al.	180/68.1
4,475,617	A	*	10/1984	Minami et al.	180/219
4,565,177	A	*	1/1986	Roettgen et al.	123/563
4,698,761	A	*	10/1987	Cooper et al.	364/424

4,760,703	A	*	8/1988	Minami et al.	60/605.1
4,900,343	A	*	2/1990	Minami et al.	55/318
4,907,552	A	*	3/1990	Martin	123/198 E
5,152,255	A	*	10/1992	Fukuda	123/41.33
5,586,540	A	*	12/1996	Marzec et al.	123/559.1
5,598,065	A	*	1/1997	Lakosky	315/77
5,598,820	A	*	2/1997	Sokoloski	123/306
5,660,245	A	*	8/1997	Marier et al.	180/190
5,846,102	A	*	12/1998	Nitta et al.	440/1
6,089,020	A	*	7/2000	Kawamura	60/618
6,155,374	A	*	12/2000	Uchida	180/309
6,176,082	B1	*	1/2001	Shaffer	60/321
6,216,809	B1	*	4/2001	Etou et al.	180/68.3
6,234,263	B1	*	5/2001	Boivin et al.	180/184
6,286,480	B1	*	9/2001	Chen et al.	123/380
6,293,264	B1	*	9/2001	Middlebrook	123/563
6,390,869	B2	*	5/2002	Korenjak et al.	440/88
6,415,759	B2	*	7/2002	Ohrnberger et al.	123/195
6,454,037	B1	*	9/2002	Atsuumi et al.	180/190
6,508,211	B1	*	1/2003	Asano	123/41.1
6,510,912	B1	*	1/2003	Atsuumi	180/69.1
6,547,021	B1	*	4/2003	Kai et al.	180/190
6,561,297	B2	*	5/2003	Yatagai et al.	180/190
6,592,415	B2	*	7/2003	Berthiaume	440/88 A
6,651,765	B1	*	11/2003	Weinzierl	180/190
2002/0027029	A1	*	3/2002	Yatagai et al.	180/190

* cited by examiner

Primary Examiner—Matthew Luby

(74) *Attorney, Agent, or Firm*—BRP Legal Services

(57) **ABSTRACT**

A snowmobile is provided that includes a frame, an engine, an endless belt drive system, and an air intake system for the engine. The frame has a forward portion and an aft portion. The engine is mounted to the forward portion and the belt drive system is mounted to the aft portion and is operatively connected to the engine. The engine is a turbocharged four-stroke type engine.

29 Claims, 16 Drawing Sheets

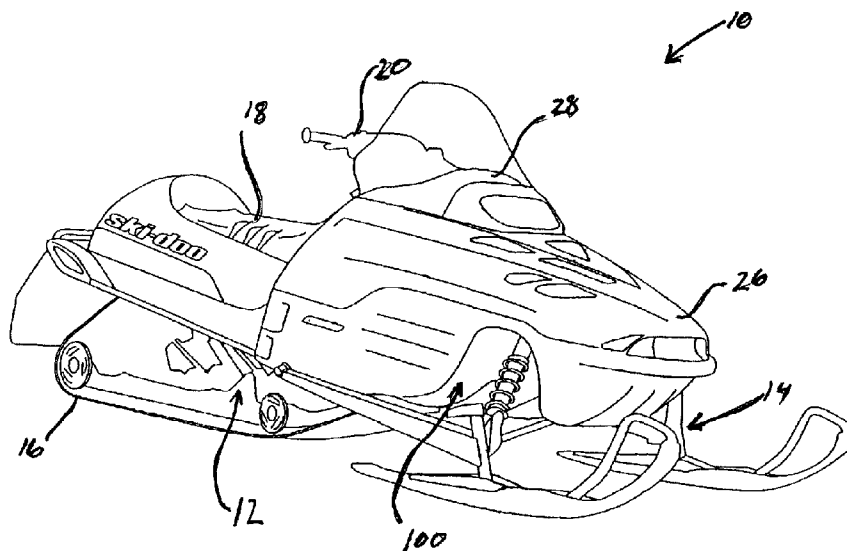

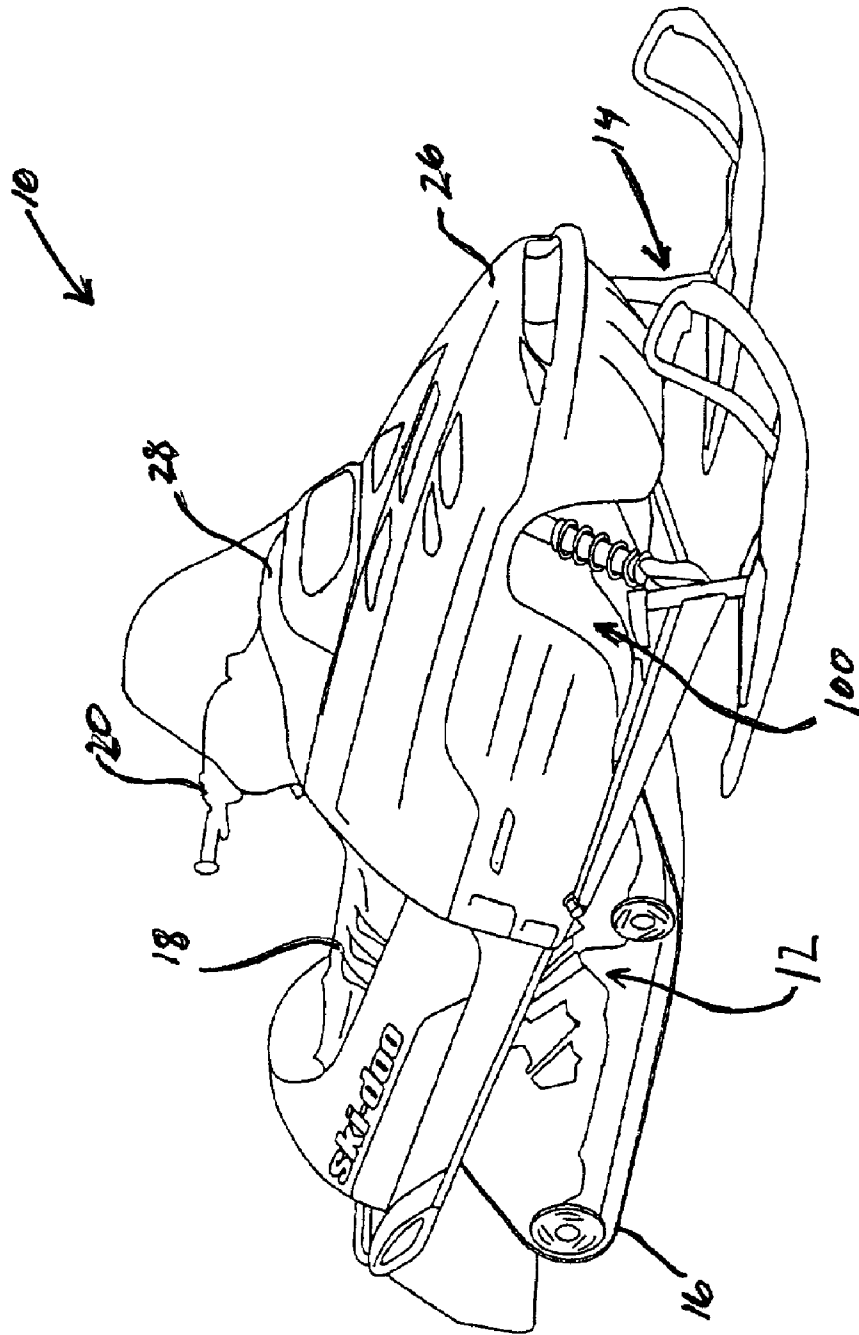

Figure 1

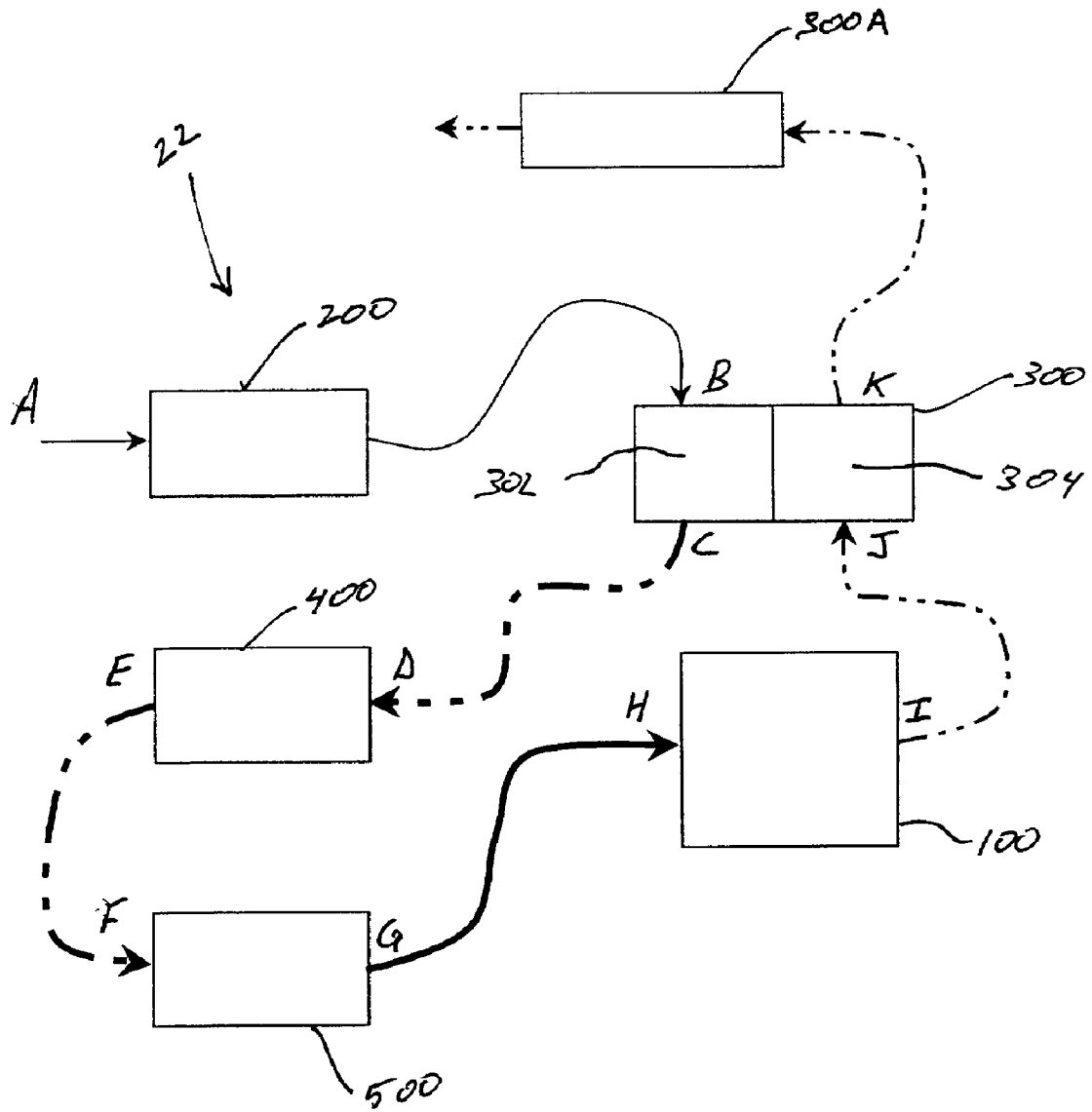

Figure 2

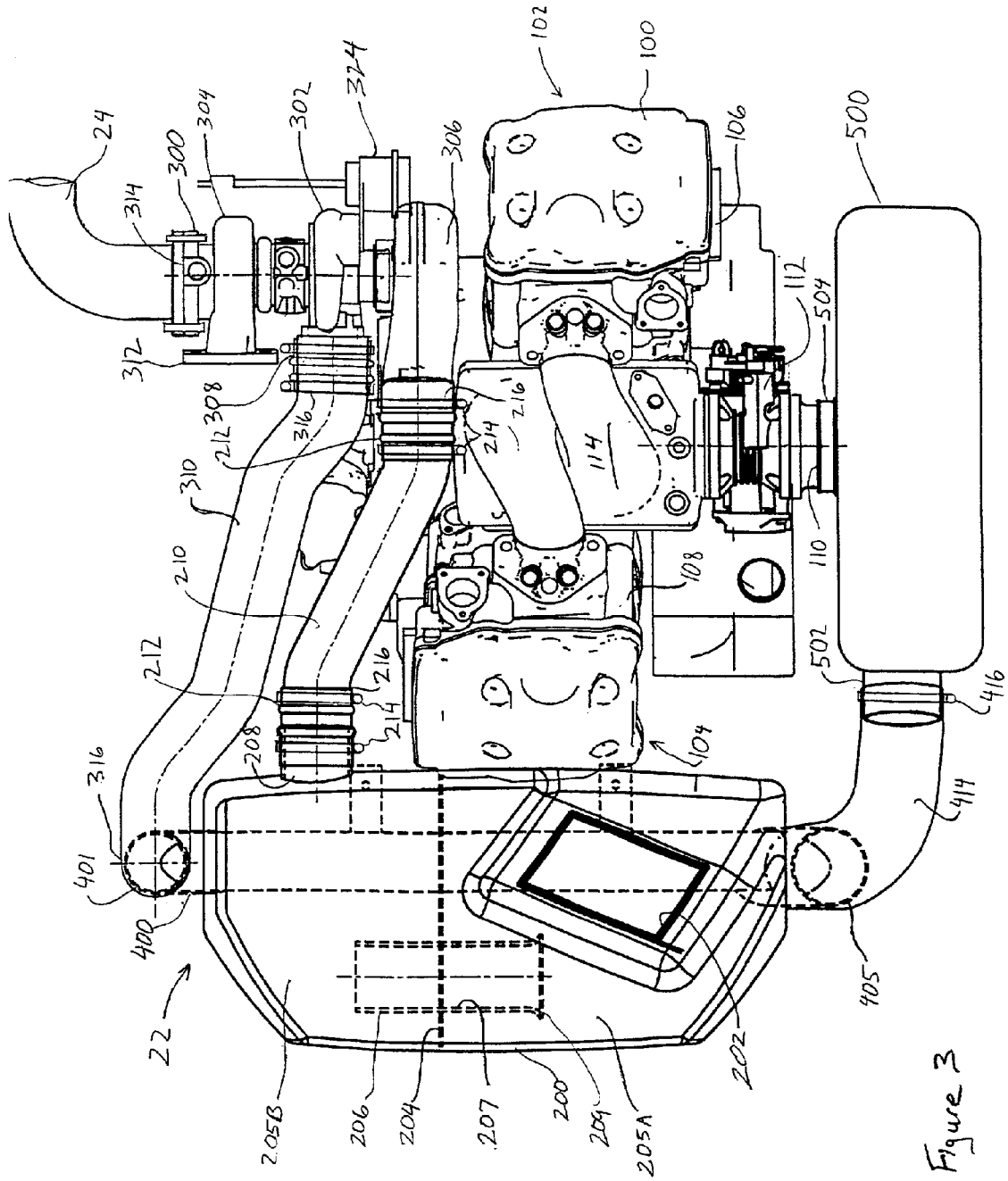

Figure 3

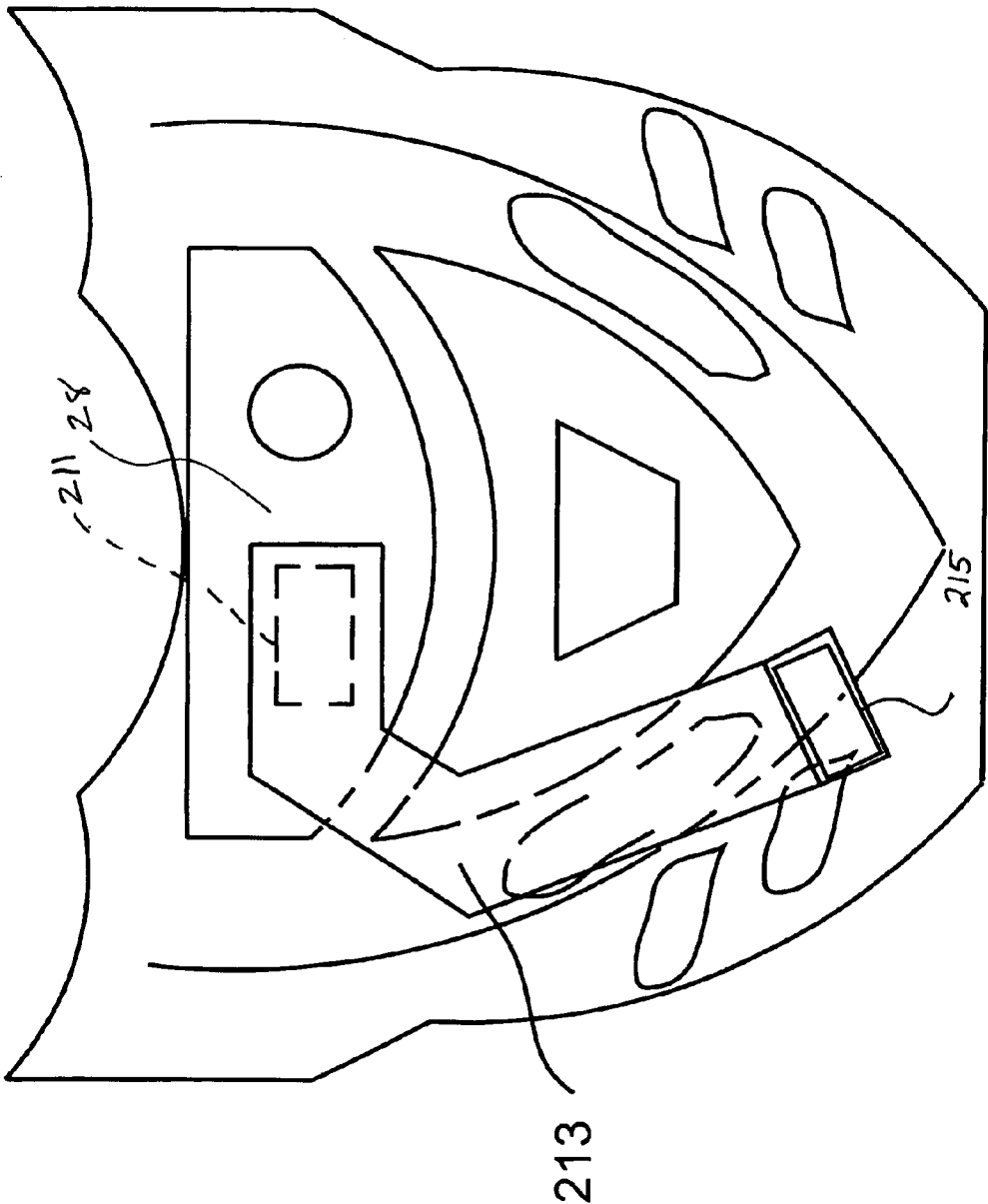

FIGURE 4

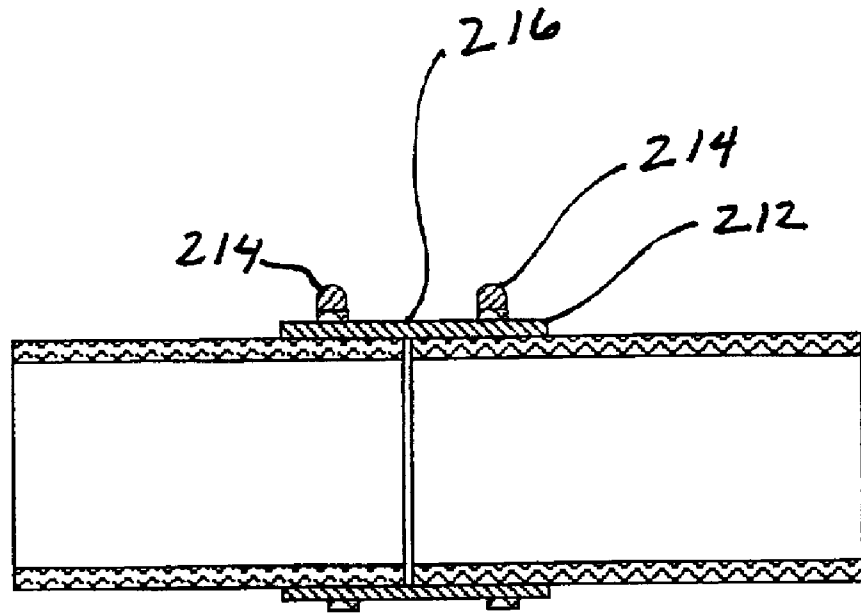

Figure 5

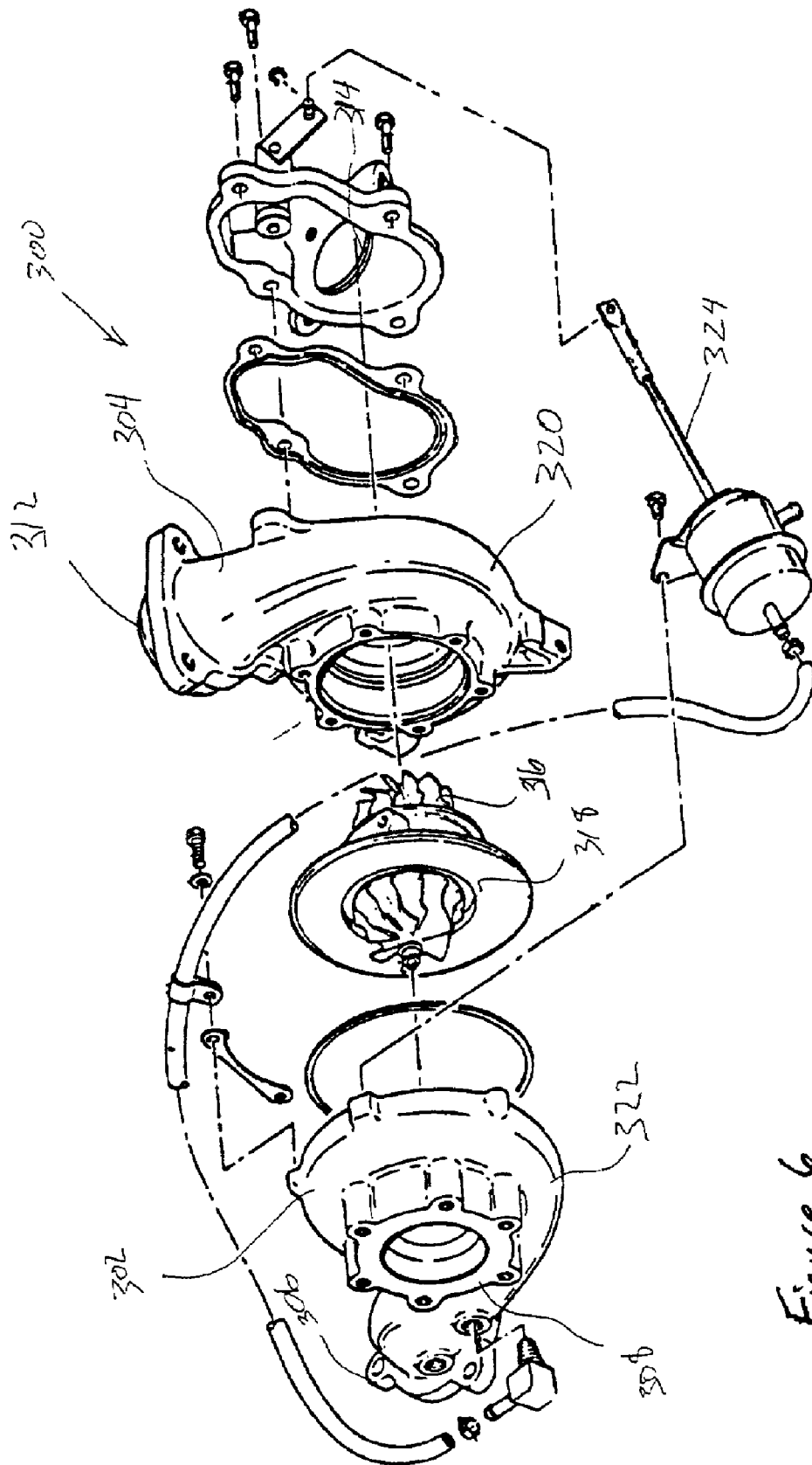

Figure 6

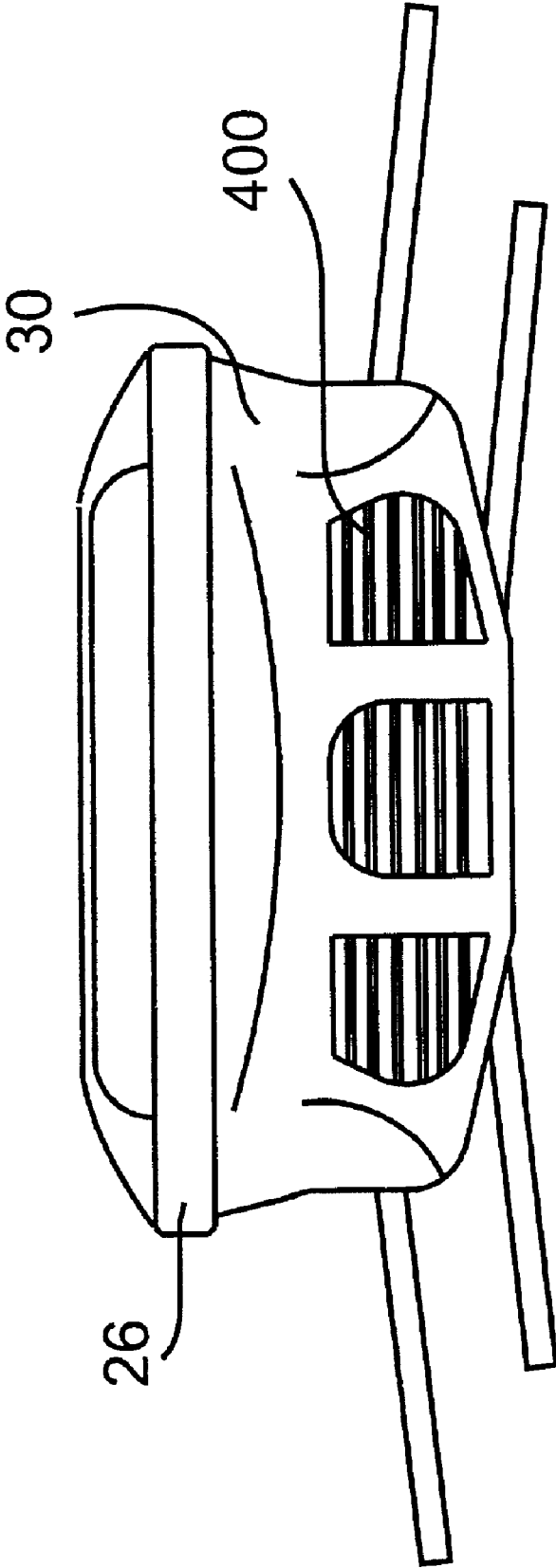

FIGURE 7

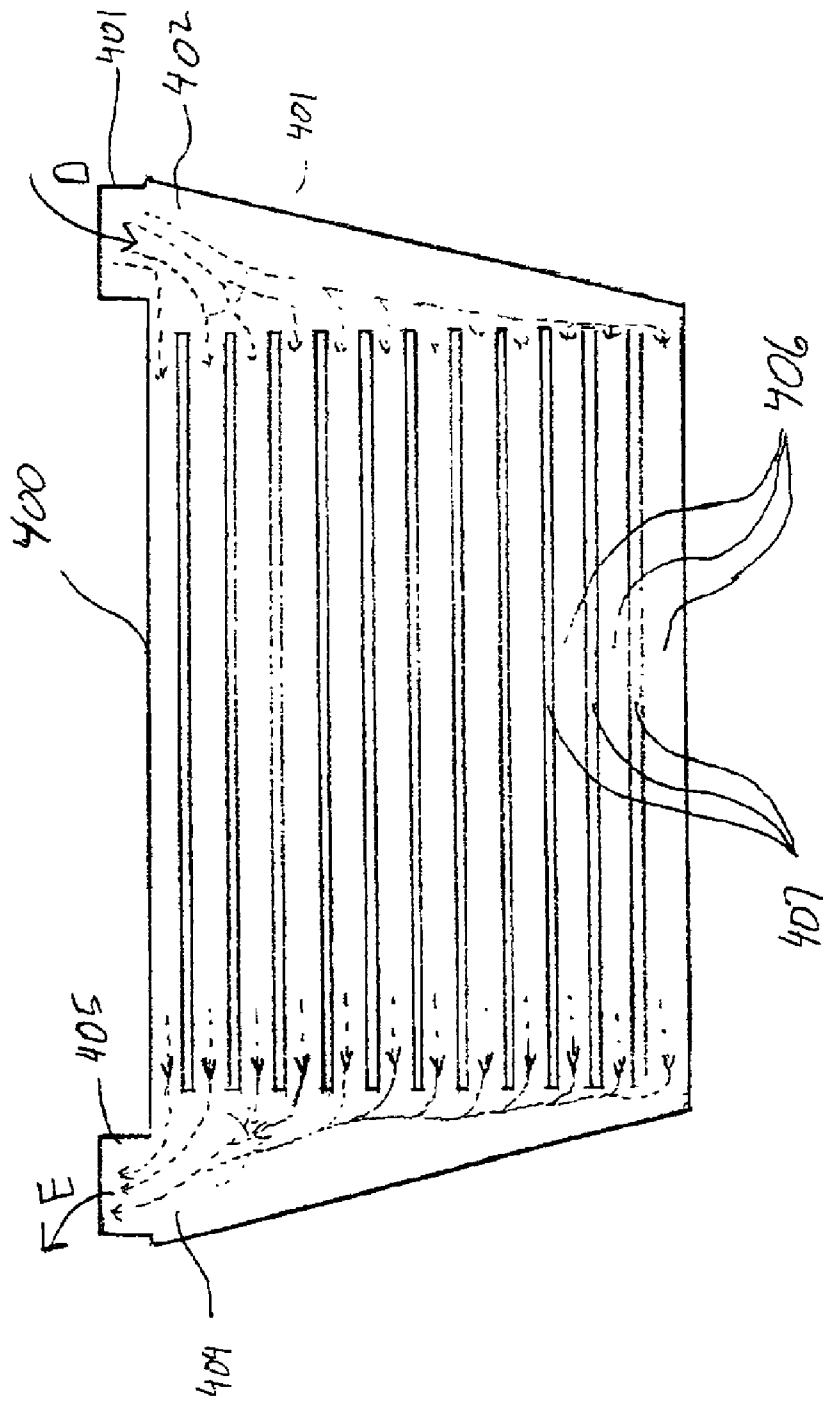

Figure 8

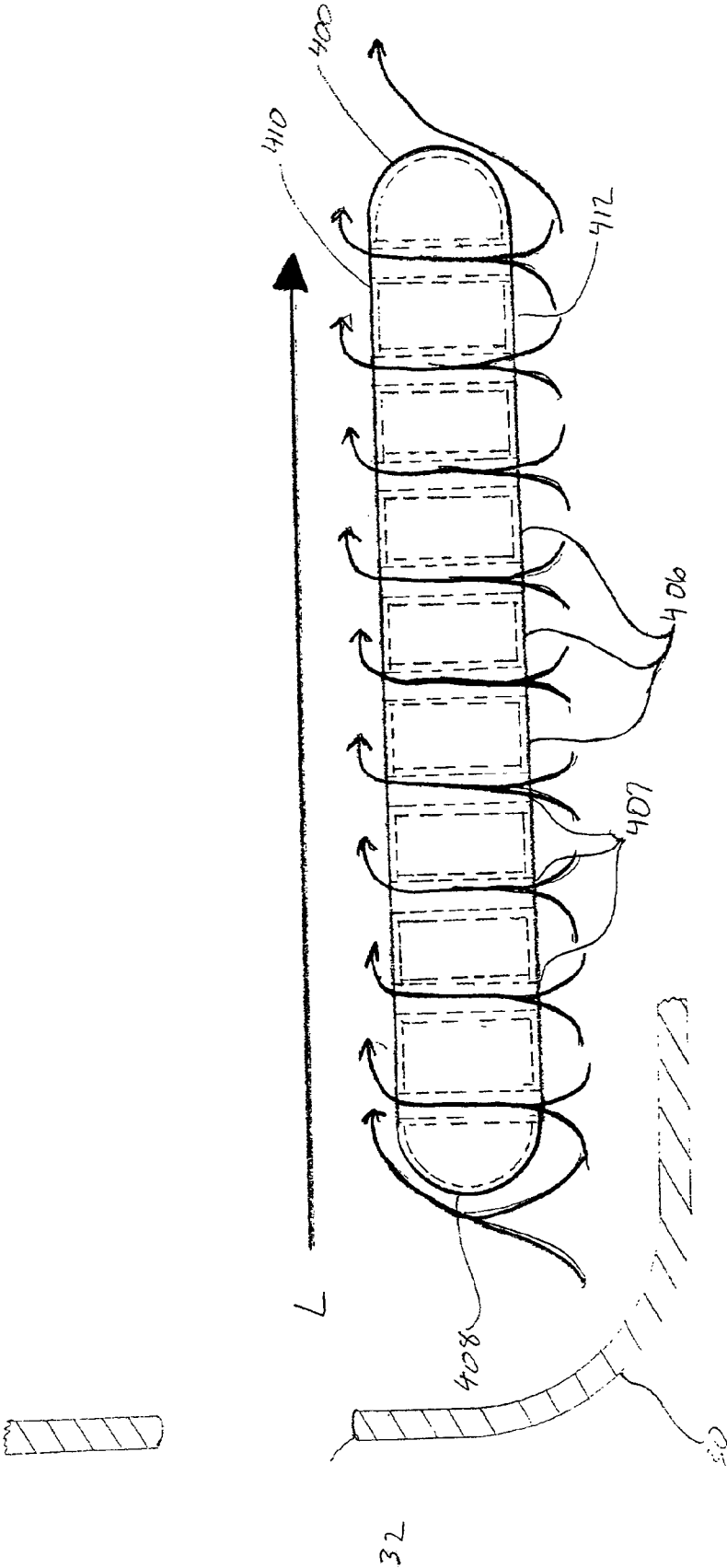

Figure 9

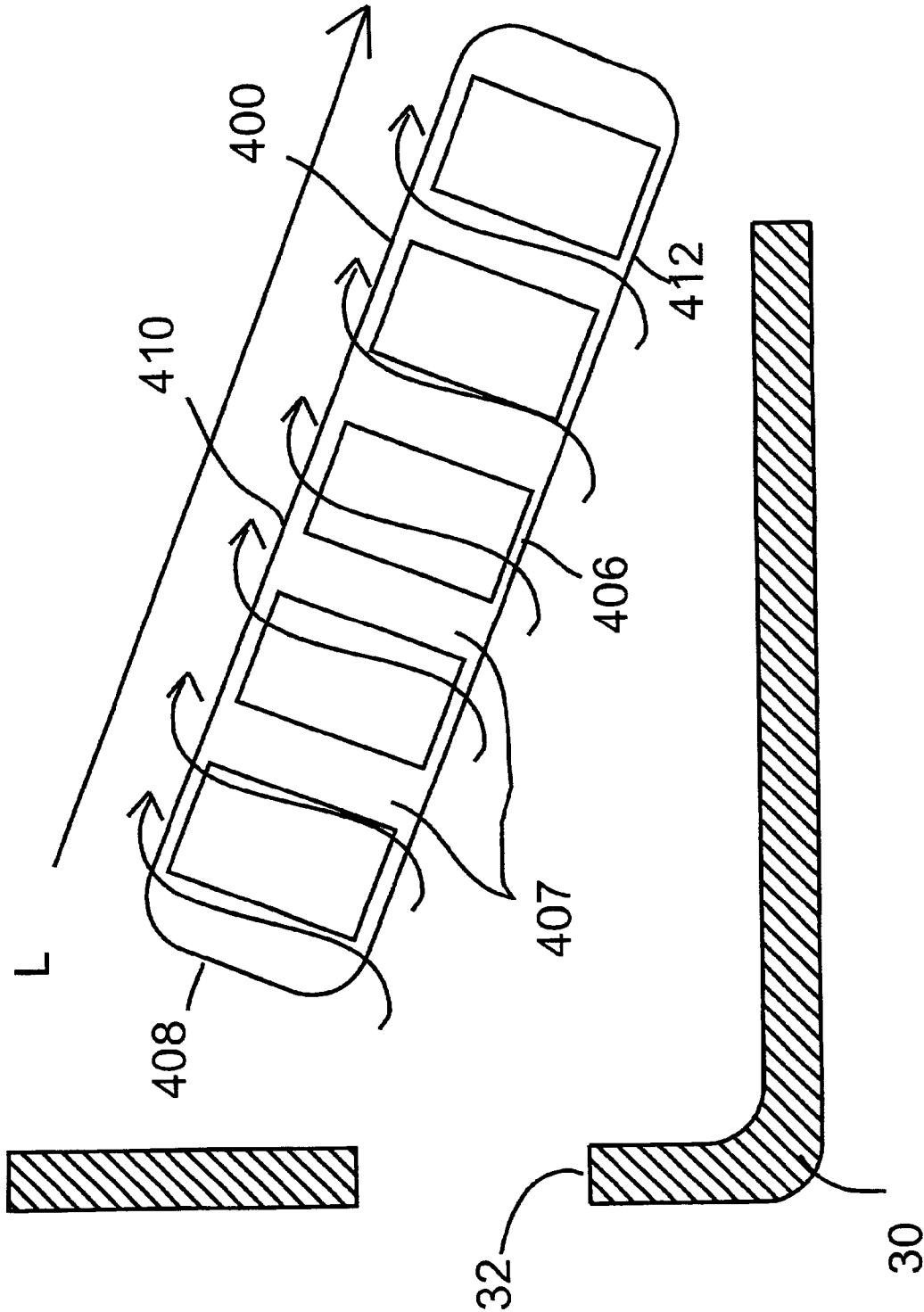

FIGURE 10

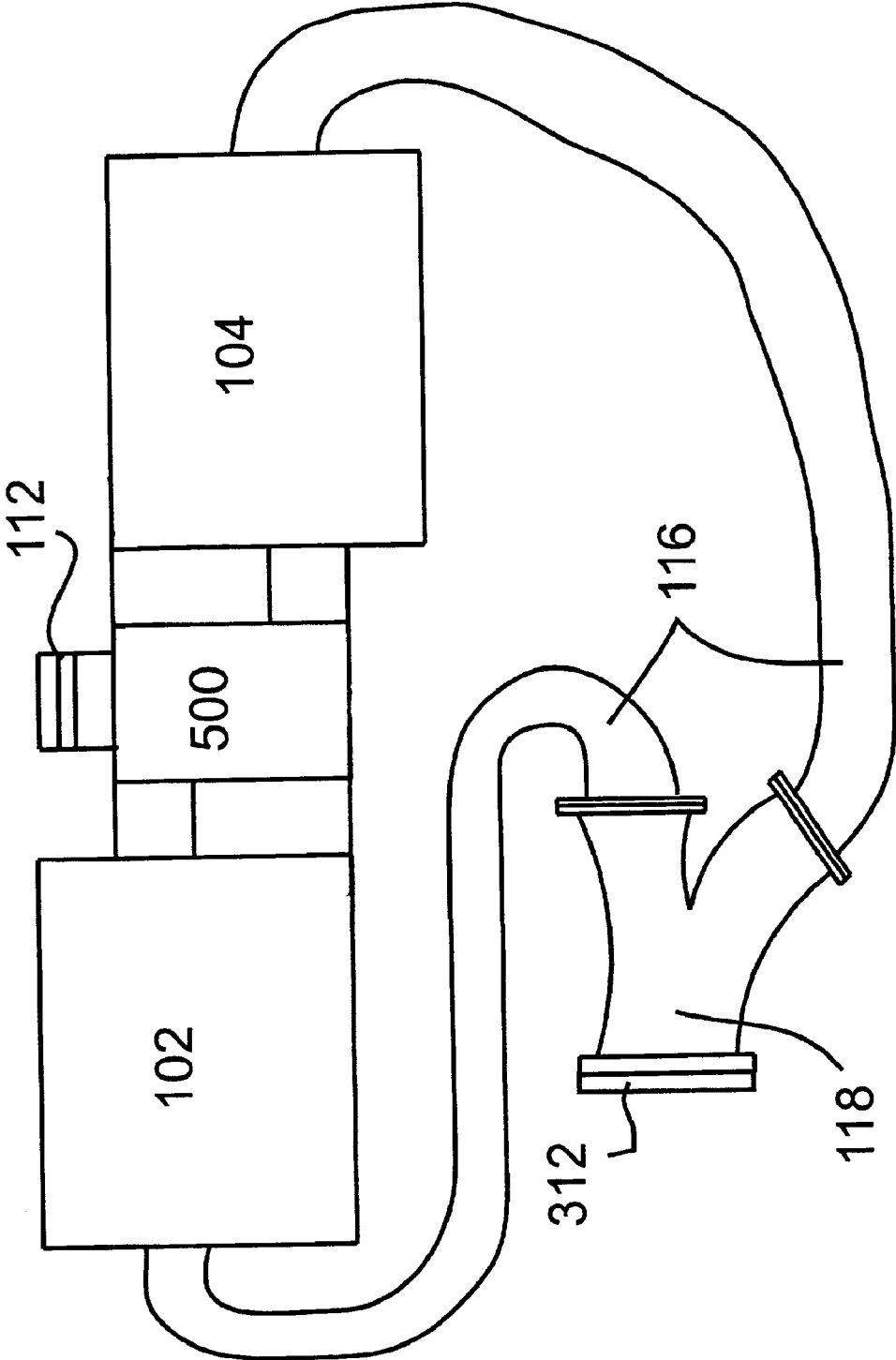

FIGURE 11

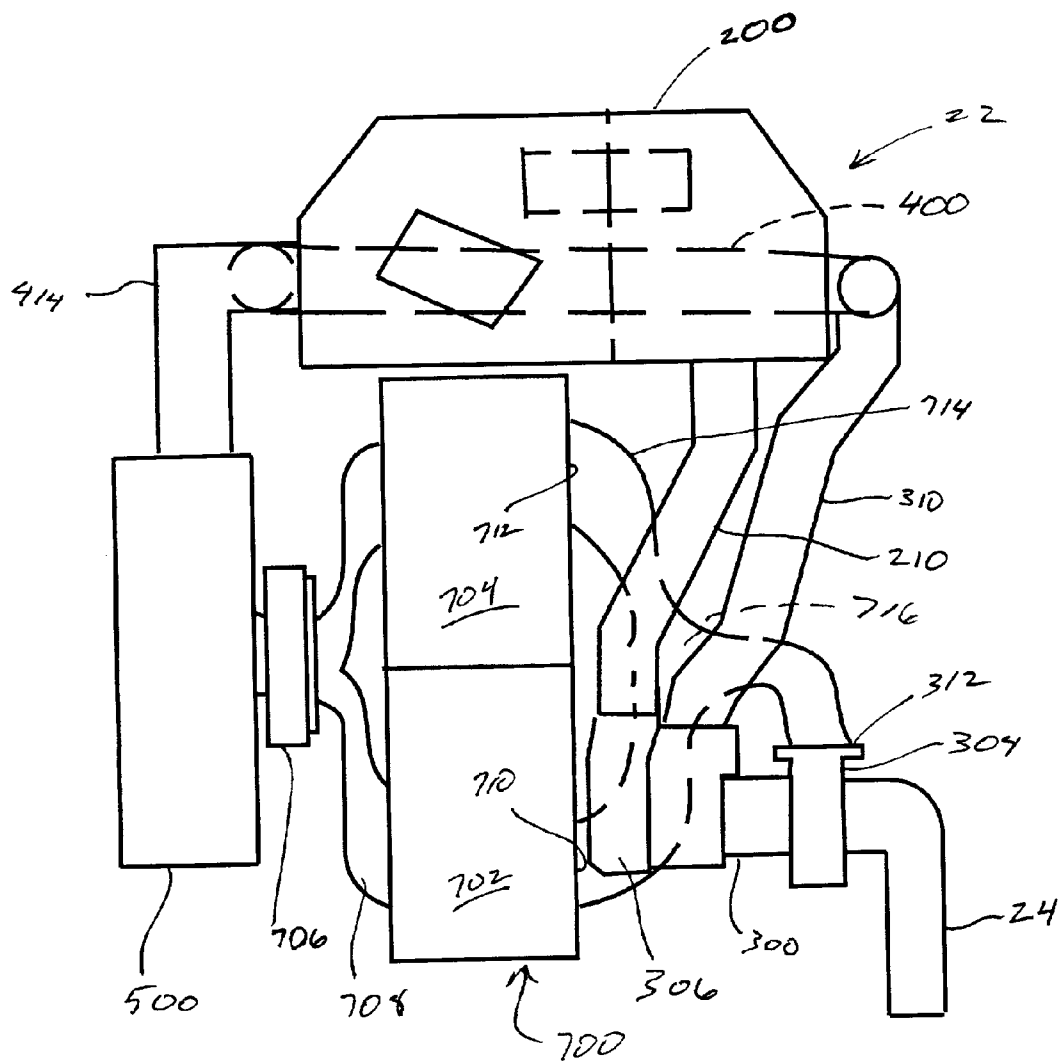

Figure 12

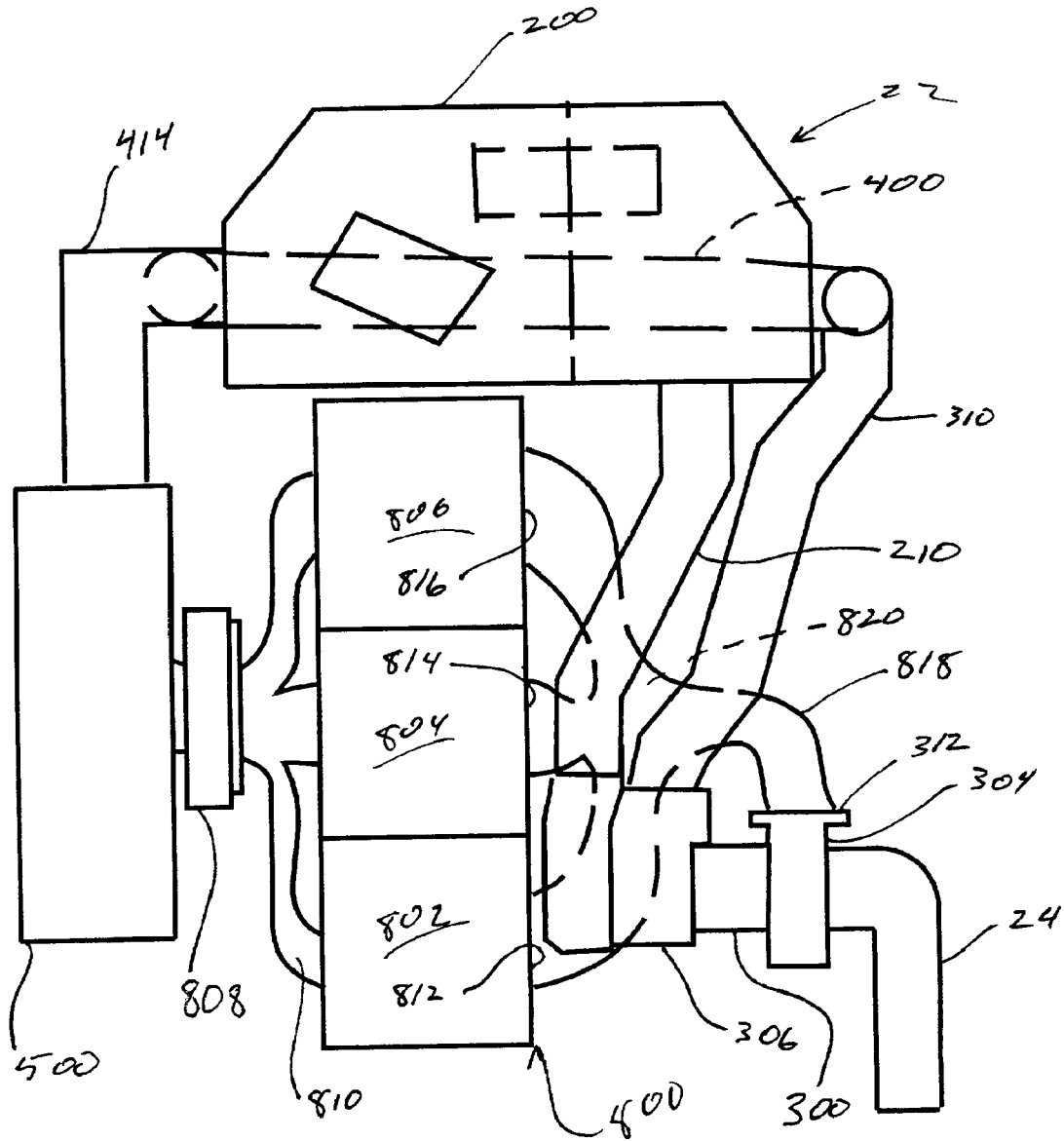

Figure 13

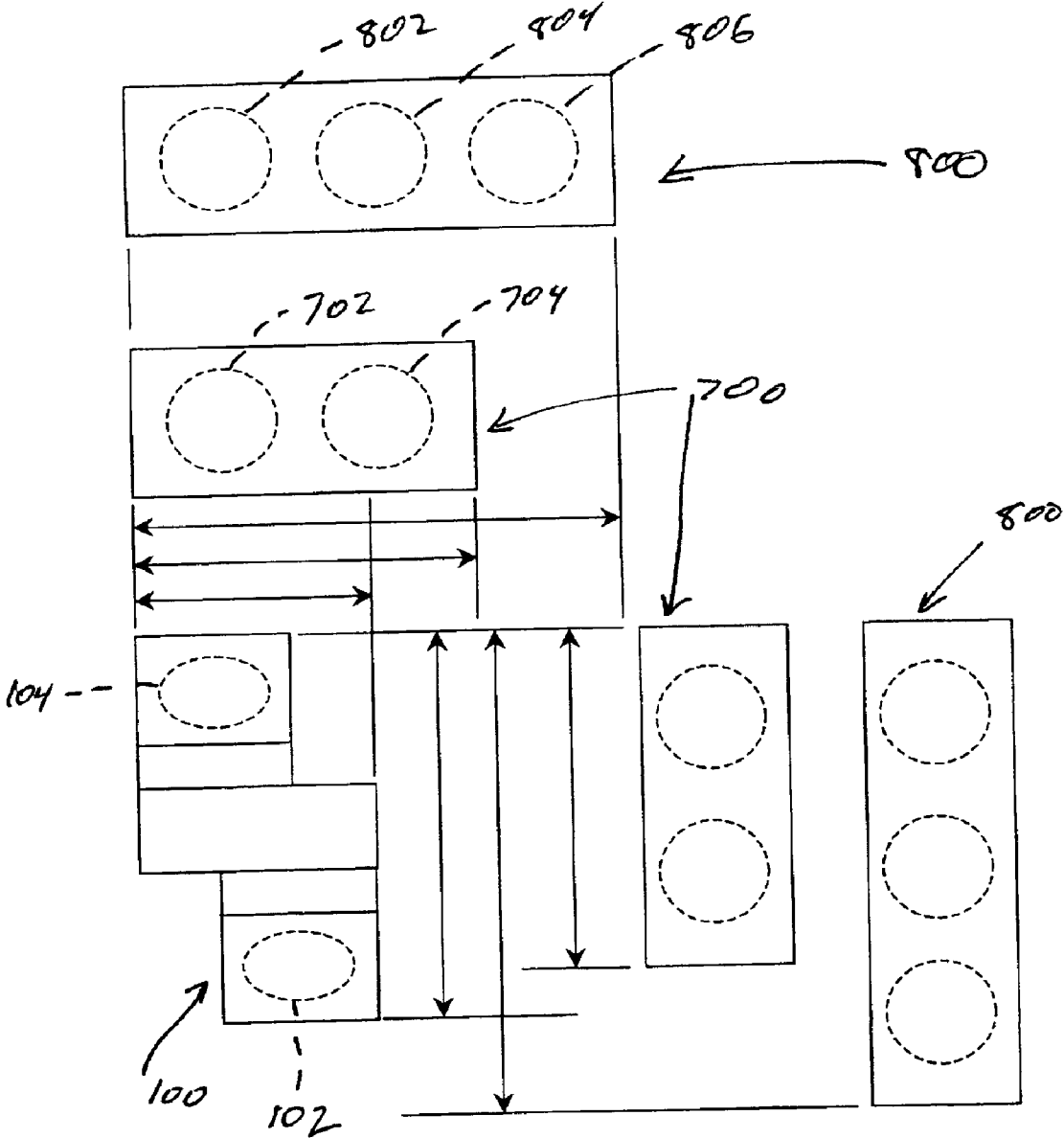

Figure 14

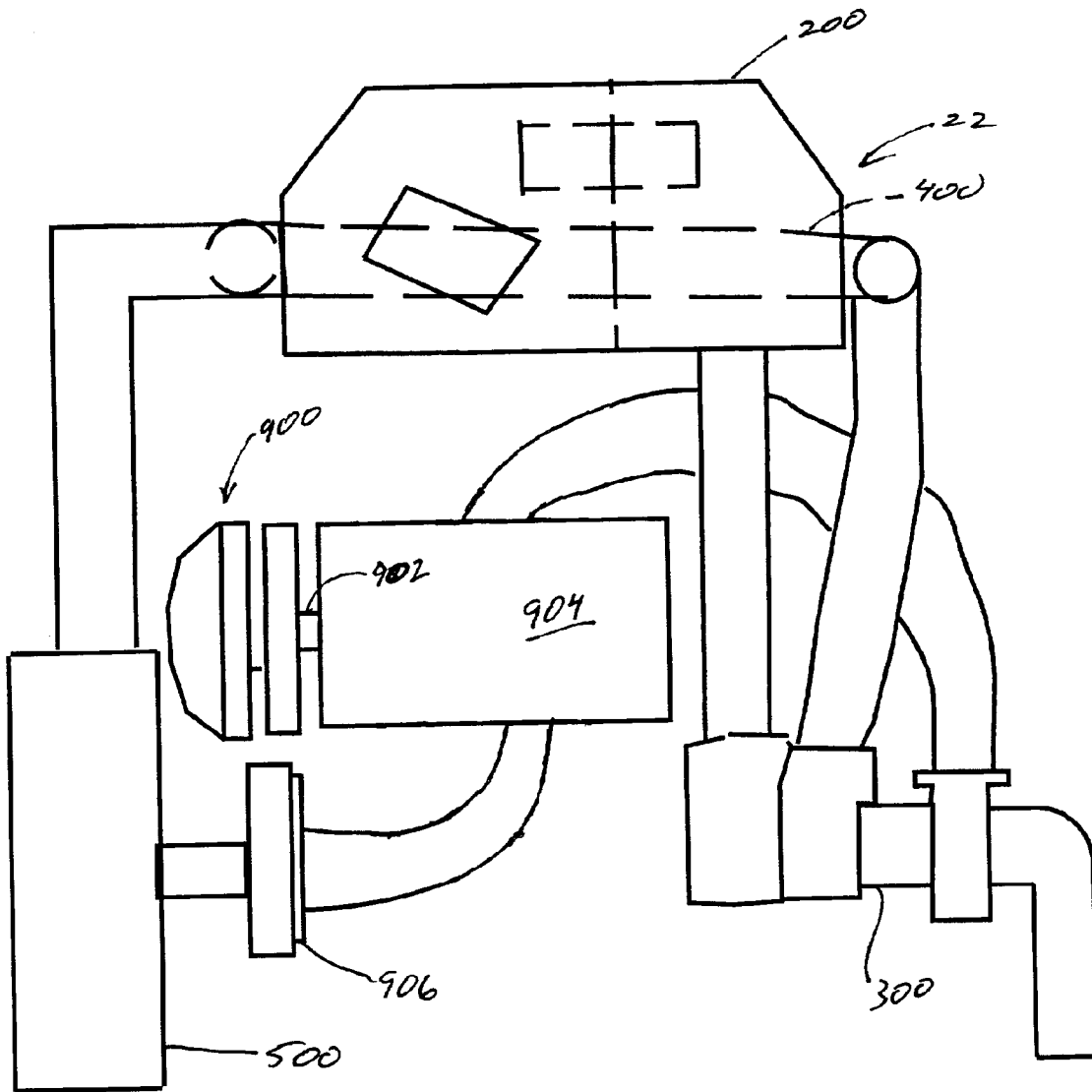

Figure 15

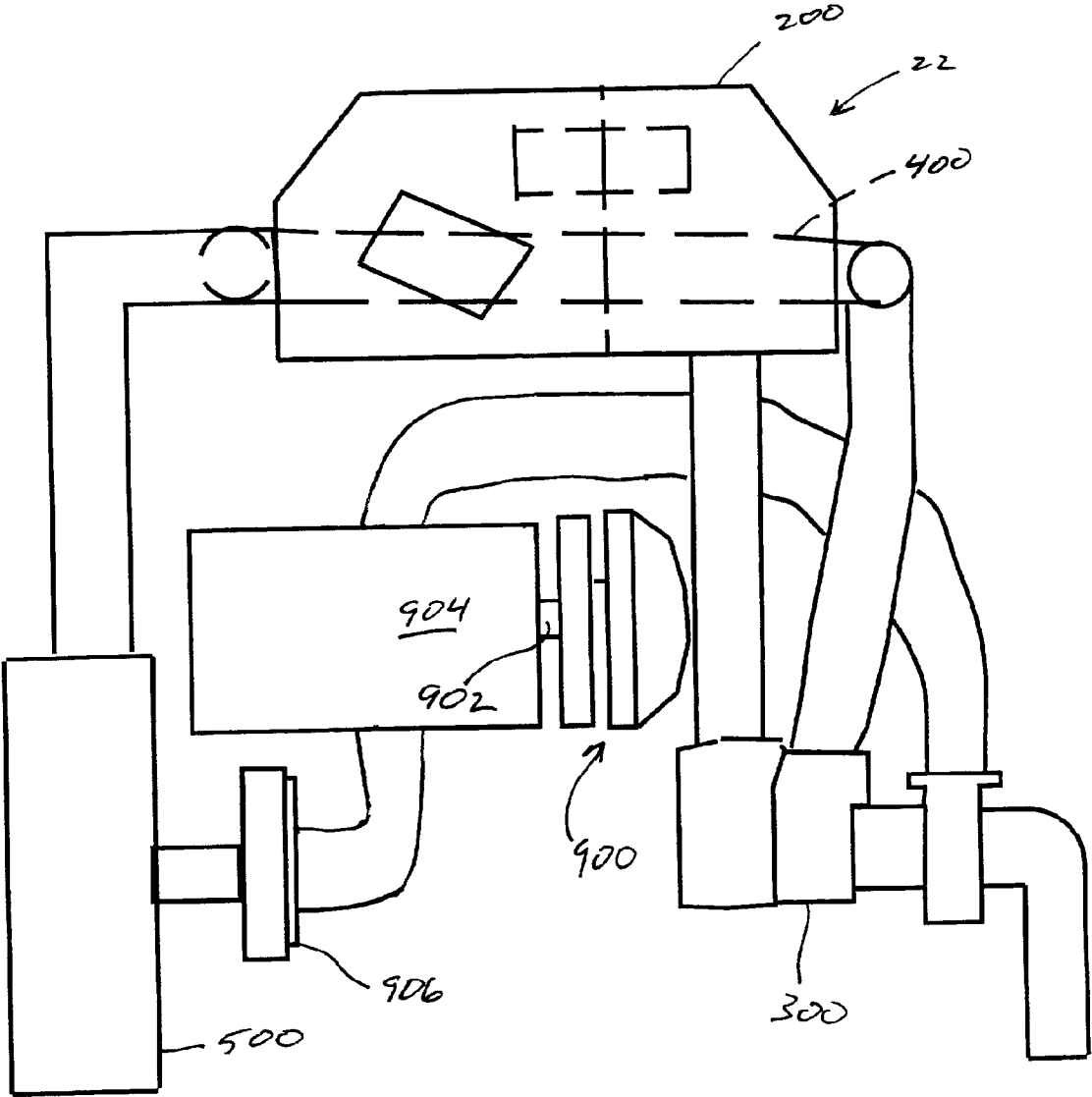

Figure 16

SNOWMOBILE WITH A TURBOCHARGED FOUR-STROKE ENGINE

This application claims priority to U.S. application Ser. No. 60/247,052, filed Nov. 13, 2000.

FIELD OF THE INVENTION

The present invention relates, generally to snowmobiles, and more particularly, to a snowmobile with a turbocharged four-stroke engine.

BACKGROUND OF THE INVENTION

Snowmobiles have traditionally used two-stroke type engines for power generation. Two-stroke type engines generally provide relatively high power-to-weight and power-to-size ratios, which are extremely desirable characteristics in an engine for a snowmobile. Other highly desirable characteristics of two-stroke engines in regards to snowmobiles include the relative simplicity of these types of engines and the relative ease of integration with systems, aided by the relatively high power-to-weight and power-to-size ratios of these engines.

However, recently there has been a trend to decrease exhaust emissions from internal combustion engines, especially two-stroke engines, due to environmental concerns and an increase in regulations related thereto. Generally, two-stroke engines inherently have higher exhaust emissions than their four-stroke counterparts due to: 1) the necessity of opening the exhaust ports subsequent to complete ignition of the fuel/air mixture, 2) unburned fuel escaping the exhaust port during the intake charging of the cylinder, and 3) lubrication oil mixing with the intake charge.

Lower emissions-producing four-stroke engines have generally not been used with snowmobiles due to the relatively lower power-to-weight/size ratios of these types of engines. Snowmobile performance is extremely sensitive to increases in weight and the relative compact chassis and body of a snowmobile limits the space available for the engine. Additionally, four-stroke engines can be relatively more difficult to integrate into vehicles, such as a snowmobile, due to the engine's relative complexity.

It is known outside the art of snowmobiles to use a turbocharger in conjunction with a four-stroke engine to increase the power output and fuel efficiency of the engine. However, a turbocharged V-twin engine has not previously been considered feasible for utilization with a snowmobile.

SUMMARY OF THE INVENTION

The present invention avoids these limitations in the prior art by providing a snowmobile comprising a frame, an engine, an endless belt drive system and an air intake system for enhancing performance of the engine. The frame of the snowmobile has a forward portion, with the engine mounted thereto, and an aft portion. The belt drive system is mounted to the aft portion of the frame and is operatively connected to the engine.

The engine is a four-stroke type with at least one cylinder arranged in an inline or V-twin configuration. Each cylinder includes a respective combustion chamber and the engine has an air inlet and an exhaust outlet communicating with each of the combustion chambers.

The snowmobile of the present invention further comprises an air intake system including an air box communicating with the atmosphere. The air box is a substantially

hollow enclosed structure. A turbocharger is connected to the air box such that air from the air box may enter the turbocharger. The turbocharger communicates with the exhaust outlet and is constructed and arranged such that a flow of exhaust gases from the exhaust outlet through the turbocharger affects a pressurization of air therein. The pressurization of the air within the turbocharger relatively increases the temperature of the air therein. The pressurization amplitude of the air pressurized within the turbocharger is cyclical in amplitude with respect to a cyclical flow of exhaust gases thereto from the exhaust outlet. A heat exchanger formed of a heat conductive material is connected to the turbocharger such that the pressurized air from the turbocharger may enter therein. The heat exchanger is constructed and arranged such that heat from the pressurized air is dissipated therefrom to the atmosphere via the heat conductive material. A plenum is connected to the heat exchanger such that air from the heat exchanger may enter the plenum. The plenum is also connected to the air inlet and is constructed and arranged such that the cyclically pressurized amplitude of the air from the turbocharger via the heat exchanger may collect therein such that the pressurization amplitude of the air upon exiting the plenum and entering the air inlet is moderated.

Other aspects, features and advantages of the present invention will become apparent from the following detailed description, the accompanying drawings, and the appended claims.

BRIEF DESCRIPTION OF THE DRAWINGS

FIG. 1 is a perspective view of a snowmobile embodying the principles of the present invention;

FIG. 2 is a schematic view of the air intake system of the present invention showing relative gas pressures with bold lines;

FIG. 3 is a schematic view of one embodiment of the engine and air intake system of the present invention;

FIG. 4 is a bottom plan view of an upper portion of the snowmobile shown in FIG. 1;

FIG. 5 is a sectional view of a fastening device;

FIG. 6 is an exploded view of one type of turbocharger;

FIG. 7 is a front plan view of the forward portion of the snowmobile shown in FIG. 1;

FIG. 8 is a front elevational view of the heat exchanger showing pathways of air flow therethrough in phantom;

FIG. 9 is a side view of the heat exchanger in a horizontal arrangement showing air entrainment;

FIG. 10 is a side view of the heat exchanger in an angled arrangement showing air entrainment;

FIG. 11 is a schematic view of a V-twin engine and exhaust conduit connected thereto;

FIG. 12 is a schematic view of a two cylinder, in-line engine equipped with an air intake system and turbocharger according to the principles of the present invention;

FIG. 13 is a schematic view of a three cylinder, in-line engine equipped with an air intake system and turbocharger according to the principles of the present invention;

FIG. 14 is a schematic view of a V-twin engine, two cylinder in-line engine, and a three cylinder in-line engine with relative dimensions indicated; and

FIGS. 15 and 16 are schematic views of an engine with a CVT in different arrangements.

DETAILED DESCRIPTION OF THE INVENTION

FIG. 1 shows a snowmobile 10 embodying the principles of the present invention. As shown, snowmobile 10 has a

tunnel or frame **12**, a steering assembly **14** and an endless belt drive system **16** mounted to an aft end portion of the frame **12**. Snowmobile **10** utilizes an internal combustion engine indicated at **100** to provide power generation thereto. Engine **100** is operatively connected to the belt drive system **16** to provide movement of the snowmobile **10**. The snowmobile **10** additionally includes a seat **18** whereon a driver and rider may be positioned in a seated manner thereon. A steering control assembly **20** is located forward of the seat **18** and is operatively coupled to steering assembly **14** so as to provide a steering capability to snowmobile **10**.

It is preferable for the engine **100** of the present invention to be a four-stroke type internal combustion engine. Advantages of this type of engine, as will be described herein below, include lower hydrocarbon emissions. However, several characteristics of four-stroke engines have previously rendered this type of engine unfeasible for use in a snowmobile. As such, the present invention is also directed toward an air intake system for the snowmobile **10** with a four-stroke engine.

An air intake system of the present invention is shown schematically in FIG. **2** at **22**. As shown in FIG. **2**, air from the atmosphere enters an air box or passage **200** at A, flows therethrough and enters a turbocharger **300** at B. Within the turbocharger **300**, the air is pressurized, as well as heated due to the rapid pressurization and heat conduction from the engine's exhaust such that at an exit point C the temperature and pressure of the air exiting the turbocharger **300** are greater than a pressure and temperature of the air entering the turbocharger at B. The heated and pressurized air then flows to an entrance D of a heat exchanger **400** (commonly referred to as an intercooler). The heat exchanger **400** is constructed and arranged to remove heat from the pressurized air such that at an exit point E, the temperature of the air is less than the temperature of the air at the entrance point D. As will be described below in more detail, the turbocharger **300** additionally adds a pulsed amplitude signature to the air being pressurized (and heated) therein. Upon exit from the heat exchanger at E, the air then flows to an entrance F of a plenum **500**. The plenum **500**, as will be described below, forms a voluminous enclosure that significantly reduces the pulsed signature from the amplitude of the pressurized air. The pressurized air then exits the plenum at G and enters the internal combustion engine at H. Further shown in FIG. **2**, exhaust gases exit the internal combustion engine **100** at I and enter the turbocharger **300** at J. As will be described below, the exhaust gases entering the turbocharger **300** affect the compression of the air entering the turbocharger **300** at B, as well as introduce the pulsed nature of the pressurized air exiting the turbocharger at C. The exhaust gases then exit the turbocharger **300** at K and exit the snowmobile through an exhaust system **24** described below.

FIG. **3** shows an exemplary arrangement of the air intake system **22** shown in FIG. **2**. As shown, air box **200** is situated proximate a forward end **26** of snowmobile **10** and is mounted to a forward portion thereof. The air box **200** is shown relatively forward of engine **100** and adjacent thereto. In the illustrated embodiment shown in FIG. **3**, the turbocharger **300** is positioned on a starboard side of the engine **100** and adjacent thereto. Shown in FIG. **3**, the heat exchanger **400** is positioned at the forward end **26** beneath the air box **200**. The plenum **500** is located on a port side of the engine **100** and is operatively connected thereto.

As shown in FIG. **3**, air box **200** is essentially a hollow voluminous structure. The air box **200** includes an inlet **202**, which communicates with the atmosphere surrounding the

snowmobile **10**. It is preferable for the air box **200** to include one or more interior walls **204** that divide the interior periphery of the air box **200** into two or more chambers. FIG. **3** shows two such chambers, indicated at **205A** and **205B**. It is preferable for the chambers **205A** and **205B** to be interconnected by one or more baffles **206** such that air may flow through the inlet **202** through the baffle **206** and exit the air box **200** from an outlet **208**. The baffle **206**, as illustrated, may be in the form of a tubular member protruding through the interior wall **204** providing an air path **207** therethrough. It is noted that the baffle **206** may also be in the form of an opening within the interior wall **204** providing the air path **207** therethrough. It is contemplated that each chamber of the air box **200** may communicate with adjacent chambers by one or more baffles **206**. It is noted that the baffles **206** are preferable to reduce intake roar from the engine. The baffles **206** should be configured so as to minimize flow resistance of the air traveling therethrough. It is contemplated that by increasing the breadth of the air path **207** within each baffle, flow resistance may be reduced. It is further contemplated that a flared portion **209** may be formed on the incoming air side of each baffle to reduce flow resistance of air through the baffles. A duct member or conduit **210** extends from outlet **208** to the turbocharger **300**.

It is preferable for the inlet **202** to be positioned as far as possible from the engine **100** and exhaust system **24**, such that the coolest air possible may be allowed to enter the inlet **202**. For this reason, and to prevent the intake of snow, an inlet opening **211** (shown in FIG. **4**) may be located within an upper portion **28** of the snowmobile **10** (shown in FIGS. **1** and **4**) proximate the steering control assembly **20**. It is contemplated that for the embodiment illustrated in FIG. **3**, the inlet **202** of the air box **200** may communicate with the inlet opening **211** with a heat-shielded duct or conduit shown in FIG. **4** at **213**. The shielded duct **213** allows cool atmospheric air to travel from the vent structure to the inlet **202** without gaining significant heat from the engine **100** and exhaust system **24**. As shown in FIG. **4**, it is preferable for a seal **215** to be provided between the duct **213** and the inlet **202** to prevent air leakage therebetween. It is also contemplated, however that the air box **200** may be positioned aft of the engine **100** such that the inlet **202** may directly communicate with the inlet opening **211** or such that a relatively shorter length of heat-shielded duct **213** may be necessary. A filter (not shown) may be positioned at inlet **202** or the inlet opening **211** within the air flow to screen or prevent particles from entering the air box **200**.

As shown in FIG. **3**, the turbocharger **300** communicates with the outlet **208** of the air box **200** via conduit **210**. Conduit **210** is preferably a rigid metallic tubular member with a configuration that allows a relatively direct path from the outlet **208** to the turbocharger **300**. It is contemplated that the configuration of the conduit **210** may include one or more bends to accommodate positioning of various engine or snowmobile components and the relative positions of the outlet **208** and turbocharger **300**. It is also contemplated that the conduit **210** may have a flexible metallic configuration or may be formed of plastic material. However, due to the heat present at the relative proximity of the engine **100**, it is preferable for the conduit **210** to be relatively resistant to high-heat environments. As shown in FIG. **3**, the conduit **210** is secured at each end to the outlet **208** and the turbocharger **300** with a fastening device **212**.

FIG. **5** shows the fastening device **212** in more detail. As shown, the fastening device **212** may include one or more circular clamps **214** and a flexible member **216**. The flexible member **216** has a configuration that allows it to be disposed

around the outlet **208** on one end and an associated end portion of the conduit **210** on an opposite end. The circular clamps **214** are then secured around the flexible member **216** proximate each end thereof to thereby secure the flexible member **216** to each of the outlet **208** and the conduit **210**. It is preferable for the fastening device **212** to include the flexible member **216** to allow relative vibrational movement between each of the outlet **208**, conduit **210** and the turbocharger **300** to prevent fatigue stress and possible cracking of any of these parts or the fastening device **212** itself, as may occur with a rigid connection at these points due to vibrations caused by the engine **100** and movement of the snowmobile **10**.

Referring back to FIG. **3**, the turbocharger **300** includes a compressor portion **302** and a turbine portion **304**. The compressor portion **302** has an inlet **306** which is connected to conduit **210**, as described above, and has an outlet **308** that is connected to a duct or conduit **310**, similarly to the connection between the conduit **210** and the inlet **306**. Turbine portion **304** includes an inlet **312** and an outlet **314**. As stated previously, the turbocharger **300** utilizes energy provided by the exhaust (generated by the engine **100**) to compress (pressurize) air from the atmosphere. FIG. **6** shows one type of turbocharger that may be used for the intake system **22**. As shown, a turbine structure **316** is connected to a compressor structure **318**. For the type of turbocharger shown in FIG. **6**, turbine structure **316** and compressor structure **318** are integral. However, it is noted that any other type of turbocharger may be used, including types that have separate turbines and compressors that are linked, for example by a rigid shaft that extends therebetween.

For the turbocharger shown in FIG. **6**, the turbine structure **316** is connected to compressor structure **318** so as to rotate in unison therewith. A turbine housing **320** is configured to direct the exhaust gases from the engine onto the turbine structure **316** in a tangential direction to produce rapid rotational movement thereof. The exhaust gases are then expelled from the turbine portion **304** through outlet **314** and flow into the exhaust system **24**. As the turbine structure **316** rotates, the compressor structure **318** rotates simultaneously therewith. A compressor housing **322** cooperates with the compressor structure **318** to draw air from the air box **200** into the compressor portion **302**. The compressor structure **318** is configured to compress the air within the compressor portion **302** and directs the pressurized air out of the compressor outlet **308**.

A waste gate, or bypass valve **324**, shown in FIGS. **3** and **6**, is operatively linked to turbine housing **320**. The turbine housing **320** provides an alternate flow path from the turbine inlet **312** to the turbine outlet **314**, while the waste gate **324** allows a predetermined volume of exhaust gas to bypass the turbine structure **316** from the turbine inlet **312** and discharge out of the turbine outlet **314**, thereby both reducing the pressure output of the turbine portion **302** and decreasing the amount of back pressure between the engine **100** and the turbocharger **300**. As such, the speed of the turbine structure **316** and the amount of pressurized air being discharged from the turbine portion **302** may be altered for any state of engine operation. The waste gate **324** is adjustable to allow for varying amounts of exhaust to bypass the turbine structure **316** for varying performance needs of the engine.

The benefits of the use of turbocharger **300** in conjunction with the engine **100** include enhanced performance and improved efficiency. As the pressurized air exiting the compressor portion **302** is denser than the unpressurized air entering the compressor portion **302**, a given volume of the

pressurized air includes a larger quantity of oxygen than a given volume of the non-pressurized air. A larger volume of oxygen present in the combustion chamber of the engine **100** upon ignition facilitates combustion of a greater amount of fuel, thereby minimizing unburned fuel exiting with the exhaust and increasing the power output-to-fuel input ratio of the engine. However, as the turbine structure **316** is directly linked to the compressor structure **318**, the compressor structure **318** induces cyclical pressurization of the air which produces a series of high amplitude pressure peaks (high pressure magnitude) coinciding with the exhaust strokes of the cylinders and a series of low amplitude pressure troughs (low pressure magnitude) coinciding with the intake, compression and power strokes of the cylinders. Therefore, the engine configuration (i.e. the timing of the exhaust strokes of the cylinders) determines the pressurization cycle of the air exiting the compressor portion **302**. For example, during the exhaust strokes of the engine **100**, a high pressure exhaust gas pulse is delivered to the turbine portion **304**. Consequently, the rotational velocity of the turbine structure **316** is increased in proportion to the amplitude of the exhaust pulse and a high amplitude intake air pressure pulse is generated by the compressor portion **302**. Conversely, during the remaining strokes (intake, compression and ignition) a relatively low pressure exhaust gas flow is delivered to the turbocharger **300**, producing low pressure amplitude intake air.

Furthermore, during low speed engine operation, the exhaust strokes of the engine occur relatively slowly and, as such, the frequency of the high amplitude pressure peaks produced by the compressor portion **302** is relatively lower. Upon rapid throttle advancement, such as at rapid takeoff from idle or during maneuvering, the generation of high amplitude pressure peaks "lags" due to the time required for the increased exhaust pressure (from the increased combustion rate of the engine) to spin-up (rotate synchronously with the exhaust gases from the engine **100**) the turbine structure **316**. Subsequently, increased air flow demands from the engine **100** are not met by the compressor portion **302** and as such, the power increase from the turbocharger **300** is not available. Additionally, as the turbine structure **316** may be rotating insufficiently to displace the increased amount of exhaust gases produced from the engine **100**, back pressure may be produced between the engine **100** and the turbine portion **304**, which may actually decrease the amount of power the engine **100** generates until the turbine structure **316** spins-up. Resistance of the turbine structure **316** to spin-up is caused by the force exerted on the increased volume of air being compressed in the compressor portion **302** and the force of suction from the resistance of the air from the air box **200**.

As shown in FIG. **3**, the compressor outlet **308** communicates with the intercooler **400** by a duct or conduit **310**. Conduit **310** is connected on one end to the compressor outlet **308** and is connected on an opposite end to an inlet port **401** of the intercooler by a pair of fastening devices **316**, similar to fastening device **216**. As with conduit **210**, conduit **310** is preferably formed from a heat resistant material, such as metal or heat resistant plastic and is configured to provide a relatively direct air path between the turbocharger **300** and the intercooler **400**.

FIG. **7** shows one embodiment of the heat exchanger **400** as being located proximate the forward portion **26** of snowmobile **10** in a vertical position. As stated previously, the heat exchanger **400** is constructed and arranged to dissipate heat from the pressurized air exiting the turbocharger **300**. As shown in FIG. **8**, the heat exchanger **400** includes an

intake portion **402**, which provides inlet port **401**, and an outlet portion **404**, which provides an outlet port **405**. The intake and outlet portions **402**, **404** are interconnected by a spaced series of elongated conduits **406**. As shown in FIG. **8**, air from the turbocharger **300** enters through the inlet port **401** of intake portion **402** from conduit **310**. The air is directed through the series of conduits **406** toward the outlet port **405**. It is preferable for the heat exchanger **400** to be formed of a heat conductive material such as metal, for example, aluminum or steel. The heat conductive material of the conduits **406** allows heat from the air flowing therein to dissipate therethrough and into the atmosphere. It is preferable for the wall thickness of the conduits **406** to be relatively thin to expedite the heat dissipation. It is also preferable for the conduits **406** to be configured so as to minimize air flow resistance and pressure loss of the air flowing therein, such as with relatively large breadth cross-sectional geometries. It is also preferable for spaces **407** between the conduits **406** to be sufficiently wide so as to allow a relatively large amount of air to pass therethrough without producing significant air resistance. However, it is also preferable to keep both the cross-sectional size and distance between conduits **406** to a minimum, to maintain a space efficient design of the intercooler **400**.

As shown in FIG. **7**, it may be preferable for the heat exchanger to be mounted in a position that is generally normal to the movement of air produced from forward movement of the snowmobile **10**. This arrangement directly exposes the conduits **406** to the flow of oncoming air, which may facilitate heat dissipation.

It is also contemplated that the heat exchanger **400** may be mounted such that it is arranged parallel to the oncoming air, when the snowmobile **10** is moving generally forwardly. As such, only a forward edge **408** of the intercooler **400** is exposed to the oncoming air. As illustrated in FIG. **9**, providing air flow over an upper side **410** of the heat exchanger **400** (relative to the horizontally mounted position), such as indicated by L, produces a lower pressure relative to the upper side **410** that entrains air from below the heat exchanger **400** through the spaces **407** to liberate heat from the conduits **406**. In this arrangement, a body panel, such as indicated in FIG. **7** at **30** may be provided forward of the heat exchanger **400** to protect the heat exchanger **400** from impacts with debris. An opening **32** within the panel **30** provides air flow across the upper side **410** of the heat exchanger, as prescribed above for sufficient heat dissipation. It is noted that the opening **32** may also be positioned so as to provide air flow across a lower side **412** of the heat exchanger **400** thereby entraining air from the upper side **410** toward the lower side **412** between the conduits **406**.

It is, of course, possible to orient the heat exchanger at any position other than parallel and normal to the flow of air. For example, FIG. **10** shows the heat exchanger **400** at about a 45° angle relative to the air flow direction.

As shown in FIG. **3**, the outlet port **405** of the heat exchanger **400** communicates with the external plenum **500** via a conduit **414**. It may be preferable for the conduit **414** to be formed of a polymer material, since the temperature of the air exiting the heat exchanger **400** may be relatively lower than the air entering the heat exchanger **400**. A pair of clamps **416**, similar to the clamps **214**, may be used to secure respective ends of the conduit **414** to the outlet port **405** and the plenum **500**.

As shown in FIG. **3**, the plenum **500** includes an inlet port **502** and an outlet port **504**. Inlet port **502** is secured to conduit **414** with the clamp **416**. The outlet port **504** is

communicated to the engine air intake **110**. It is preferable for the plenum **500** to be connected to engine air intake **110** in a relatively direct manner, so as to minimize the air travel distance between the plenum **500** and the engine **100**. It is noted that the plenum **500** may be preferably formed of a metallic material. However, it is contemplated that a rigid polymer material may also be utilized. The plenum **500** is preferably a substantially hollow enclosure, which possesses a relatively large volume.

As described previously, pressurized air from the turbocharger **300** has a cyclical pressure pattern derived from the pulses of the exhaust gases generated by the engine **100**. As the frequency of the high pressure peaks of the intake air may be out of phase with the intake strokes of the cylinders, the cylinders may intake varying amounts of high density air causing erratic performance of the engine **100**. Due to the large volume of the plenum **500**, high pressure peaks entering the plenum **500** may be dissipated. Furthermore, the plenum **500** serves to bank a potential of relatively high pressure intake air. Due to the dissipation of the high pressure peaks and the banking of a relatively high pressure potential, the engine **100** may intake air with a relatively constant pressure amplitude.

It may be preferable for the plenum **500** to possess a volume of between and including 3 and 5 liters. It may be especially preferable for the plenum **500** to possess a volume of 3.5 liters. It is contemplated, however that the plenum **500** may be utilized with volumes below or above 3 and 5 liters. It is noted that the plenum volume may be altered with respect to engine size, engine operating characteristics, and/or turbocharger output.

The illustrated embodiment of the plenum **500** is directed to an elongated rectangular structure, as shown in FIG. **3**. It is contemplated, however that any of various configurations may be utilized to perform an equivalent function. For example, a duct, hose or pipe member with a relatively large diameter (or breadth, in the case of non-circular configurations) may be utilized.

As further illustrated in FIG. **3**, the engine **100** communicates with the plenum **500** at the air intake **110**. The air intake **110** is preferably provided by a throttle body **112**, which regulates an amount of air that enters the engine **100** corresponding to throttle position.

The engine shown in FIG. **3** has a V-twin configuration, which includes the cylinders **102**, **104** that are angularly opposed to each other. It is contemplated that the angle between the cylinders **102**, **104** may be between 180° and 0°. However, it is preferable for the angle between the cylinders **102**, **104** to be between 90° and 60°. It may be especially preferable for the angle to be about 80°. It is contemplated that an angle between the cylinders **102**, **104** less than 80° may require a balancer, such as a harmonic balancer, to counteract and oppose the power strokes of the cylinders **102**, **104** to prevent excessive vibration of the engine **100**. For this reason, it may be advantageous for the engine **100** to include the 80° angle between the cylinders **102**, **104** to lower the vibrations produced by the engine and forego the balancer. The V-twin engine has the associated cylinder heads **106**, **108** secured to an upper portion of each cylinder **102**, **104**. Each cylinder head **106**, **108** has a respective plurality of valves (not shown) which includes one or more intake valves and one or more exhaust valves (not shown), each of which communicates with their associated combustion chambers (not shown). It is contemplated that the displacement of each cylinder **102**, **104** be between 300 and 750 cm³ (cc), corresponding to a total engine displacement

of between 600 and 1500 cc, respectively. It is preferable for each cylinder **102**, **104** to have a displacement of about 650 cc, corresponding to a total engine displacement of about 1300 cc. It is contemplated, however that the engine displacement may be increased or decreased due to power needs and/or space considerations of the snowmobile. Therefore, the above-described displacement values are not meant to be limiting. An integral plenum **114** provides pathways between the throttle body **112** and each cylinder head **106**, **108** through which pressurized air from the plenum **500** flows to the intake valves for intake into an associated combustion chamber. Additionally, each cylinder head **106**, **108** has an exhaust outlet from which exhaust gases may be expelled from the respective combustion chambers through the exhaust valves. Heat-resistant piping **116**, schematically illustrated in FIG. **11**, is connected to each exhaust outlet and is connected to a connecting structure **118** prior to connection to the turbine inlet **312** of the turbocharger **300**. As such the exhaust gases from both cylinders are routed through the turbine portion **304** of the turbocharger **300**.

The above discussion of a four-stroke V-twin engine is meant only as an example of one type of engine that may be used to power the snowmobile **10** and that may be used in conjunction with the air intake system **22** of the present invention. It is, of course, possible to use any other type of four-stroke engine with the intake system **22**. For example, FIGS. **12** and **13** schematically illustrate two and three cylinder, in-line four-stroke engines, respectively at **700** and **800**.

The two cylinder engine indicated at **700** in FIG. **12** includes a pair of cylinders **702**, **704** that are disposed generally in-line with one another and have pistons (not shown) housed therein, which are operatively coupled to a common crankshaft (not shown). As with the engine **100**, the engine **700** is fed pressurized air from the plenum **500** via an air inlet **706**, which may be provided by a throttle body or carburetor(s). As further illustrated, pressurized air is supplied to each cylinder **702**, **704** by a plenum, or intake manifold, indicated by **708**. Exhaust outlets **710**, **712** of each cylinder **702**, **704** are connected to the inlet **312** of the turbocharger **300** via exhaust conduit **714**, similar to conduit **116**. The exhaust conduit **714** includes a branched portion **716**, which is connected to the inlet **312**. In this manner, the engine **700** is supplied with pressurized air from the turbocharger **300** and powers the turbocharger **300** with exhaust gas from the exhaust outlets **710**, **712**.

The three cylinder engine indicated at **800** in FIG. **13** includes three cylinders **802**, **804**, and **806** that are disposed generally in-line with one another and have pistons (not shown) housed therein, which are operatively coupled to a common crankshaft (not shown). As with the engines **100** and **700**, the engine **800** is fed pressurized air from the plenum **500** via an air inlet **808**, which may be provided by a throttle body or carburetor(s). As further illustrated, pressurized air is supplied to each cylinder **802**, **804**, and **806** by a plenum, or intake manifold, indicated by **810**. Exhaust outlets **812**, **814**, and **816** of each cylinder **802**, **804**, and **806** are connected to the inlet **312** of the turbocharger **300** via exhaust conduit **818**, similar to conduits **116** and **714**. The exhaust conduit **818** includes a branched portion **820**, which is connected to the inlet **312**. In this manner, the engine **800** is supplied with pressurized air from the turbocharger **300** and powers the turbocharger **300** with exhaust gas from the exhaust outlets **812**, **814**, and **816**.

For the V-twin engine discussed above, exhaust gas flowing from the engine **100** is pulsed (i.e. has a cyclical

pressure peak frequency) due to the firing sequence of the cylinders **102**, **104**. With the configuration of the cylinders **102**, **104** of the V-twin engine **100**, the firing sequence includes the rapid successive ignition of each cylinder **102**, **104**. Therefore, the exhaust strokes of the cylinders **102**, **104** occur relatively close together. This arrangement produces a pair of high amplitude exhaust pressure peaks derived from the exhaust strokes of each cylinder **102**, **104** followed by low amplitude exhaust pressure during the three remaining strokes (intake, compression and power strokes) of each cylinder. In other words, the exhaust pressure signature includes a pair of high pressure pulses with a lull of low exhaust pressure in-between successive exhaust strokes. As described hereinabove, consequent to the pulsed nature of the exhaust gas flow, the pressurized air generated by the turbocharger **300** will also possess a pulsed flow. For this reason, the plenum **500** is advantageous to provide intake air for the engine **100** with a relatively constant high pressure.

For the in-line type engines **700**, **800** (FIGS. **12** and **13**, respectively), exhaust gas flowing from the engine **100** is pulsed (i.e. has a cyclical pressure peak frequency) due to the firing sequence of the cylinders. Consequently, the pressurized air generated by the turbocharger **300** will possess a pulsed flow corresponding to the ignition sequence of the respective engine. As with the V-twin engine discussed above, the plenum **500** is advantageous to provide intake air for the respective engine at a relatively constant high pressure.

Selection of a particular type of engine discussed herein may be based on space limitations within the snowmobile **10**. FIG. **14** is a plan view of the V-twin engine **100**, two cylinder engine **700**, and three cylinder engine **800**. Depending on the specific power requirements and space limitations of a snowmobile **10**, any one of these engines may be utilized with the snowmobile. As shown, the width of the two and three cylinder engines **700**, **800** is relatively narrower than that of the V-twin engine **100**. However, the length of the V-twin engine **100** is relatively less than either of the two or three cylinder engines **700**, **800**.

It is noted that the present invention is advantageous in the art of snowmobiles for providing a powerful four-stroke engine that produces relatively fewer hydrocarbon emissions than the prior two-stroke counterparts. It is also noted that due to the previously disadvantageous characteristics of four-stroke engines, with respect to implementation thereof with snowmobiles, the present invention has been unpracticed in the art.

Furthermore, with respect to the turbocharger **300**, previous use of a turbocharger has been unfeasible in a snowmobile due to turbo lag, described above, during rapid throttle advancement. Consequent to the nature of snowmobiles and the environment they are operated in, rapid throttle advancement is a common occurrence in normal and severe operating conditions. This can result in turbo lag in a turbocharged engine. However, the use of a continuously-variable-transmission (CVT) in the snowmobile, as is well known in the art, can help reduce or prevent turbo lag. For example, it is noted that the turbocharger **300** may deliver pressurized air to the engine **100** for engine speeds below 3000 RPM, and at 3000 RPM, pressurizes intake air at an effective and useable level. The CVT may be configured to delay driving engagement until about 3000 RPM, therefore, the turbocharger is already effectively pressurizing the engine by the time the CVT begins driving engagement. Thus this relatively high engine RPM prior to driving engagement of the CVT helps to minimize turbo lag. No turbo lag has been noticed in a snowmobile tested with the

11

turbocharged engine as described herein. FIG. 15, schematically shows a CVT 900 operatively connected to a crankshaft 902 of an engine 904. It is noted that engine 904 may be of any type discussed herein, such as the V-twin type, two cylinder type, of three cylinder type. Of course, it is contemplated that different engine sizes, turbocharger configurations, snowmobile sizes, and CVT configurations may be suited for higher or lower RPM at which point the snowmobile initially moves. It is noted that 3000 RPM is recited for example only and is not meant to be limiting.

Additionally, the CVT, engine, and turbocharger (as well as any other components discussed herein) may be arranged so as to maximize available space within the snowmobile 10. For example, FIG. 15 shows the CVT 900 disposed on a side of the engine 904 opposite the turbocharger 300. Conversely, FIG. 16 shows the CVT 900 disposed on a side of the engine 904 adjacent the turbocharger 300. Any other accommodating arrangement is, of course, possible. Additionally, FIG. 15 shows an engine air intake, indicated at 906, arranged at the side of the engine 904 adjacent the CVT 900 and opposite the turbocharger 300. Conversely, FIG. 16 shows the engine air intake 906 arranged at the side of the engine 904 opposite the turbocharger 300, while the CVT 900 is disposed adjacent the turbocharger 300 and opposite the intake 906. Specifically, FIG. 15 shows the CVT 900 and intake 906 disposed on a port side of the engine 904, while the turbocharger 300 is disposed on a starboard side of the engine 904. Furthermore, FIG. 16 shows the CVT 900 and turbocharger 300 disposed on the starboard side of the engine 904, while the intake is disposed on the port side of the engine 904. Similarly, the plenum 500 maybe disposed on either side of the engine 904. Furthermore, although the turbocharger is shown on the air inlet side of the engine in FIGS. 15 and 16, it should be appreciated that the turbocharger may be provided on the exhaust outlet side of the engine. In addition, the turbocharger may be positioned on either the port or starboard side of the engine.

As shown in FIG. 3, the turbine outlet 314 is connected to the exhaust system 24. The exhaust system 24 preferably includes heat-resistant piping and a muffler (shown in FIG. 2 at 300A) through which exhaust gases from the engine exit the snowmobile 10, via the turbocharger 300.

It will be appreciated that numerous modifications to and departures from the embodiments of the invention described above will occur to those having skill in the art. Such further embodiments are deemed to be within the scope of the following claims.

What is claimed is:

1. A snowmobile, comprising:

a frame having a forward portion and a rear portion;
a turbocharged four-stroke engine mounted to said forward portion of said frame;
an endless belt drive system mounted to said rear portion of said frame and operatively connected to said engine;
an air intake system for said engine; and
a continuously-variable-transmission operatively coupled between said engine and said belt drive system and being manipulable into an engaged configuration wherein said continuously-variable-transmission transfers sufficient power between said engine and said endless drive belt to effect movement of said snowmobile.

2. A snowmobile as in claim 1, wherein said engine includes at least one cylinder, each cylinder having a respective combustion chamber, said engine having an air inlet

12

capable of communicating with each said combustion chamber and an exhaust outlet capable of communicating with each said combustion chambers;

said air intake system comprising;

an air passage communicated with the atmosphere, said air passage being a substantially hollow enclosed structure, wherein said turbocharger is connected to said air passage such that air from said air passage may enter said turbocharger, said turbocharger communicating with said exhaust outlet and being constructed and arranged such that a flow of exhaust gases from said exhaust outlet through said turbocharger affects a pressurization of air therein.

3. A snowmobile as in claim 2, further comprising a heat exchanger formed of a heat conductive material connected to said turbocharger such that the pressurized air from said turbocharger may enter therein, said heat exchanger being constructed and arranged such that heat from the pressurized air is dissipated therefrom to the atmosphere via said heat conductive material.

4. A snowmobile as in claim 3, further comprising a plenum connected to said heat exchanger such that air from said heat exchanger may enter said plenum, said plenum further connected to said air inlet and being constructed and arranged such that cyclically pressurized amplitude of the air from said turbocharger via said heat exchanger may collect therein such that the pressurization amplitude of the air upon exiting the plenum and entering said air inlet is substantially constant.

5. A snowmobile as in claim 2, wherein said air passage is positioned forward of said engine in spaced relation thereto in order to prevent significant heating of air within said air passage.

6. A snowmobile as in claim 2, wherein said air passage is positioned aft of said engine in spaced relation thereto in order to prevent significant heating of air within said air passage.

7. A snowmobile as in claim 3, wherein said heat exchanger is an intercooler, said intercooler inducing an intake portion and an outlet portion, said intake and outlet portions connected by a series of spaced hollow conduits.

8. A snowmobile as in claim 7, wherein said intercooler is positioned proximate said forward portion of said frame, said intercooler being arranged generally normally to the oncoming air flow from the atmosphere produced by movement of said snowmobile therethrough, such that said conduits are directly exposed to the oncoming air.

9. A snowmobile as in claim 7, wherein said intercooler is positioned proximate said forward portion of said frame, said intercooler being arranged generally parallel to the oncoming air flow from the atmosphere produced by movement of said snowmobile therethrough, said intercooler being positioned such that the air is directed across one surface thereof, thereby entraining air from an opposite side through spaces between said conduits.

10. A snowmobile as in claim 7, wherein said intercooler is positioned proximate said forward portion of said frame, said intercooler being arranged at an angle to the oncoming air flow from the atmosphere produced by movement of said snowmobile therethrough, said intercooler being positioned such that the air is directed across one surface thereof, thereby entraining air from an opposite side through spaces between said conduits.

11. A snowmobile as in claim 3, wherein said air passage communicates with said turbocharger via a first duct member and said turbocharger communicates with said heat exchanger via a second duct member.

13

12. A snowmobile as in claim 4, wherein said heat exchanger communicates with said plenum via a duct member, said duct member being formed of one of a polymer material and a metallic material.

13. A snowmobile as in claim 4, wherein said plenum is connected to said air inlet on one end thereof.

14. A snowmobile as in claim 4, wherein said plenum has an internal volume between and including 3 and 5 liters.

15. A snowmobile as in claim 2, wherein said snowmobile further comprises an exhaust system, said exhaust system being operatively connected to said turbocharger such that exhaust gas may flow from said turbocharger subsequent to said affecting the pressurization of air from the environment and through said exhaust system into the atmosphere.

16. A snowmobile as in claim 15, wherein said exhaust system includes a muffler to dissipate noise of the exhaust gas exiting said engine.

17. A snowmobile as in claim 2, wherein said air inlet is provided by a throttle body.

18. A snowmobile as in claim 2, wherein said turbocharger pressurizes the air at a sufficiently useable level for engine speeds below 3000 revolutions per minute.

19. A snowmobile as in claim 1, wherein said continuously-variable-transmission is operatively connected to said engine on a side thereof opposite a side thereof that is proximate said turbocharger.

20. A snowmobile as in claim 1, wherein said continuously-variable-transmission is operatively connected

14

to said engine on a side thereof adjacent a side thereof that is proximate said turbocharger.

21. A snowmobile as in claim 1, wherein said continuously-variable-transmission is configured such that the movement of said snowmobile is effected when said engine is operating at 3000 revolutions per minute.

22. A snowmobile as in claim 1, wherein said turbocharger pressurizes the air prior to engagement of said continuously-variable-transmission.

23. A snowmobile as in claim 1, wherein said engine is of a V-twin two cylinder type engine.

24. A snowmobile as in claim 1, wherein said engine includes a plurality of cylinders and is an in-line type engine.

25. A snowmobile as in claim 1, wherein said turbocharger is disposed on a starboard side of said engine.

26. A snowmobile as in claim 1, wherein said turbocharger is disposed on a port side of said engine.

27. A snowmobile as in claim 4, wherein said plenum and said continuously-variable-transmission are disposed on a same side of said engine.

28. A snowmobile as in claim 4, wherein said plenum and said continuously-variable-transmission are disposed on opposites sides of said engine relative to one another.

29. A snowmobile as in claim 4, wherein said plenum and said turbocharger are disposed on opposite sides of said engine relative to one another.

* * * * *