

(19) World Intellectual Property Organization
International Bureau



(43) International Publication Date
18 August 2011 (18.08.2011)

PCT

(10) International Publication Number
WO 2011/099959 A1

(51) International Patent Classification:
B62M 27/02 (2006.01) *B62J 25/00* (2006.01)

(74) Agent: **GROEN, Eric, J.**; Baker & Daniels LLP, 300 North Meridian Street, Suite 2700, Indianapolis, IN 46204 (US).

(21) International Application Number:
PCT/US2010/003207

(81) Designated States (unless otherwise indicated, for every kind of national protection available): AE, AG, AL, AM, AO, AT, AU, AZ, BA, BB, BG, BH, BR, BW, BY, BZ, CA, CH, CL, CN, CO, CR, CU, CZ, DE, DK, DM, DO, DZ, EC, EE, EG, ES, FI, GB, GD, GE, GH, GM, GT, HN, HR, HU, ID, IL, IN, IS, JP, KE, KG, KM, KN, KP, KR, KZ, LA, LC, LK, LR, LS, LT, LU, LY, MA, MD, ME, MG, MK, MN, MW, MX, MY, MZ, NA, NG, NI, NO, NZ, OM, PE, PG, PH, PL, PT, RO, RS, RU, SC, SD, SE, SG, SK, SL, SM, ST, SV, SY, TH, TJ, TM, TN, TR, TT, TZ, UA, UG, US, UZ, VC, VN, ZA, ZM, ZW.

(22) International Filing Date:
16 December 2010 (16.12.2010)

(25) Filing Language: English

(26) Publication Language: English

(30) Priority Data:
61/337,676 9 February 2010 (09.02.2010) US

(71) Applicant (for all designated States except US): **POLARIS INDUSTRIES INC.** [US/US]; 2100 Highway 55, Medina, MN 55340 (US).

(72) Inventors; and

(75) Inventors/Applicants (for US only): **CONN, Jeffrey, D.** [US/US]; 40083 175th Street, Wannaska, MN 56761 (US). **MILLS, Andrew, J.** [US/US]; 35331 230th Street, Roseau, MN 56751 (UY). **MERTENS, Dustin, A.** [US/US]; 43660 277 Th Street, Roseau, MN 56751 (US). **RIPLEY, Anthony, J.** [CA/US]; 905 6th Street SW, Roseau, MN 56751 (US). **DAHLGREN, Lyle, J.** [US/US]; 26125 480th Avenue, Roseau, MN 56751 (US). **SAMPSON, Martin, E.** [US/US]; 34484 290th Street, Roseau, MN 56751 (US).

(84) Designated States (unless otherwise indicated, for every kind of regional protection available): ARIPO (BW, GH, GM, KE, LR, LS, MW, MZ, NA, SD, SL, SZ, TZ, UG, ZM, ZW), Eurasian (AM, AZ, BY, KG, KZ, MD, RU, TJ, TM), European (AL, AT, BE, BG, CH, CY, CZ, DE, DK, EE, ES, FI, FR, GB, GR, HR, HU, IE, IS, IT, LT, LU, LV, MC, MK, MT, NL, NO, PL, PT, RO, RS, SE, SI, SK, SM, TR), OAPI (BF, BJ, CF, CG, CI, CM, GA, GN, GQ, GW, ML, MR, NE, SN, TD, TG).

Published:

— with international search report (Art. 21(3))

(54) Title: SNOWMOBILE

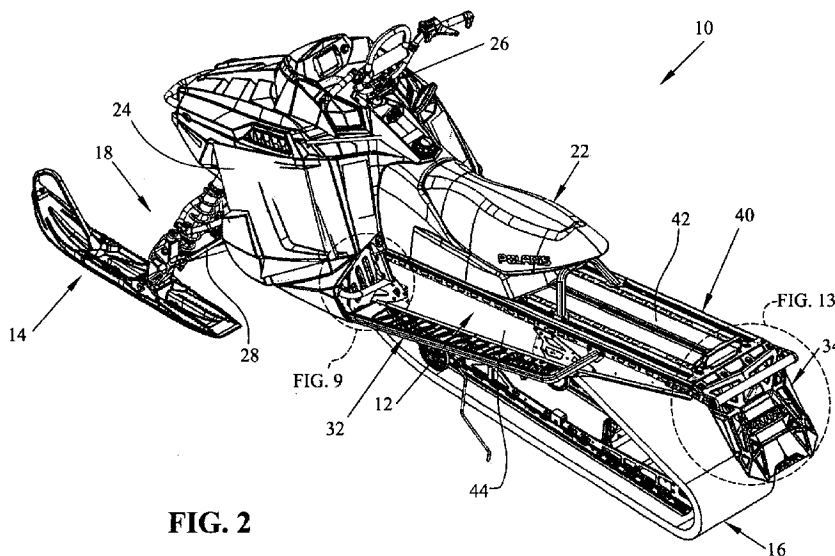

FIG. 2

(57) Abstract: The present invention generally relates to snowmobiles. More particularly, the present invention relates to the components of a snowmobile (10) such as the frame (12), running boards (32) and various other assemblies.



WO 2011/099959 A1

SNOWMOBILE

This application claims the benefit of U.S. Provisional Patent Application Serial No. 61/302,394, filed on February 8, 2010, and U.S. Provisional Patent Application Serial No. 61/337,676, filed on February 9, 2010, the complete disclosures of which are
5 expressly incorporated by reference herein.

The present invention generally relates to snowmobiles. More particularly, the present invention relates to the components of a snowmobile such as the frame, suspension, running boards and various other assemblies.

Generally, there are a variety of configurations of snowmobiles available for
10 applications such as deep snow, high performance, luxury touring, trail riding, etc. Most snowmobiles include a frame, a power train, a pair of front skis, and an endless belt assembly. Typically, features such as engine displacement and track length vary depending upon the specific application for which the snowmobile is targeted. For example, snowmobiles designed primarily for deep snow application may include
15 an endless belt assembly having a longer track length, i.e. 166 inches (4.2 meters), than a snowmobile designed primarily for trail riding, i.e. 135 inches (3.4 meters). A snowmobile designed for deep snow may also include a relatively large displacement engine, i.e. 900 cc³ (54.9 inches³), to provide suitable power when operating in a mountain environment at higher elevations with less oxygen. Other
20 features of a deep snow snowmobile may be added to improve ride and handling characteristics such as side hilling.

A deep snow snowmobile is shown in our patent application Serial No. 11/501,454 filed August 9, 2006, the contents of which are incorporated herein by reference.

One illustrative embodiment of the present invention includes a snowmobile
25 comprising a frame, a power train supported by the frame; a running board assembly supported by the frame and comprising a toe clip, a front wall and a foot tread; and a shroud laterally encompassing the toe clip and the back wall, with the toe clip extending rearwardly, beyond a rear edge of the shroud.

Another illustrative embodiment of the present invention includes a frame; a power train supported by the frame; a running board assembly supported by the frame and comprising a toe clip, a front wall and a foot tread; and a shroud laterally encompassing the toe clip and the back wall, with the back wall extending
5 substantially aligned with a rear edge of the shroud.

Another illustrative embodiment of the present invention includes a snowmobile comprising: a frame; a power train supported by the frame; and a running board assembly supported by the frame and comprising a toe clip, a front wall and a foot tread; the foot tread having upturned embossed openings having gripping surfaces
10 thereon.

Another illustrative embodiment of the present invention includes a snowmobile comprising a frame; a power train supported by the frame; and a running board assembly supported by the frame and comprising a toe clip, a front wall and a foot tread; the foot tread having upturned embossed openings and openings through the
15 running board.

Another illustrative embodiment of the present invention includes a snowmobile comprising a frame; a power train supported by the frame; a running board assembly supported by the frame and comprising a toe clip, a front wall and a foot tread; and a shroud laterally encompassing the toe clip and the back wall, with the back wall
20 extending substantially aligned with a rear edge of the shroud.

The above mentioned and other features of this invention, and the manner of attaining them, will become more apparent and the invention itself will be better understood by reference to the following description of embodiments of the invention taken in conjunction with the accompanying drawings.

25 Fig. 1 is a front perspective view of an illustrative embodiment of a snowmobile;

Fig. 2 is a rear perspective view of the embodiment shown in FIG. 1;

Fig. 3 is a side view of the left hand side of the embodiment shown in FIG. 1;

Fig. 4 is a side view of the right side of the embodiment shown in FIG. 1;

Fig. 5 is a top view of the embodiment shown in FIG. 1;

Fig. 6 is a front view of the embodiment shown in FIG. 1;

Fig. 7 is a rear view of the embodiment shown in FIG. 1;

Fig. 8 is a bottom view of the embodiment shown in FIG. 1;

5 Fig. 9 is an enlarged view of the running board assembly of the embodiment shown in FIG. 1;

FIG. 10 is an enlarged view of the foot tread of the embodiment shown in FIG. 1;

FIG. 11 is an enlarged side view of a front portion of the running board;

FIG. 12 is an exploded view of the tunnel;

10 FIG. 13 is an enlarged view of the rear snow flap;

FIG. 14 is a partial front perspective view of the snowmobile with the front body removed;

FIG. 15 is an enlarged front perspective of the front frame;

FIG. 16 is a front perspective of the cast frame member;

15 FIG. 17 is an underside perspective view of the cast frame member of FIG. 16;

FIG. 18 is a rear view of the cast frame member;

FIG. 19 is a front perspective view of the steering assembly;

FIG. 20 is a side view of the steering assembly mounted to the cast frame member of FIG. 16;

20 FIG. 21 is a side perspective view of a heat shield member mounted to an inside of the body panel; and

FIG. 22 is an exploded perspective view of the air intake system;

FIG. 23 is a side showing the suspension system removed from the tunnel; and

FIG. 24 shows an exploded view of a rear bumper.

Corresponding reference characters indicate corresponding parts throughout the several views. Although the drawings represent embodiments of the present invention, the drawings are not necessarily to scale and certain features may be
5 exaggerated in order to better illustrate and explain the present invention.

The embodiments disclosed below are not intended to be exhaustive or to limit the invention to the precise forms disclosed in the following detailed description. Rather, the embodiments are chosen and described so that others skilled in the art may utilize their teachings. For example, while the following description refers primarily to
10 a snowmobile, it should be understood that the principles of the invention apply equally to other snow vehicles. While the present invention primarily involves a snowmobile, it should be understood, however, that the invention may have application to other types of vehicles, such as motorcycles, ATVs, utility vehicles, scooters, and mopeds.

Referring to FIGS. 1-8, one illustrative embodiment of a snowmobile 10 is shown. Snowmobile 10 includes a frame 12, supported by front skis 14 and by endless belt assembly 16. Front skis are coupled to a front suspension 18, and endless belt assembly is supported by a rear suspension 20. Snowmobile also includes a seat assembly 22, front outer body 24, and a steering assembly 26. Steering assembly
20 26 is operably coupled to steering arms 28 (FIG. 2) which allows a rider to steer snowmobile 10. A power train is covered by outer body 24 and provides power to endless belt assembly 16. Running board assemblies 32 extend along the sides of the seat assembly which are supported by the frame 12. A snow flap 34 (FIG. 2) is also supported by the frame rearward of the endless belt.

With reference to FIGS. 1 and 2, frame 12 includes a tunnel 40 having a top wall 42 and side walls 44. As shown best in FIG. 2, endless belt 16 at least partially runs up into tunnel 40 between side walls 44 and upwardly towards top wall 42. As shown, running board assemblies 32 include a rider's foot grip assembly 50 (FIG. 4) and a foot tread assembly 52, where the foot grip assembly 50 and foot tread assembly 52
30 are supported by the tunnel sidewall 44. As shown best in FIGS. 11 and 12, the tunnel 40 also include a plurality of cutout portions 46 which reduce the material in

locations where fasteners are not needed. These cutouts 46 help to reduce the weight of the entire vehicle. The surface to which sidewalls 44 abut (not shown), also include notches but complement notches 46 such that the notches do not overlap. Other cutouts could be provided elsewhere as well.

- 5 With reference now to FIG. 9, the foot grip assembly 50 is shown in greater detail. Foot grip assembly 50 includes frame member 100 which extends over the top wall 42 of tunnel 40, having a first portion 102 extending downwardly and away from the tunnel, and a second portion 104 extending downwardly and reversely bent towards the tunnel. The end of portion 104 is flattened and includes a flange at 106. Foot
- 10 grip assembly 50 further includes a tube portion 110 which is fastened to the side of the tunnel and connected to frame portion 100 for example, by welding. A toe clip 112 extends between frame member 110 and frame portion 102. Finally, foot grip assembly 50 includes a back wall 114 attached at marginal edges 115 and 116, and comprises plural slotted openings 118.
- 15 With reference to FIGS. 9-12, foot tread assembly 52 is comprised of an elongate frame member 122 and running board plate 124. Elongate frame member 122 is comprised of a tube 126 and a frame bracket 128. As shown in FIG. 12, frame bracket 128 is discreet from tube 126. Bracket 128 includes a bracket foot 130 which extends into tube 126 and a bracket arm 132 for attachment to flange 106.
- 20 Bracket foot 130 may be attached to tube 126 by way of fasteners, welding or adhesives, or a combination thereof. As shown (FIG. 9), the flattened surfaces of flanges 106 and bracket arms 132 are positioned back to back and attached by way of fasteners 134 (FIG. 9). Furthermore, the planes of the flat surfaces of flanges 106 and bracket member 132 extend in a longitudinal direction as described herein.
- 25 With respect now to FIGS. 9 and 10, running board plate 124 is comprised of a plate portion 140 having a lip 142 positioned and attached to elongate tube member 126 as shown. The opposite side of the plate portion 140 has a marginal edge 144 which is attached to the tunnel side wall 44. As shown in Figure 12, the running board plate 124 is integral with the tunnel side wall 44, however this connection could also
- 30 be by fastening, such as by welding, adhesives or riveting.

The running board plate 124 further includes a plurality of upturned embossments 150 (FIG. 10) having a generally triangular shape with gripping serrations 152 positioned thereon. Intermediate each of the upturned embossments 150 is an opening 156, of reverse triangular shape, where the embossments 150 rigidify the plate portion 140 whereas openings 156 maximize the open area of the foot tread to allow snow to drop downwardly therethrough. This provides a smooth bottom surface to plate portion 140, having no interference with the snow.

Thus, as shown in FIG. 9, an enlarged ventilation area is defined by the spacing at 160 and within the slots 118. The longitudinal disposition of the flanges 106 and 132 as described above also maximizes the ventilation area 160, particularly for the removal heat from the engine compartment as described herein.

Finally, with respect to FIGS. 9-11, an outer shroud 180 covers foot grip assembly 50 and includes a shroud portion 182 which encompasses portions 102 and 104 of frame tube 100. Shroud 180 also includes a rear edge 184 (FIG. 11) which is proximate to back wall 162. As shown best in FIG. 11, toe clip 112 extends rearwardly beyond rear edge 184 of shroud 180 which provides easy access for the rider to place their boot in the toe clip, yet prevents forming a pocket into which snow may accumulate and pack. Also, the forward angle of edge 184 allows a rider's foot to position sideways, overlapping the foot tread assembly 52, and yet stay retained behind foot grip assembly 50.

With reference now to FIG. 13, snow flap 34 is shown in an enlarged view. Snow flap 34 is hingedly mounted to the tunnel 40 along a rear edge 190. The snow flap 34 includes a plurality of apertures 192 which reduces the overall weight of the component. These could be machined or molded in.

With reference now to FIG. 14, the outer body 24 has been removed which better exposes the engine compartment 200, the steering assembly 26, the frame front portion 202, and the power train 204. The power train 204 includes an engine 206 having an exhaust system 208, an intake system 210 and a drive system including a CVT 212. As mentioned above, the ventilation area 160 was defined around the foot grip area, and this allows the CVT ventilation to exhaust through ventilation area 160.

With reference now to FIG. 15, the front portion 202 of the frame is shown in greater detail. Front portion 202 includes a cast coupling or connector 220 configured to attach plural frame tubes, namely front frame tubes 222, 224 and rear frame tubes 226 and 228 thereto. The frame tubes 222, 224, 226, 228 may be attached to the cast coupling 220 by way of fasteners such as 230 and/or may be adhesively fixed to the cast coupling 220. As shown, the cast coupling 220 further includes two support webs 232 and 234. Each of the webs is provided with threaded apertures, for example, 236 and 238. As also shown in FIG. 15, a steering post 260 of steering assembly 26 is directly coupled to webs 232 and 234 of the cast coupling 220, as described herein.

With reference now to FIGS. 16-18, cast coupling 220 will be described in greater detail. Cast coupling 220 further includes a first circular channel (FIG. 16) defined by portions 240 and 242 having threaded bosses 244 extending downwardly therethrough. A second circular channel is defined by portions 246 and 248 having threaded bosses 250 therein. The circular channels are intersected by cylindrical members 252 and 254. Thus, with a comparison of FIGS. 15 and 16, it should be appreciated that frame tubes 222 and 224 are positioned across the circular channels with fasteners such as 230 positioned through the frame tubes 222, 224 and into the threaded bosses 244, 250. Adhesive may also be applied. Meanwhile, frame tubes 226 and 228 are positioned in the cylindrical members 252 and 254, and may also be fixed in place by way of fasteners and adhesive.

With reference now to FIG. 18, cast coupling 220 includes machined mounting surfaces 232A and 234A on the backside of the webs 232 and 234, respectively, for mounting the steering post as described below. Finally as best shown in FIG. 17, cast coupling 220 includes an integral fuel tank mounting tab shown at 258.

With reference now to FIG. 19, the steering assembly is shown in greater detail. As shown, steering post 260 includes an upper and lower bearing posts 270 and 272 which attach to the backside of the webs 232, 234 respectively, with fasteners being attached to threaded apertures 236 and 238, respectively. This rigidly connects the steering post 260 to the cast coupling 220 yet allows the steering post to pivot about the corresponding bushings 270 and 272. As also shown, handlebars 276 of

steering assembly 26 are attached to the steering post 260 by way of a clamp at 278.

Steering assembly 26 further comprises a lower steering post 280 which is operatively coupled to steering post 260 by way of respective link arms 282, 284, 5 connected together by way of a link 286. Lower steering post 280 is ultimately connected to steering arms 28 by way of a further steering arm, not shown, to maneuver the steering skis 14.

With reference now to FIG. 20, steering assembly 26 is shown mounted to the backside of cast coupling 220 with the bushings 270, 272 (FIG. 19) mounted to the 10 surfaces 232A, 234A (FIG. 18), respectively. As shown, steering post 260 is nearly vertical and could be in the range where angle \emptyset could be between 0 and 15 degrees and as shown is about 13 degrees. As steering post 260 is positioned at a substantially upright angle, the ergonomics is improved for the deep snow rider.

As known, when side hilling, a rider is often standing on only one side of the running 15 board assemblies 32 and the maneuverability of the steering post and handlebars 276 is substantially increased when the steering post 260 is close to vertical. This prevents the handlebars 276 from dipping down or raising up on either side when attempting to steer the snowmobile while standing on only one side.

FIG. 20 also shows a fuel tank 258 having a front end positioned adjacent to the 20 integral fuel tank mounting tab 256 to retain a front end of the fuel tank 258. Fuel tank 258 may be attached to tab 256 through fasteners, or fuel tank could have a molded slot to be applied over tab 256.

With respect now to FIG. 21, front side panel 300 (see also FIG. 4) on the right hand side of the snowmobile is provided with sound insulation 302 as well as a heat shield 25 304. The foam includes a front surface 306, a back surface 308, and a plurality of cutouts 310 extending between the front and back surface. Heat shield 304 includes a plate 320 having a plurality of mounting feet 322 which correspond in location to the apertures 310. An adhesive is provided against the back surface 308 to retain sound insulation to the inside surface of the panel 300. Heat shield 304 can be 30 placed with the feet 322 aligned with the associated apertures 310 and pressed against the foam 302 until the feet contact the adhesive, through the apertures,

which retains the heat shield to the foam member 302. This prevents any fasteners or additional dimensional requirements for attaching the heat shield to the foam. This also provides less weight for the snowmobile yet provides a heat shield 304 adjacent to a portion of the exhaust system of the snowmobile power train as described above. The adhesive could be a double-sided sticky tape, double sided foam tape, or any other adhesive for the purposed described.

Referring now to FIG. 22, air inlet 210 (FIG. 15) is shown in greater detail as comprised of inlet housing 350, retainer housing 352 and sound-deadening foam 354. Housing 350 is generally rectangular having a plurality of apertures 356 extending therethrough, where the rectangular housing has a front wall 360, sidewall 362 opposite side wall 366 and rear wall 368. Retainer 352 includes a front wall 370, sidewall 372 having lugs 374, opposite sidewall 376 and a partial rear wall 378. Sound-deadening foam 354 generally includes a foam body portion 380 having locating apertures at 382.

It should be appreciated that the foam 354 is positioned on an inside of the retainer member 352 with lugs 374 aligned with apertures 382 of the foam 354. The retainer and foam together are then snapped around housing 350 with the front wall 370 of retainer 352 positioned against front wall 360 of housing 350, sidewalls 372 and 376 positioned adjacent to corresponding sidewalls 362 and 366, respectively, and with partial wall 378 at retainer 352 positioned against back wall 368. The retainer 352 and housing 350 can be held together by way of corresponding latch members such as lug 390 and aperture 392 to retain the two components together. This provides an easy to assemble two component intake system 210 having an internal housing 350 and a retainer housing 352 whereby air traveling through the intake system can be sound-deadened by foam member 354.

With reference now to FIG. 23, rear suspension 20 is shown removed from the tunnel, understanding that the rear suspension is attached to the underside of tunnel 40. Suspension 20 includes a frame 400 having laterally spaced frame rails 402 with slide rails 404 attached thereto. Suspension 20 includes two coil over shocks 406 and 408 providing dampening between the tunnel 40 and frame 400. A track roller 410 is mounted on the outside of the slide rail 402, and as shown, has an outer radial surface 412 which extends beyond lower surface 414 of slider 404. Track

rollers 410 are located at a position proximate a maximum pressure point between the sliders 404 and track (absent the track wheel) which allows the track a slight spacing between the sliders 404 preventing substantial frictional heating.

Suspension 20 also includes idler rollers 420 and 422. Scratchers 426 are also provided on the side of frame 404 to break up crusted snow in order that the track can throw snow against the underside of tunnel 40, as the tunnel includes a heat exchanger for engine water.

With reference now to FIGS. 13 and 24, a rear bumper assembly 450 is shown including a rear bumper member 452 and side brackets 454. Bumper member 452 is comprised of a carbon fiber material and as best shown in FIG. 24 has an outer diameter 456, an inner diameter 458, and apertures 460. Side brackets 454 are comprised of an extruded aluminum and include apertures 462 for mounting the side brackets to tunnel 40 by way of fasteners 464 (FIG. 13). As shown, extruded brackets 454 have extruded openings at 466 and apertures 468 which extend into openings 466. A cap 470 is also provided having a lip 472, and a reduced diameter portion 474 having apertures 476.

To assemble bumper assembly 450, bumper member 452 is positioned in openings 466 of extruded members 454. Caps 470 are positioned with diameter portions 474 within inner diameter 458 and with the lips 472 against the extruded side bracket 454, with apertures 460 and 476 aligned. Fasteners 480 are then placed through the extruded members 454, bumper member 452 and cap 470 to retain the bumper member thereto. Fasteners 464 could be set screws, bolts, rivets or any similar fastening device, although as shown, fasteners 480 are rivets. As also shown in FIG. 13, snow flap 34 includes a stop member 490 integrally molded with the flap which has an upper stop surface 492 which abuts against the bumper member 452.

It should be generally understood that the description provided herein relates only to the specific embodiment, and that other variations could be envisioned. For example, while referring herein to tubes, cylindrical tubes are shown, but it is contemplated that other structural geometries, such rectangular or square tubes could also be used.

While this invention has been described as having an exemplary design, the present invention may be further modified within the spirit and scope of this disclosure. This application is therefore intended to cover any variations, uses, or adaptations of the invention using its general principles. Further, this application is intended to cover
5 such departures from the present disclosure as come within known or customary practice in the art to which this invention pertains.

WHAT IS CLAIMED IS:

1. A snowmobile (10) comprising a frame (12); and a foot grip assembly (50) supported by the frame and including a toe clip (112), a back wall (114) proximate a rider's footwear, and a shroud (180, 182) having a rear edge (184), the shroud
5 generally surrounding the toe clip and the back wall; characterized in that the toe clip extends rearwardly beyond the rear edge of the shroud, and in that the back wall includes a plurality of openings (118), each of the openings of the back wall extending to a height greater than the height of the toe clip.
- 10 2. The snowmobile of claim 1, further characterized by a power train (204) and heat produced by the power train dissipates rearwardly through the plurality of openings of the back wall and toward the rider's footwear.
3. The snowmobile of claims 1 or 2, characterized in that the rear edge of the
15 shroud is approximately vertical to maximize the lateral distance between the toe clip and an outer edge of the shroud.
4. The snowmobile of any of claims 1-3, characterized in that the back wall and the rear edge of the shroud are generally coincident to prevent accumulation of snow
20 within the shroud.
5. A foot grip assembly (50) for a snowmobile (10) comprising a back wall (114); a toe clip (112) positioned rearward of the back wall; a frame member (100, 102, 104) coupled to the toe clip and extending around a front face of the back wall; and a
25 shroud (180, 182) generally surrounding the back wall, the frame member, and the toe clip; characterized in that the frame member extends in a diagonal direction between an inner edge and an outer edge of the front face of the back wall, and in that the toe clip couples to the frame member at a position approximately half the height of the shroud.
- 30 6. The foot grip assembly of claim 5, characterized in that the back wall and the shroud are configured to prevent snow accumulation in the foot grip assembly.

7. The foot grip assembly of claims 5 or 6, characterized in that a rear edge (184) of the shroud is approximately vertical to maximize a lateral distance between the toe clip and the shroud.

5 8. A snowmobile (10) comprising a frame (12); and a foot tread assembly (52) supported by the frame and including a running board plate (124) having a plurality of embossed openings (150) and a plurality of intermediate openings (156) allowing snow to drop therethrough; characterized in that each of the embossed openings has a triangular shape and each of the intermediate openings has a reverse triangular
10 shape relative to each of the embossed openings, each of the embossed openings alternatively arranged with each of the intermediate openings to provide a maximum open area of the running board plate.

9. The snowmobile of claim 8, characterized in that each of the plurality of
15 embossed openings further comprises gripping serrations (152) positioned thereon and extending above the running board plate.

10. The snowmobile of claims 8 or 9, characterized in that a bottom surface of the running board plate is smooth to prevent interference with the snow.

20

11. The snowmobile of any of claims 8-10, characterized in that the running board plate further comprises a lip portion (142) positioned away from the frame of the snowmobile and including a plurality of raised foot treads.

25 12. The snowmobile of any of claims 8-11, characterized in that the running board plate is integral with the frame.

13. The snowmobile of any of claims 8-12, characterized in that the foot tread assembly is adhesively coupled to the frame.

30

14. A frame (12) for a snowmobile (10) comprising a plurality of frame members (222, 224, 226, 228); and a coupling (220) to receive the plurality of frame members; characterized in that the coupling includes at least one open channel (240, 242, 246,

248) and at least one cylindrical member (252, 254) for receiving the plurality of frame members.

15. The frame of claim 14, characterized in that the coupling is cast.

5

16. The frame of claims 14 or 15, characterized in that a steering assembly (26) is operatively coupled to the coupling.

17. The frame of claim 16, characterized in that the steering assembly includes a steering post (260) operatively coupled to at least one web (232, 234) of the coupling.

10

18. The frame of claims 16 or 17, characterized in that the steering assembly is coupled to the coupling at an angle between 0-15 degrees.

15

19. The frame of any of claims 14-18, characterized in that the coupling includes a tab (256) for mounting a fuel tank to the coupling.

20. The frame of claim 19, characterized in that the tab is integral with the coupling.

20

21. The frame of any of claims 14-20, characterized in that each of the frame members is attached to the coupling with at least one of adhesive and fasteners.

22. A connector (220) for a snowmobile (10) comprising means for securing a plurality of frame members (222, 224, 226, 228) thereto; and means for coupling a steering assembly (26) thereto; characterized in that the securing means include a first channel (240, 242), a second channel (246, 248), a first cylindrical member (252), and a second cylindrical member (254) for receiving the plurality of frame members, and in that the coupling means include a first web (232) and a second web (234) for receiving a steering post (260) of the steering assembly.

25

30

23. The connector of claim 22, characterized in that the first channel is intersected by the first cylindrical member and the second channel is intersected by the second cylindrical member.

5 24. The connector of claims 22 or 23, characterized in that the first channel includes an upper portion (242) and a lower portion (240), and the second channel includes an upper portion (248) and a lower portion (246), the first web extending between the upper portion of the first channel and the upper portion of the second channel, and the second web extending between the lower portion of the first
10 channel and the lower portion of the second channel.

25. The connector of claim 24, characterized in that the steering post is operatively coupled to a back face of the first web and a back face of the second web between 0-15 degrees.

15

26. The connector of any of claims 22-25, further characterized by a tab (256) for mounting a fuel tank to the connector.

27. The connector of any of claims 22-26, characterized in that each of the frame
20 members is secured to the connector with at least one of adhesive and fasteners.

28. A snowmobile (10) comprising a frame (12); a power train (204) supported by the frame and having an exhaust system; and a heat shield (304) positioned adjacent to a portion of the exhaust system; characterized in that insulation (302) is
25 proximate the heat shield such that the heat shield is intermediate the insulation and the portion of the exhaust system.

29. The snowmobile of claim 28, characterized in that the insulation is foam.

30. The snowmobile of claims 28 or 29, characterized in that the insulation is
30 intermediate the heat shield and an inner surface of a side panel (300) of the snowmobile.

31. The snowmobile of claim 30, characterized in that adhesive is applied to at least one of the insulation and the inner surface of the side panel, the adhesive being intermediate the insulation and the inner surface of the side panel.

5 32. The snowmobile of any of claims 28-31, characterized in that the heat shield includes a plurality of mounting feet (322) and the insulation includes a plurality of apertures (310), the plurality of mounting feet engaging with the plurality of apertures to couple the heat shield and the insulation.

10 33. A snowmobile (10) comprising a frame (12); and a power train (204) supported by the frame and having an air intake system, the intake system including at least one air inlet (210) having a housing (350) to reduce noise outputted by the intake system; characterized in that the housing includes a plurality of apertures (356) adjacent to a body of foam (354, 380).

15

34. The snowmobile of claim 33, characterized in that the air inlet further includes a retainer (352) coupled to the housing, the body of foam being intermediate the housing and the retainer.

20 35. The snowmobile of claim 34, characterized in that the retainer includes at least one lug (374), the body of foam includes at least one aperture (382), and the housing includes at least one latch (390, 392), the at least one lug corresponding to the at least one aperture and the at least one latch to couple the retainer to the body of foam and the housing.

25

36. The snowmobile of claims 34 or 35, characterized in that the housing has a generally rectangular shape including a front wall (360), opposing side walls (362, 366), and a rear wall (368), and the retainer has a generally rectangular shape including a front wall (370), opposing side walls (372, 376), and a partial rear wall (378), the front wall of the housing configured to couple with the front wall of the retainer, the opposing side walls of the housing configured to couple with the opposing side walls of the retainer, and the rear wall of the housing configured to couple with the partial rear wall of the retainer.

30

37. A snowmobile (10) comprising a frame (12) having a front end and a rear end; and a bumper assembly (450) supported by the rear end of the frame; characterized in that the bumper assembly includes a bumper (452) mounted to the rear end of the frame and at least one side bracket (454) coupled to the frame and the bumper, and
5 in that a snow flap (34) is hingedly mounted to the rear end of the frame and includes a stop member (490) for engaging with the bumper.

38. The snowmobile of claim 37, characterized in that the snow flap includes a plurality of apertures (192) to reduce the weight of the bumper assembly.

10

39. The snowmobile of claims 37 or 38, characterized in that the at least one side bracket includes at least one extruded opening (466) to retain the bumper therein.

15

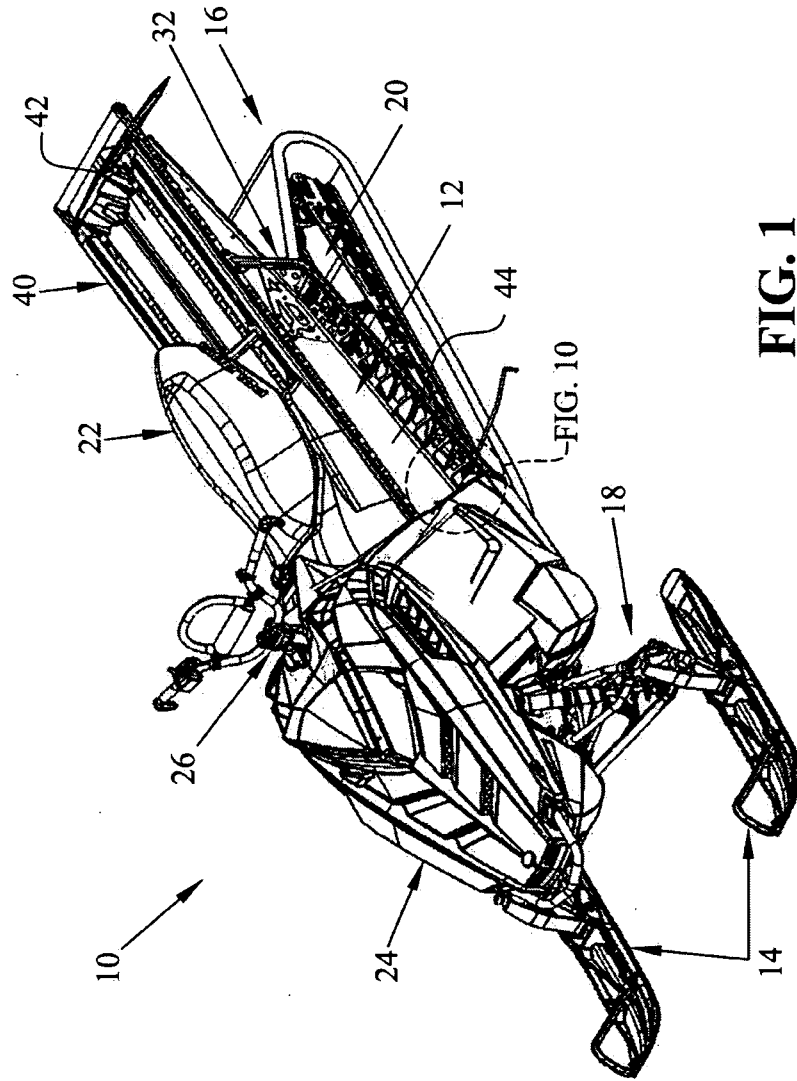

FIG. 1

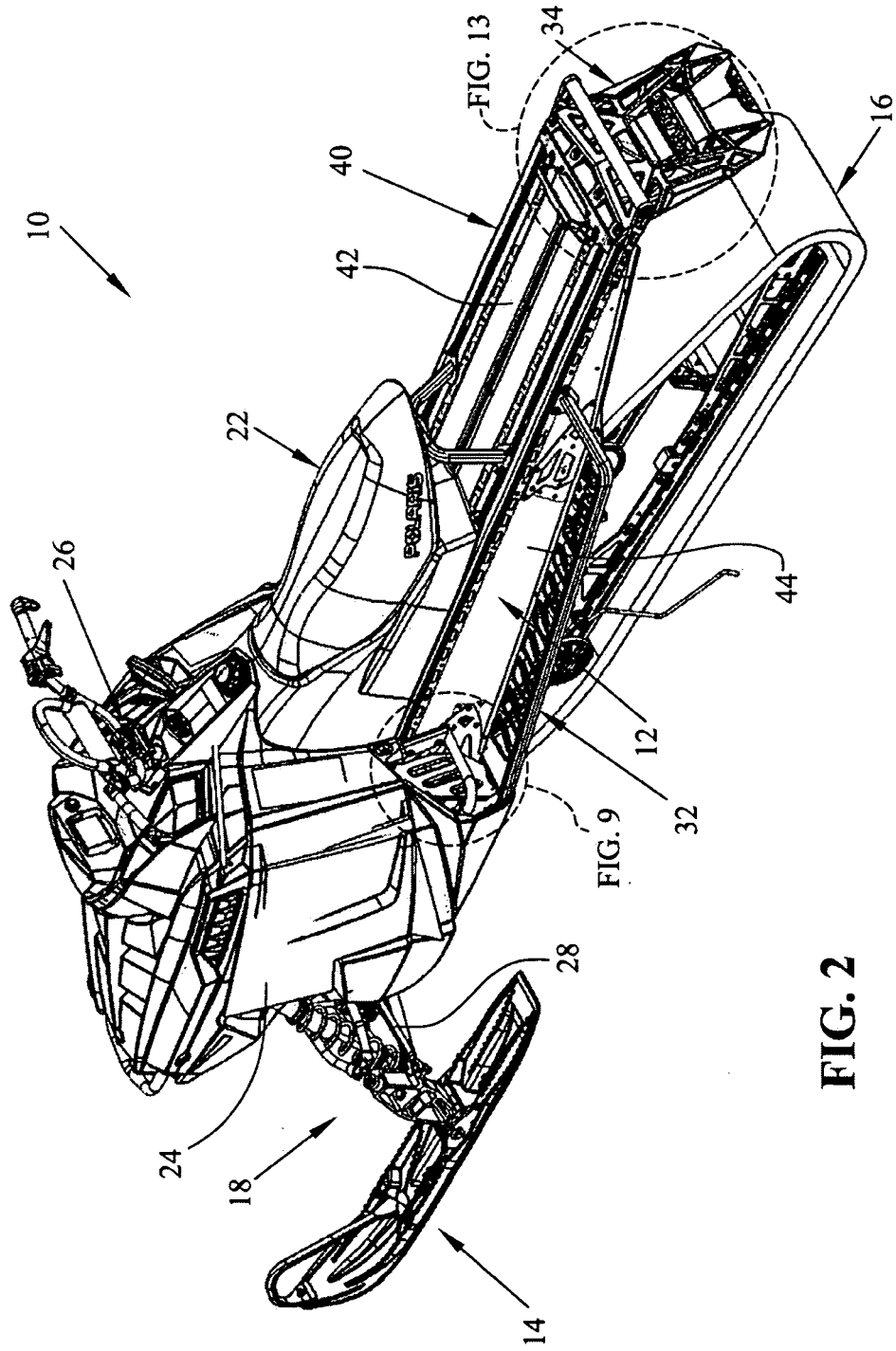
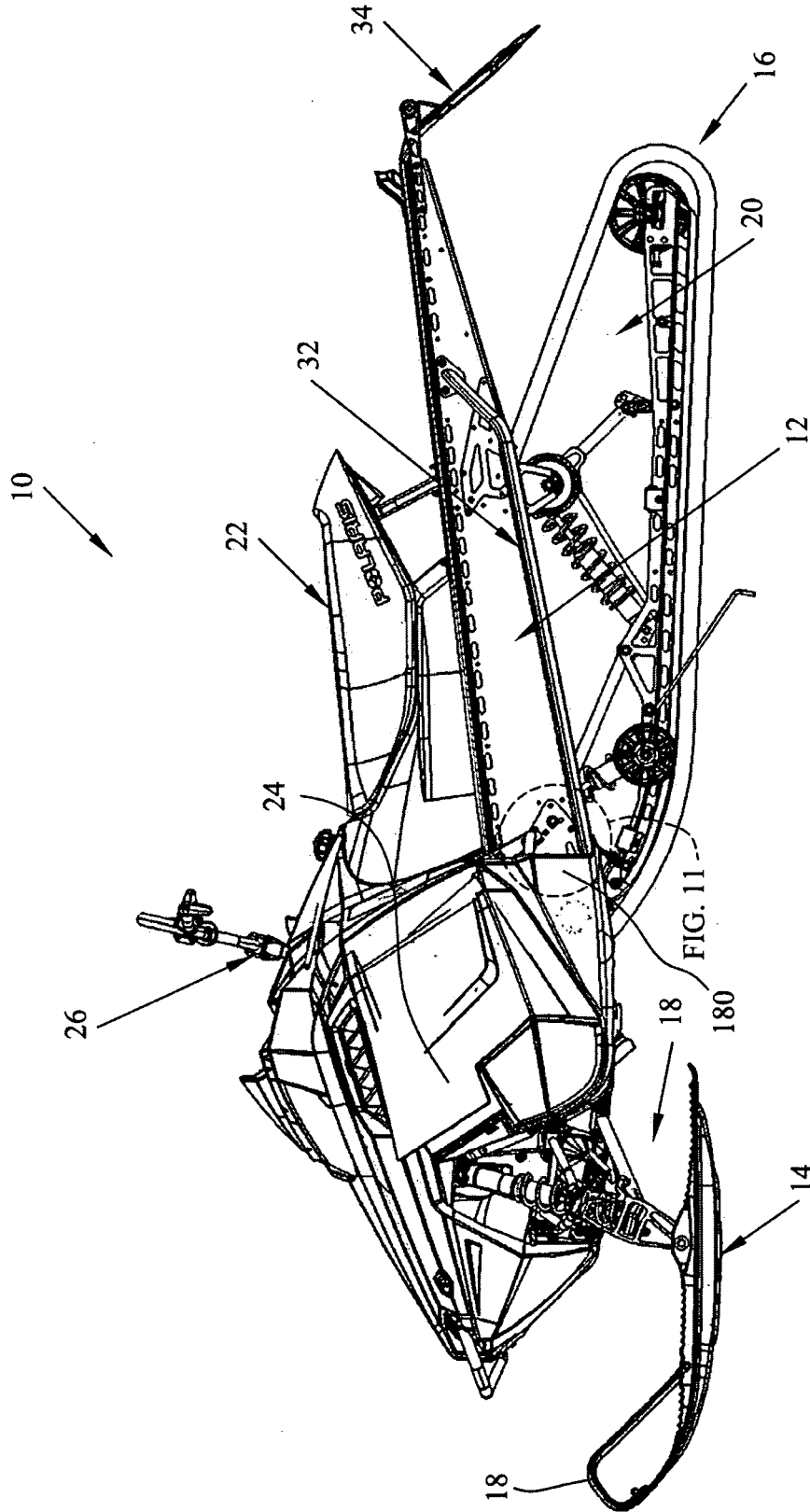

FIG. 2

3/22



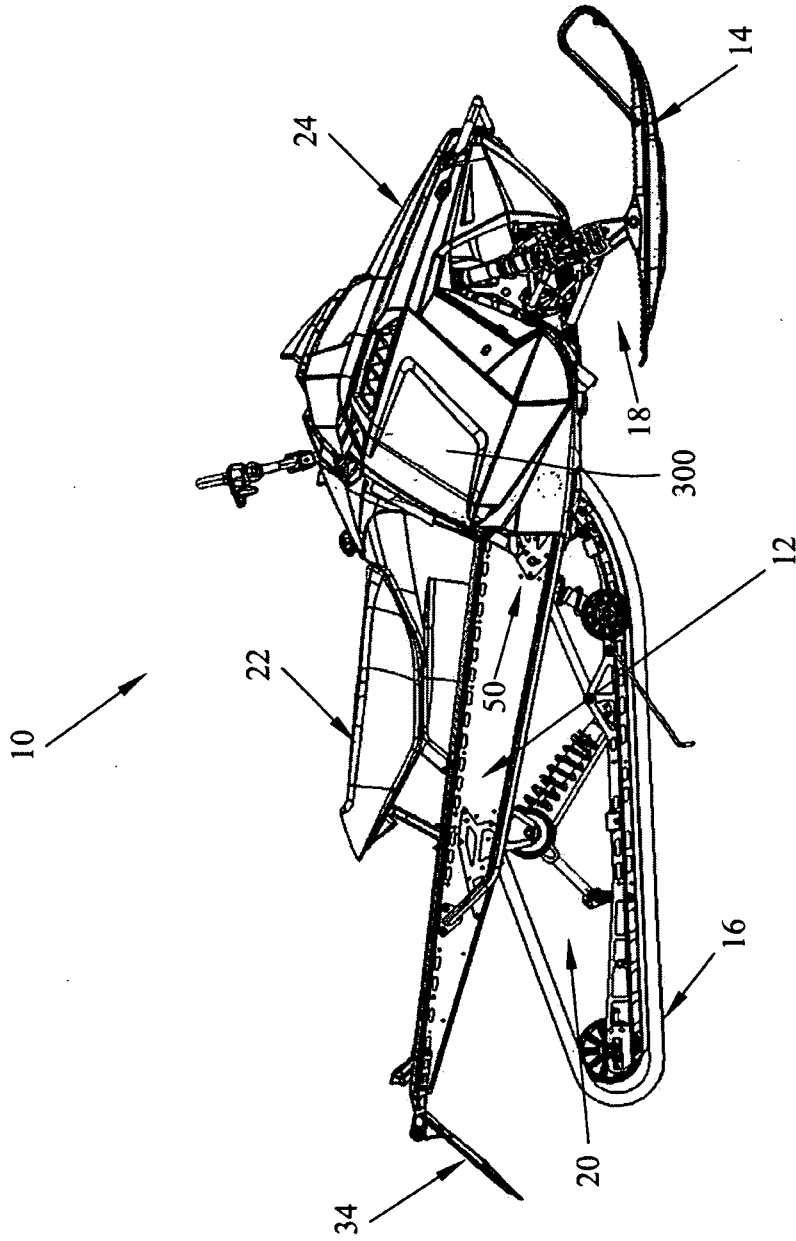

FIG. 4

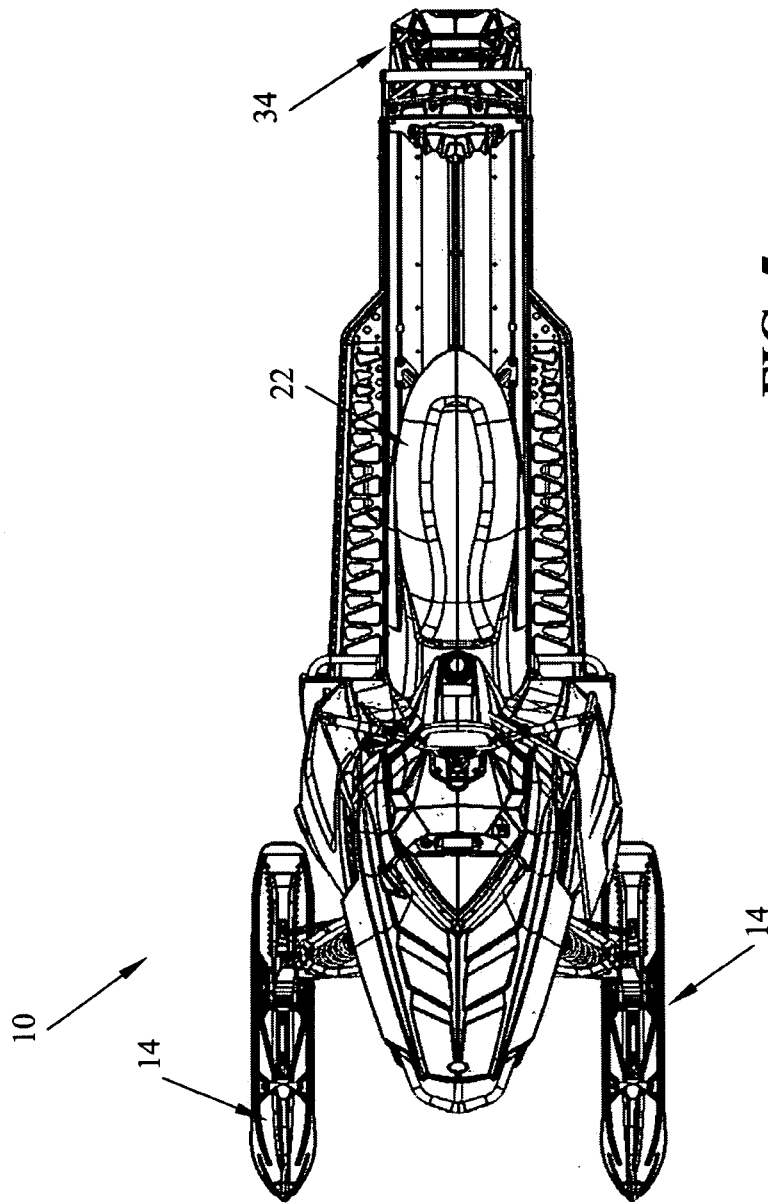
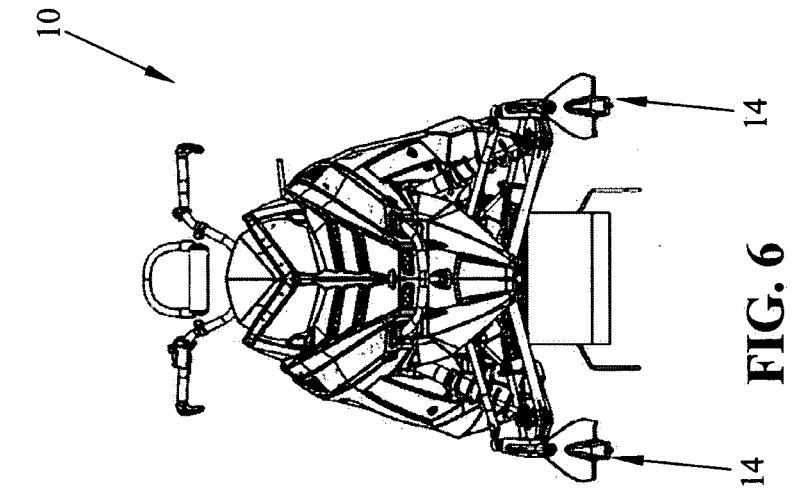
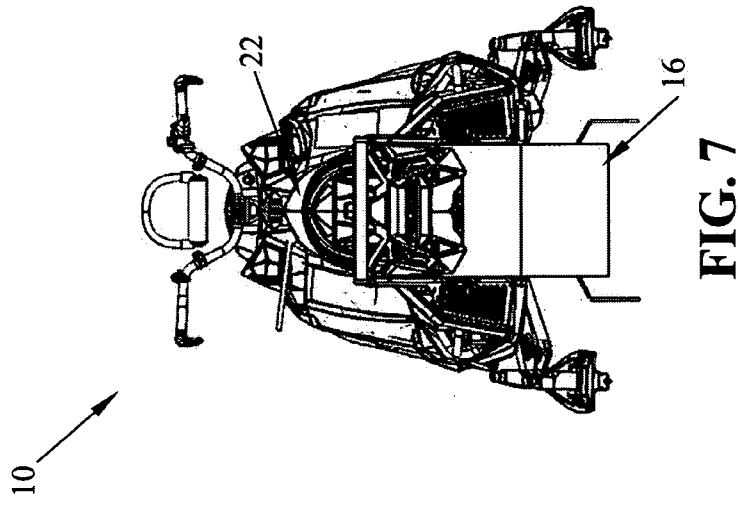

FIG. 5



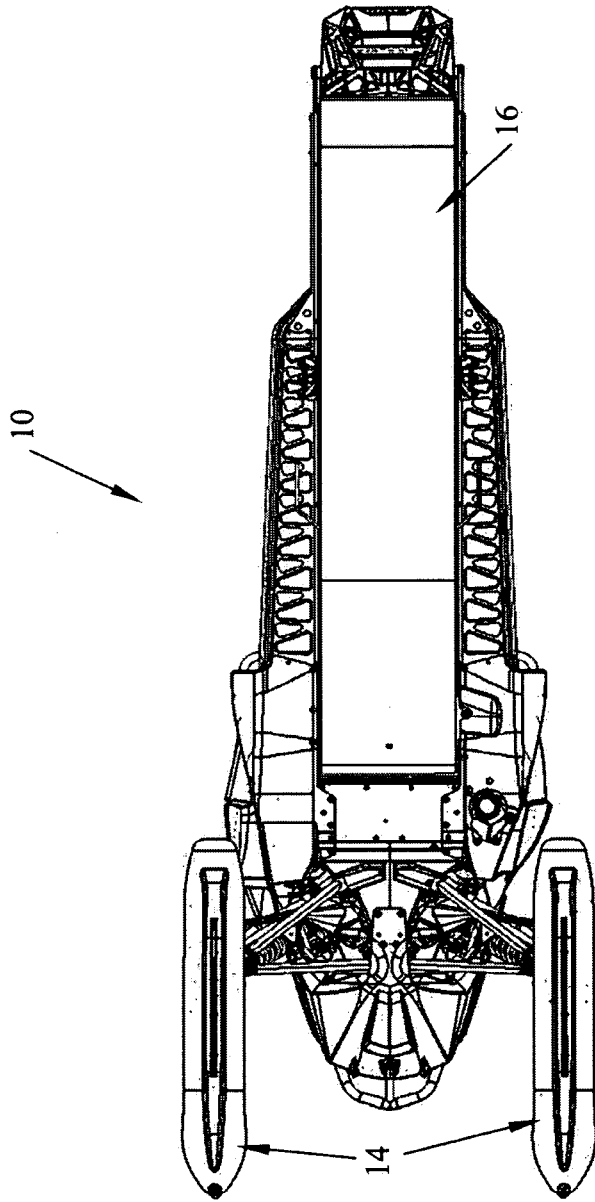

FIG. 8

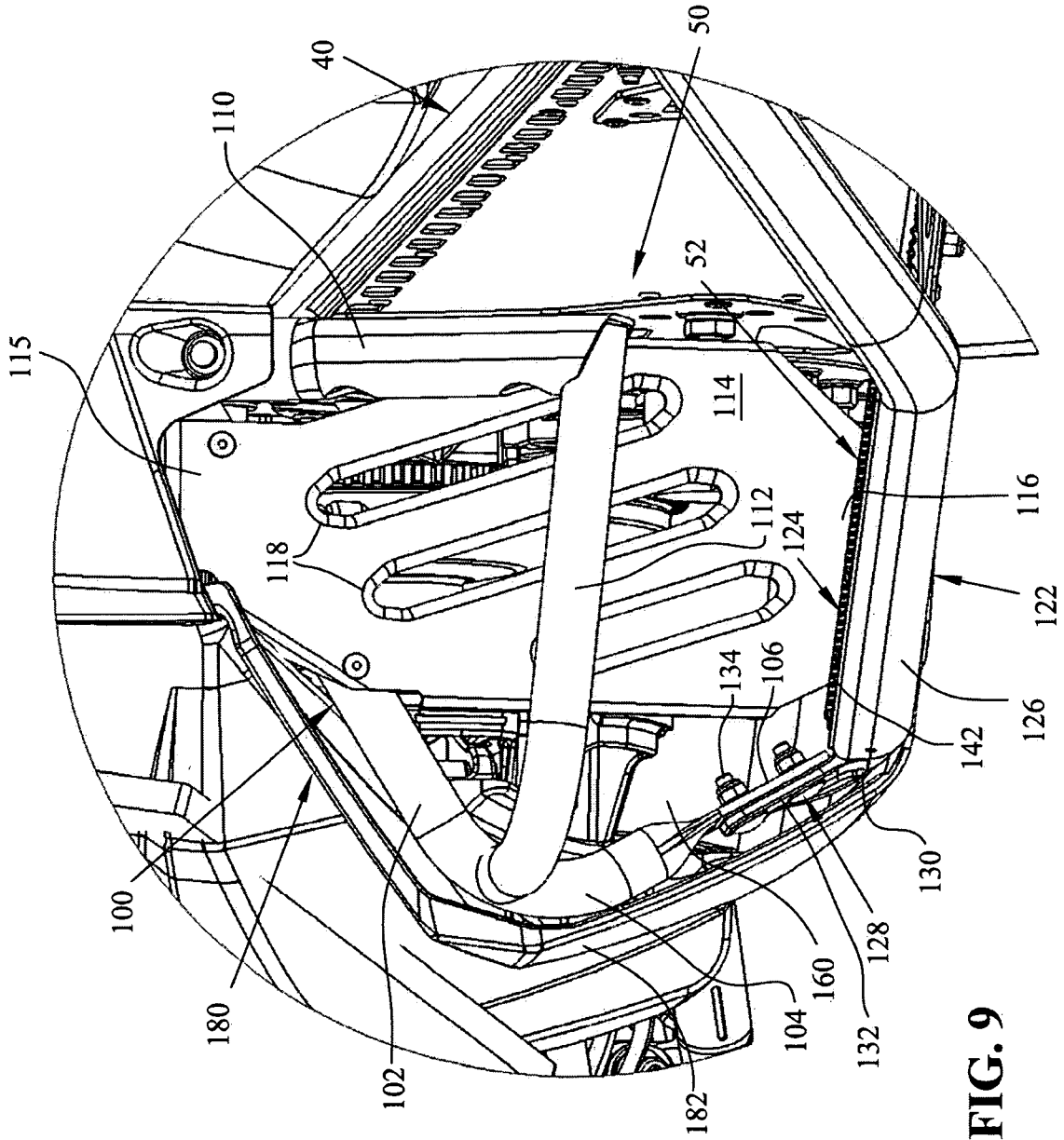

FIG. 9

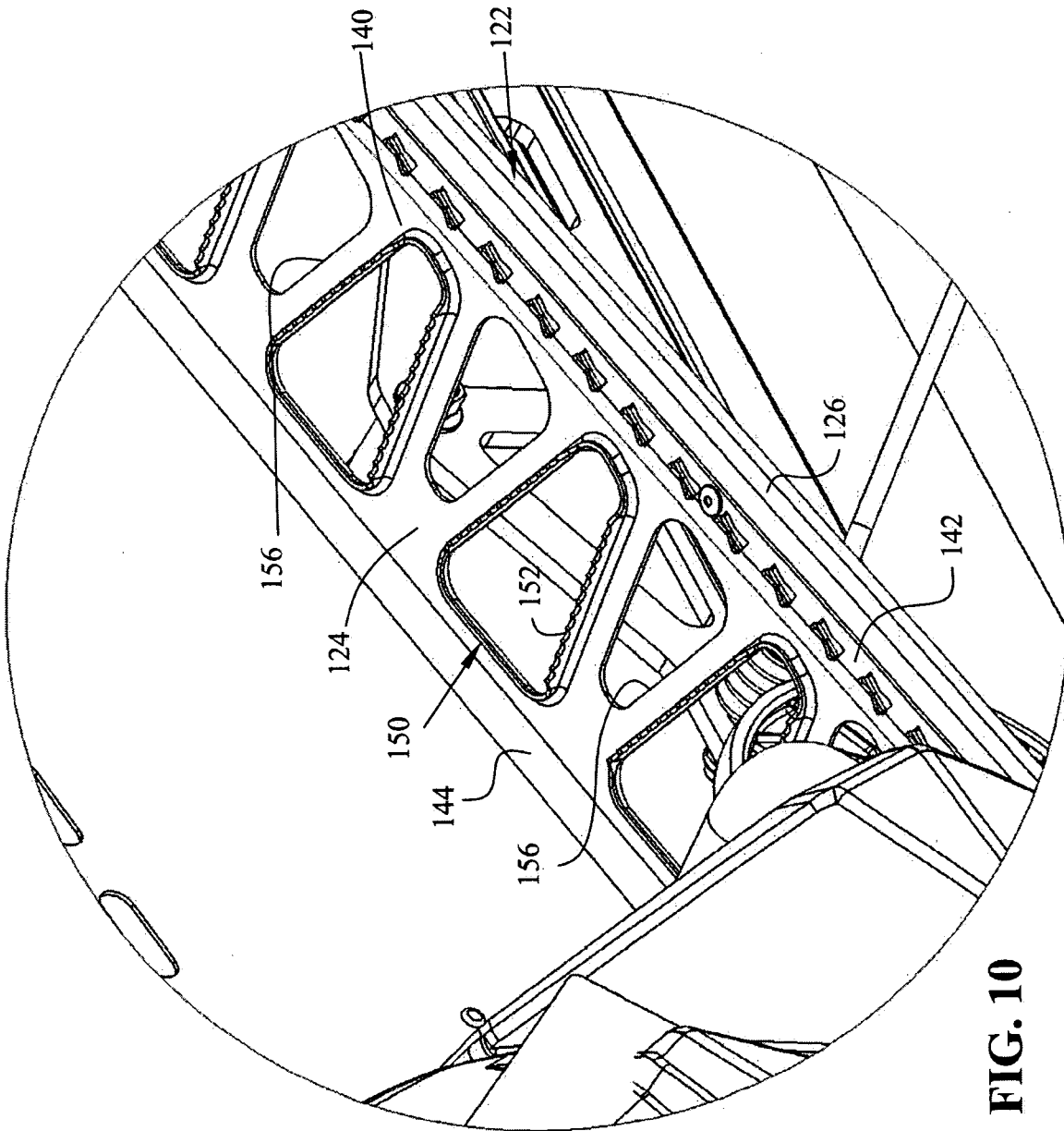

FIG. 10

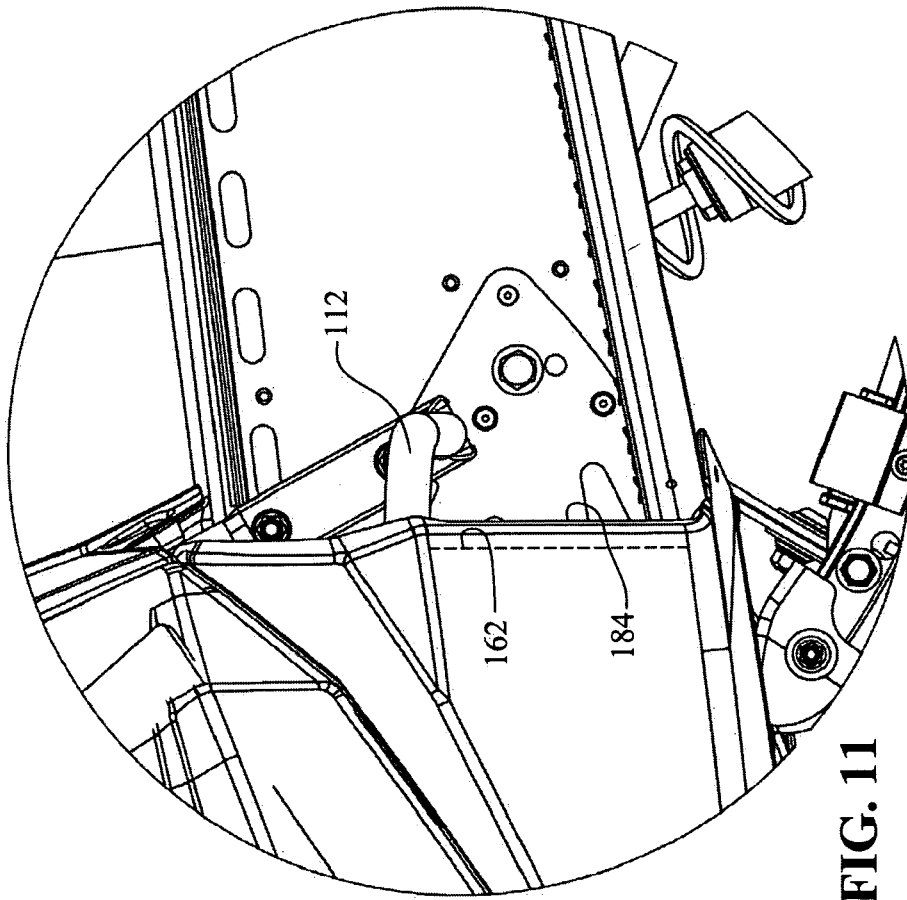

FIG. 11

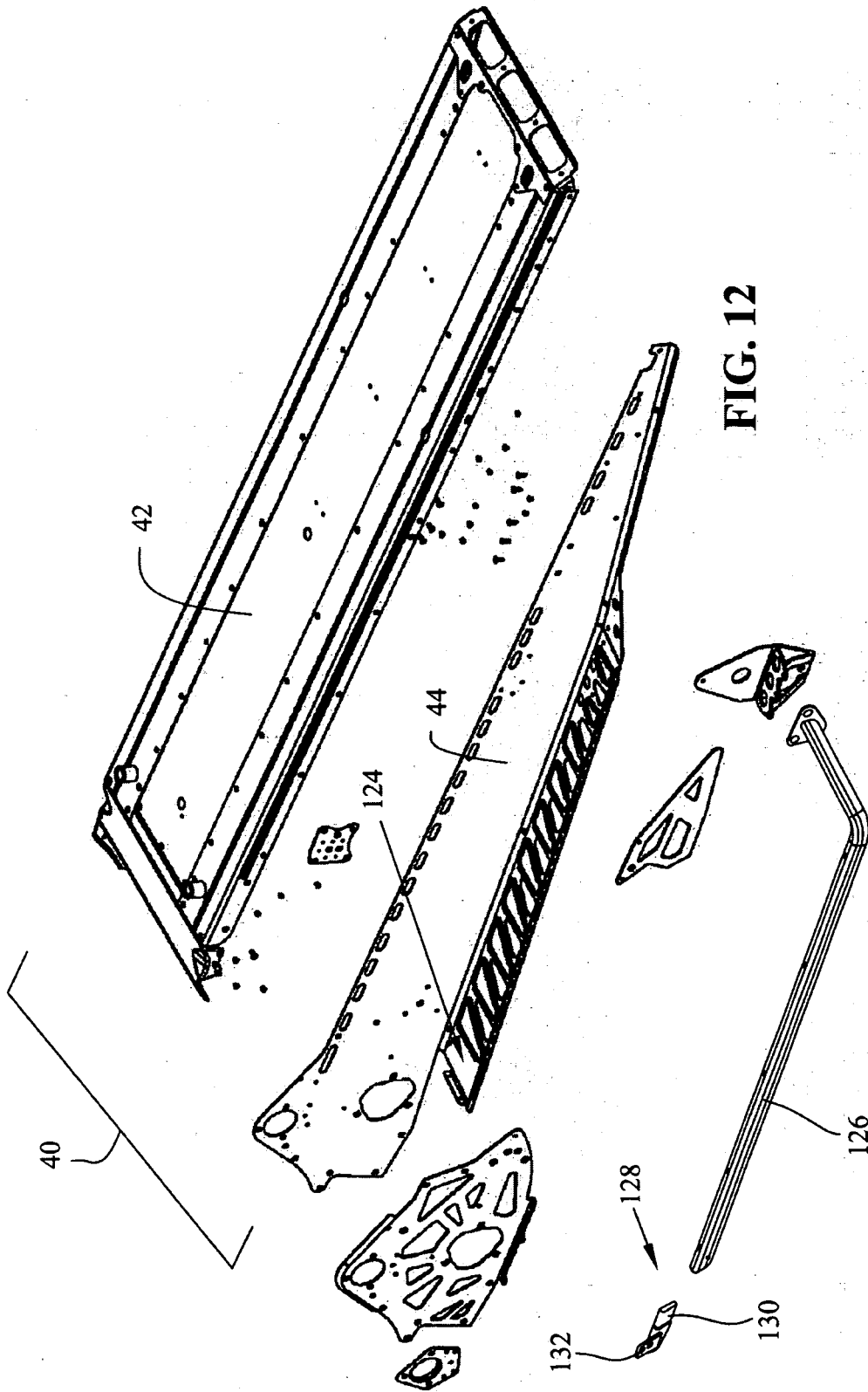

FIG. 12

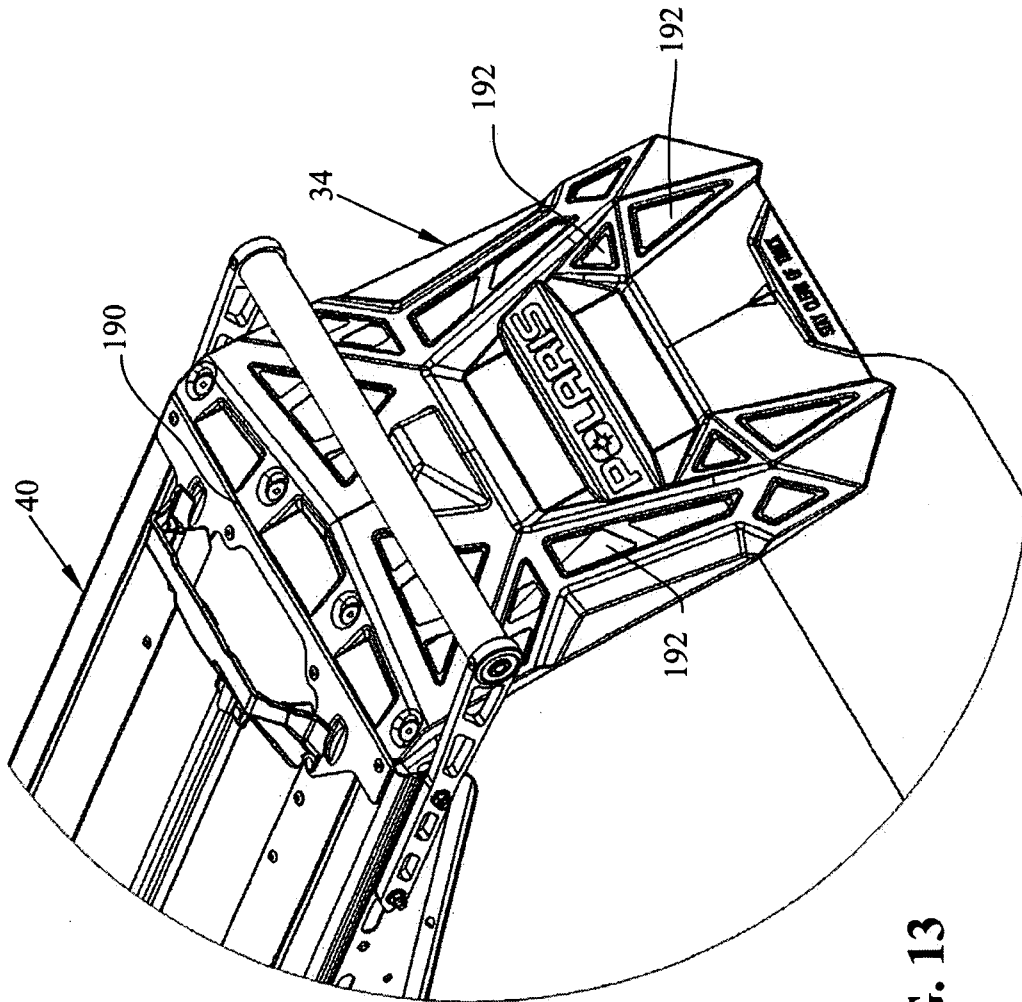

FIG. 13

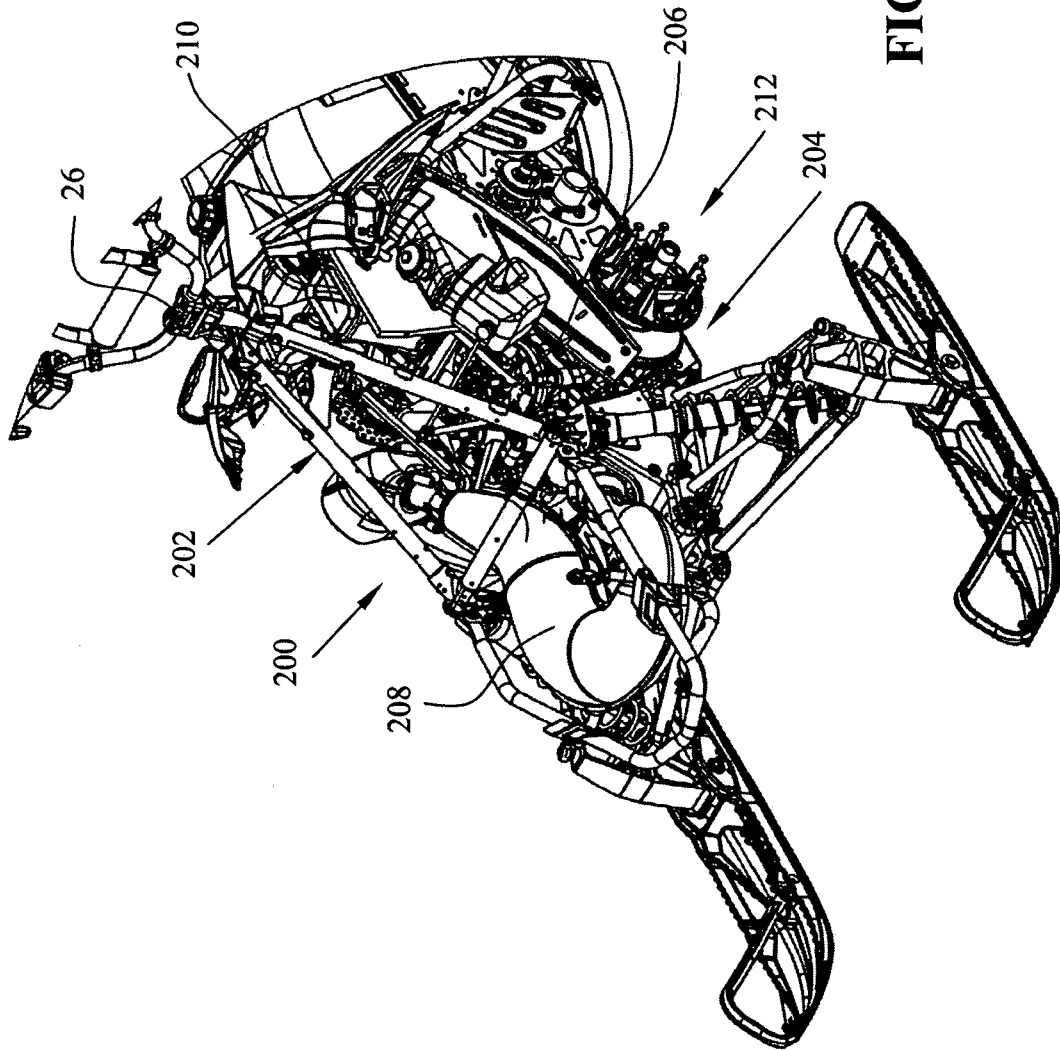

FIG. 14

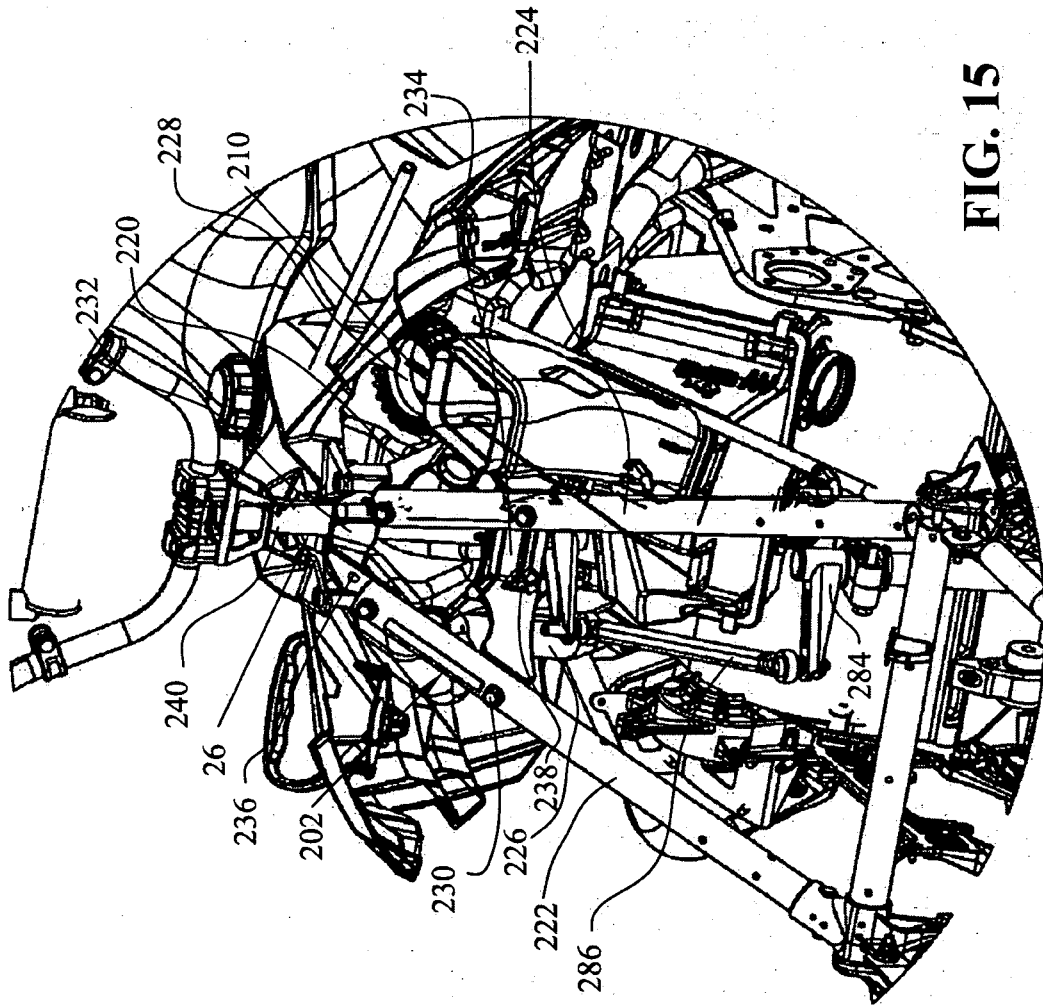

FIG. 15

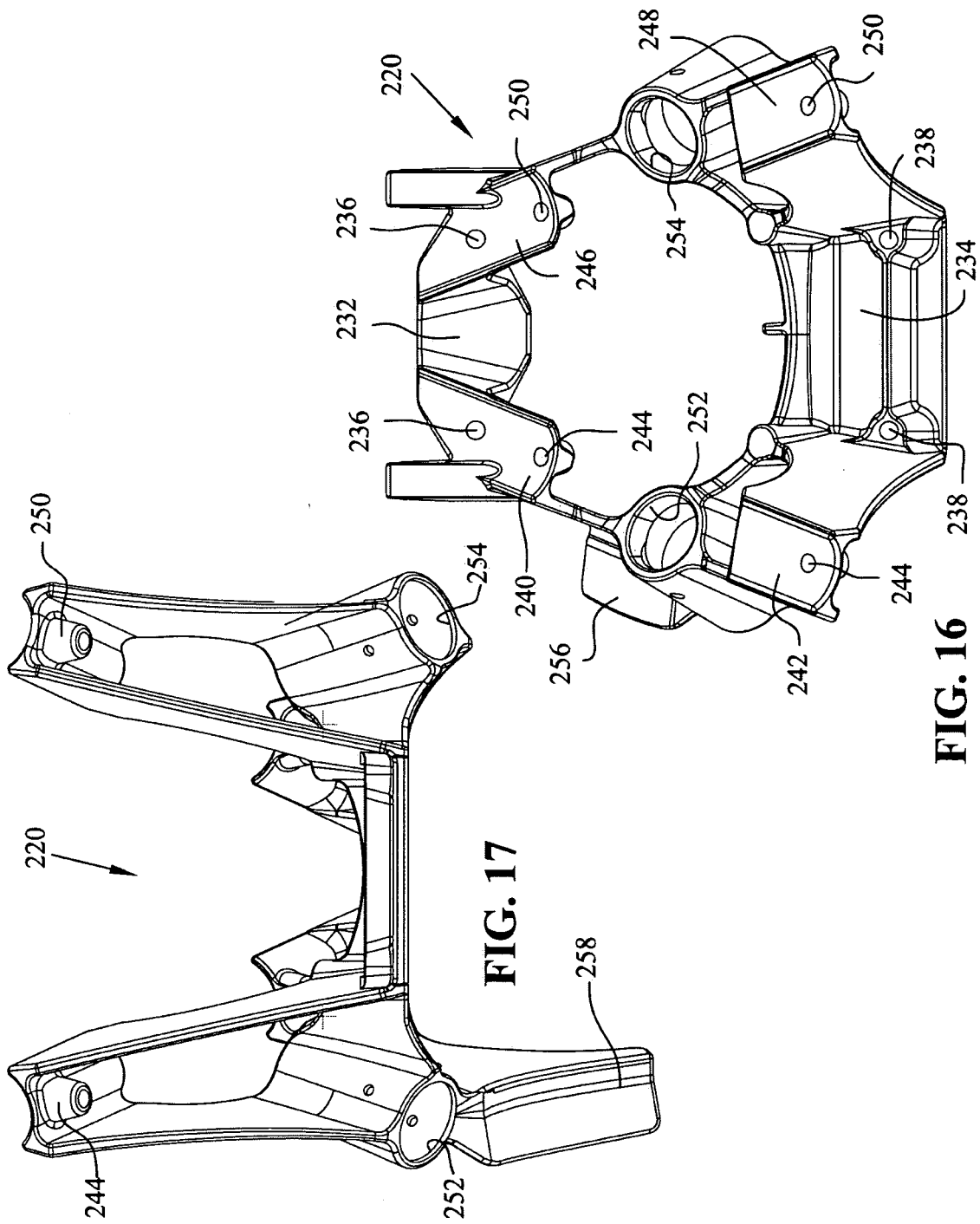

FIG. 16

FIG. 17

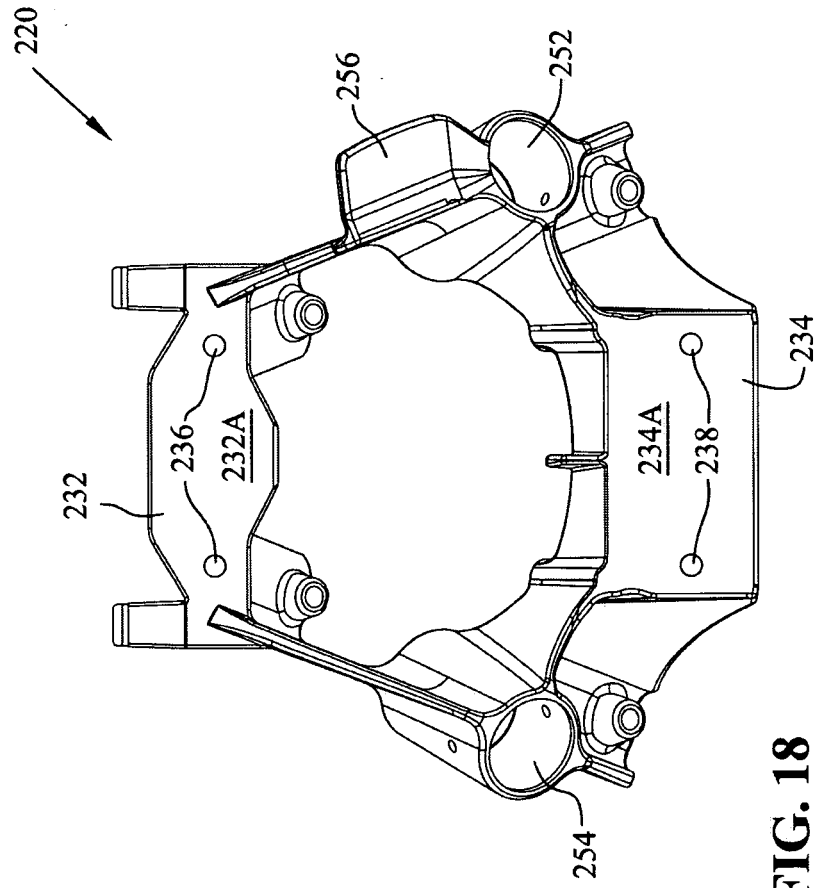
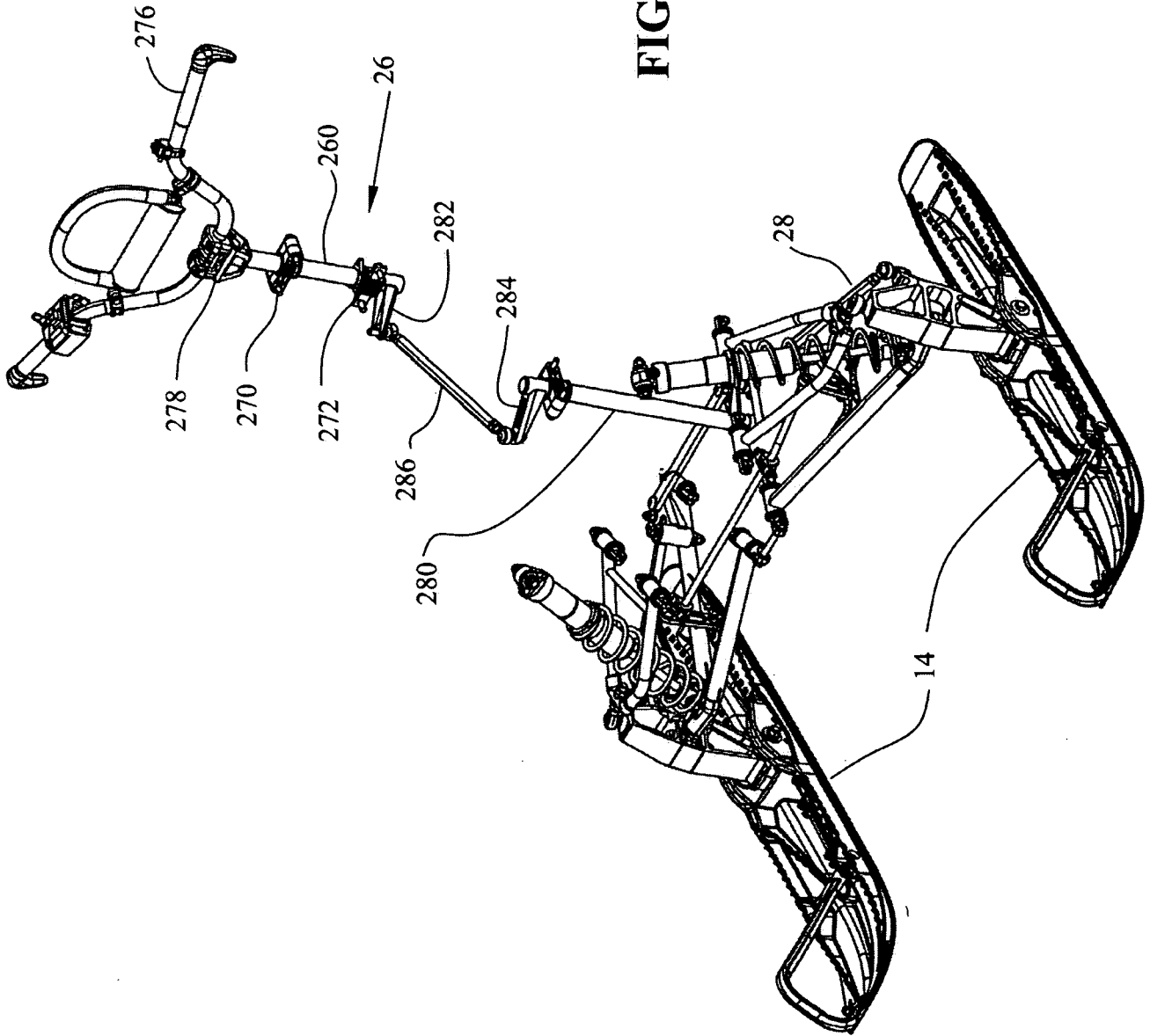

FIG. 18

FIG. 19



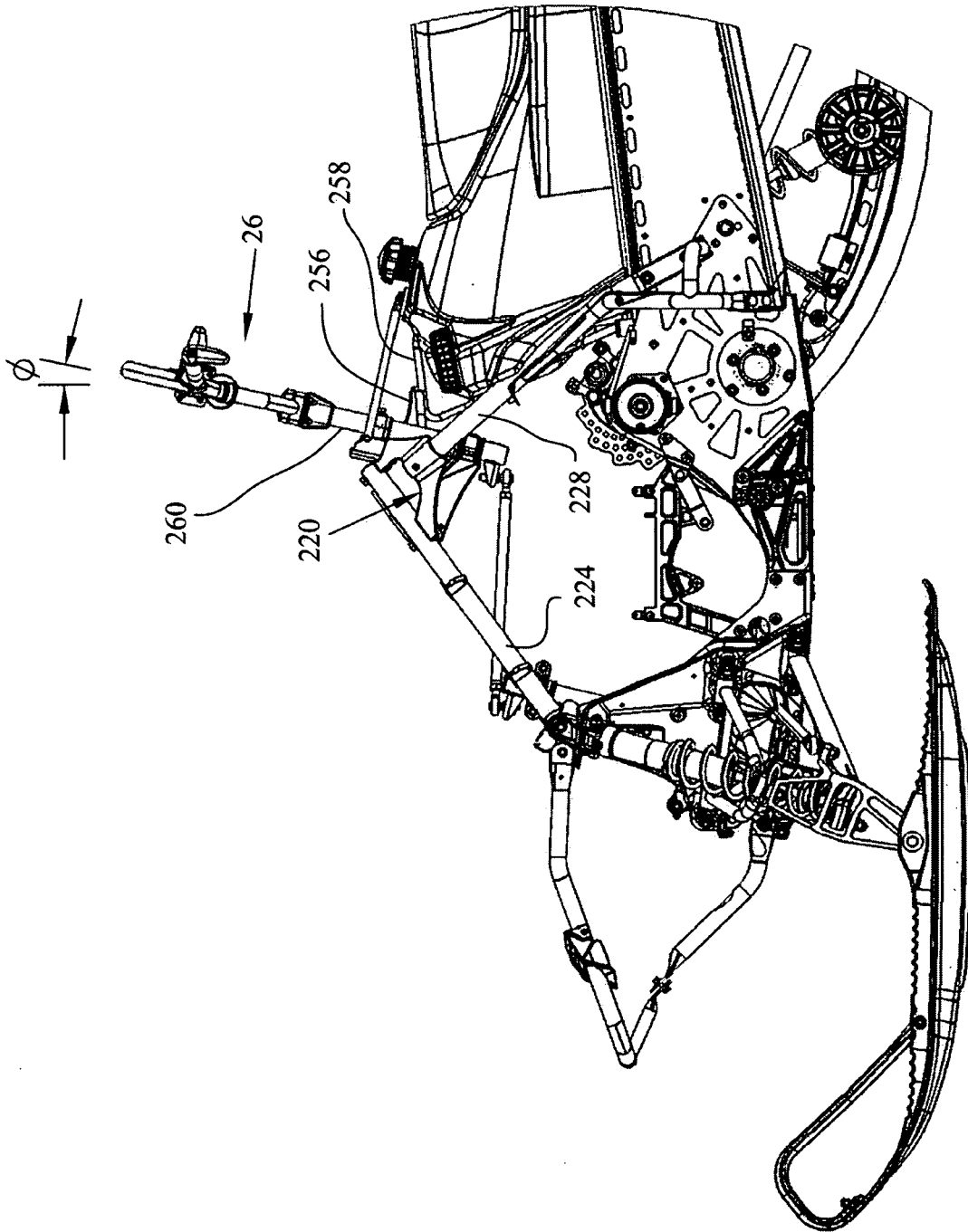

FIG. 20

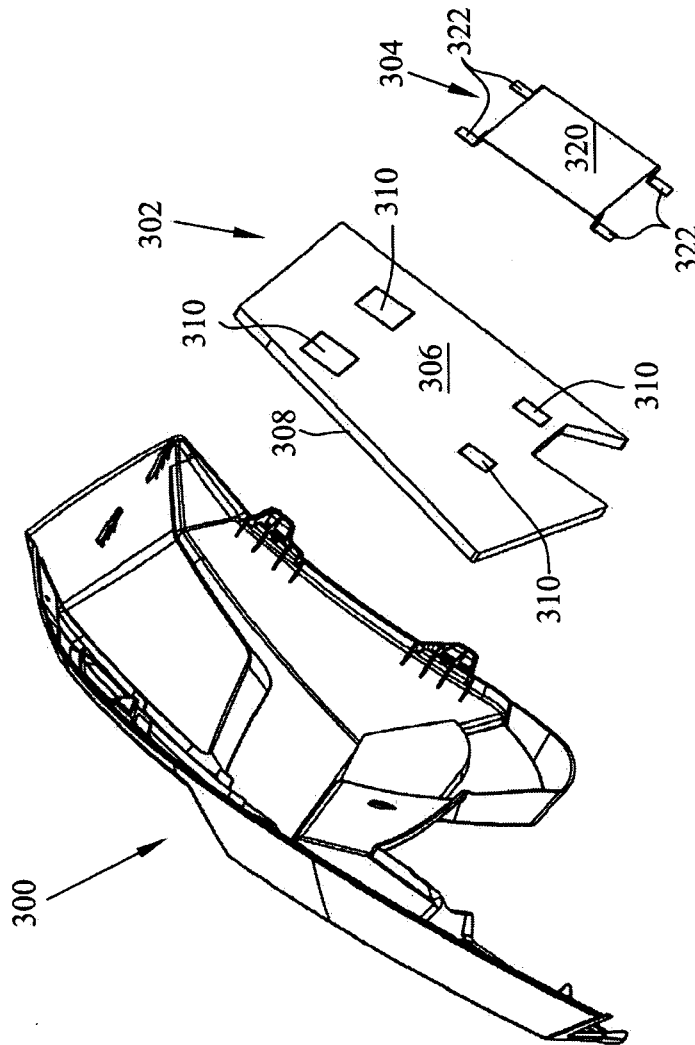

FIG. 21

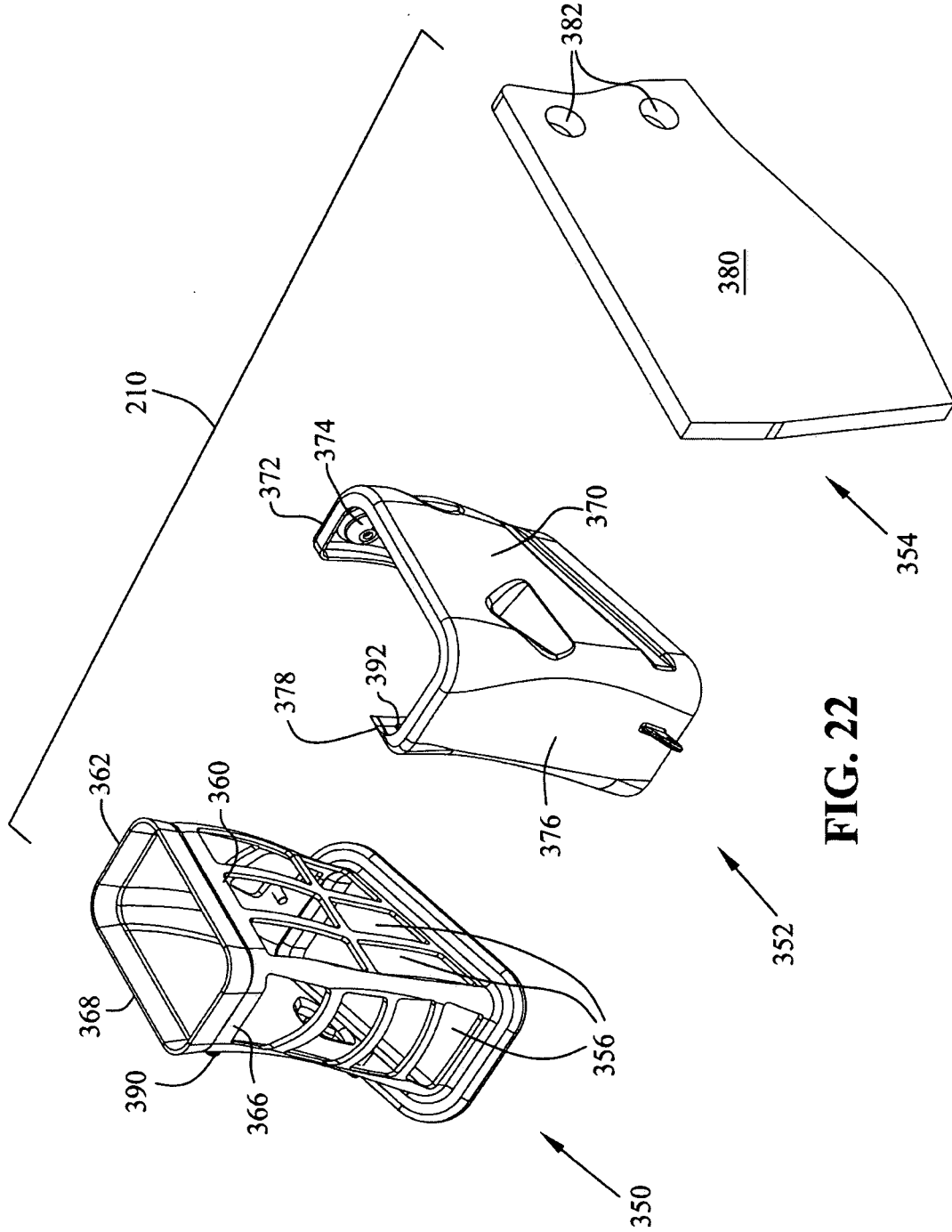

FIG. 22

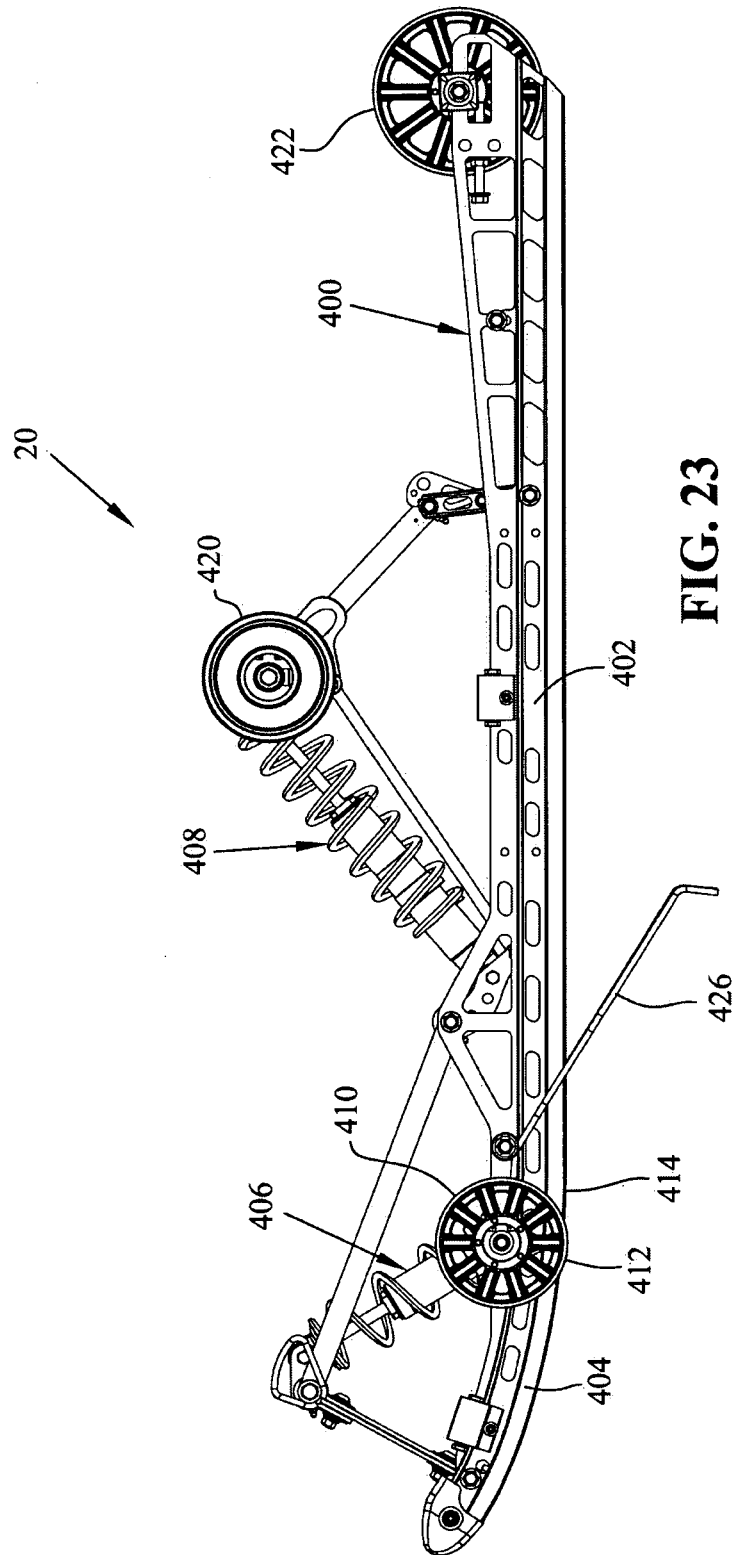

FIG. 23

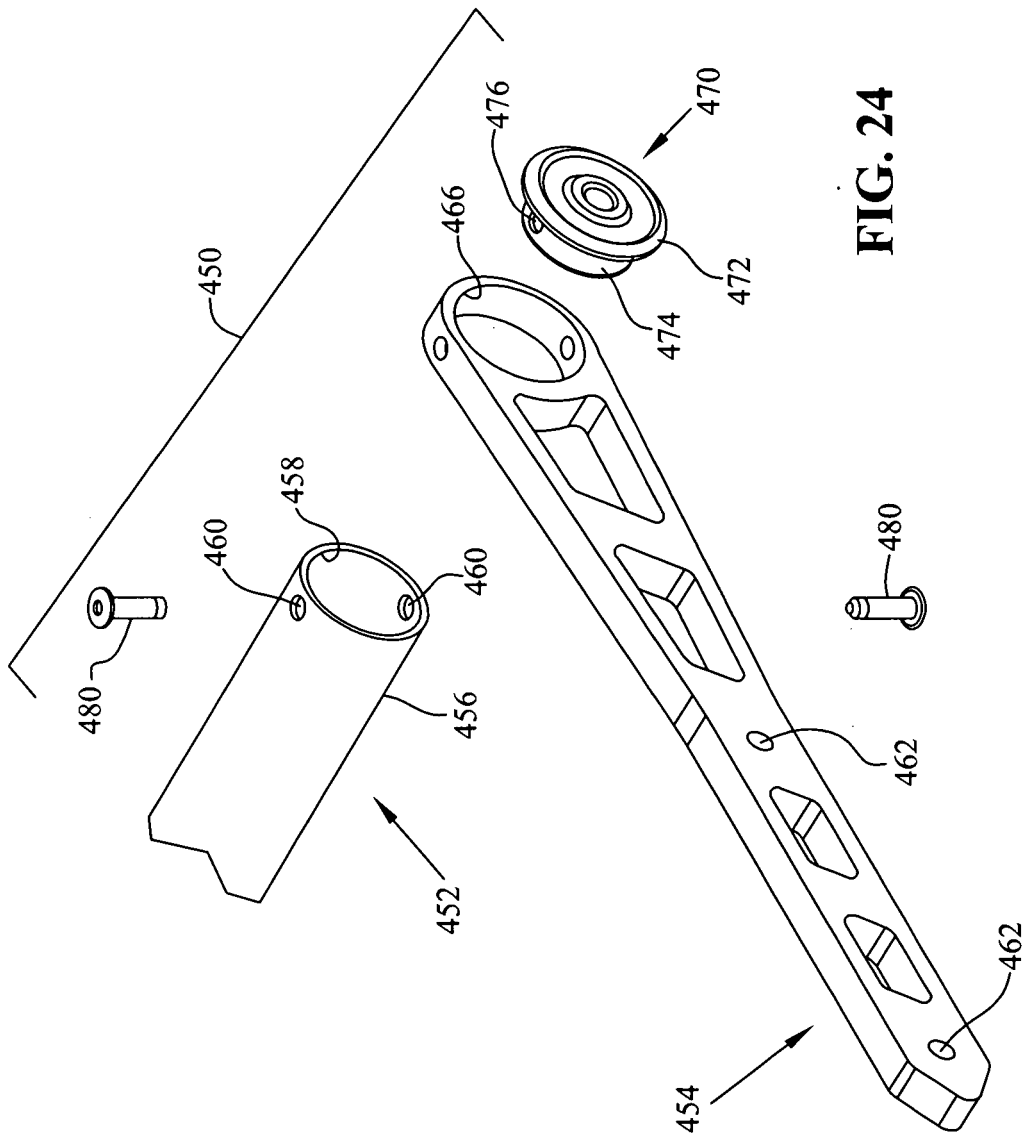

FIG. 24

INTERNATIONAL SEARCH REPORT

International application No PCT/US2010/003207

A. CLASSIFICATION OF SUBJECT MATTER INV. B62M27/02 B62J25/00 ADD.				
According to International Patent Classification (IPC) or to both national classification and IPC				
B. FIELDS SEARCHED				
Minimum documentation searched (classification system followed by classification symbols) B62M B62J				
Documentation searched other than minimum documentation to the extent that such documents are included in the fields searched				
Electronic data base consulted during the international search (name of data base and, where practical, search terms used) EPO-Internal				
C. DOCUMENTS CONSIDERED TO BE RELEVANT				
Category*	Citation of document, with indication, where appropriate, of the relevant passages	Relevant to claim No.		
X	US 2005/034909 A1 (VAISANEN ESA [FI]) 17 February 2005 (2005-02-17) abstract; figures -----	1-4		
X	US 7 533 749 B1 (SAMPSON MARTIN ELLIOTT [US] ET AL) 19 May 2009 (2009-05-19) abstract; figures figure 6 column 4, line 38 - line 43 -----	1,5-7		
Y		8-13		
X	WO 2009/114414 A1 (POLARIS INC [US]; BORUD ERIC J [US]; EATON JEFFREY A [US]; KERNER RICH) 17 September 2009 (2009-09-17) abstract; figures -----	14-27		
Y		8-13		
A		1,5		
	----- -/--			
<input checked="" type="checkbox"/> Further documents are listed in the continuation of Box C. <input checked="" type="checkbox"/> See patent family annex.				
* Special categories of cited documents : <table style="width: 100%; border: none;"> <tr> <td style="width: 50%; border: none; vertical-align: top;"> "A" document defining the general state of the art which is not considered to be of particular relevance "E" earlier document but published on or after the international filing date "L" document which may throw doubts on priority claim(s) or which is cited to establish the publication date of another citation or other special reason (as specified) "O" document referring to an oral disclosure, use, exhibition or other means "P" document published prior to the international filing date but later than the priority date claimed </td> <td style="width: 50%; border: none; vertical-align: top;"> "T" later document published after the international filing date or priority date and not in conflict with the application but cited to understand the principle or theory underlying the invention "X" document of particular relevance; the claimed invention cannot be considered novel or cannot be considered to involve an inventive step when the document is taken alone "Y" document of particular relevance; the claimed invention cannot be considered to involve an inventive step when the document is combined with one or more other such documents, such combination being obvious to a person skilled in the art. "&" document member of the same patent family </td> </tr> </table>			"A" document defining the general state of the art which is not considered to be of particular relevance "E" earlier document but published on or after the international filing date "L" document which may throw doubts on priority claim(s) or which is cited to establish the publication date of another citation or other special reason (as specified) "O" document referring to an oral disclosure, use, exhibition or other means "P" document published prior to the international filing date but later than the priority date claimed	"T" later document published after the international filing date or priority date and not in conflict with the application but cited to understand the principle or theory underlying the invention "X" document of particular relevance; the claimed invention cannot be considered novel or cannot be considered to involve an inventive step when the document is taken alone "Y" document of particular relevance; the claimed invention cannot be considered to involve an inventive step when the document is combined with one or more other such documents, such combination being obvious to a person skilled in the art. "&" document member of the same patent family
"A" document defining the general state of the art which is not considered to be of particular relevance "E" earlier document but published on or after the international filing date "L" document which may throw doubts on priority claim(s) or which is cited to establish the publication date of another citation or other special reason (as specified) "O" document referring to an oral disclosure, use, exhibition or other means "P" document published prior to the international filing date but later than the priority date claimed	"T" later document published after the international filing date or priority date and not in conflict with the application but cited to understand the principle or theory underlying the invention "X" document of particular relevance; the claimed invention cannot be considered novel or cannot be considered to involve an inventive step when the document is taken alone "Y" document of particular relevance; the claimed invention cannot be considered to involve an inventive step when the document is combined with one or more other such documents, such combination being obvious to a person skilled in the art. "&" document member of the same patent family			
Date of the actual completion of the international search	Date of mailing of the international search report			
29 April 2011	06/05/2011			
Name and mailing address of the ISA/ European Patent Office, P.B. 5818 Patentlaan 2 NL - 2280 HV Rijswijk Tel. (+31-70) 340-2040, Fax: (+31-70) 340-3016	Authorized officer Wagner, Helmut			

7

INTERNATIONAL SEARCH REPORT

International application No
PCT/US2010/003207

C(Continuation). DOCUMENTS CONSIDERED TO BE RELEVANT

Category*	Citation of document, with indication, where appropriate, of the relevant passages	Relevant to claim No.
X	WO 2008/060265 A2 (POLARIS INC [US]; BERG NORMAN O [US]; HAGEN ELLSWORTH J [US]; BATES RI) 22 May 2008 (2008-05-22) abstract; figure 17A -----	5
X	US 2004/104062 A1 (BEDARD YVON [CA] ET AL) 3 June 2004 (2004-06-03) abstract; figure 3 -----	1
X	US 2007/284171 A1 (OKADA HIROYUKI [JP] ET AL) 13 December 2007 (2007-12-13) abstract; figures -----	1
A	US 2005/039962 A1 (BEDARD YVON [CA]) 24 February 2005 (2005-02-24) abstract; figures -----	1,5

INTERNATIONAL SEARCH REPORT

International application No.
PCT/US2010/003207

Box No. II Observations where certain claims were found unsearchable (Continuation of item 2 of first sheet)

This international search report has not been established in respect of certain claims under Article 17(2)(a) for the following reasons:

1. Claims Nos.:
because they relate to subject matter not required to be searched by this Authority, namely:

2. Claims Nos.:
because they relate to parts of the international application that do not comply with the prescribed requirements to such an extent that no meaningful international search can be carried out, specifically:

3. Claims Nos.:
because they are dependent claims and are not drafted in accordance with the second and third sentences of Rule 6.4(a).

Box No. III Observations where unity of invention is lacking (Continuation of item 3 of first sheet)

This International Searching Authority found multiple inventions in this international application, as follows:

see additional sheet

1. As all required additional search fees were timely paid by the applicant, this international search report covers all searchable claims.
2. As all searchable claims could be searched without effort justifying an additional fees, this Authority did not invite payment of additional fees.
3. As only some of the required additional search fees were timely paid by the applicant, this international search report covers only those claims for which fees were paid, specifically claims Nos.:

1-27
4. No required additional search fees were timely paid by the applicant. Consequently, this international search report is restricted to the invention first mentioned in the claims; it is covered by claims Nos.:

Remark on Protest

- The additional search fees were accompanied by the applicant's protest and, where applicable, the payment of a protest fee.
- The additional search fees were accompanied by the applicant's protest but the applicable protest fee was not paid within the time limit specified in the invitation.
- No protest accompanied the payment of additional search fees.

INTERNATIONAL SEARCH REPORT

Information on patent family members

International application No
PCT/US2010/003207

Patent document cited in search report	Publication date	Patent family member(s)	Publication date
US 2005034909	A1	17-02-2005	NONE
US 7533749	B1	19-05-2009	US 7775313 B1 17-08-2010
WO 2009114414	A1	17-09-2009	CA 2714434 A1 17-09-2009
WO 2008060265	A2	22-05-2008	NONE
US 2004104062	A1	03-06-2004	US 2005072615 A1 07-04-2005
US 2007284171	A1	13-12-2007	NONE
US 2005039962	A1	24-02-2005	NONE

FURTHER INFORMATION CONTINUED FROM PCT/ISA/ 210

This International Searching Authority found multiple (groups of) inventions in this international application, as follows:

1. claims: 1-7

Snowmobile with toe clip and details of back wall.

2. claims: 8-13

Snowmobile with details of running board plate

3. claims: 14-27

Snowmobile with frame coupling details

4. claims: 28-32

Snowmobile with details of heat shield of the exhaust system

5. claims: 33-36

Snowmobile with details of air intake system

6. claims: 37-39

Snowmobile with details of the rear bumper and snow flap
