



US011332215B2

(12) **United States Patent**
Vigen

(10) **Patent No.:** **US 11,332,215 B2**
(45) **Date of Patent:** **May 17, 2022**

(54) **SNOW VEHICLE**

(71) Applicant: **Arctic Cat Inc.**, Thief River Falls, MN (US)

(72) Inventor: **David L. Vigen**, Thief River Falls, MN (US)

(73) Assignee: **ARCTIC CAT INC.**, Thief River Falls, MN (US)

(*) Notice: Subject to any disclaimer, the term of this patent is extended or adjusted under 35 U.S.C. 154(b) by 0 days.

(21) Appl. No.: **16/875,823**

(22) Filed: **May 15, 2020**

(65) **Prior Publication Data**

US 2020/0277023 A1 Sep. 3, 2020

Related U.S. Application Data

(63) Continuation-in-part of application No. 16/192,000, filed on Nov. 15, 2018.

(60) Provisional application No. 62/586,559, filed on Nov. 15, 2017.

(51) **Int. Cl.**
B62M 27/02 (2006.01)

(52) **U.S. Cl.**
CPC **B62M 27/02** (2013.01); **B62M 2027/023** (2013.01); **B62M 2027/025** (2013.01); **B62M 2027/027** (2013.01)

(58) **Field of Classification Search**
CPC B62M 27/02; B62M 2027/021; B62M 2027/023; B62M 2027/025; B62M 2027/027; B62M 2027/028
USPC 180/190, 182
See application file for complete search history.

(56) **References Cited**

U.S. PATENT DOCUMENTS

4,535,869 A 8/1985 Tsutsumikoshi et al.
4,620,604 A 11/1986 Talbot
4,688,817 A * 8/1987 Maher B62B 13/10
180/182
5,054,798 A * 10/1991 Zulawski B62B 13/08
280/16
5,474,146 A * 12/1995 Yoshioka B62K 13/00
180/184
5,586,614 A 12/1996 Kouchi et al.

(Continued)

FOREIGN PATENT DOCUMENTS

CA 2143383 C 10/2000
CA 2321860 C 10/2006

(Continued)

OTHER PUBLICATIONS

“Ez-Snow—World Cub”, <https://honda-ezcub.forumfree.it/?t=25454988>, Feb. 23, 2008, 5.

(Continued)

Primary Examiner — Minnah L Seoh
Assistant Examiner — Hosam Shabara

(74) *Attorney, Agent, or Firm* — Billion & Armitage

(57) **ABSTRACT**

Embodiments of the present disclosure describe a snow vehicle including an engine mounted on a frame, a drive track in contact with the frame, a drive train operatively interconnecting the engine with the drive track for delivering propulsive power to the drive track, a fork connected to the frame, one or more skis connected to the fork, a drop fork component positioned between a fork and handlebars, and an exhaust system. The drive train includes a continuously variable transmission (CVT) positioned within a CVT housing.

21 Claims, 43 Drawing Sheets

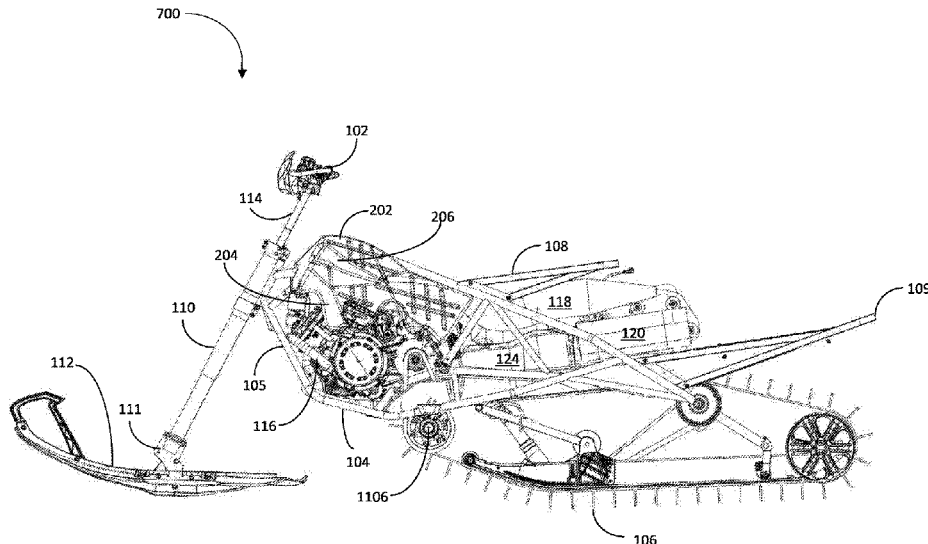

(56)

References Cited

U.S. PATENT DOCUMENTS

5,660,245 A 8/1997 Marier et al.
 5,727,643 A 3/1998 Kawano et al.
 5,791,431 A 8/1998 Asao et al.
 5,944,133 A 8/1999 Eto
 5,996,717 A 12/1999 Hisadomi
 6,095,275 A 8/2000 Shaw
 6,112,840 A 9/2000 Forbes
 6,234,263 B1 5/2001 Boivin et al.
 6,321,864 B1 11/2001 Forbes
 6,382,338 B1 5/2002 Forbes
 6,431,301 B1 8/2002 Forbes
 6,446,744 B2 9/2002 Wubbolts et al.
 6,467,787 B1* 10/2002 Marsh B62K 5/01
 180/182
 6,626,258 B1 9/2003 Forbes
 6,808,034 B2* 10/2004 Nakano B62M 27/02
 123/65 PE
 6,904,990 B2* 6/2005 Etou B62M 27/02
 180/190
 7,124,847 B2 10/2006 Girouard et al.
 7,124,848 B2 10/2006 Girouard et al.
 7,213,669 B2 5/2007 Fecteau et al.
 7,448,462 B2 11/2008 Toyochika
 7,475,751 B2* 1/2009 Pard B62M 27/00
 180/190
 7,815,003 B2 10/2010 Ferrer Almazan
 8,127,877 B2 3/2012 Fredrickson et al.
 8,910,738 B2 12/2014 Mangum
 8,978,794 B2 3/2015 Giese et al.
 9,321,509 B2 4/2016 Beavis
 9,352,802 B2 5/2016 Sampson
 9,809,195 B2* 11/2017 Giese B60R 25/34
 9,845,004 B2 12/2017 Hedlund et al.
 9,873,485 B2 1/2018 Mangum et al.
 10,493,846 B2 12/2019 Bennett et al.
 10,538,262 B2* 1/2020 Mangum B62B 17/04
 10,899,415 B2* 1/2021 Mangum B62D 55/07
 2002/0112909 A1* 8/2002 Nishijima B62M 27/02
 180/190
 2003/0201128 A1 10/2003 Girouard et al.
 2004/0129483 A1 7/2004 Girouard et al.
 2005/0194199 A1* 9/2005 Marks B62K 5/01
 180/332
 2006/0162977 A1* 7/2006 Etou B62M 27/02
 180/190
 2007/0193715 A1* 8/2007 Bergman B60K 11/04
 165/41

2015/0144412 A1 5/2015 Magnum
 2015/0197313 A1 7/2015 Vistad et al.
 2016/0167722 A1 6/2016 Anderson
 2018/0237106 A1 8/2018 Hedlund et al.
 2018/0273142 A1 9/2018 Mangum et al.
 2019/0047652 A1* 2/2019 Laberge B62M 7/02

FOREIGN PATENT DOCUMENTS

CA 2345490 C 2/2007
 CA 2555108 C 6/2009
 CA 2555039 C 12/2009
 CA 2561337 C 12/2010
 EP 0391282 B1 11/1992
 EP 1056639 B1 6/2003
 WO 2017031591 3/2017
 WO 2017031592 3/2017

OTHER PUBLICATIONS

“New Super-Duper”, Sep. 1969, 42-43.
 “Read Valve—Truth, Lies, Rumors, Falsehoods, Speculation”, Supertrax International, Jan. 1999, 4.
 “RM-2 Snowmobile—Winter”, 1990-1991, 1.
 “RMI—Ron Mooring’s Invention?”, SledHeads Magazine, vol. 1, Issue 1, Dec. 1999, 1.
 “World Snowmobile Association Black Magic Duluth National”, SnowAction Magazine, Dec. 1998, 3.
 Barkley16, “Honda EZ Snow The Real Deal”, <http://www.pilotodyssey.com/PO/viewtopic.php?f=4&t=15480&start=0>, Apr. 2, 2015, 6.
 Bassett, “The Snowbike Revolution”, <http://www.snowmobile.com/products/the-snow-bike-revolution-1995.html>, Sep. 23, 2015, 12.
 Carbonare, “Too Much Street Car Nationals Is Never Enough”, <http://www.speedhunters.com/2018/06/too-much-street-car-nationals-is-never-enough/>, Jun. 5, 2018, 65.
 Durtschi, “Size Really Does Matter—PSI Big Bore Engines”, Mod-Stock Competition, 1998, 18-19.
 Margo, “Triumph 675 Winter Edition”, <http://www.snowmobile.com/blog/2010/01/triumph-675-winter-edition.html>, Jan. 18, 2010, 3.
 Ramstad, et al., “Y2Kool Sleds to Come—What Will Tomorrow’s Snowmobiles Be Like?”, Supertrax International, 1999, 7.
 Taylor, “A Sand Mobile”, Aug. 1970, 82-83.
 Johnny, “Johnny’s Vintage Motorcycle Company”, [http://www.johnnysvintagemotorcycle.com/Bikes/Project-Bikes-\(parts\).aspx](http://www.johnnysvintagemotorcycle.com/Bikes/Project-Bikes-(parts).aspx), 2019, 2.

* cited by examiner

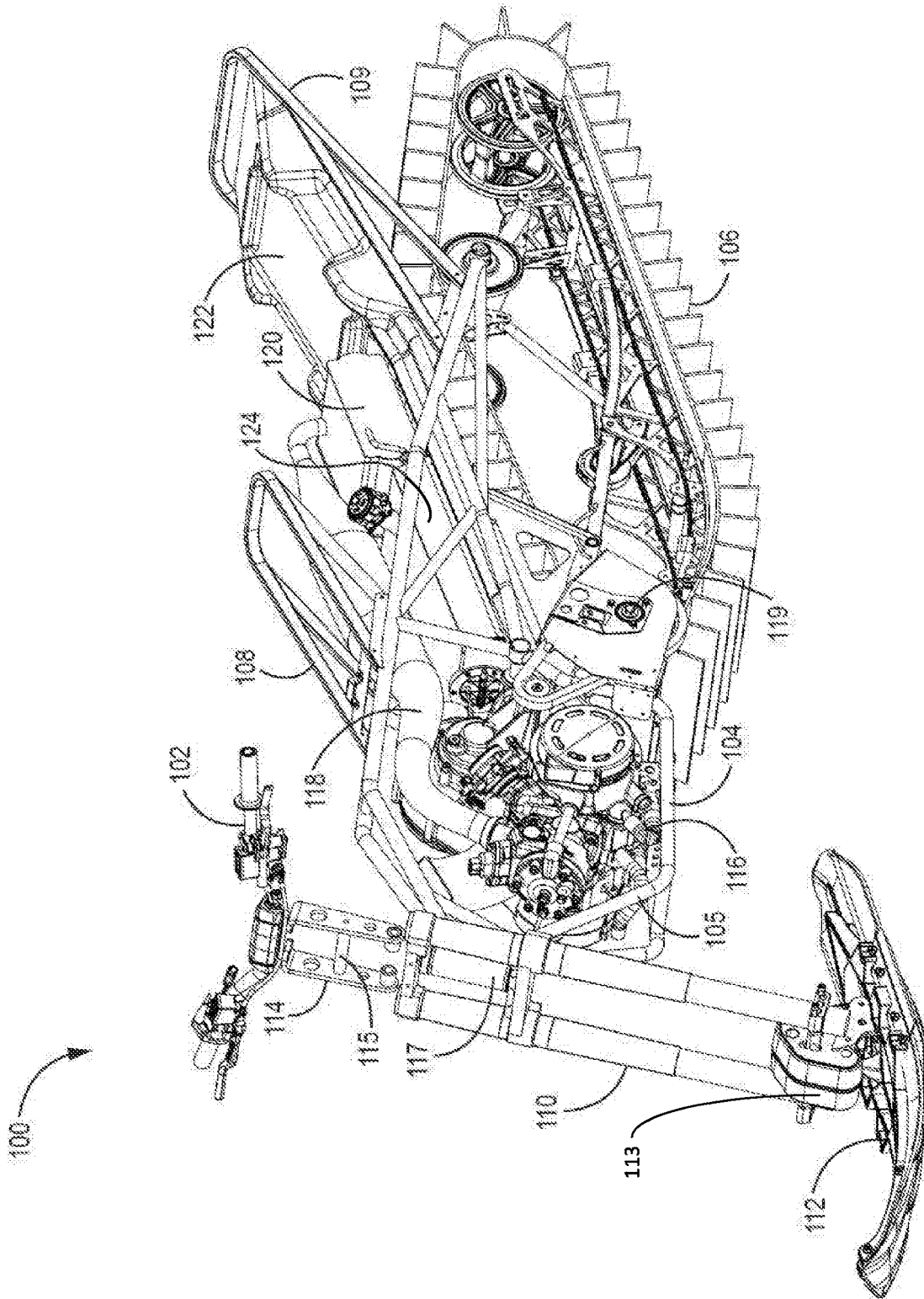

FIG. 1

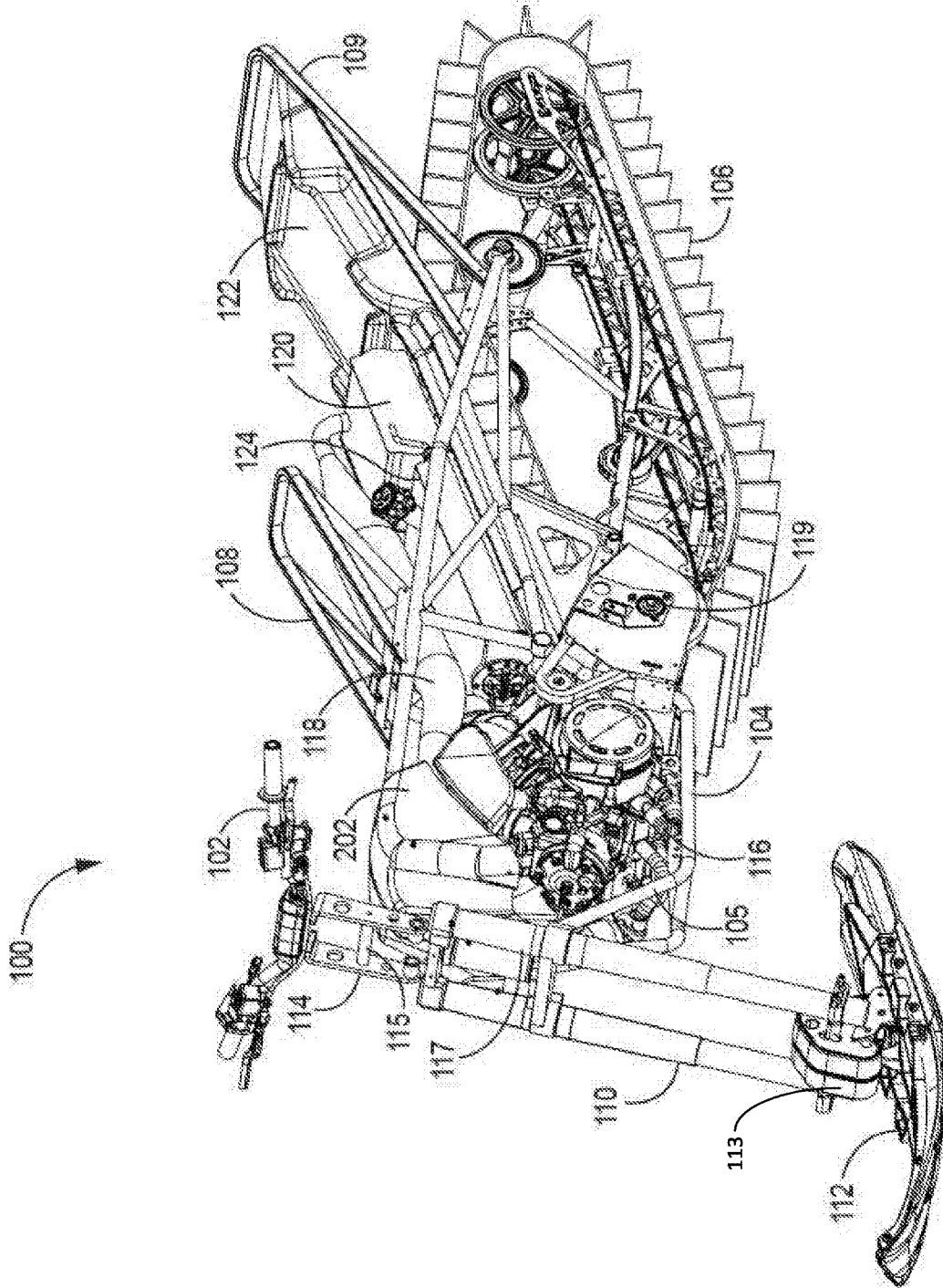

FIG. 2

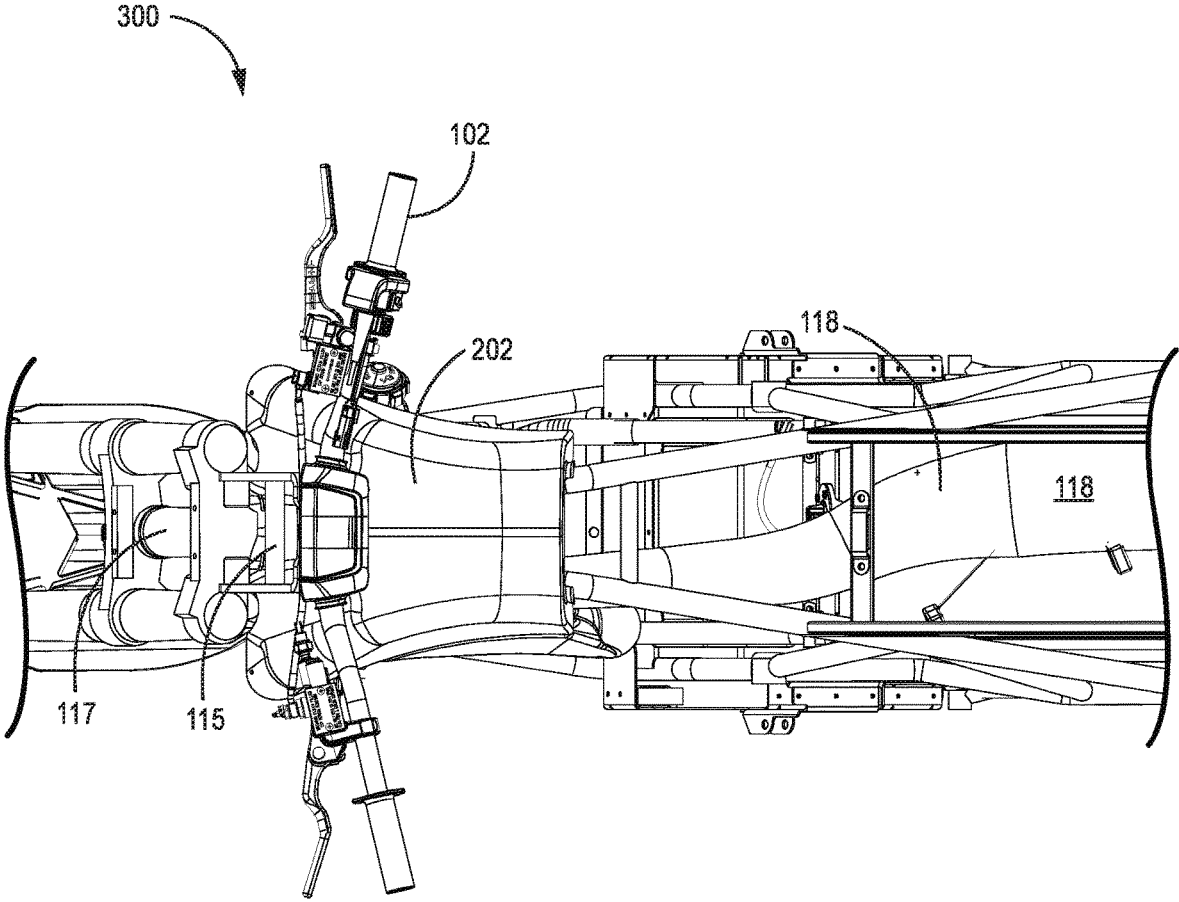

FIG. 3

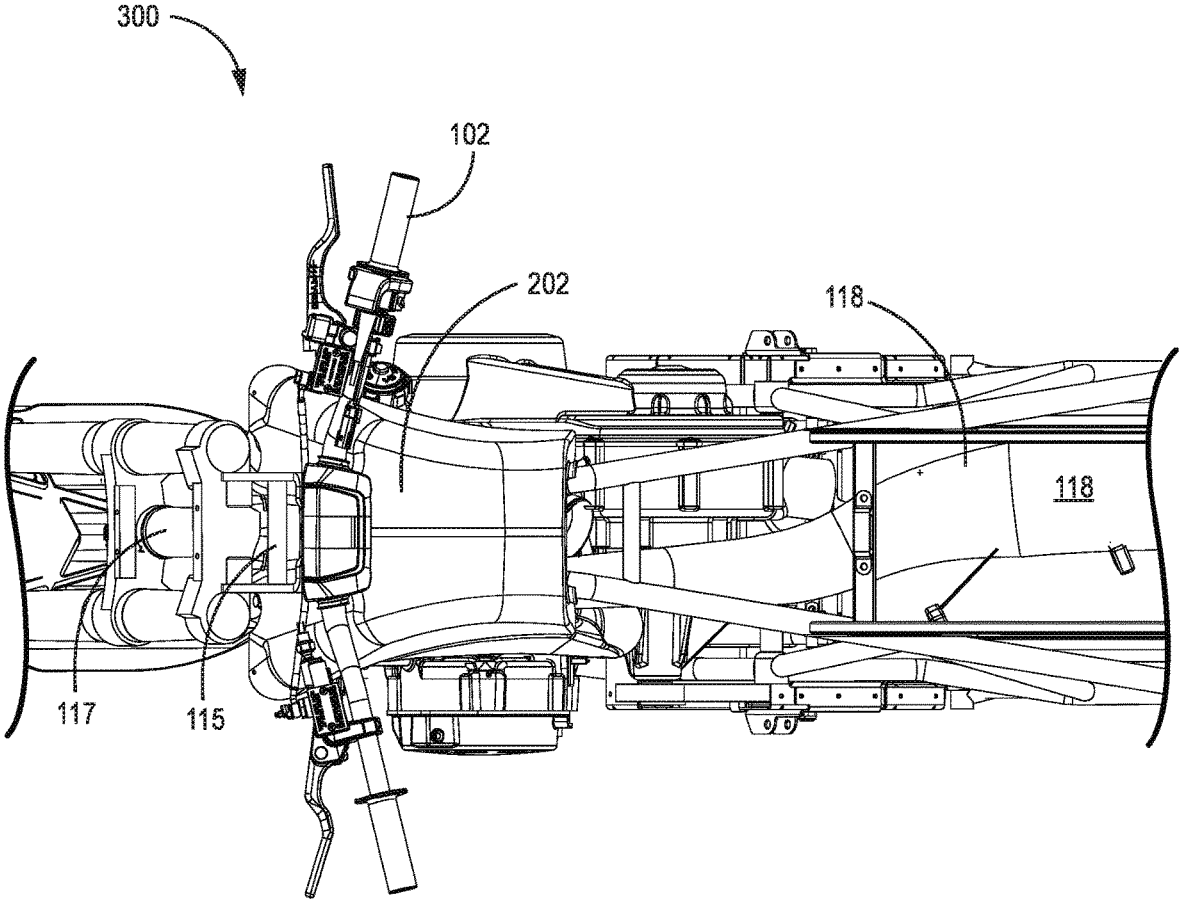

FIG. 4

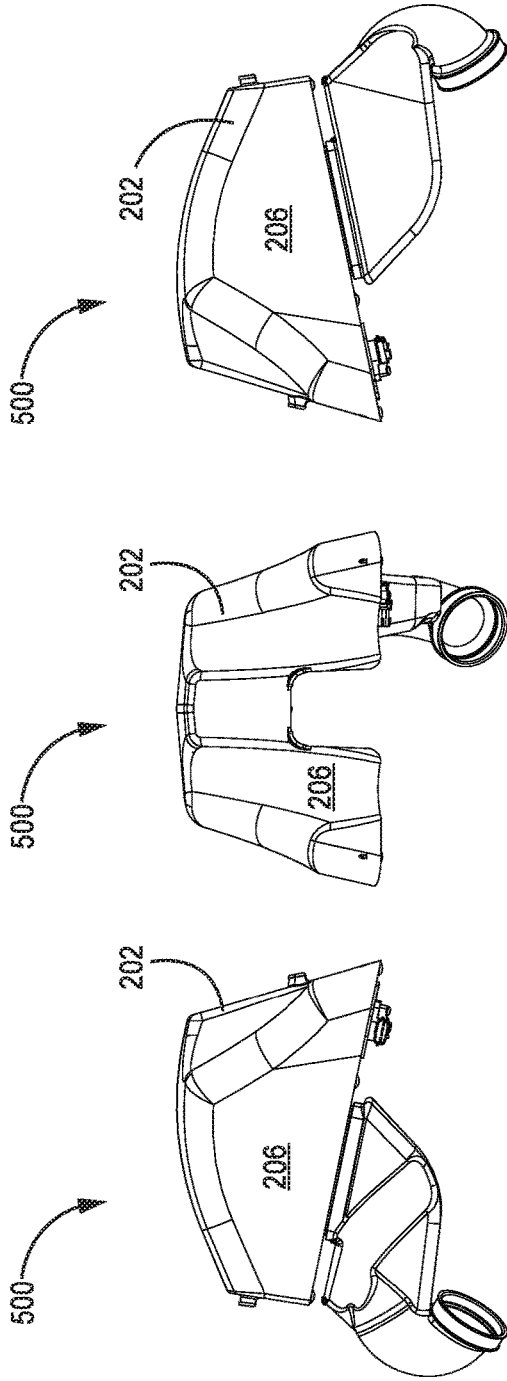

FIG. 5C

FIG. 5B

FIG. 5A

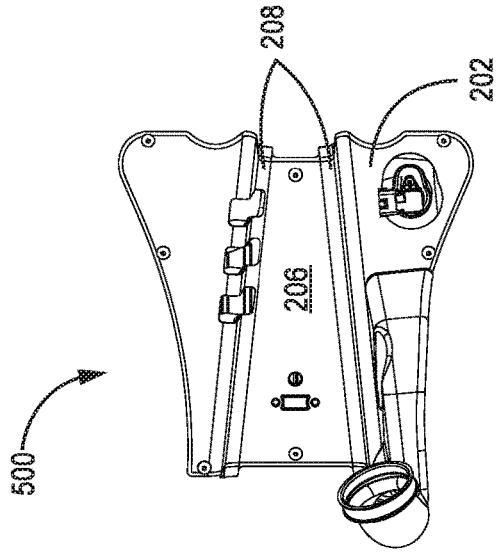

FIG. 5D

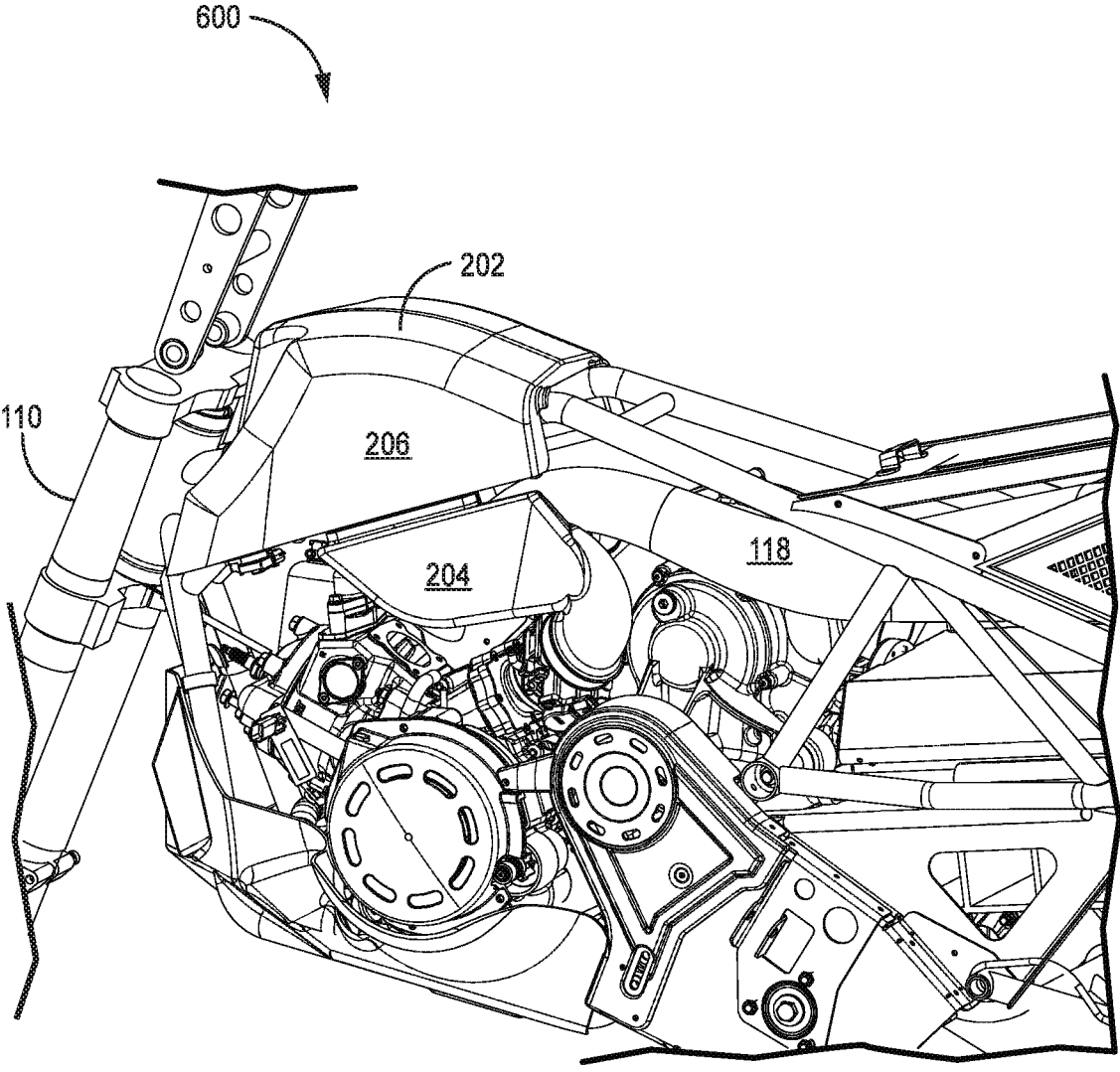

FIG. 6

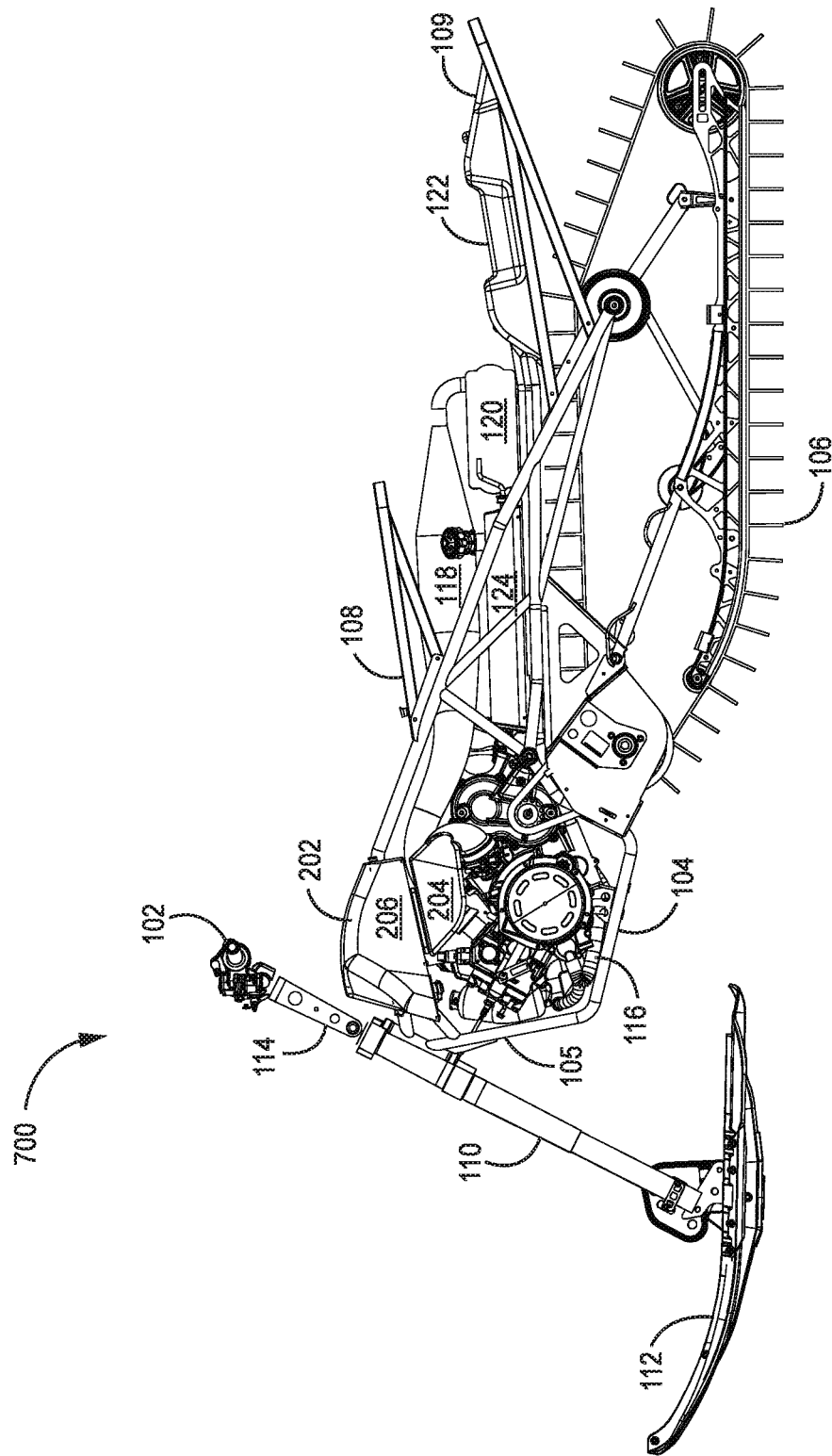

FIG. 7

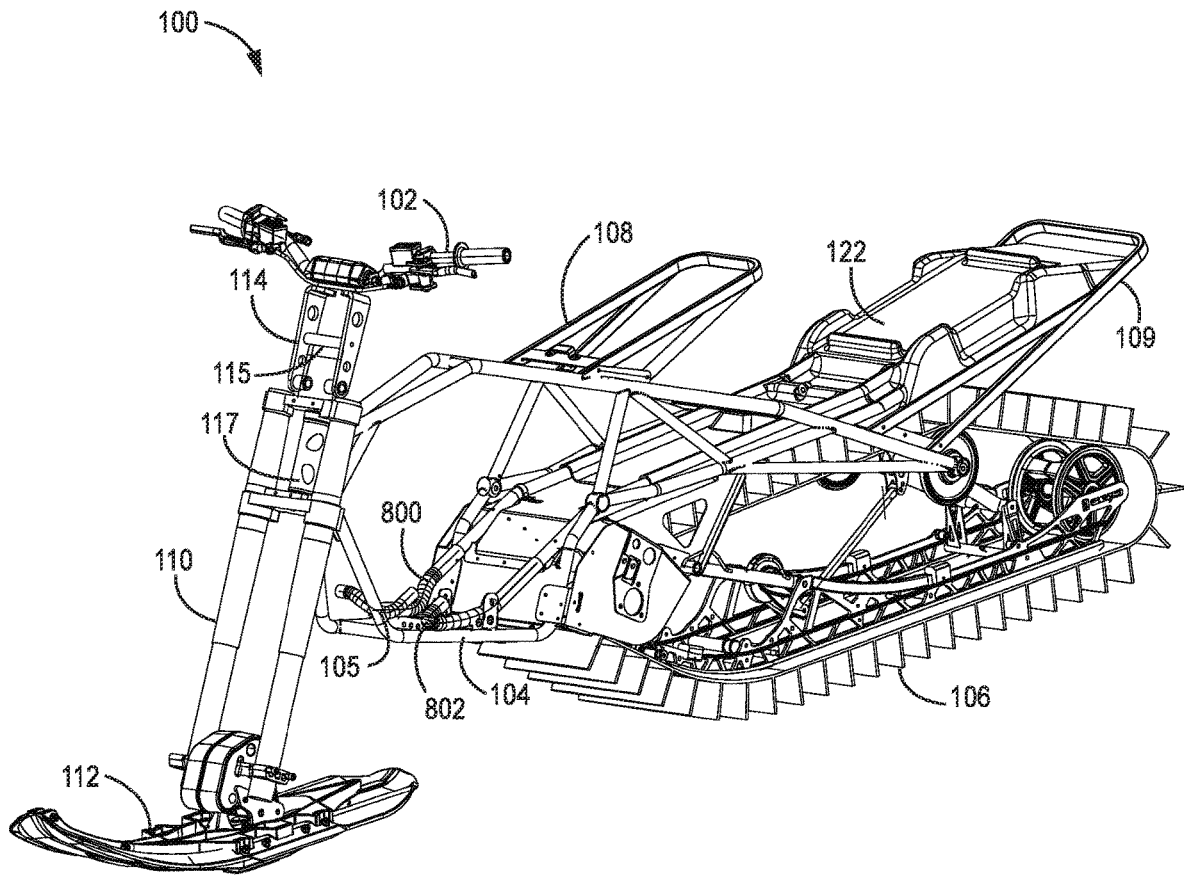

FIG. 8

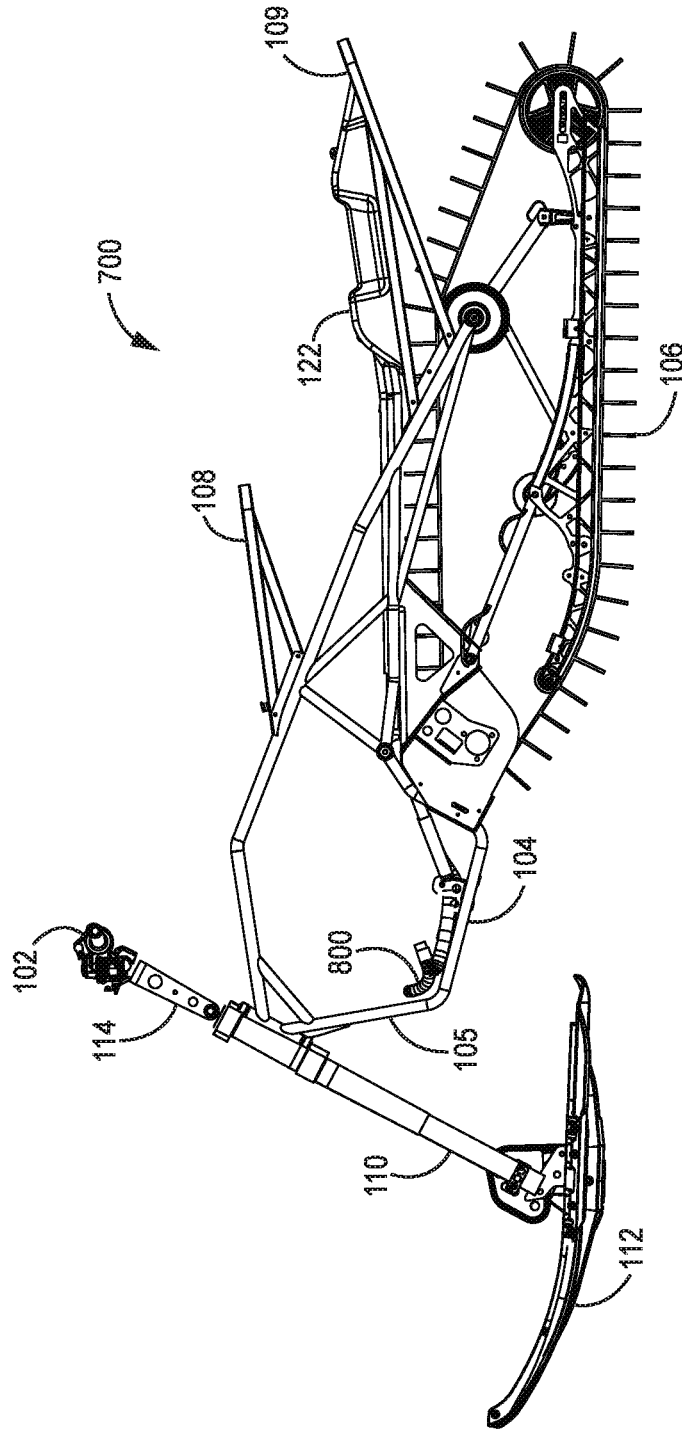

FIG. 9

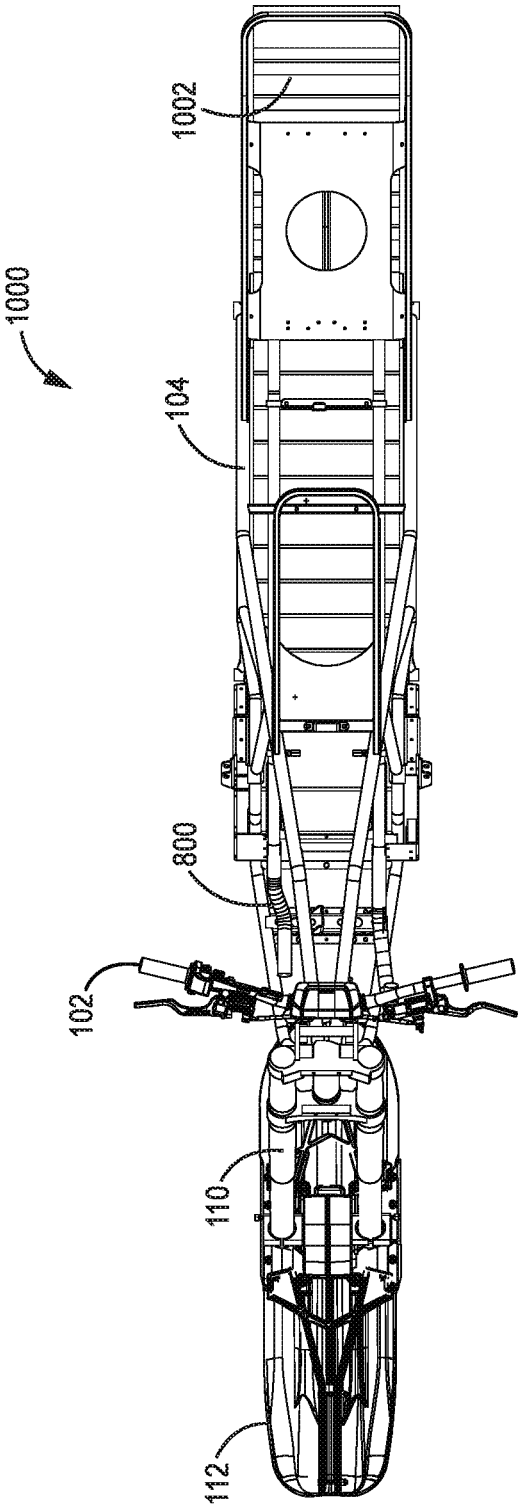

FIG. 10

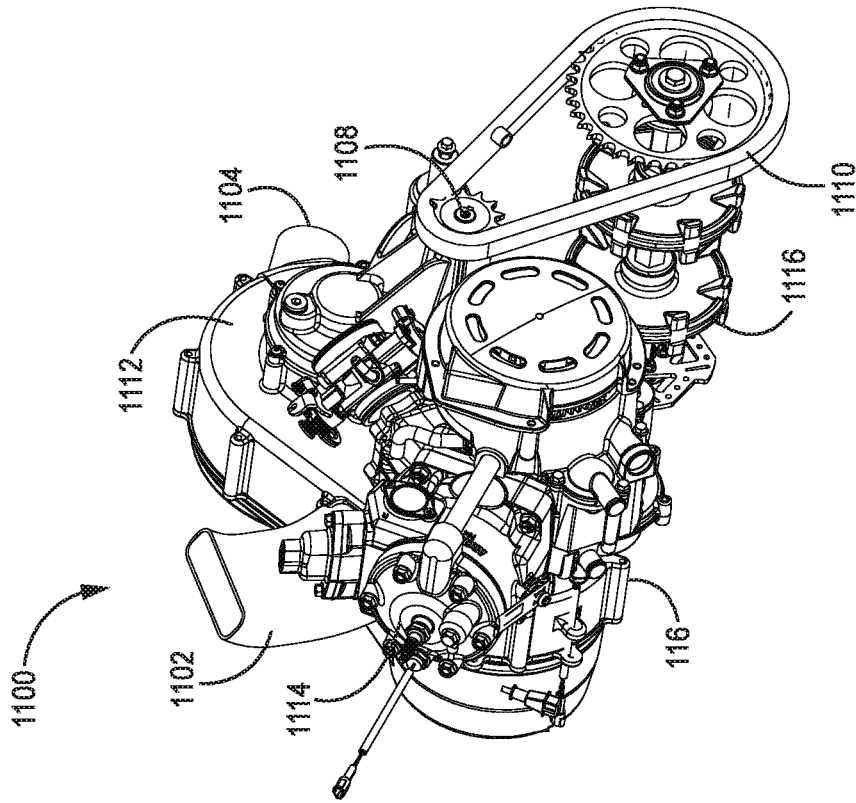

FIG. 11B

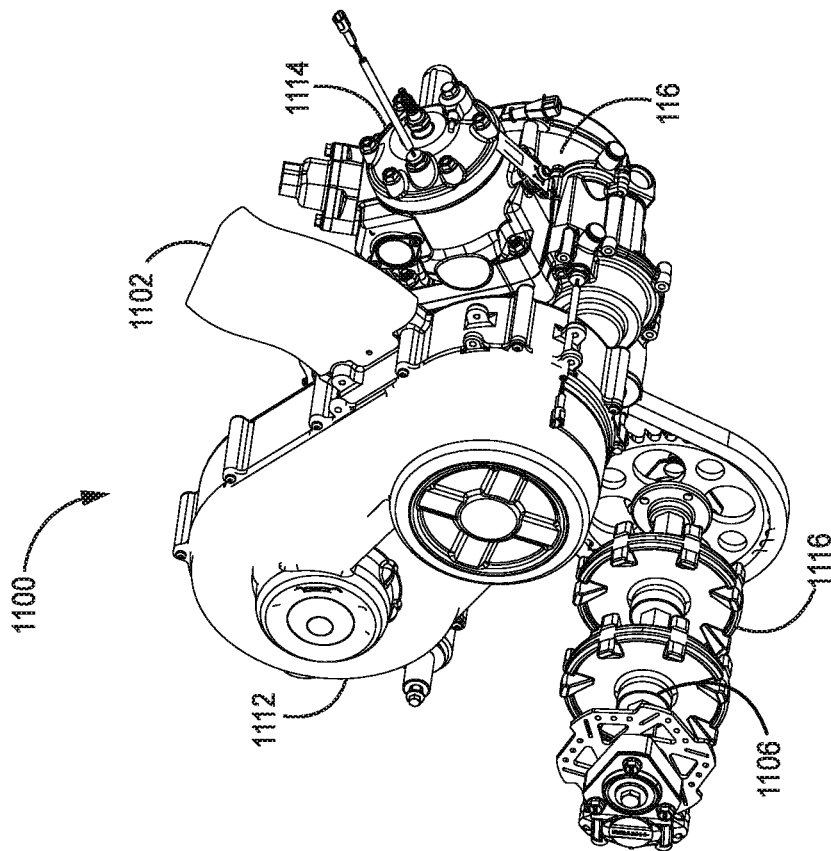

FIG. 11A

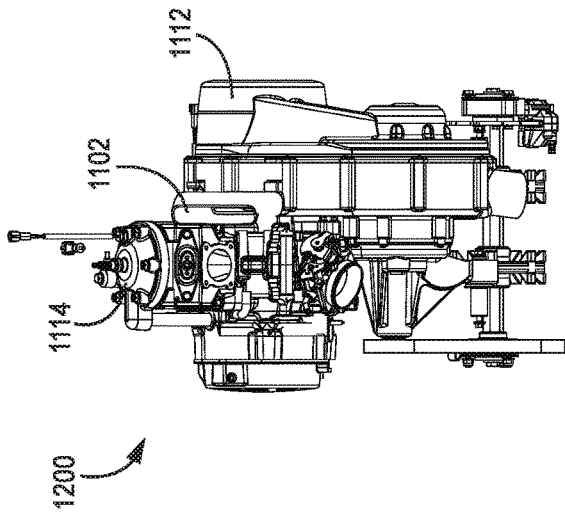

FIG. 12A

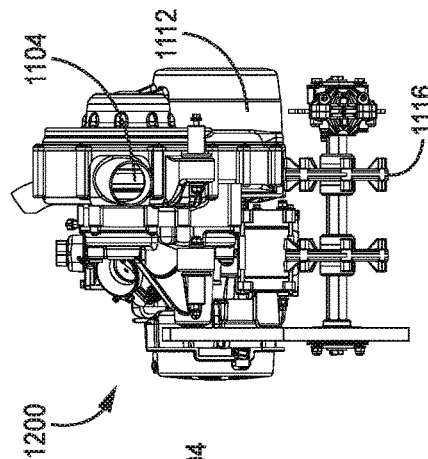

FIG. 12C

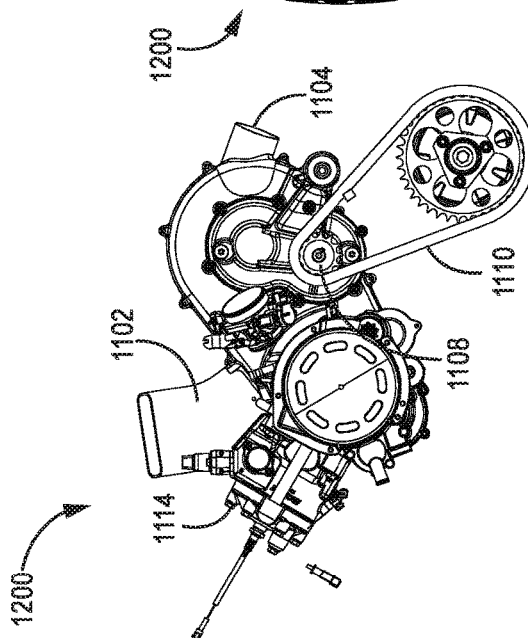

FIG. 12B

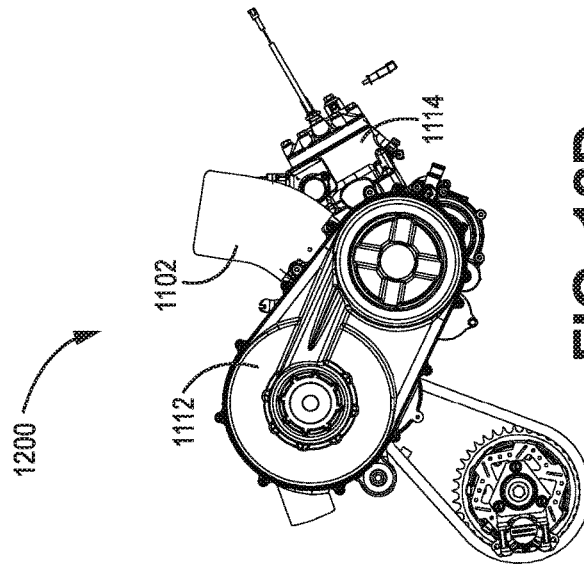

FIG. 12D

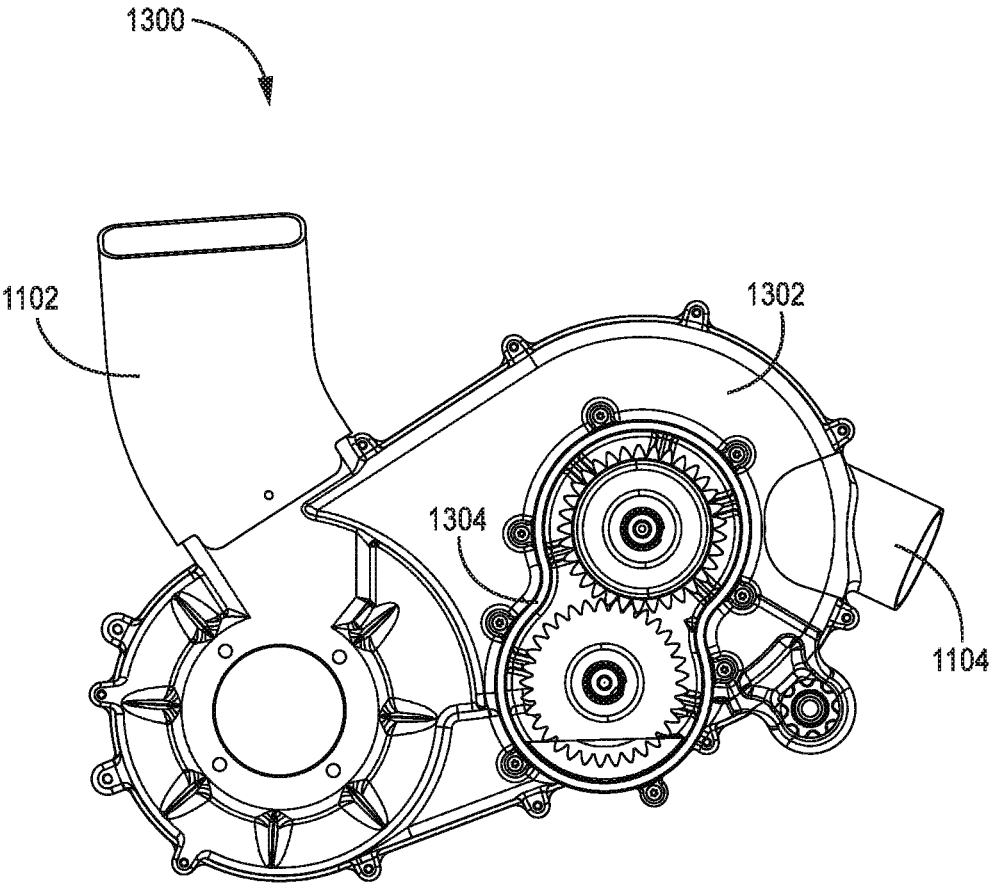

FIG. 13

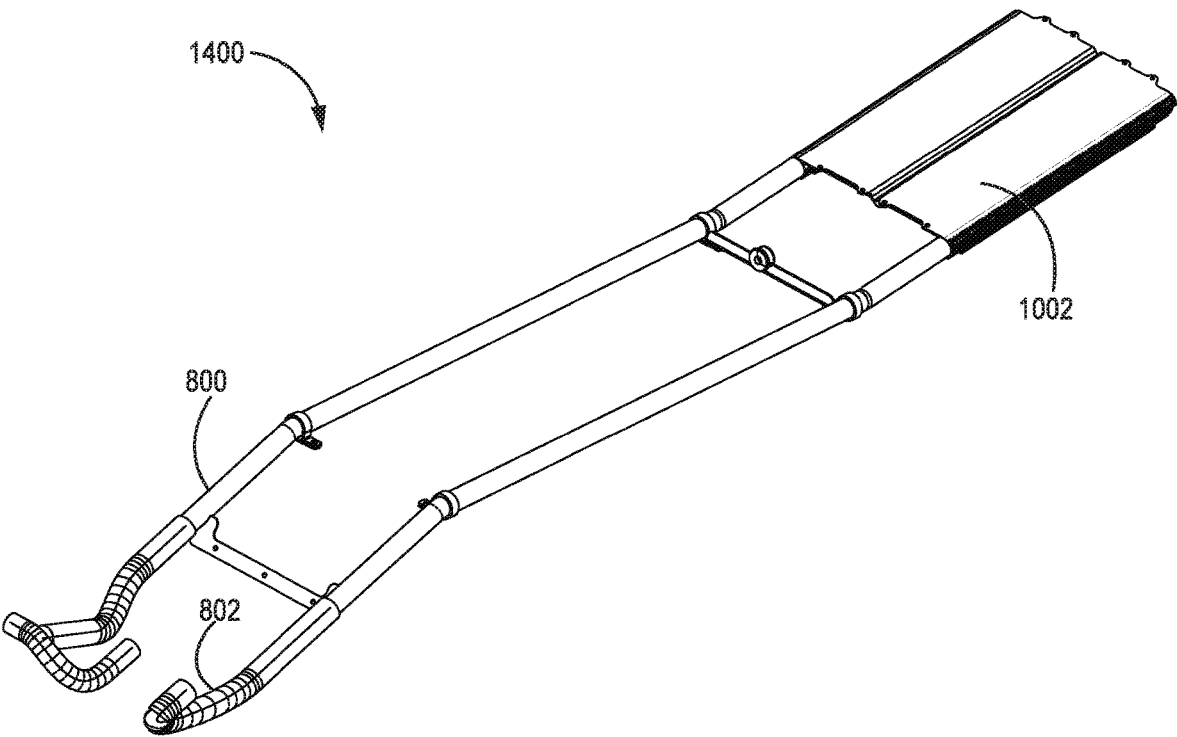

FIG. 14

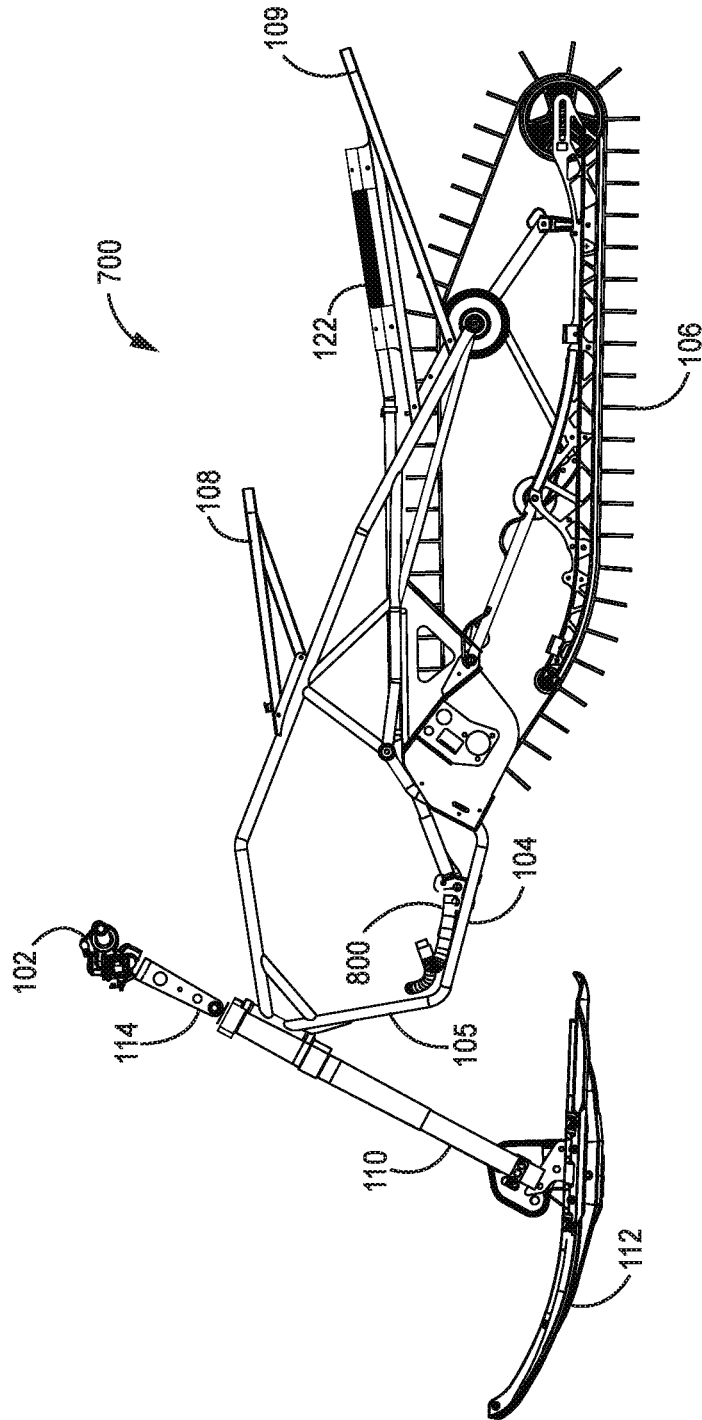

FIG. 15

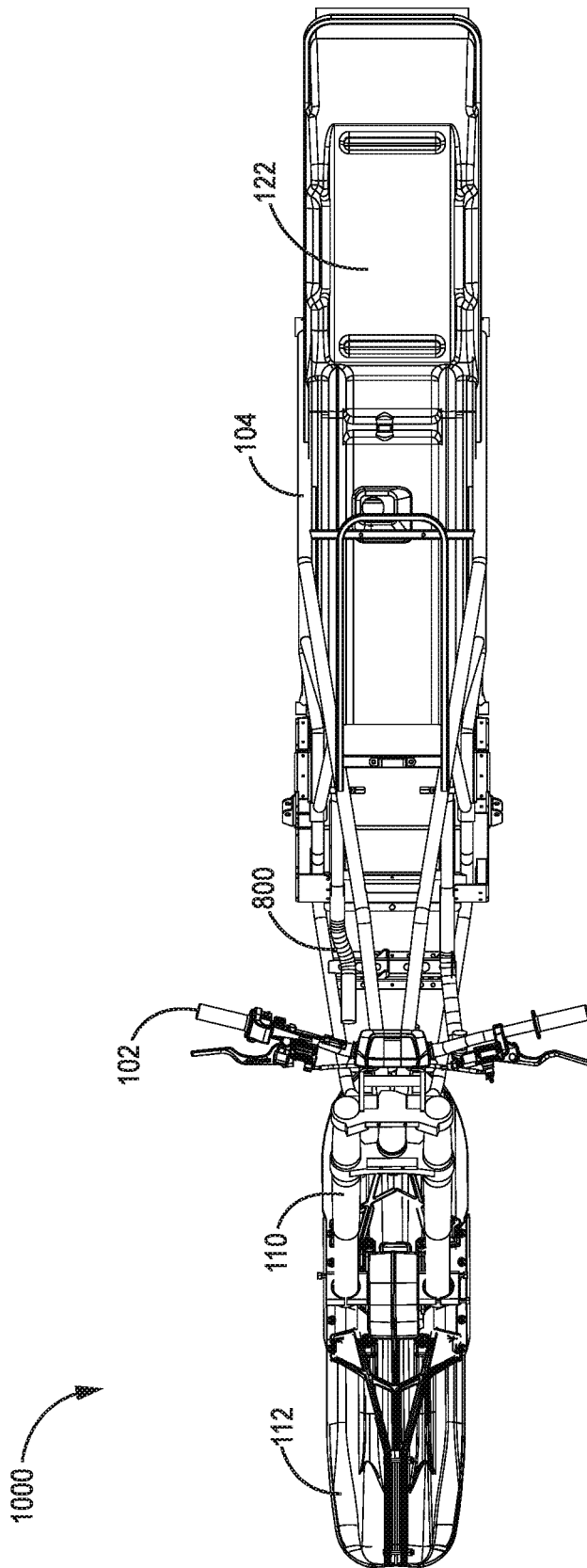

FIG. 16

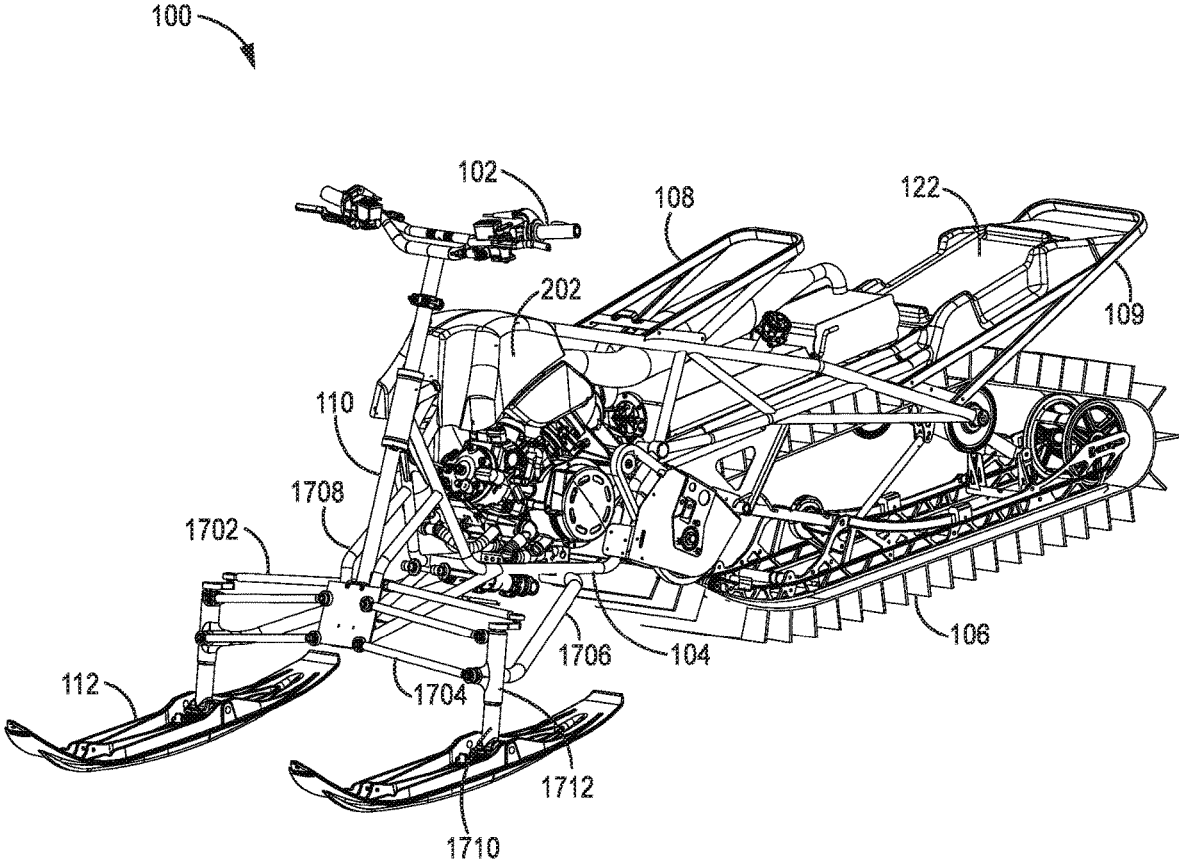

FIG. 17

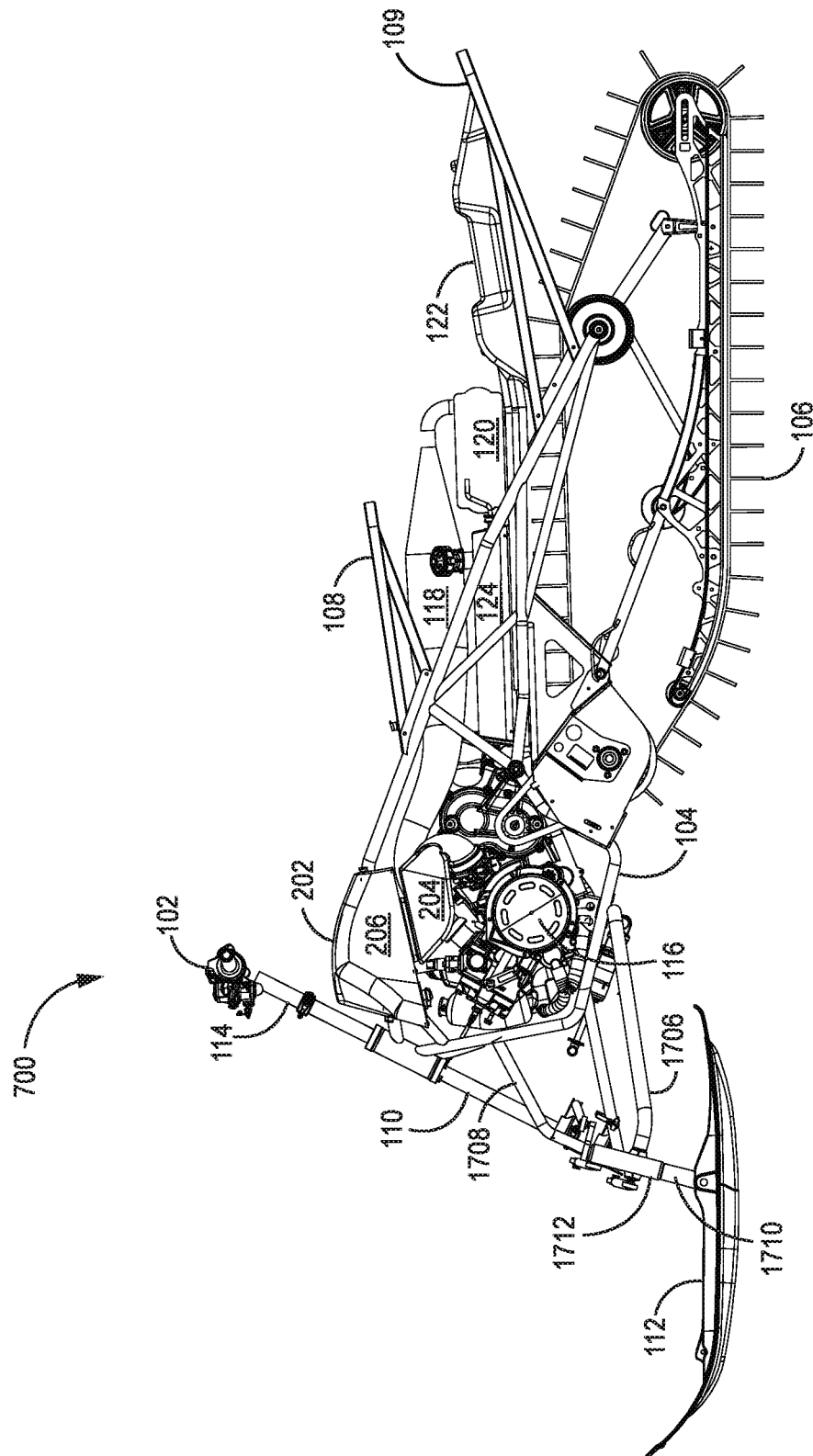

FIG. 18

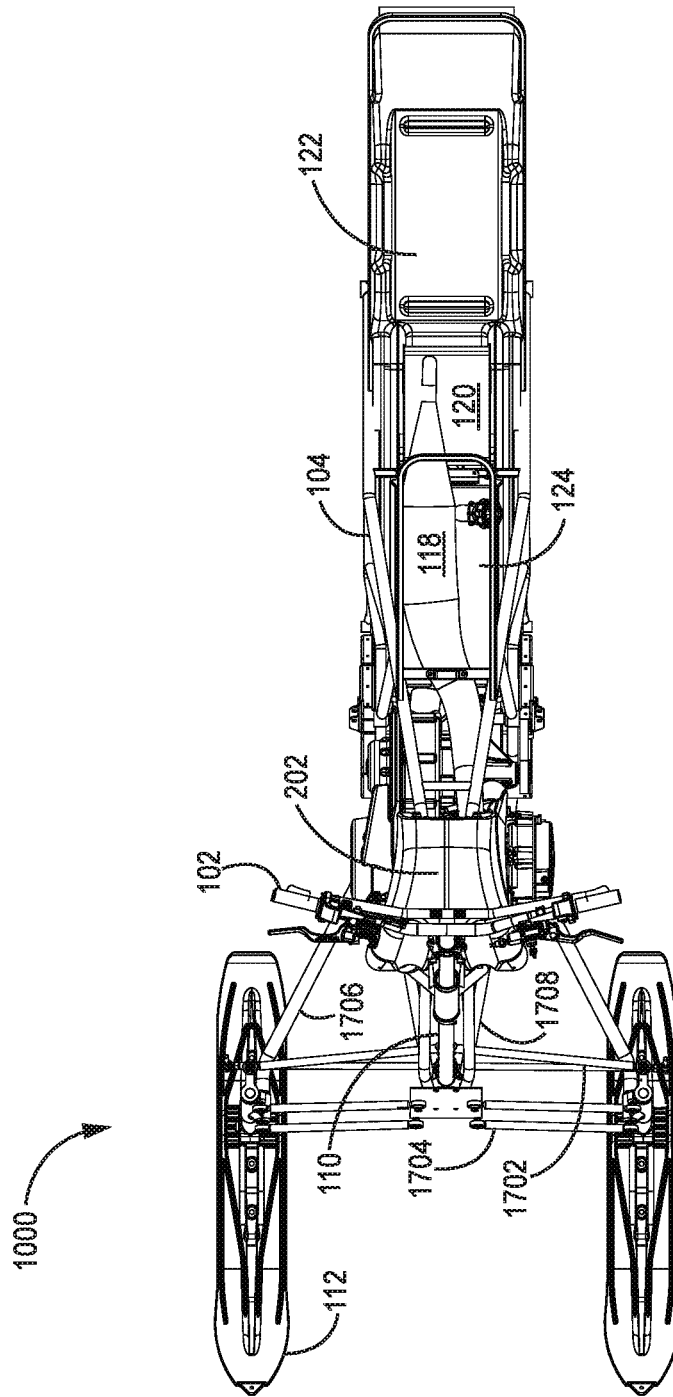

FIG. 19

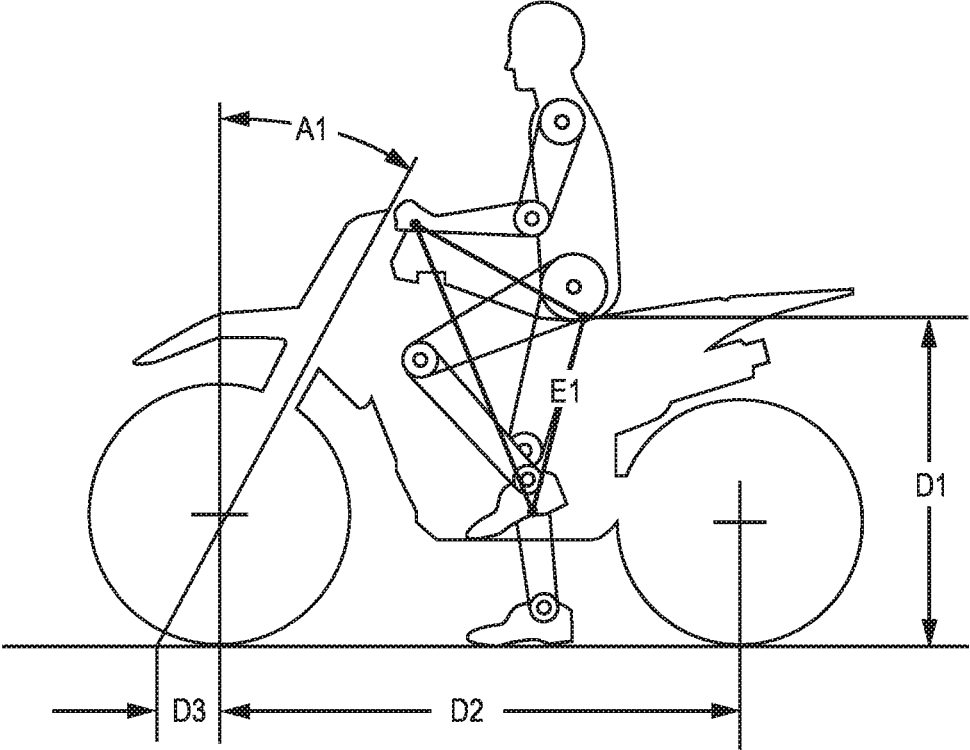

FIG. 20A

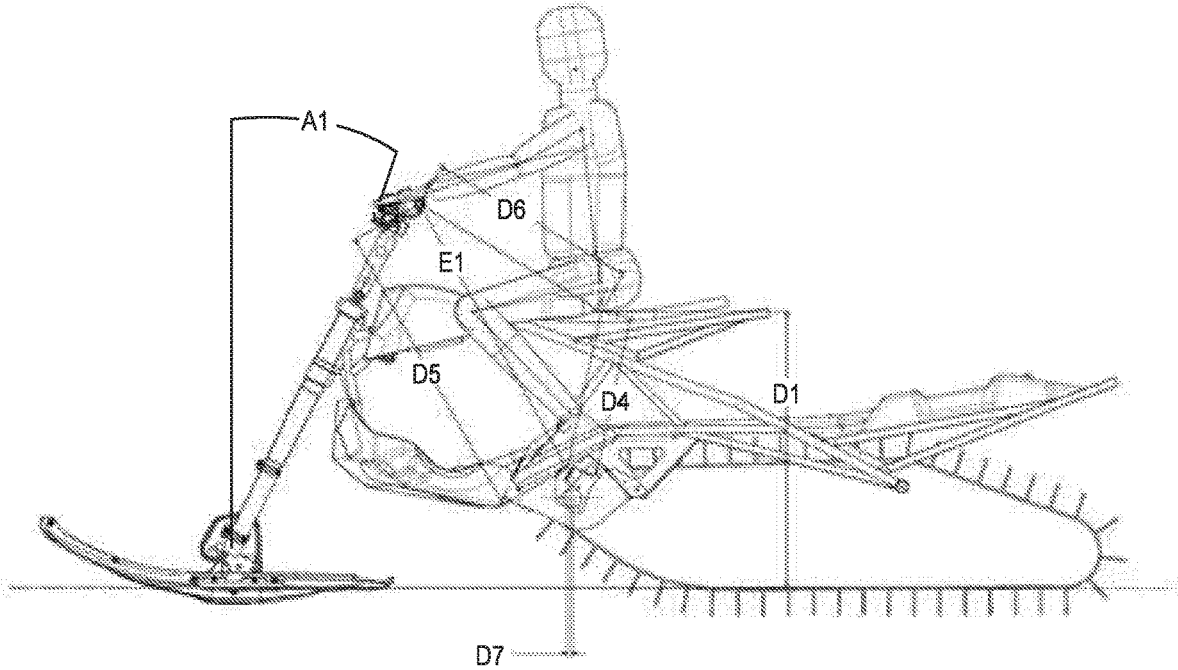

FIG. 20B

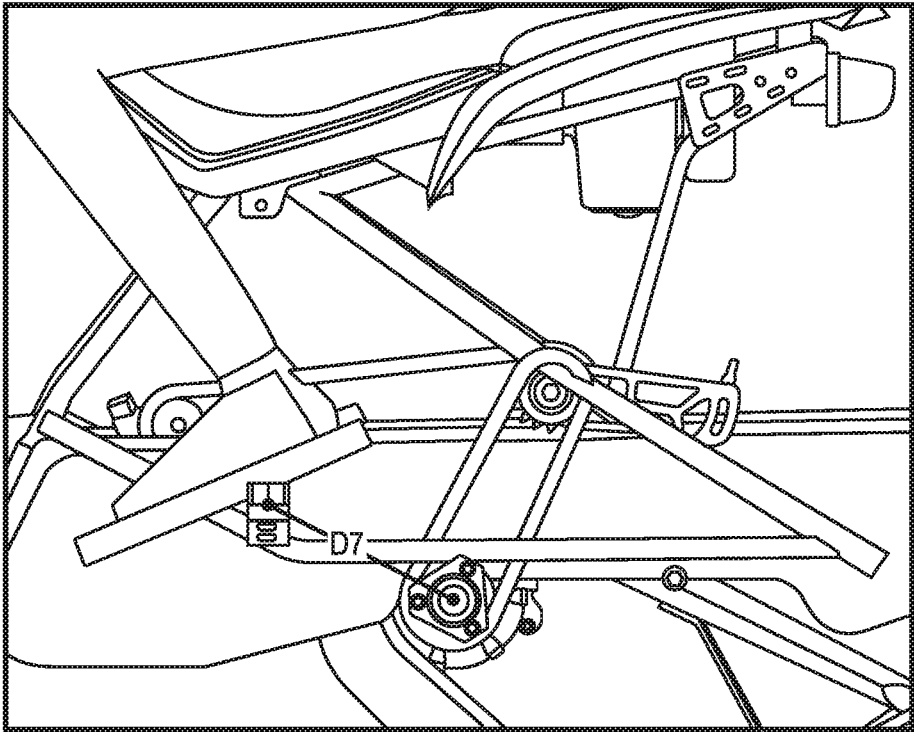

FIG. 20C

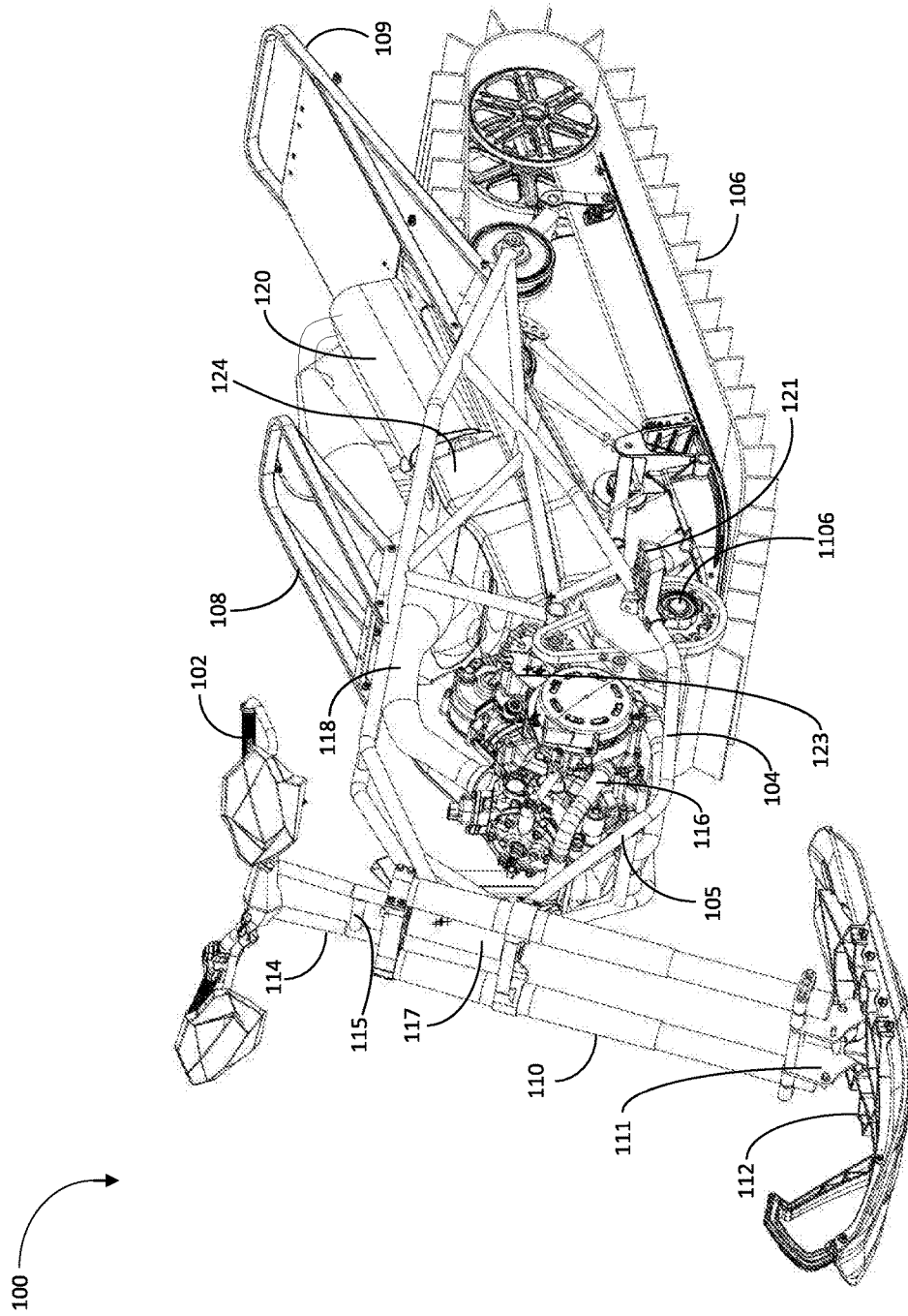

FIG. 21

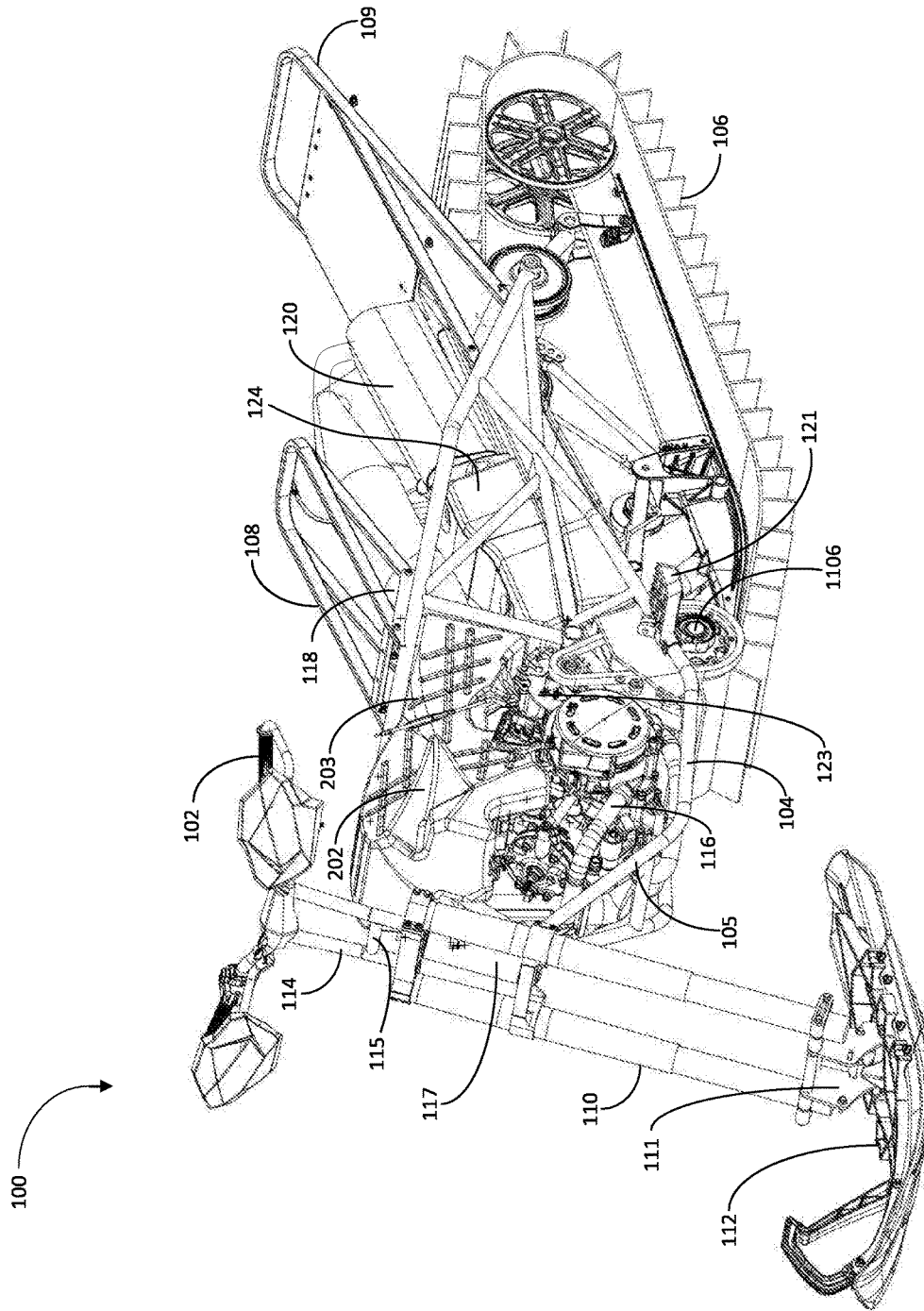

FIG. 22

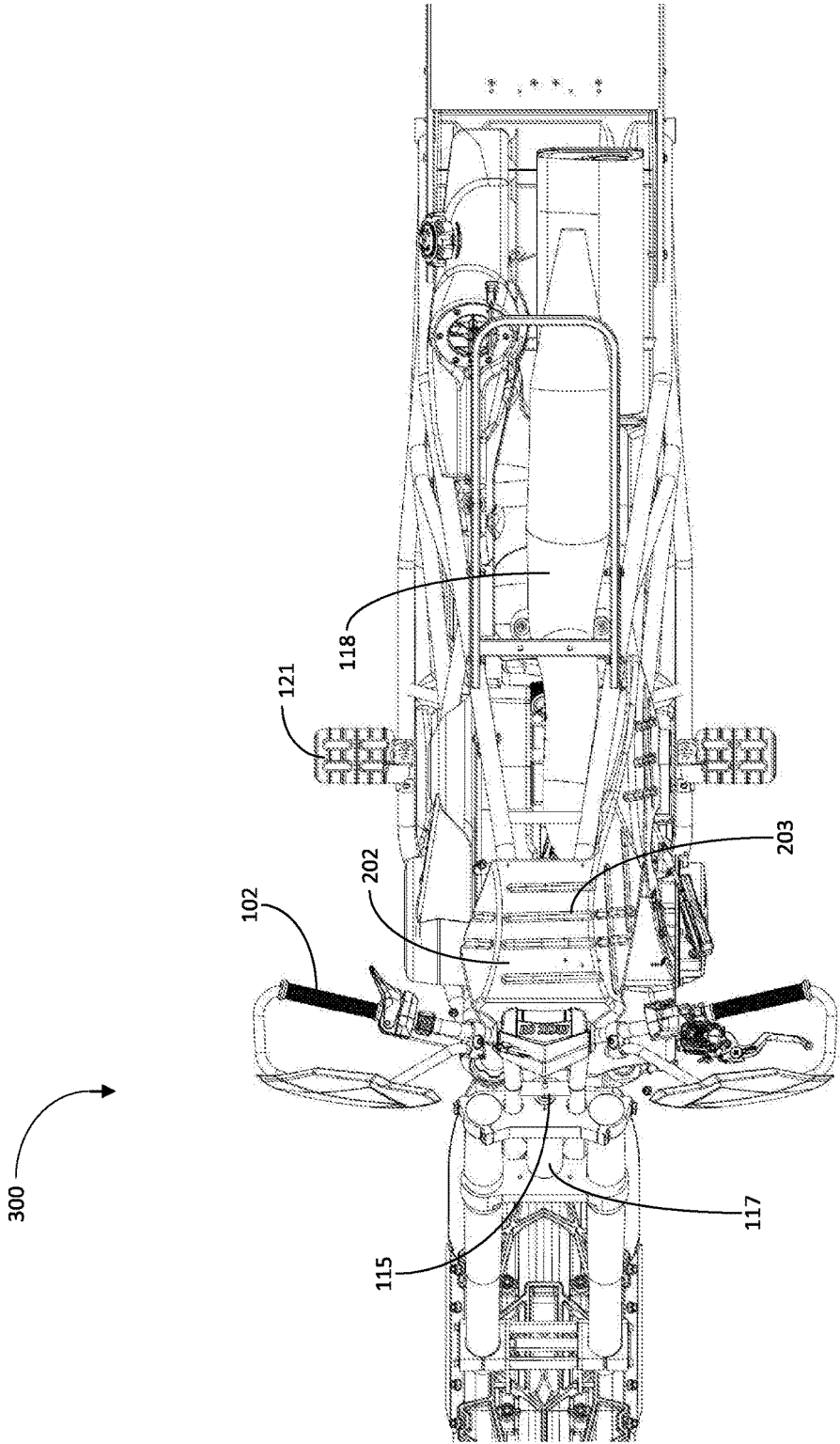

FIG. 23

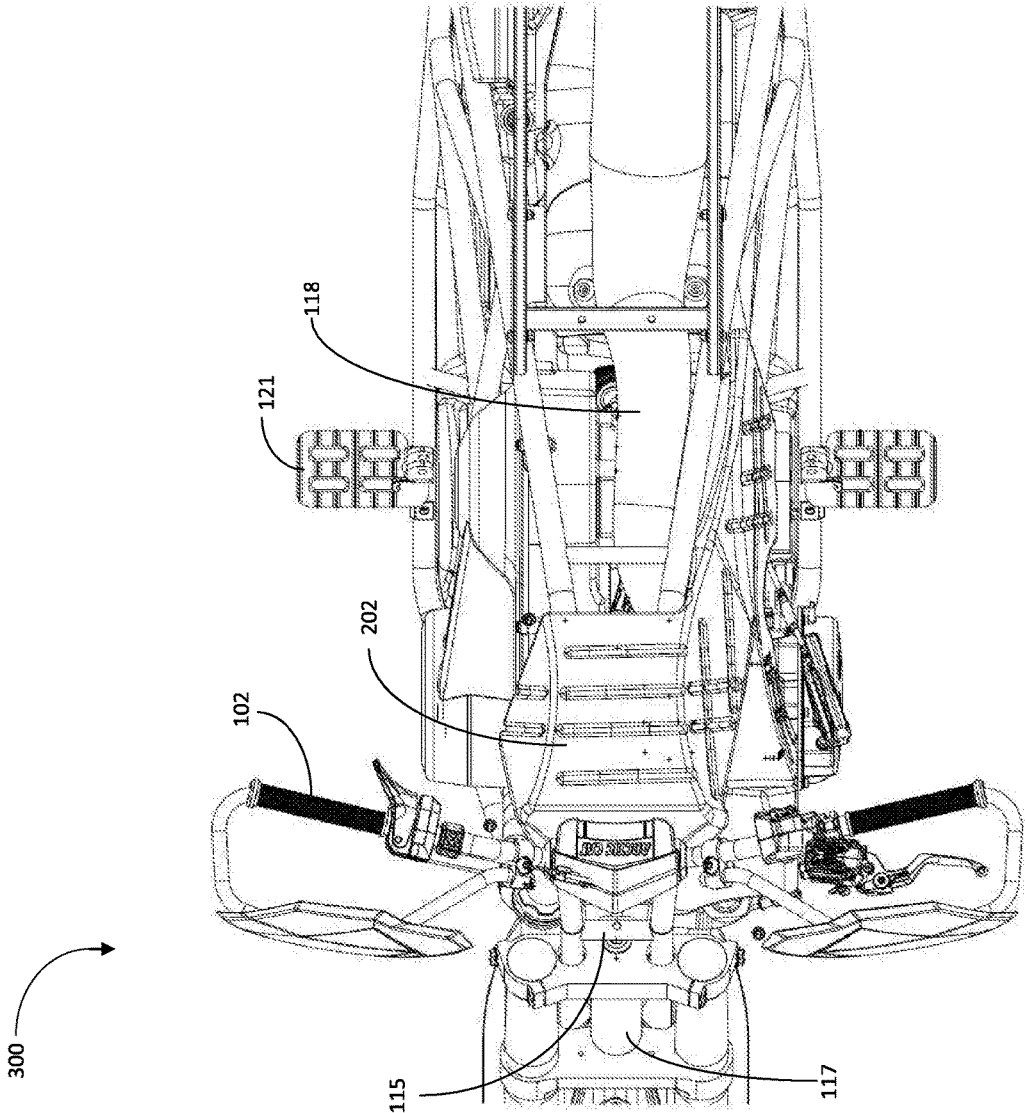

FIG. 24

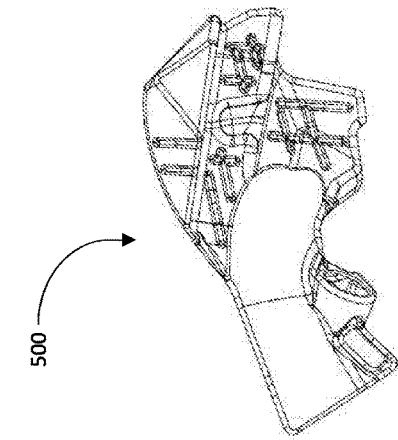

FIG. 25A

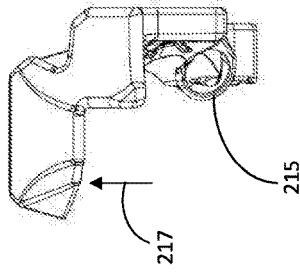

FIG. 25B

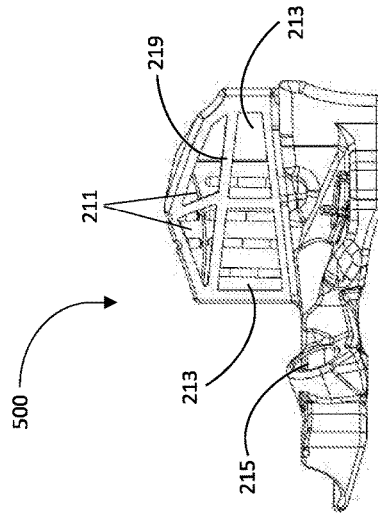

FIG. 25C

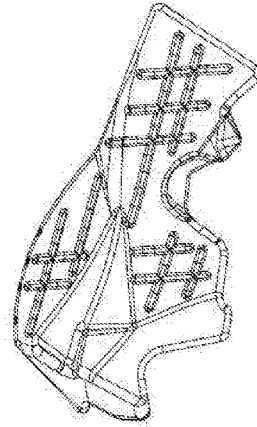

FIG. 25D

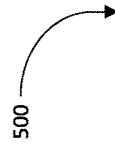

FIG. 25E

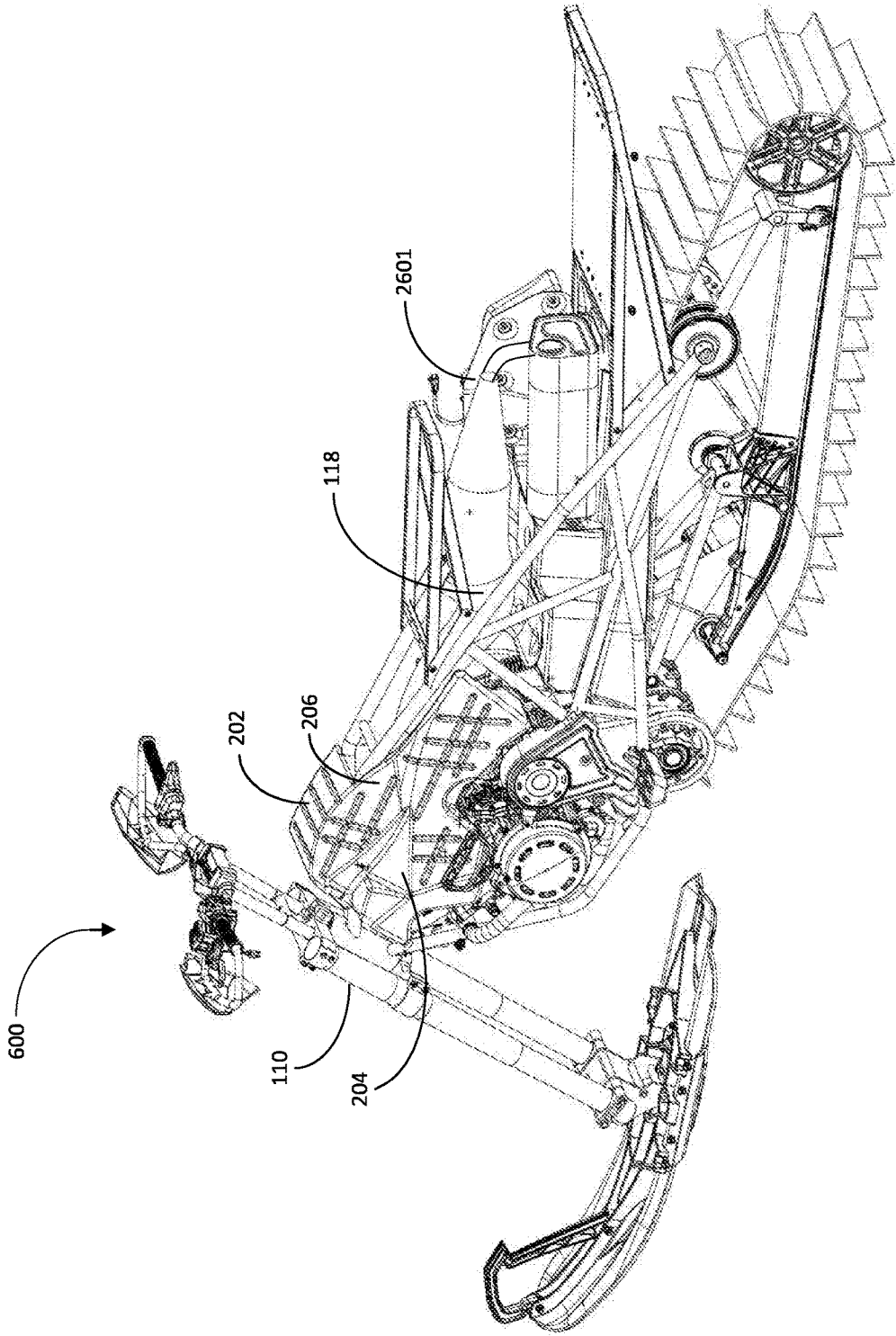

FIG. 26

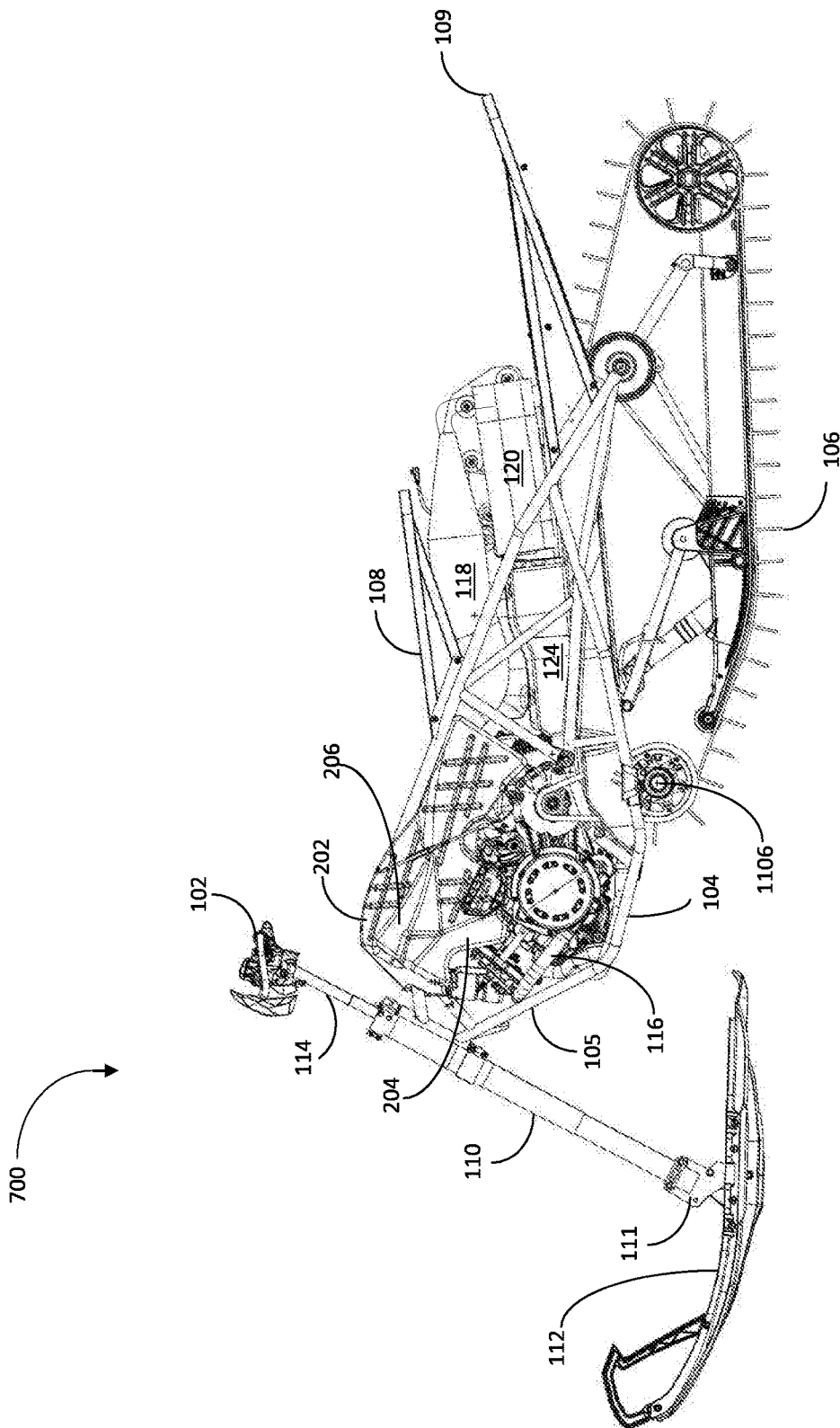

FIG. 27

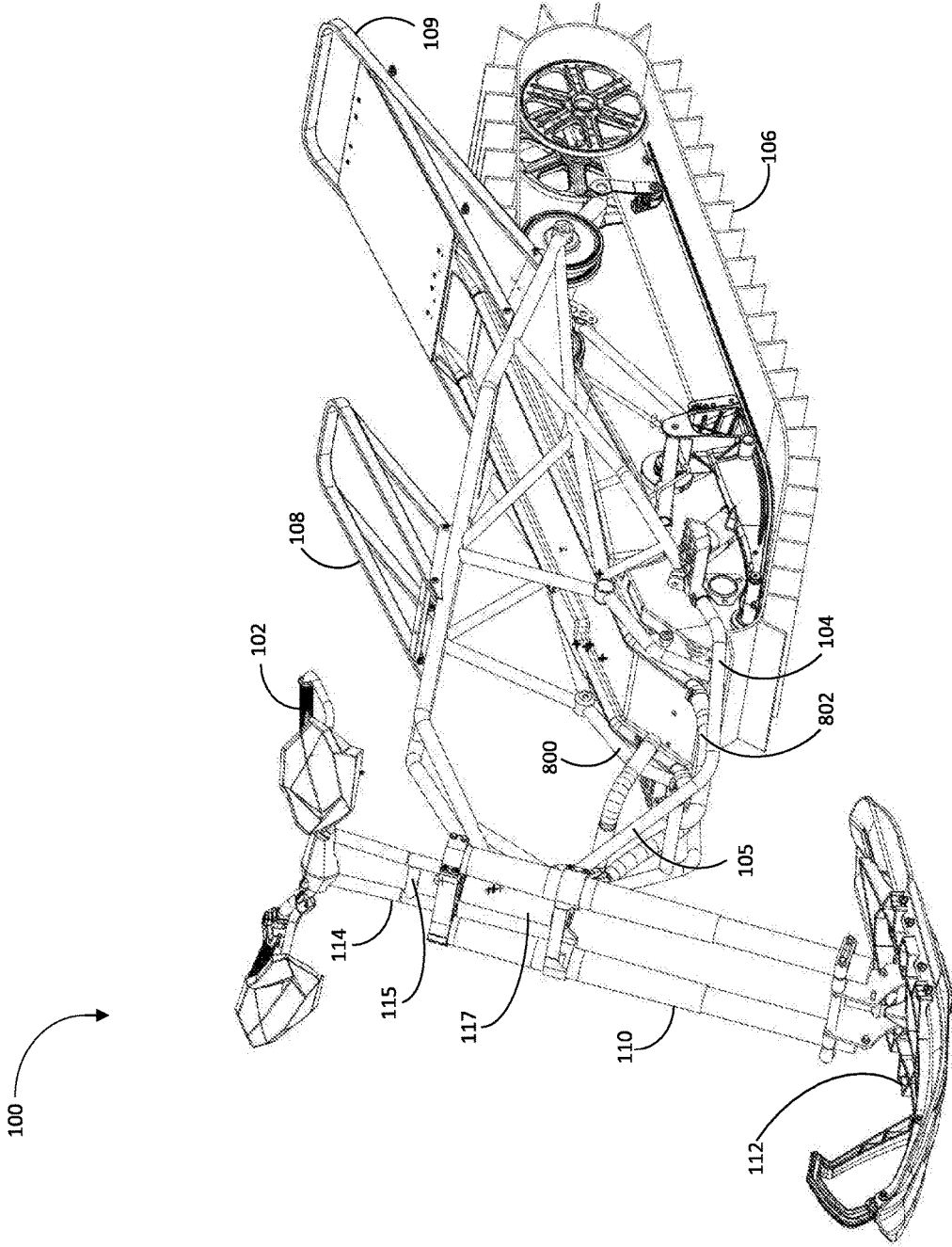

FIG. 28

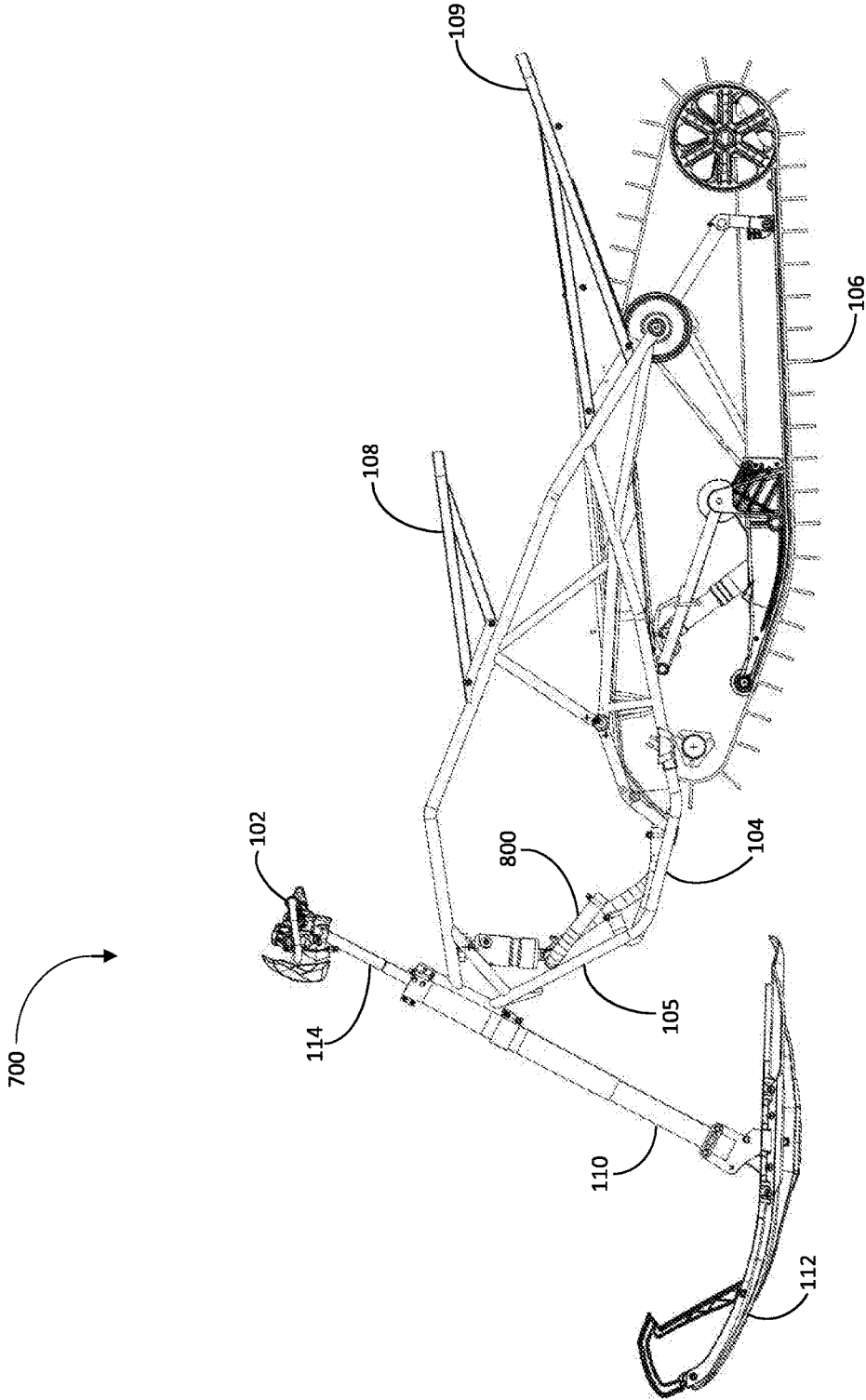

FIG. 29

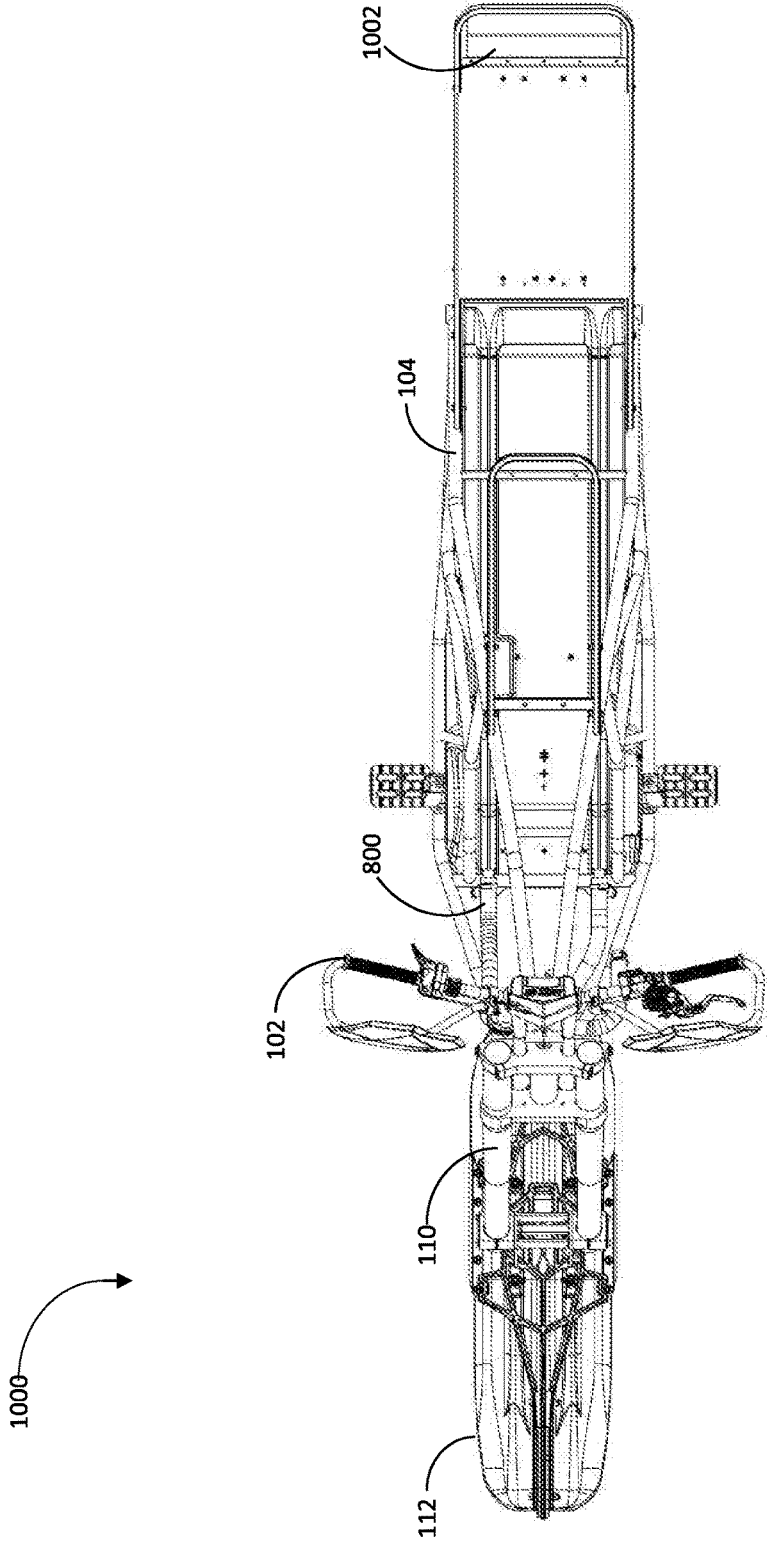

FIG. 30

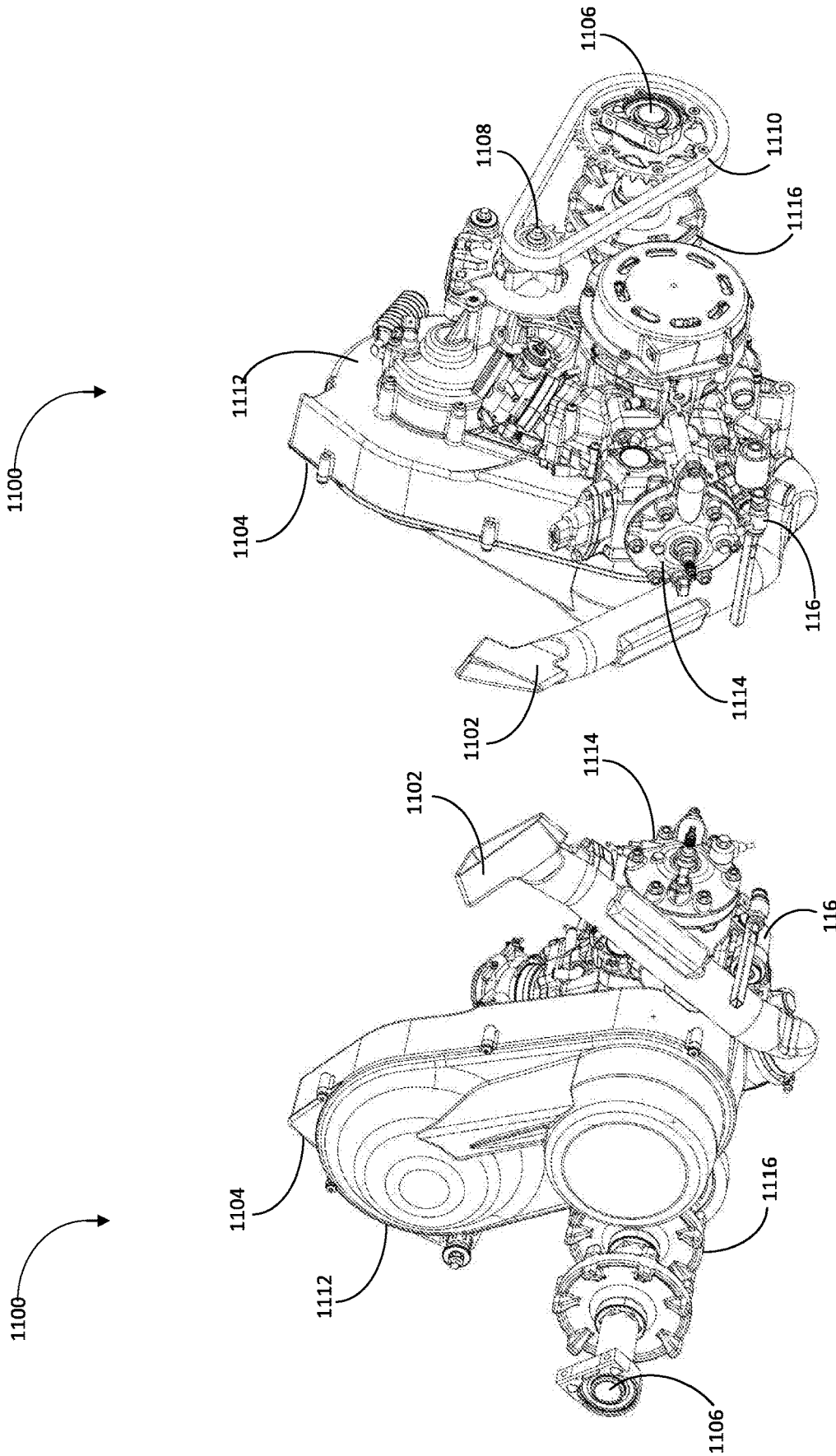

FIG. 31B

FIG. 31A

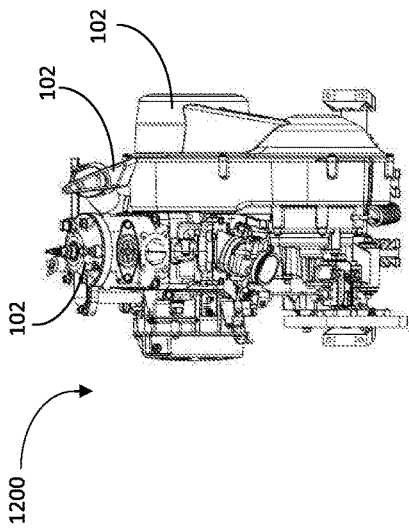

FIG. 32A

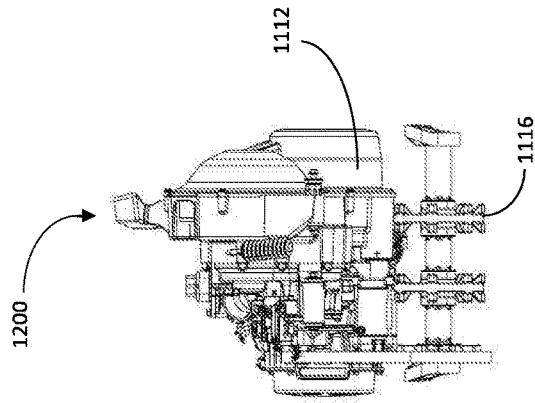

FIG. 32C

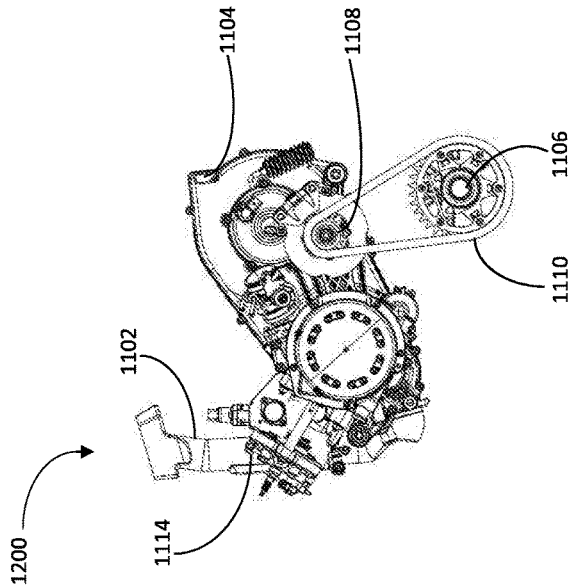

FIG. 32B

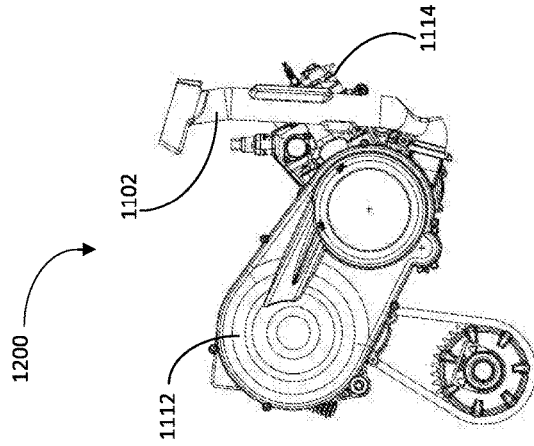

FIG. 32D

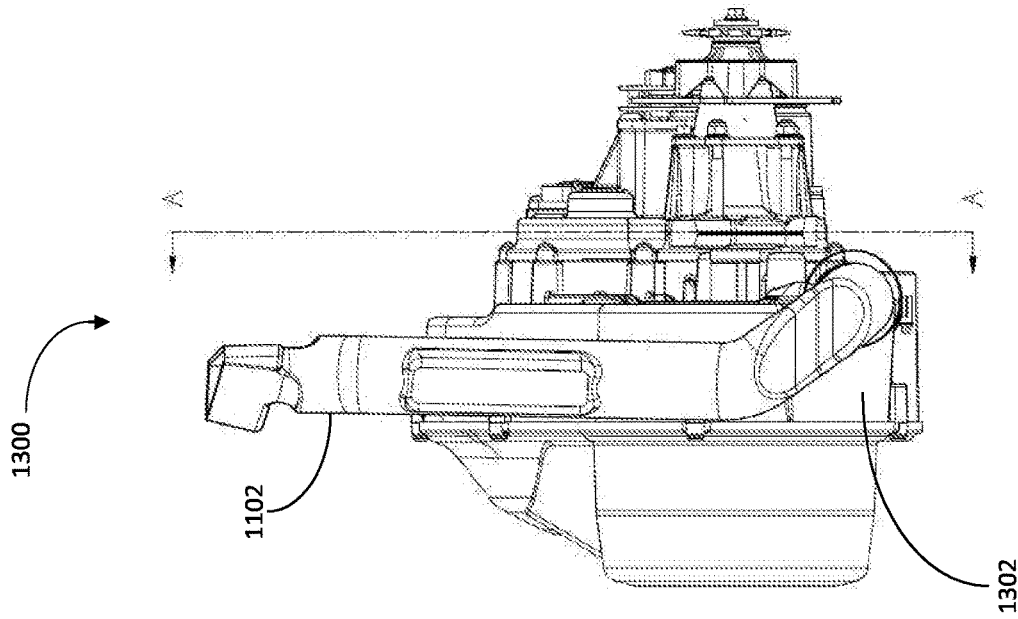

FIG. 33B

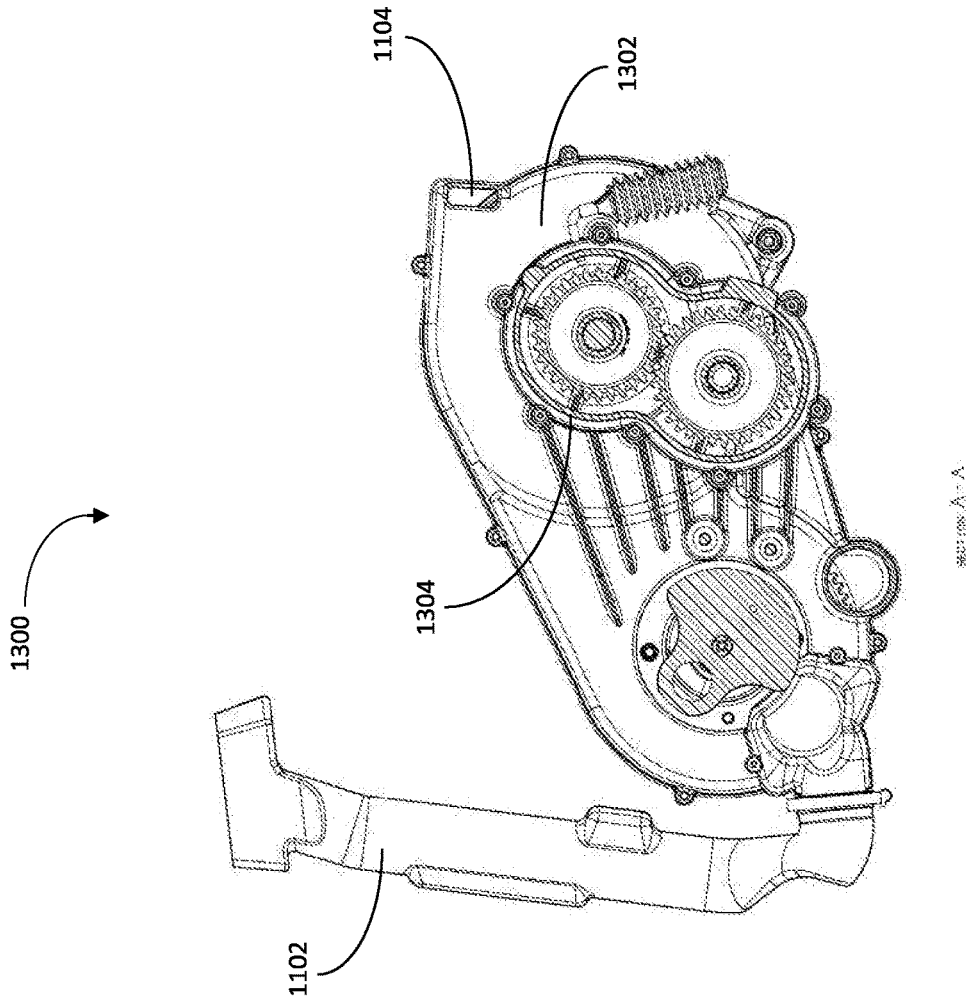

FIG. 33A

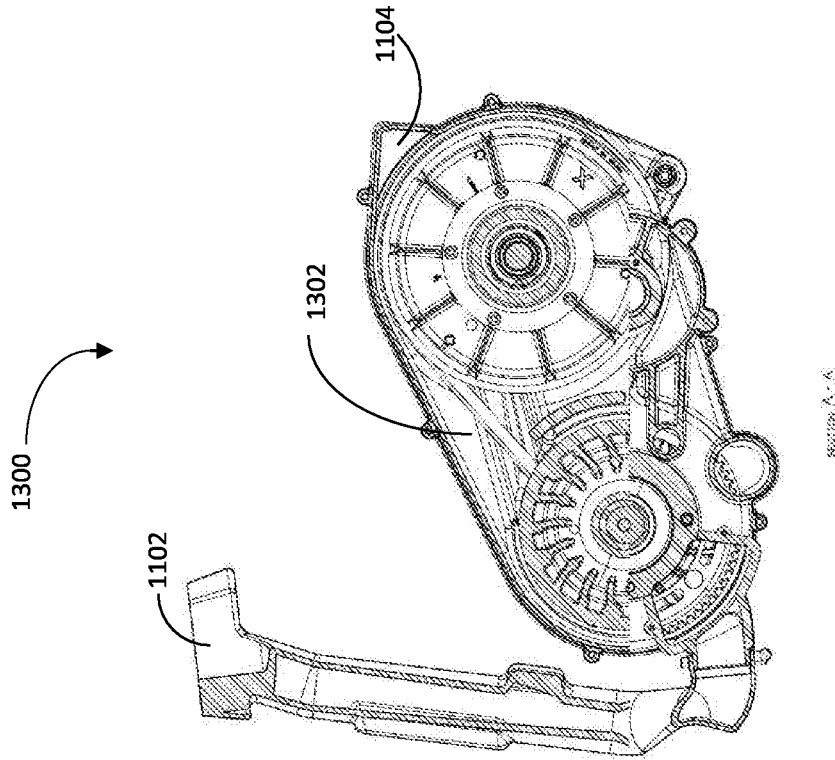

FIG. 33D

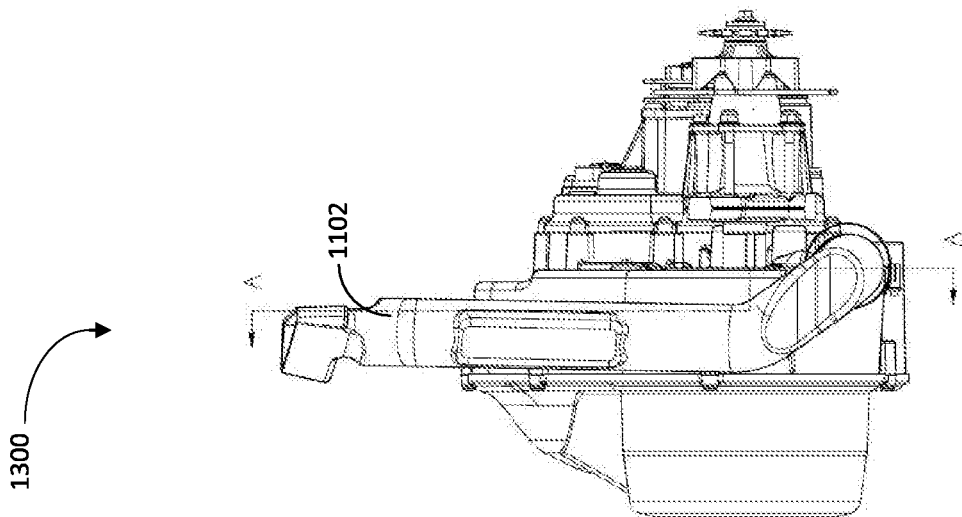

FIG. 33C

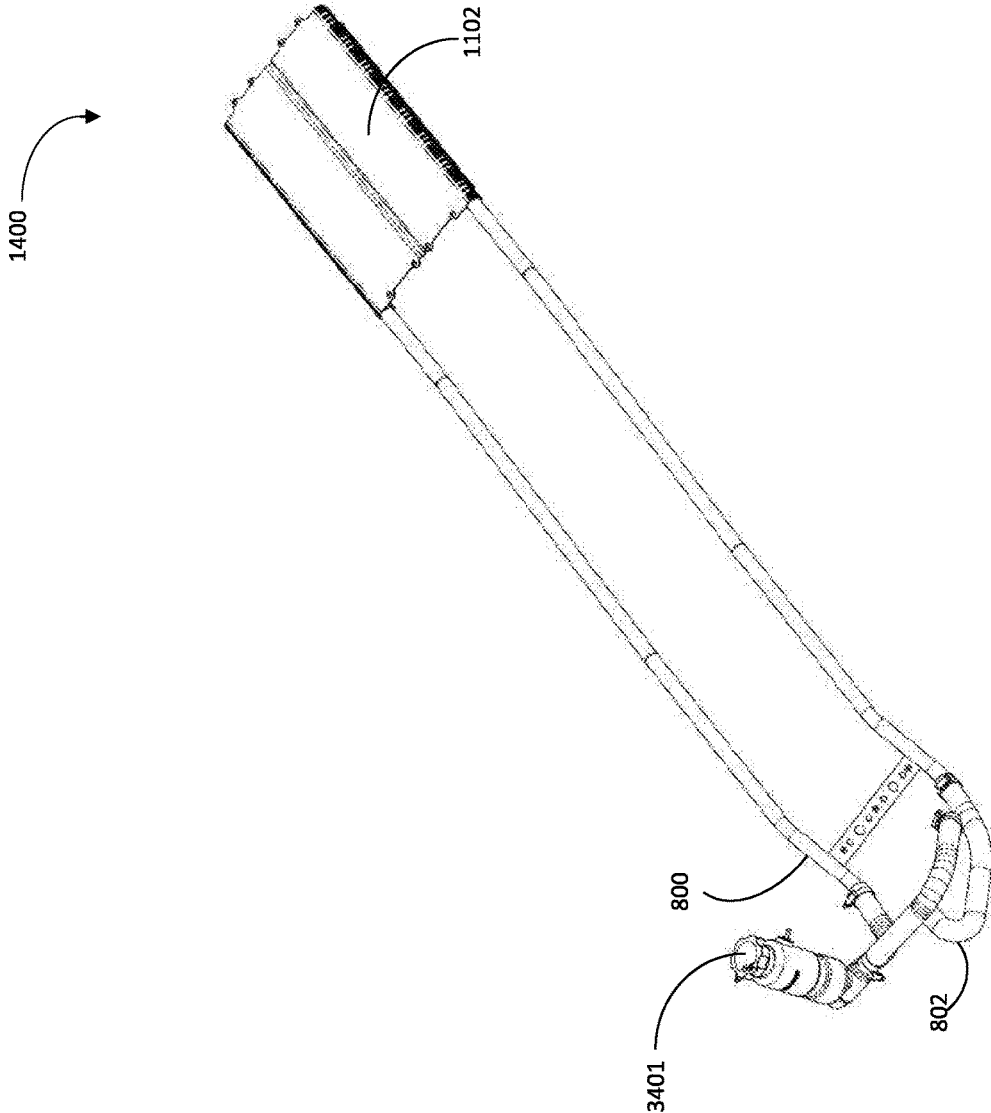

FIG. 34

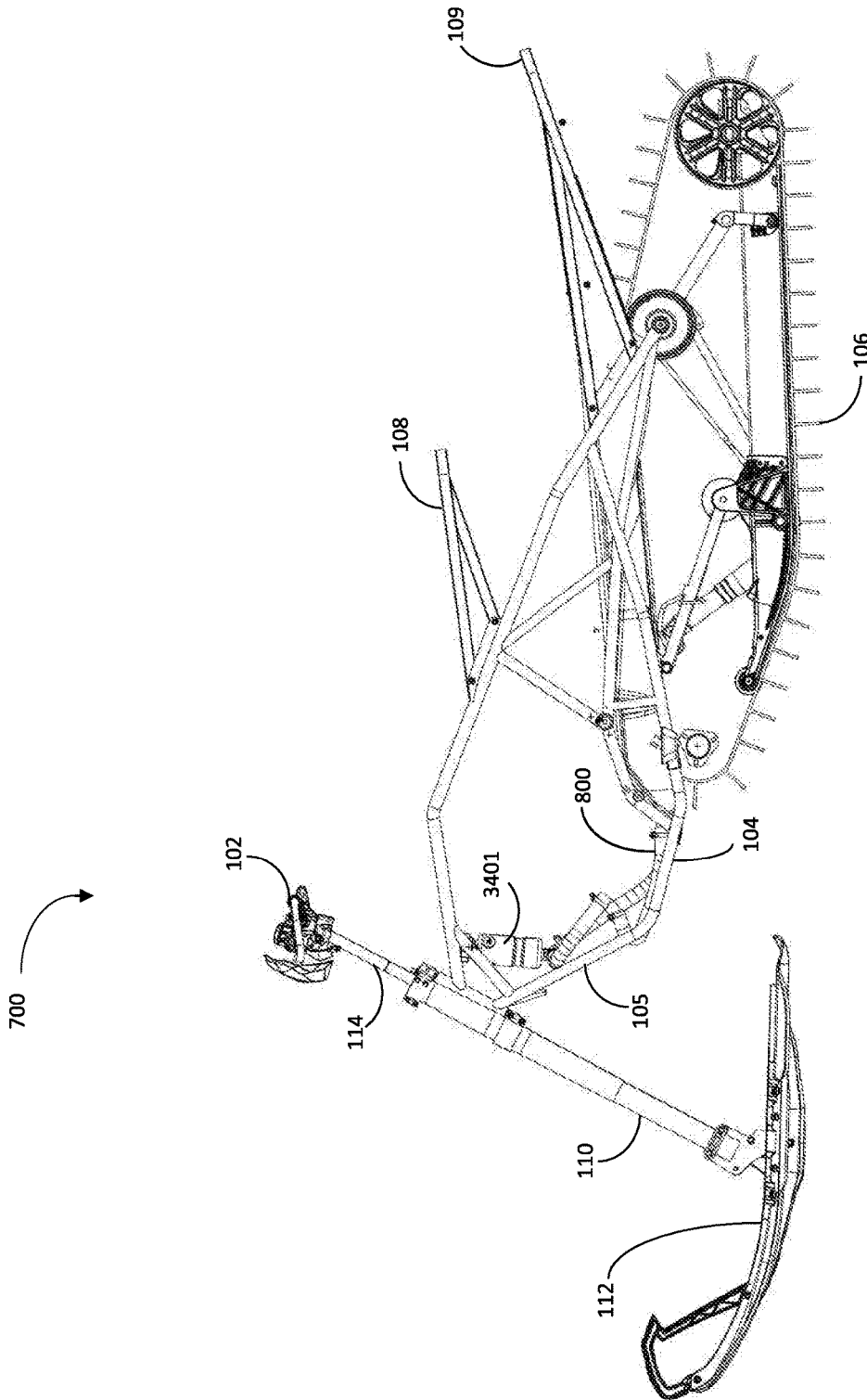

FIG. 35

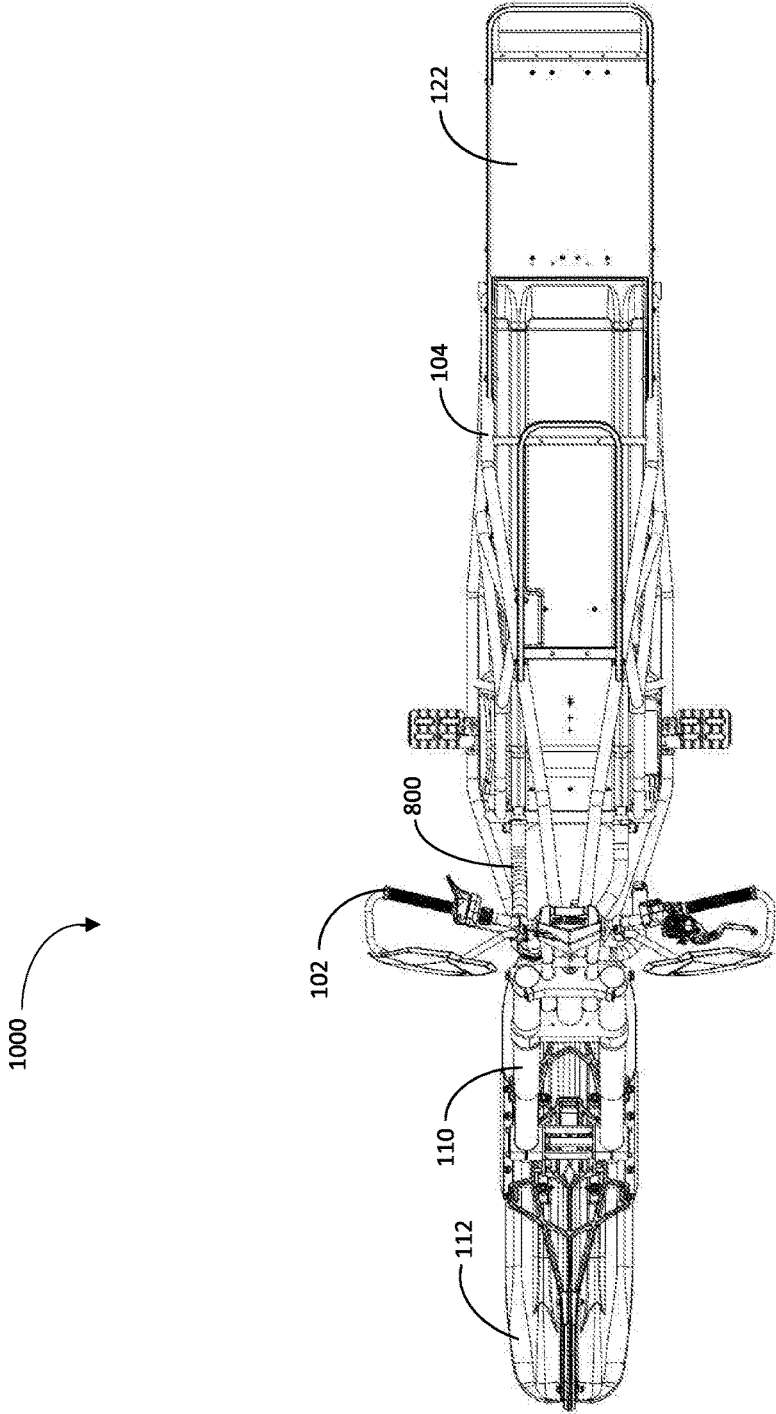

FIG. 36

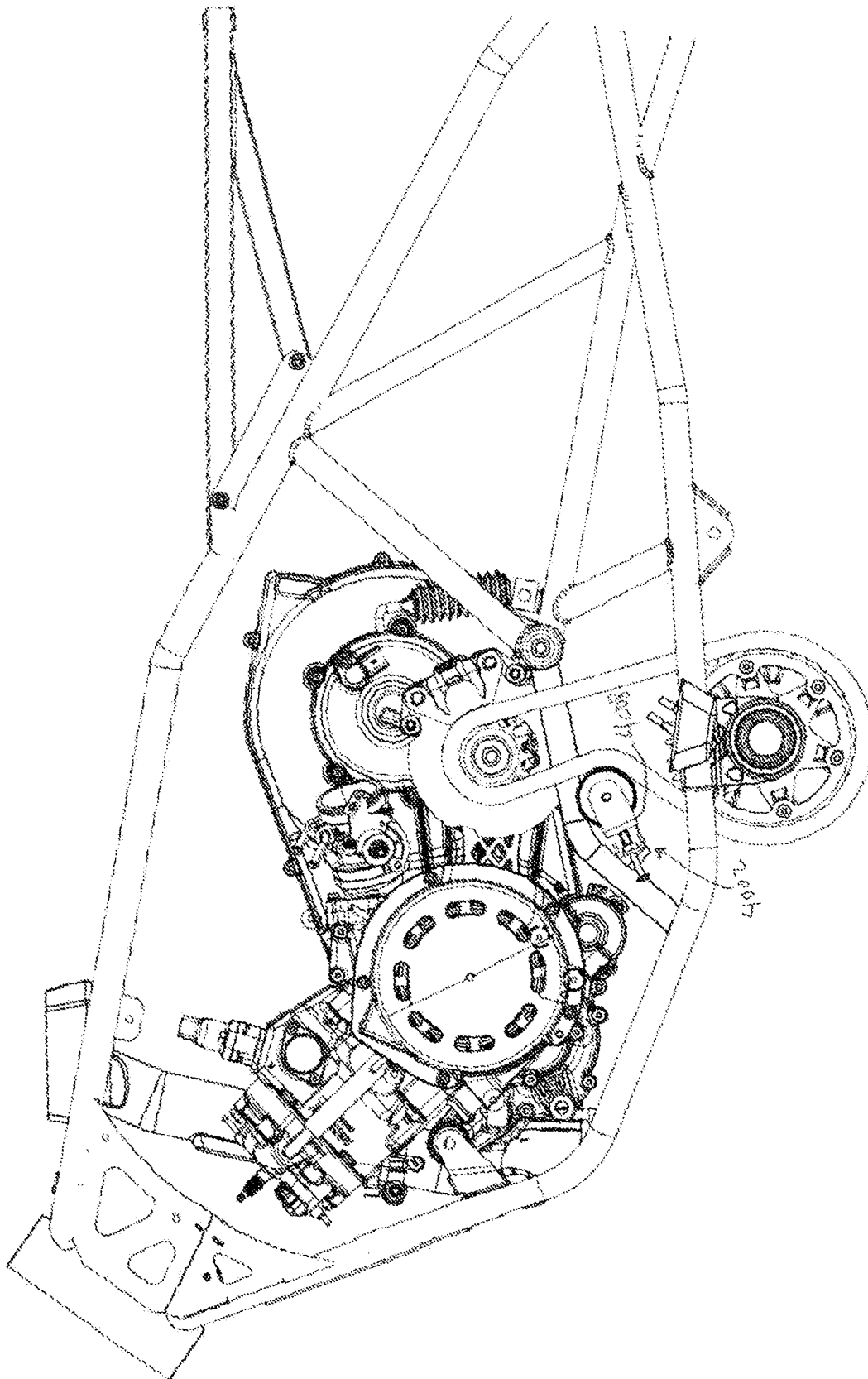

FIG. 37

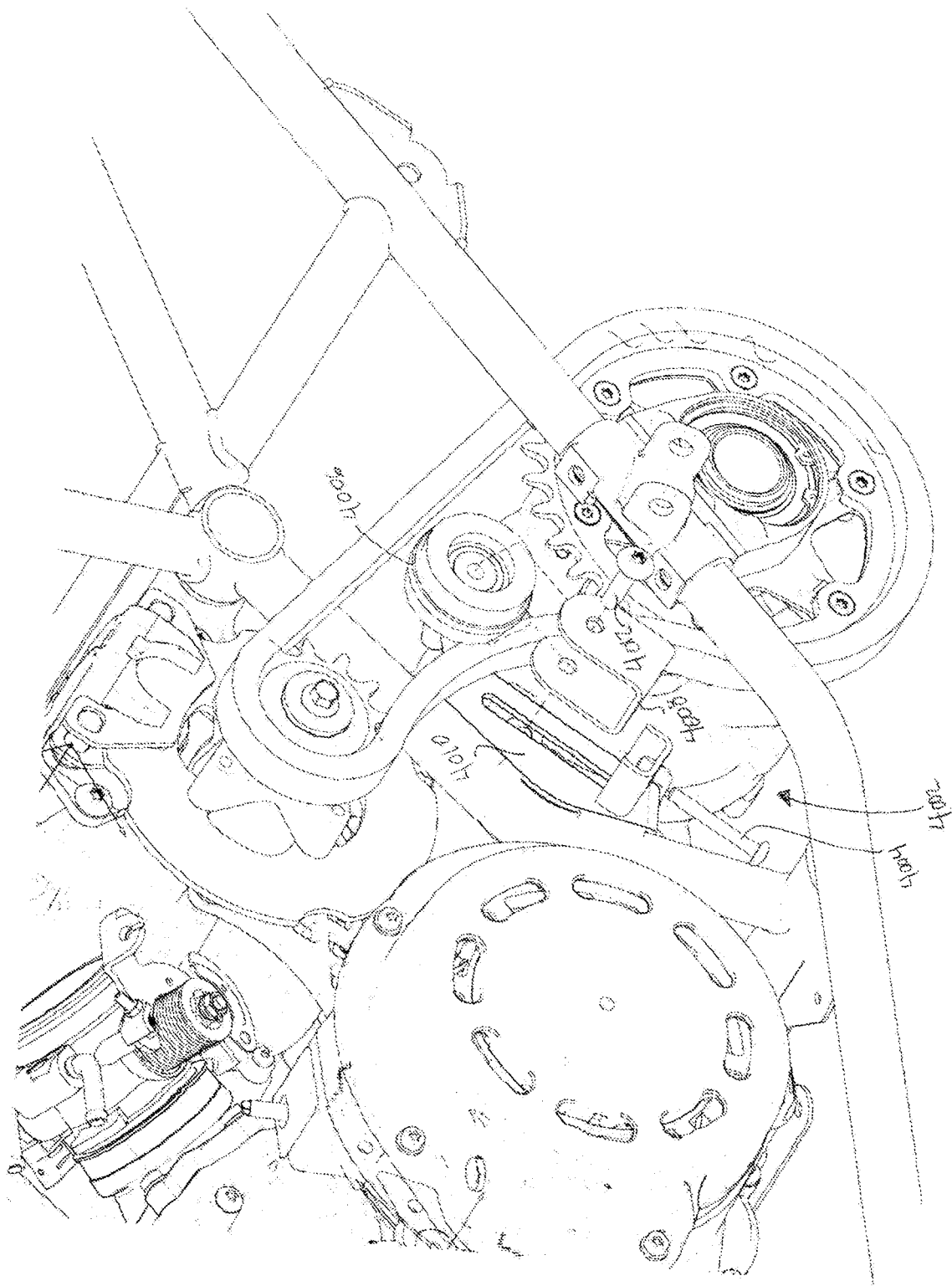

FIG. 38

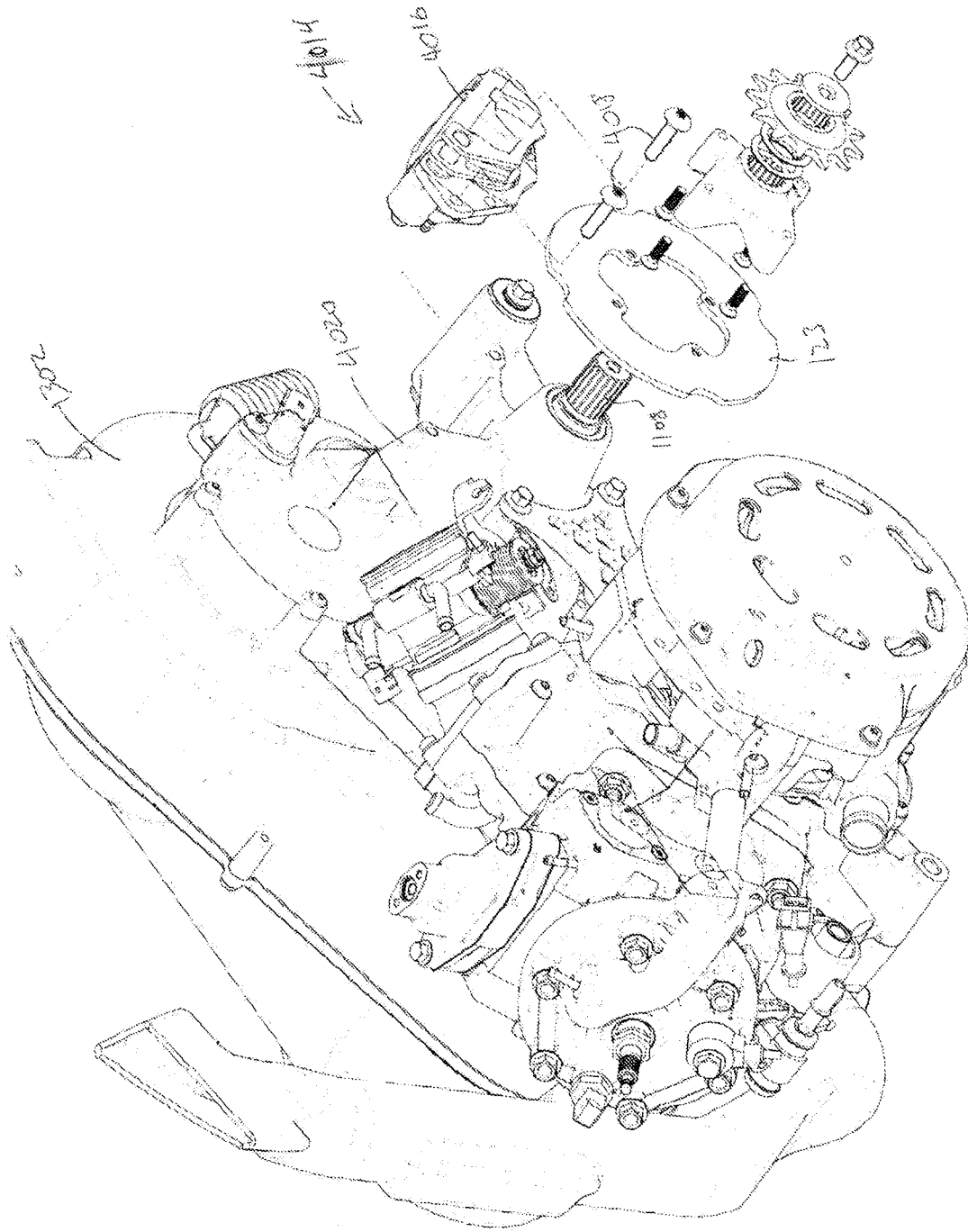
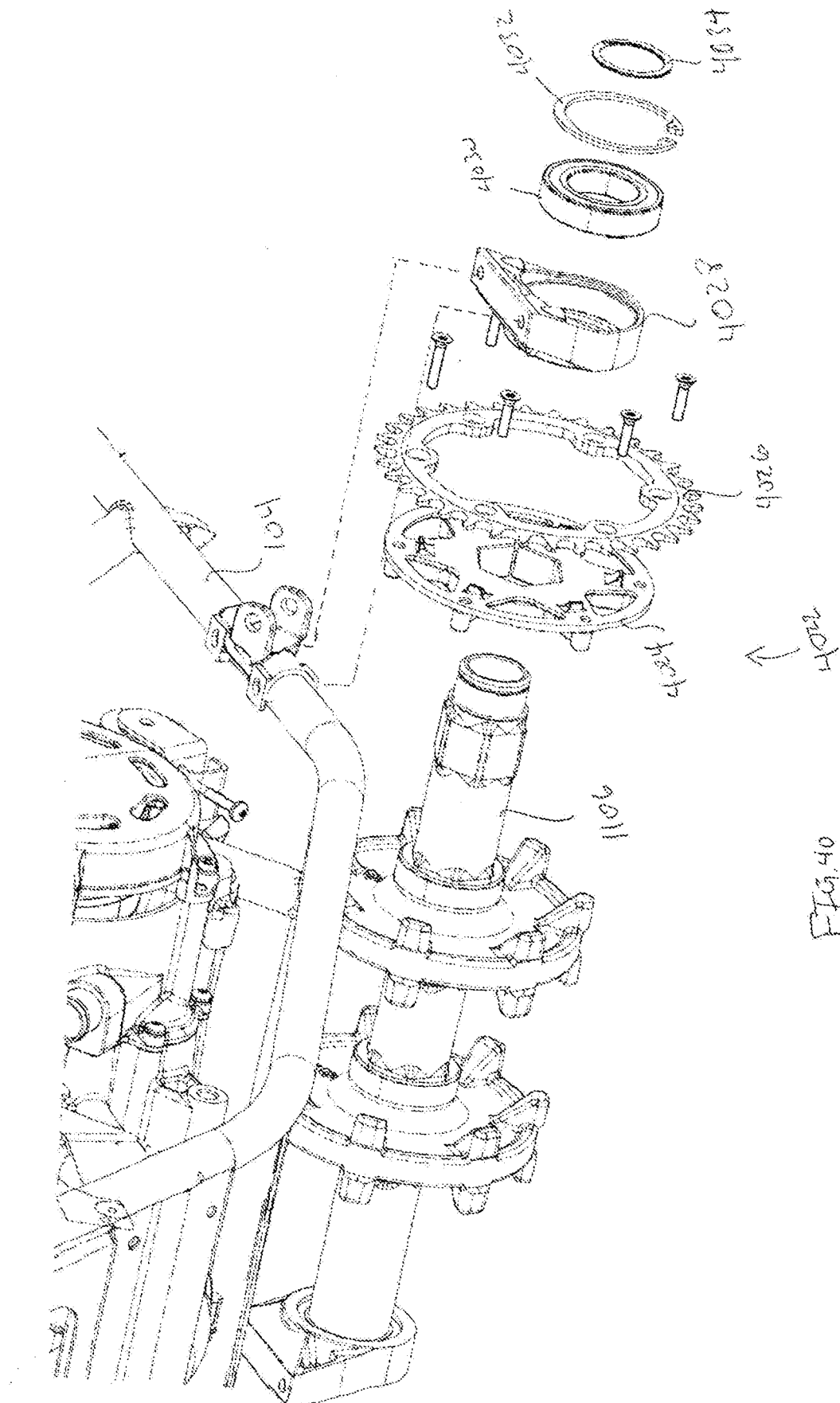

FIG. 39



1

SNOW VEHICLE**CROSS REFERENCE TO RELATED APPLICATIONS**

This application is a Continuation-In-Part of U.S. application Ser. No. 16/192,200, titled "SNOW VEHICLE," filed Nov. 17, 2018, which application claims the benefit of and priority to U.S. Provisional Application No. 62/586,559, filed Nov. 15, 2017. A claim of priority is made to the aforementioned applications.

BACKGROUND

In addition to traditional snowmobiles, an alternative snow vehicle is the snow bike or snow cycle. These vehicles are generally smaller and lighter than snowmobiles. Snow cycle designs are typically based upon off-road motorcycles with the front wheel replaced by a ski and the rear wheel replaced by an endless loop traction belt, commonly called a track. Snow bikes typically have a single steering ski and a relatively narrow track located behind and in line with the single ski.

SUMMARY

Embodiments of the present disclosure describe a snow vehicle including an engine mounted on a frame, a drive track in contact with the frame, a drive train operatively interconnecting the engine with the drive track for delivering propulsive power to the drive track, a fork connected to the frame, one or more skis connected to the fork, a drop fork component positioned between a fork and handlebars, and an exhaust system. The drive train includes a continuously variable transmission (CVT) positioned within a CVT housing.

Embodiments also describe a snow vehicle including an engine mounted on a frame, a drive track in contact with the frame, a drive train operatively interconnecting the engine with the drive track for delivering propulsive power to the drive track, a disc brake in contact with the drive train and positioned in a top-mount configuration, and an engine air intake system positioned above the engine. The air intake system includes a rearward positioned air intake port.

Embodiments describe a snow vehicle including an engine mounted on a frame, a drive track in contact with the frame, a drive train operatively interconnecting the engine with the drive track for delivering propulsive power to the drive track, a disc brake in contact with the drive train and positioned in a top-mount configuration, and an engine air intake system positioned above the engine. The air intake system includes a rearward positioned air intake port; and wherein the drive train includes a CVT.

BRIEF DESCRIPTION OF DRAWINGS

This written disclosure describes illustrative embodiments that are non-limiting and non-exhaustive. Reference is made to illustrative embodiments that are depicted in the figures, in which:

FIG. 1 illustrates a perspective view **100** of a snow vehicle, according to some embodiments.

FIG. 2 illustrates a perspective view **100** of a snow vehicle with air intake system, according to some embodiments.

FIG. 3 illustrates a partial top-down view **300** of a snow vehicle with air intake system (engine removed), according to some embodiments.

2

FIG. 4 illustrates a partial top-down view **300** of a snow vehicle with air intake system, according to some embodiments.

FIGS. 5A-D illustrate perspective views **500** of an air intake system, according to some embodiments.

FIG. 6 illustrates a partial side view **600** of a snow vehicle with air intake system, according to some embodiments.

FIG. 7 illustrates a side view **700** of a snow vehicle, according to some embodiments.

FIG. 8 illustrates a perspective view **100** of a snow vehicle with engine removed, according to some embodiments.

FIG. 9 illustrates a side view **700** of a snow vehicle with engine removed, according to some embodiments.

FIG. 10 illustrates a top-down view **1000** of a snow vehicle with cooling system, according to some embodiments.

FIGS. 11A-B illustrate perspective views **1100** of power train components, according to some embodiments.

FIGS. 12A-D illustrate perspective views **1200** of power train components, according to some embodiments.

FIG. 13 illustrates a side view **13** of a continuously variable transmission (CVT) housing with air handling components and drop box, according to some embodiments.

FIG. 14 illustrates a perspective view **1400** of a cooling system, according to some embodiments.

FIG. 15 illustrates a side view **700** of a snow vehicle with engine removed and with a cooling system, according to some embodiments.

FIG. 16 illustrates a top-down view **1000** of a snow vehicle tunnel shroud, according to some embodiments.

FIG. 17 illustrates a perspective view **100** of a snow vehicle with two-ski configuration, according to some embodiments.

FIG. 18 illustrates a side view **700** of a snow vehicle with two-ski configuration, according to some embodiments.

FIG. 19 illustrates a top-down view **1000** of a snow vehicle with two-ski configuration, according to some embodiments.

FIGS. 20A-C illustrate user or rider positioning in a dirt bike and in a snow vehicle, according to some embodiments.

FIG. 21 illustrates a perspective view **100** of a snow vehicle, according to some embodiments.

FIG. 22 illustrates a perspective view **100** of a snow vehicle with air intake system, according to some embodiments.

FIG. 23 illustrates a partial top-down view **300** of a snow vehicle with air intake system (engine removed), according to some embodiments.

FIG. 24 illustrates a partial top-down view **300** of a snow vehicle with air intake system, according to some embodiments.

FIGS. 25A-E illustrate perspective views **500** of an air intake system, according to some embodiments.

FIG. 26 illustrates a perspective view **600** of a snow vehicle with air intake system, according to some embodiments.

FIG. 27 illustrates a side view **700** of a snow vehicle, according to some embodiments.

FIG. 28 illustrates a perspective view **100** of a snow vehicle with engine removed, according to some embodiments.

FIG. 29 illustrates a side view **700** of a snow vehicle with engine removed, according to some embodiments.

FIG. 30 illustrates a top-down view **1000** of a snow vehicle with cooling system, according to some embodiments.

FIGS. 31A-B illustrate perspective views **1100** of power train components, according to some embodiments.

FIGS. 32A-D illustrate perspective views **1200** of power train components, according to some embodiments.

FIG. 33A-D illustrate a side views **1300** of a continuously variable transmission (CVT) housing with air handling components and drop box, according to some embodiments.

FIG. 34 illustrates a perspective view **1400** of a cooling system, according to some embodiments.

FIG. 35 illustrates a side view **700** of a snow vehicle with engine removed and with a cooling system, according to some embodiments.

FIG. 36 illustrates a top-down view **1000** of a snow vehicle, according to some embodiments

FIG. 37 illustrates a side view showing a tensioner assembly, according to some embodiments.

FIG. 38 illustrates an exploded view of the tensioner assembly of FIG. 37.

FIG. 39 illustrates an exploded view of a brake assembly, according to some embodiments.

FIG. 40 illustrates an exploded view of a driveshaft assembly with removable mount, according to some embodiments.

DETAILED DESCRIPTION

Snow vehicles, such as snow bikes, are often created as modifications or kits of off-road motorcycles or dirt bikes. The front wheel is temporarily replaced by a ski and the rear wheel by a power track for gripping snow and ice. Such vehicles exceed noise and safety regulations and are therefore often restricted to use on closed courses. In snow vehicle applications, reducing the weight of individual components and overall vehicle weight, without sacrificing durability, function or utility, is an ongoing goal in product design. A lighter vehicle can increase performance and handling, among other characteristics. Embodiments of the present disclosure describe a purpose-built snow vehicle with numerous advantages over current snow vehicles and snow bike kits. Embodiments herein describe a snow vehicle utilizing a continuously variable transmission (CVT) with an air handling system. The snow vehicle includes an exhaust system positioned entirely within the chassis and tunnel of the vehicle, to prevent any contact with a user or their clothing. The snow vehicle further includes a lower center of gravity in the positioning of the vehicle components within the purpose-built frame. The engine is positioned lower and forward, and additional weight, such as one or more gas tanks are further positioned to create the optimal center of gravity for handling and balance. The engine and transmission provide for both forward and reverse gearing.

Embodiments herein describe a dropped fork component that creates a lower weight of the vehicle and additional adjustment of the handlebars. An engine air handling system provides a rear facing air intake for the engine. The purpose-built chassis or frame allows for greater space utilization and a lower center of gravity of the vehicle.

Referring to FIG. 1, a perspective view **100** of a snow vehicle is shown, according to some embodiments. A chassis or frame **104** supports an engine **116**, drive train components, a drive track **106**, handlebars **102** and one or more skis **112**. The chassis includes a seat frame **108**, lower front frame component **105**, and integrated bumper **109**. Exhaust system **118** connects to muffler **120**. The chassis **104** connects to a fork **110**, in contact with the one or more skis **112**. A fork foot **113** is in contact with the fork **110** and one or more skis **112**. The fork foot **113** often mimics the radius of

a motorcycle front tire in conversion kits. A drop fork component **114** connects the fork **110** and handlebars **102**. Fuel tank **124** is positioned beneath the exhaust system **118** and seat frame **108**. Tunnel shroud **122** is positioned in contact with the chassis **104** and above the drive track **106**. The track width can be about 10 inches to about 12 inches, about 12 inches to about 13 inches, about 12.5 inches, about 13.5 inches, or about 14 inches wide. A foot peg attachment **119** can be positioned near an exterior surface. Examples of drive track **106** and other embodiments can be found in co-owned U.S. Pat. No. 9,321,509, filed on Dec. 17, 2013 with first named inventor Andrew Beavis and entitled "Snowmobile Skid Frame Assembly", the contents of which are incorporated herein by reference.

In some embodiments, the exhaust system **118** is positioned completely within the tunnel and frame **104** of the vehicle. By rotating the position of the engine **116** one hundred eighty degrees from a typical snowmobile or motorcycle configuration, the exhaust port faces a rearward direction. The exhaust system **118** can then be contained in a substantially linear configuration towards the rear of the vehicle and into a muffler **120**. The muffler **120** can also be contained within an interior of the frame **104**. The exhaust then exits the rear of the vehicle. By positioning the exhaust system **118** completely within the frame **104** and tunnel of the vehicle, a user is protected from incidental contact on the hot surface of the exhaust system **118**. A partial top-down view of a snow vehicle is shown in FIG. 3, in which exhaust system **118** runs within the width of the frame **104**.

FIG. 2 additionally shows engine air intake system **202**, according to some embodiments. The air intake system **202** is positioned above the motor and can be attached to frame **104** or integrated with the frame **104**. Shown in FIGS. 3-4 in a partial top-down view **300**, the air handling system **202** encloses the frame **104** as the tube chassis runs through the box and supports its efficient placement and space utilization. The air handling system **202** can alternatively be positioned under the frame **104**.

Referring to FIGS. 5A-D, perspective views **500** of the air intake system **202** components are shown, according to some embodiments. The air box **206** collects and funnels air as the vehicle moves. The size and position of the air box allows for a sufficient volume of air to be collected and move through the system **202** to the engine. Once collected in box **202**, the air then travels through channel component **204** to the engine **116** (see view **600** of FIG. 6). Frame channels **208** can be positioned or formed on an interior or exterior surface for attachment or integration with the frame **104**.

Referring to FIG. 7, a side view **700** of a snow vehicle is shown, according to some embodiments. The frame **104** can be comprised of a tube chassis that maximizes the position of vehicle components for space utilization and weight reduction. As the snow vehicle is not a kit for motorcycles, the engine **116** can be positioned much lower and forward as any consideration for the position of a wheel is not needed. The lower front frame component **105** can be much closer to fork **110** than in traditional snow bike configurations. A traditional motorcycle user or rider posture is show in FIG. 20A. The ergonomic position E1 is shown between foot peg, seat and handlebars. The angle A1 may be between about 27-30 degrees. D1 distance is about 29 inches in this example. D2 is about 48 inches and D3 about 3.2 inches. In one embodiment of the snow vehicle of the present disclosure (see FIG. 20B), a similar ergonomic position E1 is achieved. Hence, the rider or user is positioned in a similar manner with a user of a dirt bike. This differentiates from the position of a traditional snowmobile. In FIG. 20B, angle A1

5

can be about 24 to about 30 degrees, about 26 to about 28 degrees, or about 26.5 to about 27.5 degrees. D1 distance can be about 26 inches to about 37 inches. D1 can be about 28 inches to about 34 inches, or about 30 inches to about 33 inches for example. D6 can be about 19 inches to about 30 inches, about 22 inches to about 28 inches, or about 24 to about 26 inches. D4 can be about 15 inches to about 24 inches, about 17 inches to about 22 inches, or about 18 to about 20 inches. D5 can be about 28 inches to about 42 inches, about 32 inches to about 38 inches or about 34 inches to about 36 inches. D7 measures the distance between foot peg and track/drive shaft. Embodiments of the present invention allow for a smaller distance between the two components, as the engine 116 is positioned more forward. The track/drive shaft can even be positioned more forward than the foot peg. In motorcycles and snow kits of motorcycles, the track/drive shaft is typically about 6 to about 8 inches behind the foot peg (see D7 of FIG. 20C.). In FIG. 20B, the distance D7 can be about zero inches to about 1 inch positive (foot peg ahead of the drive shaft), or about zero inches to about 1 inch negative (drive shaft ahead of the foot peg), about 2 inches positive to about 2 inches negative, about 3 inches positive to about 3 inches negative, or about 4 inches positive to about 4 inches negative.

Additionally, the frame 104 includes integrated or attached bumper 109. If attached, the bumper 109 can be bolted, welded, or otherwise fastened. If integrated, the bumper 109 can be of a continuous construction with the frame 104. The bumper 109 can connect to the shroud 122 or be separated from shroud 122. The bumper 109 can optionally support the shroud 122 at one or more connection points. As the bumper 109 is part of frame 104 or connected to frame 104, the need for a structural tunnel shroud is removed as the bumper does not need to connect to the tunnel shroud. Current shroud 122 can be made of plastic or lightweight aluminum to further reduce weight of the vehicle. The placement of the engine 116 in a forward and lower configuration advantageously moves the center of gravity of the vehicle in a lower position. The position of the one or more fuel tanks 124 further supports the lower center of gravity.

Because the frame 104 is purpose-built to for this vehicle, the size and length of the fork 110 can be reduced. The frame 104 can connect with fork 110 at a lower position. The connection between frame 104 and fork 110 can be gusset bracket 117. The gusset bracket 117 can transfer and distribute load throughout the frame 104. A drop fork component 114 can then be utilized to connect the fork 110 and handlebars 102. The drop fork component 114 is lighter than any corresponding length of fork 110 and can further be utilized for fore and aft handlebar adjustment and rotational adjustment for the user. The drop fork component 114 can include support components 115, such as a cross brace. The drop fork component 114 can be manufactured of light weight, but durable materials, such as aluminum for example. The length of the drop fork component 114 can be about 8 inches, about 10 inches, or about 12 inches. The length of the drop fork component 114 can be about 6 inches to about 12 inches. The fork 110 can also include suspension components, such as dampeners, springs, coils, etc. The front suspension can be telescoping compression dampening component or rebound dampening component, for example.

Referring to FIG. 8, a perspective view 100 of a snow vehicle with engine 116 removed and with cooling system 800 is shown, according to some embodiments. With the engine 116 removed from view, the cooling system 800 can be seen. The cooling lines 802 connect to the engine 116,

6

and a pump (not shown) moves coolant to heat exchanger 1002 (see view 1400 of FIG. 14). The tunnel shroud 122 (see top view 1000 of FIG. 16) covers the heat exchanger 1002 (see view 700 of FIG. 15 and top view 1000 of FIG. 10) and deflects snow onto the exchanger 1002 to assist in cooling the liquid coolant (see view 700 of FIG. 9). As discussed above, the tunnel shroud 122 can be manufactured of light weight materials, such as plastic or aluminum as the need for structural support has been removed by integrating such function into frame 104. The shroud 122 can be vacuum formed, molded, or shaped into various shapes or configurations for snow deflection functionality and aesthetic considerations.

Referring to FIGS. 11A-B, 12A-D perspective views 1100, 1200 of power train components are shown, according to some embodiments. The drive train of the snow vehicle includes a continuously variable transmission (CVT), for transferring power from the engine 116 to the drive track 106. The use of an automatic transmission makes for a smoother user experience and handling as compared to manual transmission. An engine 116 converts chemical energy to mechanical energy via a rotating input shaft in contact with a transmission or drive train, such as a CVT. The CVT housing 1112 includes a rotatable drive (or primary) clutch connected to the input shaft. The CVT also includes a rotatable driven (or secondary) clutch connected to an output shaft or jack shaft 1108, the driven clutch having a laterally stationary sheave and a laterally movable sheave that is normally biased toward the stationary sheave. An endless flexible drive belt is disposed about the drive and driven clutches. Typically, the CVT transmission is connected to the output shaft 1108 of the vehicle's engine, the transmission providing continuously variable gear reduction from the relatively higher rotation speed of the engine to the relatively lower rotation speed of the vehicle drive axle. The CVT 1112 is used in conjunction with or integrated with a gear or drop box 1302 (see view 1300 of FIG. 13), for correcting the rotation of the output shaft 1108 due to the position of the engine. The drop box 1302 can include two or more gears 1304. The CVT housing 1112 with drop box 1302 is connected to the jack shaft 1108. Power is transferred via a belt 1110 from the jack shaft 1108 to driveshaft 1106, connected by suitable linkages (sprockets 1116, for example) to the drive track 106.

The endless, flexible, generally V-shaped drive belt is disposed about the clutches within housing 1112. Each of the clutches has a pair of complementary sheaves, one of the sheaves being laterally movable with respect to the other. The effective gear ratio of the transmission is determined by the positions of the movable sheaves in each of the clutches. The secondary driven clutch has its sheaves normally biased together (e.g., by a torsion spring working in combination with a helix-type cam, as described below), so that when the engine is at idle speeds the drive belt rides near the outer perimeter of the driven clutch sheaves.

The spacing of the sheaves in the primary drive clutch usually is controlled by centrifugal flyweights. As the drive clutch rotates faster (in response to increased engine rpm) the flyweights urge the movable sheave toward the stationary sheave. This pinches the drive belt, causing the belt to begin rotating with the drive clutch, the belt in turn causing the driven clutch to begin to rotate. Further movement of the drive clutch's movable sheave toward the stationary sheave forces the belt to climb outwardly on the drive clutch sheaves, increasing the effective diameter of the drive belt path around the drive clutch. Thus, the spacing of the

sheaves in the drive clutch changes based on engine rpm. The clutch therefore can be said to be speed sensitive.

As the sheaves of the drive clutch pinch the drive belt and force the belt to climb outwardly on the drive clutch sheaves, the belt (not being stretchable) is pulled inwardly between the sheaves of the driven clutch, decreasing the effective diameter of the drive belt path around the driven clutch. This movement of the belt inwardly and outwardly on the drive and driven clutches smoothly changes the effective gear ratio of the transmission in infinitely variable increments.

The CVT housing **1112** includes air handling components (e.g., ducting) to cool the operation of the CVT. Intake **1102** brings air into the housing and exit port **1104** releases the heated air from the housing **1112**. The intake **1102** can face a perpendicular direction to vehicle travel, face a parallel direction to vehicle travel, or face angles in between perpendicular and parallel vehicle travel, so long as sufficient air is gathered and moved through the handling system to cool the CVT.

In the present example, the engine **1116** is shown with a single, two-stroke cylinder **1114**. The single cylinder, two-stroke engine provides durability, simplicity, and lighter weight to the vehicle. Four-stroke engines and multi-cylinder two-stroke engines can also be used, but at the possible sacrifice of weight and size.

Referring to FIG. 17, a perspective view **100** of a snow vehicle with a two-ski configuration is shown, according to some embodiments. In place of a motorcycle-type fork, a single tube fork connection and accompanying suspension can be utilized to provide a two-ski configuration as an optional kit in place of the single ski configuration. A side view **700** (see FIG. 18) and top down view **1000** (see FIG. 19) are also shown. The two-ski configuration would allow for a snow bike feel, with increased stability and balance.

A front suspension subframe assembly **1708** connects with the frame **104**. Steering mechanism **1702** connects with the handlebars **102** and steering shaft **1710**, positioned within each spindle **1712**. The spindle **1712** connects with each ski **112**. A trailing arm **1706** connects with the frame and each spindle **1712**. Radius arms **1704** connect with the spindles **1712** and subframe assembly **1708**. Dampening components, such as shocks, springs, coils (not shown), can be attached to the subframe assembly **1708** and spindles **1712**, for example.

Referring to FIG. 21, a perspective view **100** of a snow vehicle is shown, according to some embodiments. A chassis or frame **104** supports an engine **116**, drive train components, a drive track **106**, handlebars **102** and one or more skis **112**. The chassis includes a seat frame **108**, lower front frame component **105**, and integrated bumper **109**. Exhaust system **118** connects to muffler **120**. The chassis **104** connects to a fork **110**, in contact with the one or more skis **112**. A drop fork component **114** connects the fork **110** and handlebars **102**. Fork bracket **111** contacts one or more skis **112** and fork **110**. Because the fork **110** is in a lower, dropped position than motorcycle conversion kit forks, the need for a fork foot **113** is eliminated. The fork bracket **111** provides additional adjustment features, reduces cost and simplifies manufacturing. Fuel tank **124** is positioned beneath the exhaust system **118** and seat frame **108**. The track width can be about 10 inches to about 12 inches, about 12 inches to about 13 inches, about 12.5 inches, about 13.5 inches, or about 14 inches wide. In some embodiments, the track has a width of between 10 and 18 inches; in some embodiments between 13 and 15 inches. A foot peg or pedal **121** can be positioned outside a portion of the frame **104**. Examples of drive track **106** and other embodiments can be found in

co-owned U.S. Pat. No. 9,321,509, filed on Dec. 17, 2013 with first named inventor Andrew Beavis and entitled "Snowmobile Skid Frame Assembly", the contents of which are incorporated herein by reference.

By repositioning driveshaft **1106** in a more forward and lower position than the embodiment of FIG. 1, the engine **116** can be positioned even lower, further lowering the center of gravity and shortening the entire length of the vehicle. Additionally, disc brake **123** is positioned near or above the output shaft **1108** in a top-mounted position and is therefore distanced from snow and dirt, improving its performance and extending the life of the components.

In some embodiments, the exhaust system **118** is positioned completely within the tunnel and frame **104** of the vehicle. By rotating the position of the engine **116** one hundred eighty degrees from a typical snowmobile or motorcycle configuration, the exhaust port faces a rearward direction. The exhaust system **118** can then be contained in a substantially linear configuration towards the rear of the vehicle and into a muffler **120**. The muffler **120** can also be contained within an interior of the frame **104**. The muffler **120** can be positioned directly below the seat frame **108**, partially below the seat frame **108**, or offset from the seat frame **108**. The exhaust then exits the rear of the vehicle. By positioning the exhaust system **118** completely within the frame **104** and tunnel of the vehicle, a user is protected from incidental contact on the hot surface of the exhaust system **118**. A partial top-down view of a snow vehicle is shown in FIG. 23, in which exhaust system **118** runs within the width of the frame **104**. The exhaust system **118** can be positioned in an offset position within the frame **104** and can be in line with muffler **120**, or further offset with the muffler **120**.

FIG. 22 additionally shows engine air intake system **202**, according to some embodiments. The air intake system **202** is positioned above the engine and can be attached to frame **104** or integrated with the frame **104**. Shown in FIGS. 23-24 in a partial top-down view **300**, the air handling system **202** encloses the frame **104** as a portion of the tube chassis extends through an opening in the air box and supports its placement, thereby providing efficient space utilization. In some embodiments, the frame **104** is entirely tubular. The tubular frame embodiment allows for simplicity of design and manufacture.

The air handling system **202** can alternatively be positioned under one or more portions of the frame **104**. One or more ribs **203** can be positioned on one or more interior or exterior surfaces of the air handling system **202** to increase the stiffness and reduce vibration across such surfaces. The ribs **203** can be positioned in parallel, in a perpendicular arrangement, or in other patterns that may or may not intersect to reduce vibration.

Referring to FIGS. 25A-E, perspective views **500** of the air intake system **202** components are shown, according to some embodiments. In this embodiment, the air intake system **202** is a multi-part component. The system **202** can also be a single piece component, such as a blow mold component. The air intake system **202** (e.g., air box) collects engine combustion air while minimizing the intake of undesirable particulates and/or snow. The size and position of the air box allows for a sufficient volume of air to be collected and move through the system **202** to the engine. Once collected in the air box, the air then travels into the throttle body of the engine **116** (see view **600** of FIG. 26). Frame channels can be positioned or formed for attachment of the air intake system **202** with the frame **104**.

A shield **2601** (see view **600** of FIG. 26) is positioned to deflect or absorb heat away from the fuel tank **124**. The

shield **2601** can be positioned partially or substantially around the fuel tank **124** (FIG. 27). The shield **2601** can further provide structural protection to the fuel tank **124**, such as in the event of impact.

Referring to FIG. 27, a side view **700** of a snow vehicle is shown, according to some embodiments. As the snow vehicle is not a kit for motorcycles, the engine **116** can be positioned much lower and forward as any consideration for the position of a wheel is not needed. The lower front frame component **105** can be much closer to fork **110** than in traditional snow bike configurations. A traditional motorcycle user or rider posture is shown in FIG. 20A. The ergonomic position **E1** between foot peg, seat and handlebars. The angle **A1** may be between about 27-30 degrees. **D1** distance is about 29 inches in this example. **D2** is about 48 inches and **D3** about 3.2 inches. In one embodiment of the snow vehicle of the present disclosure (see FIG. 20B), a similar ergonomic position **E1** is achieved. This differentiates from the position of a traditional snowmobile. In FIG. 20B, angle **A1** can be about 24 to about 30 degrees, about 26 to about 28 degrees, or about 26.5 to about 27.5 degrees.

In some embodiments, the frame **104** includes integrated or attached bumper **109**. If attached, the bumper **109** can be bolted, welded, or otherwise fastened. If integrated, the bumper **109** can be of a continuous construction with the frame **104**. The bumper **109** can connect to a shroud or body panel or be separated therefrom. The bumper **109** can optionally support the shroud at one or more connection points. As the bumper **109** is part of frame **104** or connected to frame **104**, there may not be a need for a structural tunnel. The placement of the engine **116** in a forward and lower configuration advantageously moves the center of gravity of the vehicle in a lower position. The position of the one or more fuel tanks **124** further supports the lower center of gravity.

Because the frame **104** is purpose-built to for this vehicle, the frame **104** can connect with fork **110** at a lower position, when compared to snow bike kits. The connection between frame **104** and fork **110** can be gusset bracket **117**. The gusset bracket **117** can transfer and distribute load throughout the frame **104**. A drop fork component **114** can then be utilized to connect the fork **110** and handlebars **102**. The drop fork component **114** is lighter than any corresponding length of fork **110** and can further be utilized for fore and aft handlebar adjustment and rotational adjustment for the user. The drop fork component **114** can include support components **115**, such as a cross brace. The drop fork component **114** can be manufactured of light weight, but durable materials, such as aluminum or composite (e.g., carbon fiber) for example. The length of the drop fork component **114** can be about 8 inches, about 10 inches, or about 12 inches. The length of the drop fork component **114** can be about 6 inches to about 12 inches. The fork **110** can also include suspension components, such as dampeners, springs, coils, etc. The front suspension can be telescoping compression dampening component or rebound dampening component, for example.

Referring to FIG. 28, a perspective view **100** of a snow vehicle with engine **116** removed and with cooling system **800** is shown, according to some embodiments. With the engine **116** removed from view, the cooling system **800** can be seen. The cooling lines **802** connect to the engine **116**, and a pump (not shown) moves coolant to heat exchanger **1002** (see view **1400** of FIG. 34). A tunnel shroud (not shown) can cover the heat exchanger **1002** (see view **700** of FIG. 35 and top view **1000** of FIG. 30) and deflects snow onto the exchanger **1002** to assist in cooling the liquid coolant (see view **700** of FIG. 29). Cooling system connec-

tor **3401** facilitates connection with engine **116**. Lines **802** can be consolidated at one or more points along the system **800**.

Referring to FIGS. 31A-B, 32A-D perspective views **1100**, **1200** of power train components are shown, according to some embodiments. The drive train of the snow vehicle includes a continuously variable transmission (CVT), for transferring power from the engine **116** to the drive track **106**. The use of an automatic transmission makes for a smoother user experience and handling as compared to manual transmission and helps to ensure that the engine operates in a desirable powerband. An engine **116** converts chemical energy to mechanical energy via a rotating input shaft in contact with a transmission or drive train, such as a CVT. The CVT housing **1112** includes a rotatable drive (or primary) clutch connected to the input shaft. The CVT also includes a rotatable driven (or secondary) clutch connected to an output shaft or jack shaft **1108**, the driven clutch having a laterally stationary sheave and a laterally movable sheave that is normally biased toward the stationary sheave. An endless flexible drive belt is disposed about the drive and driven clutches. The CVT **1112** is used in conjunction with or integrated with a gear or drop box **1302** (see view **1300** of FIGS. 33A-D), for correcting the rotation of the output shaft **1108** due to the position of the engine. The drop box **1302** can include two or more gears **1304**. The CVT housing **1112** with drop box **1302** is connected to the jack shaft **1108**. Power is transferred via a belt **1110** (or chain or gear set or combination thereof) from the jack shaft **1108** to driveshaft **1106**, connected by suitable linkages (sprockets **1116**, for example) to the drive track **106**.

The endless, flexible, generally V-shaped drive belt is disposed about the clutches within housing **1112**. Each of the clutches has a pair of complementary sheaves, one of the sheaves being laterally movable with respect to the other. The effective gear ratio of the transmission is determined by the positions of the movable sheaves in each of the clutches. The secondary driven clutch has its sheaves normally biased together (e.g., by a torsion spring working in combination with a helix-type cam, as described below), so that when the engine is at idle speeds the drive belt rides near the outer perimeter of the driven clutch sheaves.

The CVT housing **1112** includes air handling components (e.g., ducting) to cool the operation of the CVT. Intake **1102** brings air into the housing and exit port **1104** releases the heated air from the housing **1112**. The intake **1102** can face a perpendicular direction to vehicle travel, face a parallel direction to vehicle travel, or face angles in between perpendicular and parallel vehicle travel, so long as sufficient air is gathered and moved through the handling system to cool the CVT. In some embodiments, the intake **1102** is at least partially obscured by a body panel, frame member, etc., and/or directed so as to not be susceptible to ingesting snow or other foreign debris.

In the present example, the engine **1116** is shown with a single, two-stroke cylinder **1114**. The single cylinder, two-stroke engine provides durability, simplicity, and lighter weight to the vehicle. Four-stroke engines and multi-cylinder two-stroke engines can also be used, but at the possible sacrifice of weight and size.

Referring to FIG. 17, a perspective view **100** of a snow vehicle with a two-ski configuration is shown, according to some embodiments. In place of a motorcycle-type fork, a single tube fork connection and accompanying suspension can be utilized to provide a two-ski configuration as an optional kit in place of the single ski configuration. A side view **700** (see FIG. 18) and top down view **1000** (see FIG.

19) are also shown. The two-ski configuration would allow for a snow bike feel, with increased stability and balance.

A front suspension subframe assembly **1708** connects with the frame **104**. Steering mechanism **1702** connects with the handlebars **102** and steering shaft **1710**, positioned within each spindle **1712**. The spindle **1712** connects with each ski **112**. A trailing arm **1706** connects with the frame and each spindle **1712**. Radius arms **1704** connect with the spindles **1712** and subframe assembly **1708**. Dampening components, such as shocks, springs, coils (not shown), can be attached to the subframe assembly **1708** and spindles **1712**, for example.

Turning to FIGS. **37** and **38**, an embodiment of a tensioner assembly **4002** is shown. The tensioner assembly **4002** tensions the belt or chain **1110**. In some embodiments, the tensioner assembly **4002** includes an adjuster **4004**, roller **4006**, roller bracket **4008**, securing bracket **4010**, and securing fastener **4012**. The tensioner assembly **4002** is used to keep the chain or belt tensioned in order to prevent slippage of the chain or belt relative to the driving and driven sprockets (or pulleys, etc.). In some embodiments, the adjuster **4004** is a fastener such as a bolt that can be rotated to tension the chain or belt. Once a desirable tension has been achieved, the securing fastener **4012** is tightened against another fastener on the opposing side of the securing bracket **4008**, thereby clamping the roller bracket **4008** against the securing bracket **4010**.

FIG. **39** shows an exploded view of a brake assembly **4014**, according to some embodiments. In some embodiments, the brake assembly **4014** includes a disc **123**, caliper **4016**, and mounting hardware **4018**. In some embodiments, the caliper **4016** is fastened to a structural casing **4020** portion of the drop box **1302**. Further, in some embodiments the brake disc **123** is coaxial with the jack shaft **1108** and the output gear from the gearset **1304** (shown in FIG. **33A**). In this way, the brake disc **123** and caliper **4016** are located above the track/drive shaft and are more protected from snow and other debris when compared to an embodiment where the brake disc is located coaxially with the track/drive shaft.

With regard to FIG. **40**, a driveshaft assembly **4022** is shown, according to some embodiments. In some embodiments, the driveshaft assembly **4022** includes a driveshaft **1106**, drive adapter **4024**, and driven sprocket **4026**. In some embodiments, for example as shown in FIG. **40**, the drive adapter **4024** and driven sprocket **4026** are separate components attached together via fasteners. In some embodiments, however, the drive adapter **4024** and driven sprocket **4026** are formed as a single component.

In some embodiments, the driveshaft assembly **4022** is mounted to the chassis **104** via one or more carriers **4028**. In some embodiments, the carrier(s) **4028** are readily removable from the chassis **104**, along with the driveshaft **1106**, drive adapter **4024**, etc., as shown. In some embodiments, the carrier(s) **4028** are fastened to the chassis **104** adjacent to a foot peg. As further shown in FIG. **40**, in some embodiments, a bearing **4030** is retained within the carrier **4028** via snap ring **4032** (or other retainer) and the driveshaft **1106** is retained in the bearing **4030** via a circlip **4034** (e.g., spiral lock circlip). As noted above, it should be appreciated that the assembly can be easily removed from the chassis **104**, thereby facilitating ease of maintenance and/or track changes without sophisticated disassembly of the vehicle.

Other embodiments of the present disclosure are possible. Although the description above contains much specificity, these should not be construed as limiting the scope of the disclosure, but as merely providing illustrations of some of

the presently preferred embodiments of this disclosure. It is also contemplated that various combinations or sub-combinations of the specific features and aspects of the embodiments may be made and still fall within the scope of this disclosure. It should be understood that various features and aspects of the disclosed embodiments can be combined with or substituted for one another in order to form various embodiments. Thus, it is intended that the scope of at least some of the present disclosure should not be limited by the particular disclosed embodiments described above.

Thus, the scope of this disclosure should be determined by the appended claims and their legal equivalents. Therefore, it will be appreciated that the scope of the present disclosure fully encompasses other embodiments which may become obvious to those skilled in the art, and that the scope of the present disclosure is accordingly to be limited by nothing other than the appended claims, in which reference to an element in the singular is not intended to mean "one and only one" unless explicitly so stated, but rather "one or more." All structural, chemical, and functional equivalents to the elements of the above-described preferred embodiment that are known to those of ordinary skill in the art are expressly incorporated herein by reference and are intended to be encompassed by the present claims. Moreover, it is not necessary for a device or method to address each and every problem sought to be solved by the present disclosure, for it to be encompassed by the present claims. Furthermore, no element, component, or method step in the present disclosure is intended to be dedicated to the public regardless of whether the element, component, or method step is explicitly recited in the claims.

The foregoing description of various preferred embodiments of the disclosure have been presented for purposes of illustration and description. It is not intended to be exhaustive or to limit the disclosure to the precise embodiments, and obviously many modifications and variations are possible in light of the above teaching. The example embodiments, as described above, were chosen and described in order to best explain the principles of the disclosure and its practical application to thereby enable others skilled in the art to best utilize the disclosure in various embodiments and with various modifications as are suited to the particular use contemplated. It is intended that the scope of the disclosure be defined by the claims appended hereto. Various examples have been described. These and other examples are within the scope of the following claims.

What is claimed is:

1. A snow bike, comprising:
 - an engine mounted on a frame;
 - a drive track connected to the frame;
 - an output shaft operatively interconnecting the engine with the drive track for delivering propulsive power to the drive track;
 - a fork rotatably connected to the frame;
 - a ski connected to the fork;
 - handlebars connected to the fork; and
 - an engine cooling system comprising a heat exchanger and cooling lines interconnecting the heat exchanger to the engine, wherein the heat exchanger is entirely horizontally disposed between a rear bumper and two frame rails, wherein the two frame rails extend from the rear bumper and are located opposite one another, wherein the heat exchanger does not protrude below the rear bumper or the two frame rails, and wherein the rear bumper is located above the drive track.

13

2. The snow bike of claim 1, wherein the engine cooling system further comprises a pump configured to circulate a coolant between the engine and the heat exchanger through the cooling lines.

3. The snow bike of claim 1, further comprising a shroud configured to deflect snow onto the heat exchanger.

4. The snow bike of claim 3, wherein the shroud is mounted to the frame and positioned above the drive track.

5. The snow bike of claim 4, wherein the shroud is positioned above the heat exchanger.

6. The snow bike of claim 5, wherein the shroud is positioned above the drive track.

7. The snow bike of claim 4, wherein the shroud is configured to deflect snow from the drive track onto the heat exchanger.

8. The snow bike of claim 4, wherein the shroud is formed of a material selected from a list consisting of aluminum and plastic.

9. The snow bike of claim 4, wherein the shroud is shaped and located to deflect snow onto the heat exchanger.

10. The snow bike of claim 1, wherein the fork comprises two parallel tubes.

11. The snow bike of claim 10, wherein the fork comprises suspension components.

12. The snow bike of claim 11, wherein the suspension components include dampeners selected from the list consisting of a telescoping compression dampening component and a rebound dampening component.

14

13. The snow bike of claim 1, further comprising a foot peg positioned outside a portion of the frame.

14. The snow bike of claim 13, wherein the output shaft is mounted to the frame via one or more carriers and wherein the one or more carriers are fastened to the frame adjacent to the foot peg.

15. The snow bike of claim 1, further comprising:
a seat connected to the frame; and

a foot peg mounted on frame, wherein the foot peg is in a range of 10 centimeters forward of the output shaft to 10 centimeters rearward of the output shaft.

16. The snow bike of claim 15, wherein the foot peg is up to 10 centimeters rearward of the output shaft.

17. The snow bike of claim 15, wherein the foot peg is less than or equal to 10 centimeters forward of the output shaft.

18. The snow bike of claim 15, wherein a distance between the seat and the foot peg is in a range of 38 centimeters to 61 centimeters.

19. The snow bike of claim 15, wherein a distance between the handlebars and the foot peg is in a range of 71 centimeters to 107 centimeters.

20. The snow bike of claim 15, wherein a distance between the seat and the handlebars is in a range of 48 centimeters to 76 centimeters.

21. The snow bike of claim 1, wherein a fork rake angle of the fork is in a range of 24 to 30 degrees from vertical.

* * * * *