



US007188693B2

(12) **United States Patent**
Girouard et al.

(10) **Patent No.:** **US 7,188,693 B2**
(45) **Date of Patent:** ***Mar. 13, 2007**

(54) **FRAME CONSTRUCTION FOR A VEHICLE**

(75) Inventors: **Bruno Girouard**, Montreal (CA);
Berthold Fecteau, Richmond (CA);
Jérôme Wubbolts, Orford (CA);
Anne-Marie Dion, Granby (CA)

(73) Assignee: **Bombardier Recreational Products Inc.**, Valcourt (CA)

(*) Notice: Subject to any disclaimer, the term of this patent is extended or adjusted under 35 U.S.C. 154(b) by 0 days.

This patent is subject to a terminal disclaimer.

(21) Appl. No.: **11/127,161**

(22) Filed: **May 12, 2005**

(65) **Prior Publication Data**

US 2005/0205322 A1 Sep. 22, 2005

Related U.S. Application Data

(63) Continuation of application No. 09/877,212, filed on Jun. 11, 2001, and a continuation-in-part of application No. 09/472,133, filed on Dec. 23, 1999, now abandoned.

(60) Provisional application No. 60/237,384, filed on Oct. 4, 2000.

(30) **Foreign Application Priority Data**

Dec. 23, 1998 (CA) 2256944

(51) **Int. Cl.**
B62M 27/02 (2006.01)

(52) **U.S. Cl.** **180/184**; 180/182; 180/186;
180/190; 296/203.01; 296/205

(58) **Field of Classification Search** 180/182, 180/184, 186, 190, 183; 296/203.01, 205
See application file for complete search history.

(56) **References Cited**

U.S. PATENT DOCUMENTS

D175,866 S 10/1955 Strunk

(Continued)

OTHER PUBLICATIONS

Creations J.P.L. Inc. Advertisement (advertising seat designs).

(Continued)

Primary Examiner—Lesley D. Morris

Assistant Examiner—Marc A. Scharich

(74) *Attorney, Agent, or Firm*—Osler, Hoskin & Harcourt LLP

(57) **ABSTRACT**

A frame assembly is described including a tunnel, an engine cradle disposed forward of the tunnel and connected thereto, and a sub-frame disposed forward of the engine cradle and connected thereto. A forward support assembly extends upwardly from the subframe. An upper column extends upwardly from the engine cradle to connect with the forward support assembly. A rear brace assembly extends upwardly from the tunnel to connect with the forward support assembly and the upper column. In one embodiment, the frame assembly further includes an engine disposed in the engine cradle. An endless track is operatively connected to the engine and disposed beneath the tunnel for propulsion. A pair of skis is operatively connected to a steering device for steering. In another embodiment, the frame assembly further includes an engine disposed in the engine cradle. A rear wheel is operatively connected to the engine and disposed beneath the tunnel for propulsion, and two front wheels are operatively connected to a steering device for steering.

20 Claims, 33 Drawing Sheets

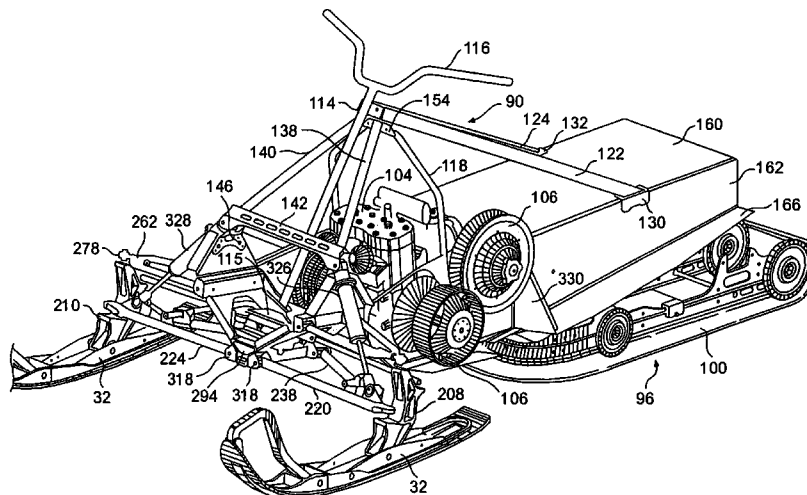

U.S. PATENT DOCUMENTS

3,583,506	A	6/1971	Preble	
3,583,507	A	6/1971	Trautwein	
3,622,196	A	11/1971	Sarra	
3,627,073	A	12/1971	Grimm	
3,653,453	A	4/1972	Titola	
3,804,455	A *	4/1974	Gorski	296/205
3,815,696	A *	6/1974	Larive et al.	180/190
3,827,516	A *	8/1974	Lucia	280/22.1
3,981,373	A	9/1976	Irvine	
4,204,581	A	5/1980	Husted	
4,204,582	A	5/1980	Van Soest	
4,407,383	A	10/1983	Enokimoto et al.	
4,502,560	A	3/1985	Hisatomi	
4,613,006	A	9/1986	Moss et al.	
4,620,604	A	11/1986	Talbot	
4,633,964	A	1/1987	Boyer et al.	
4,699,229	A *	10/1987	Hirose et al.	180/9.21
4,787,470	A	11/1988	Badsey	
4,848,503	A	7/1989	Yasui et al.	
5,370,198	A	12/1994	Karpik	
5,474,146	A *	12/1995	Yoshioka et al.	180/184
5,564,517	A	10/1996	Levasseur	
5,586,614	A	12/1996	Kouchi	
5,660,245	A *	8/1997	Marier et al.	180/190
5,904,217	A	5/1999	Yamamoto et al.	
5,944,133	A	8/1999	Eto	
5,996,717	A *	12/1999	Hisadomi	180/182
6,170,590	B1 *	1/2001	Hisadomi	180/190
6,227,323	B1	5/2001	Ashida	
6,234,263	B1	5/2001	Boivin et al.	
6,328,124	B1 *	12/2001	Olson et al.	180/182
6,343,666	B1 *	2/2002	Olson et al.	180/182
6,357,543	B1 *	3/2002	Karpik	180/182
6,446,744	B2 *	9/2002	Wubbolts et al.	180/190

6,491,125	B2 *	12/2002	Girouard et al.	180/190
6,499,551	B2 *	12/2002	Karpik	180/190
6,561,302	B2 *	5/2003	Karpik	180/291
6,604,594	B2 *	8/2003	Wubbolts et al.	180/186
6,655,487	B2 *	12/2003	Mallette et al.	180/190
6,691,812	B2 *	2/2004	Karpik	180/190
6,823,957	B2 *	11/2004	Girouard et al.	180/190
6,889,787	B2 *	5/2005	Karpik	180/190
2001/0047900	A1 *	12/2001	Fecteau et al.	180/190
2002/0053477	A1 *	5/2002	Karpik	180/182
2003/0127265	A1 *	7/2003	Watson et al.	180/190
2003/0183436	A1 *	10/2003	Karpik	180/190
2003/0201128	A1 *	10/2003	Girouard et al.	180/190
2003/0201129	A2 *	10/2003	Fecteau et al.	180/190
2004/0134702	A1 *	7/2004	Karpik	180/190
2005/0115754	A1 *	6/2005	Watson et al.	180/190
2005/0126839	A1 *	6/2005	Rasidescu et al.	180/190
2005/0205320	A1 *	9/2005	Girouard et al.	180/190
2005/0205321	A1 *	9/2005	Girouard et al.	180/190
2005/0205322	A1 *	9/2005	Girouard et al.	180/190

OTHER PUBLICATIONS

Magazine Article: Dirt Wheels/Jan. 1991.
 Brochure of Yamaha Snow Scout: Motoneige Quebec, 1987, vol. 13, No. 1 (CA).
 Brochure of Yamaha Snow Scout: Snowmobile Brochure Business, 3rd Annual.
 Magazine Supertrax/Jan. 1999.
 Snow Tech, Spring 1999, Article "Special Report" Redline Snowmobiles, pp. 28-31.
 Motoneige Quebec, vol. 25-No. 3, Nov. 1999, pp. 1 (front cover), 6, 31 and 58.
 Ski-Doo Parts Catalogue No. 480 1263 00, 1991, pp. C12, D1, D2 and D3.

* cited by examiner

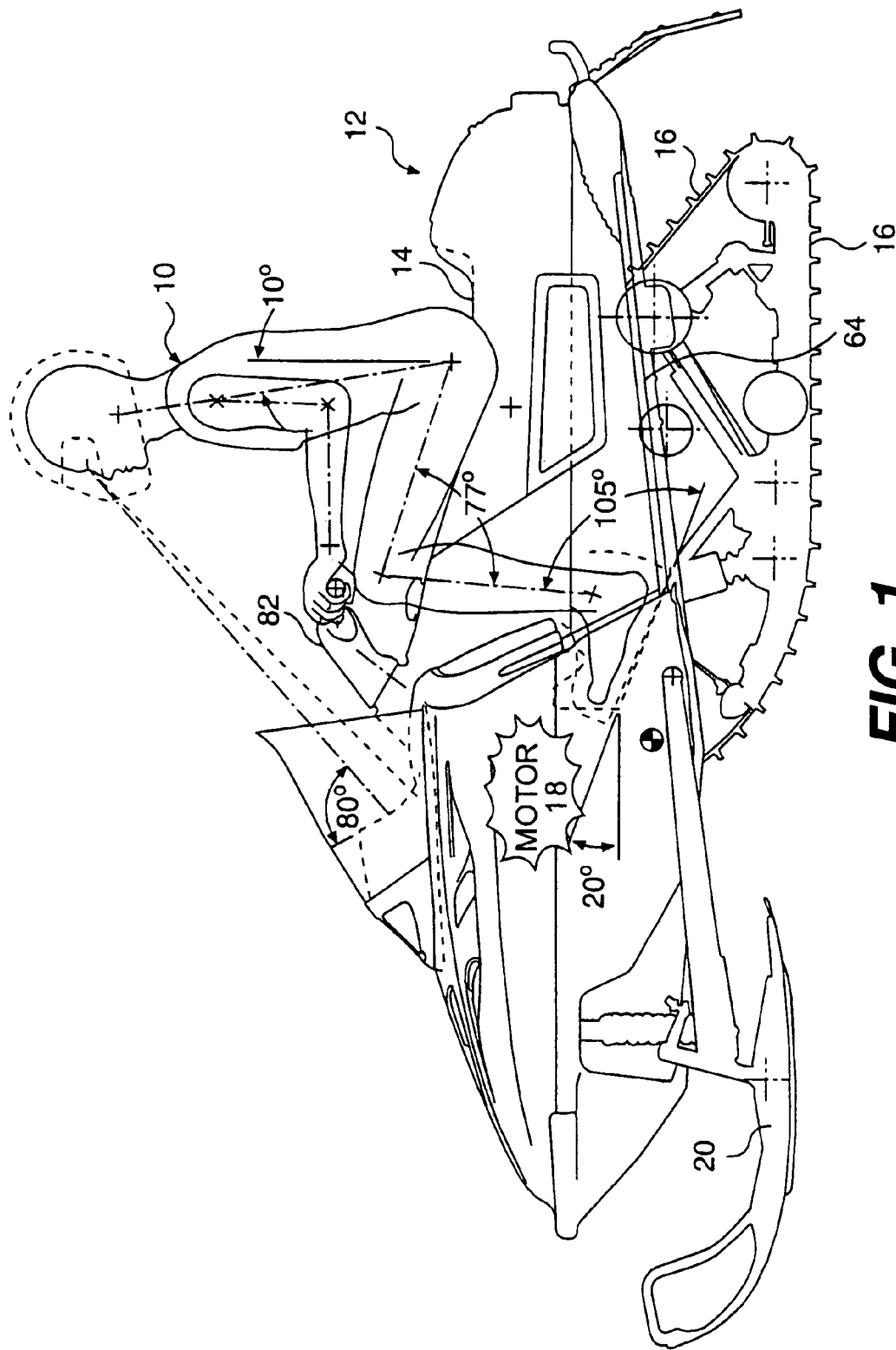
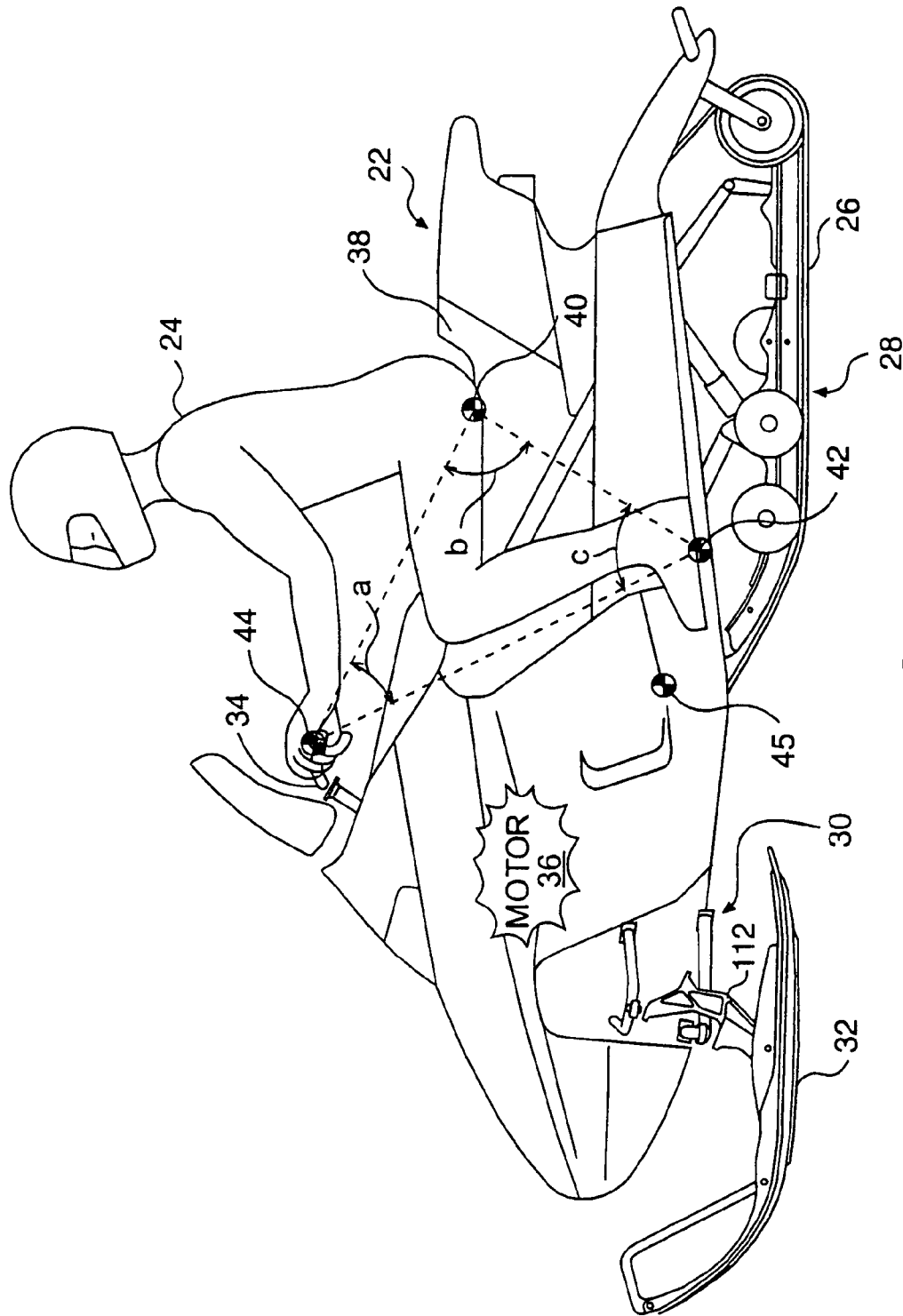

FIG. 1
PRIOR ART



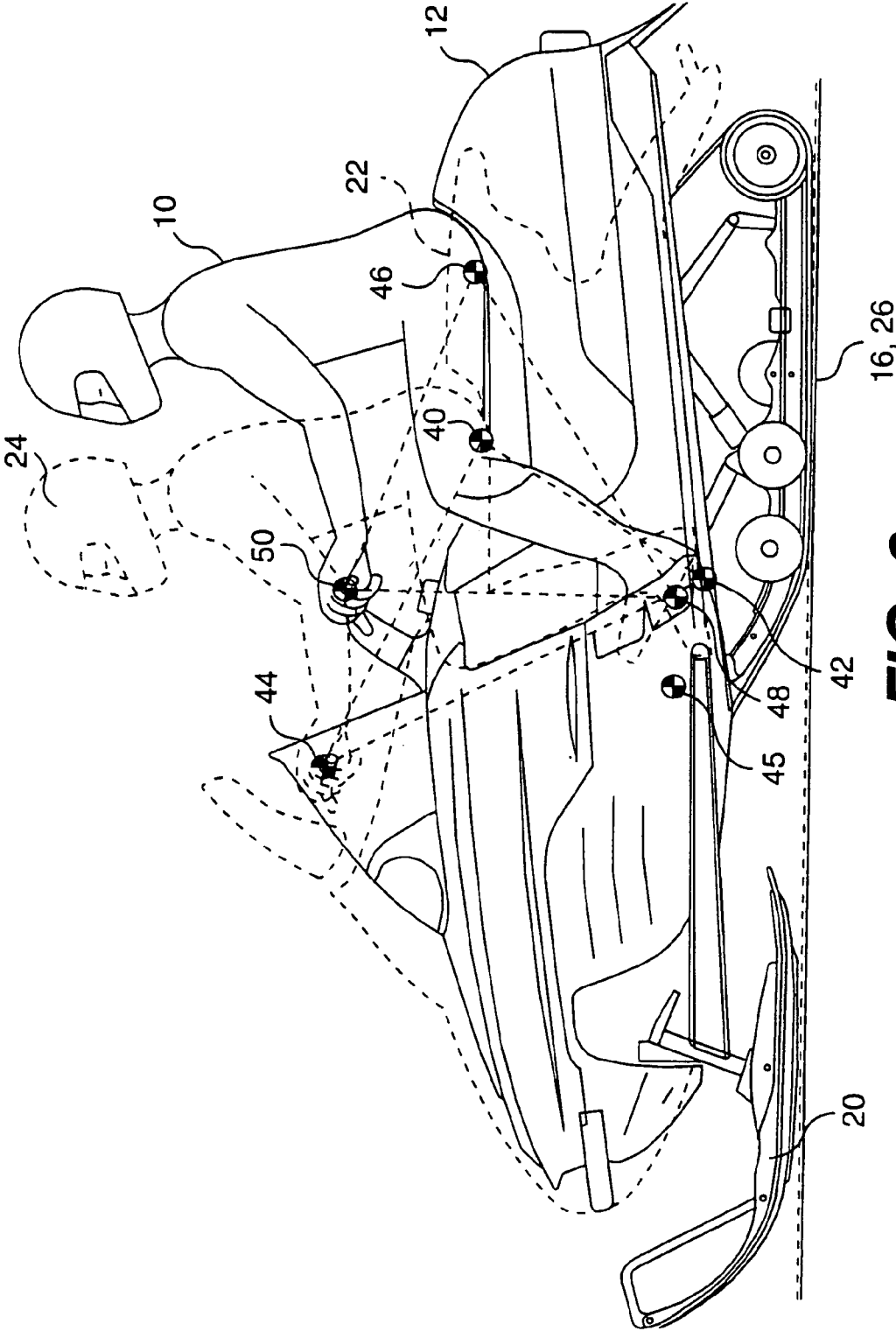

FIG. 3

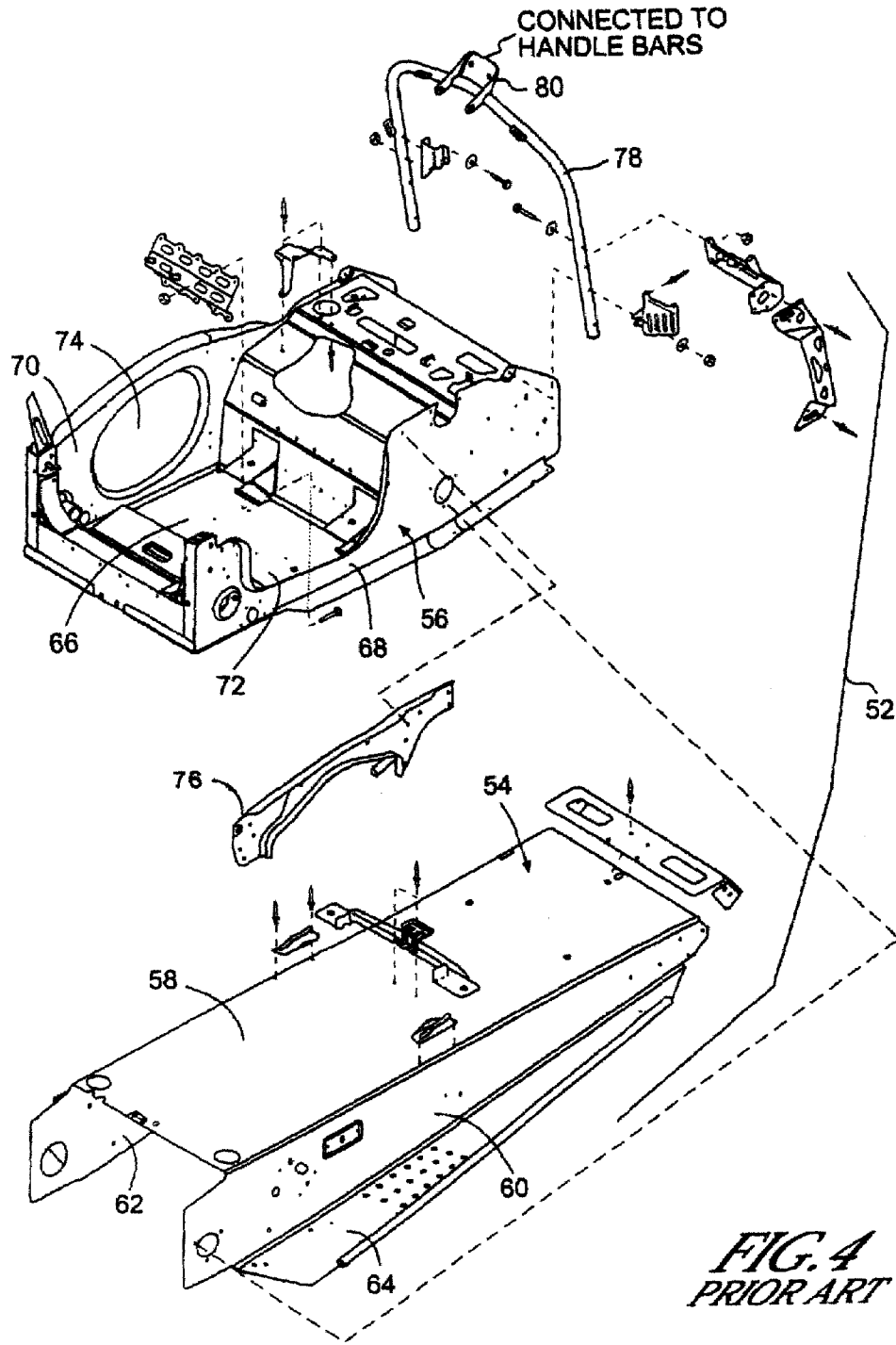

FIG. 4
PRIOR ART

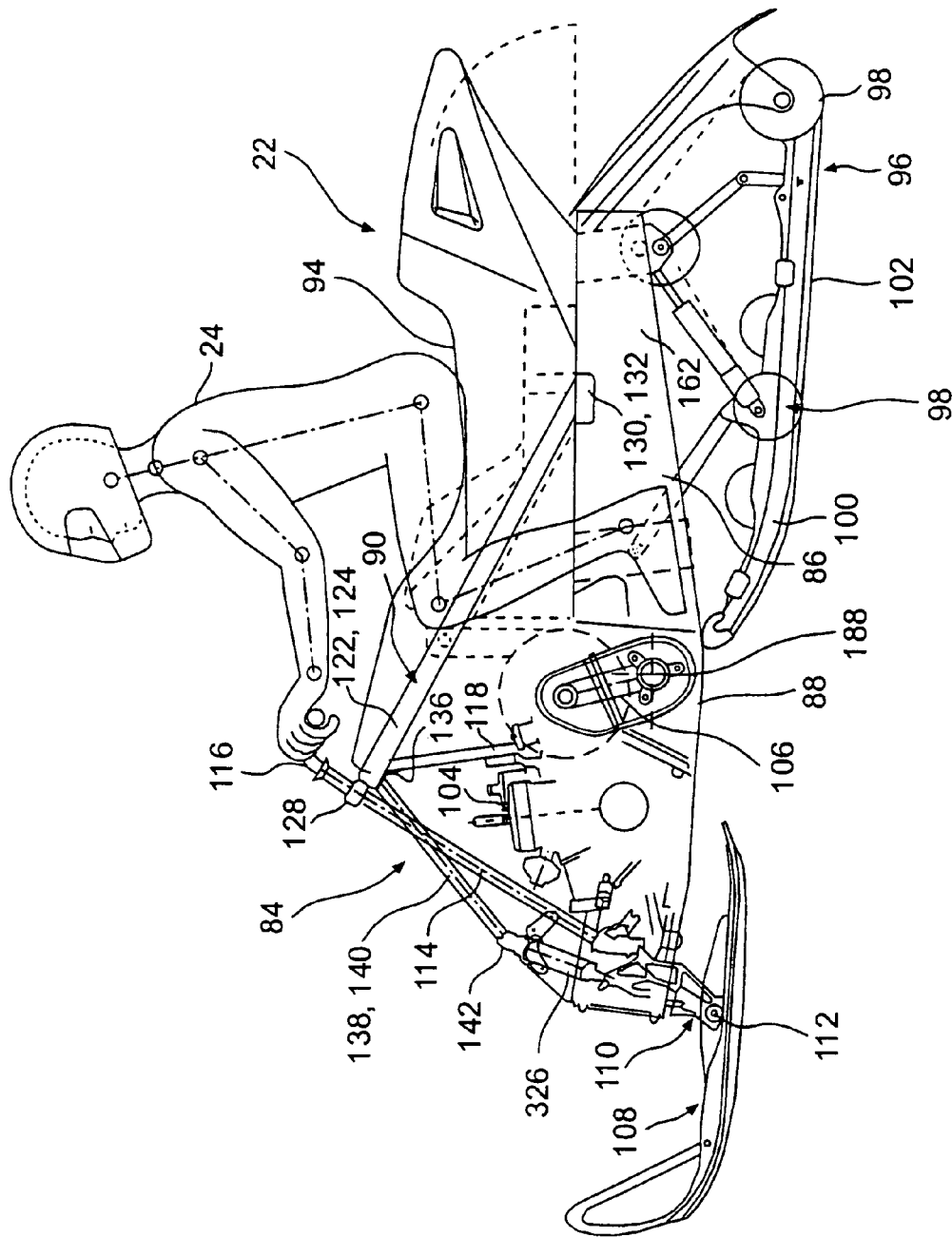

FIG. 5

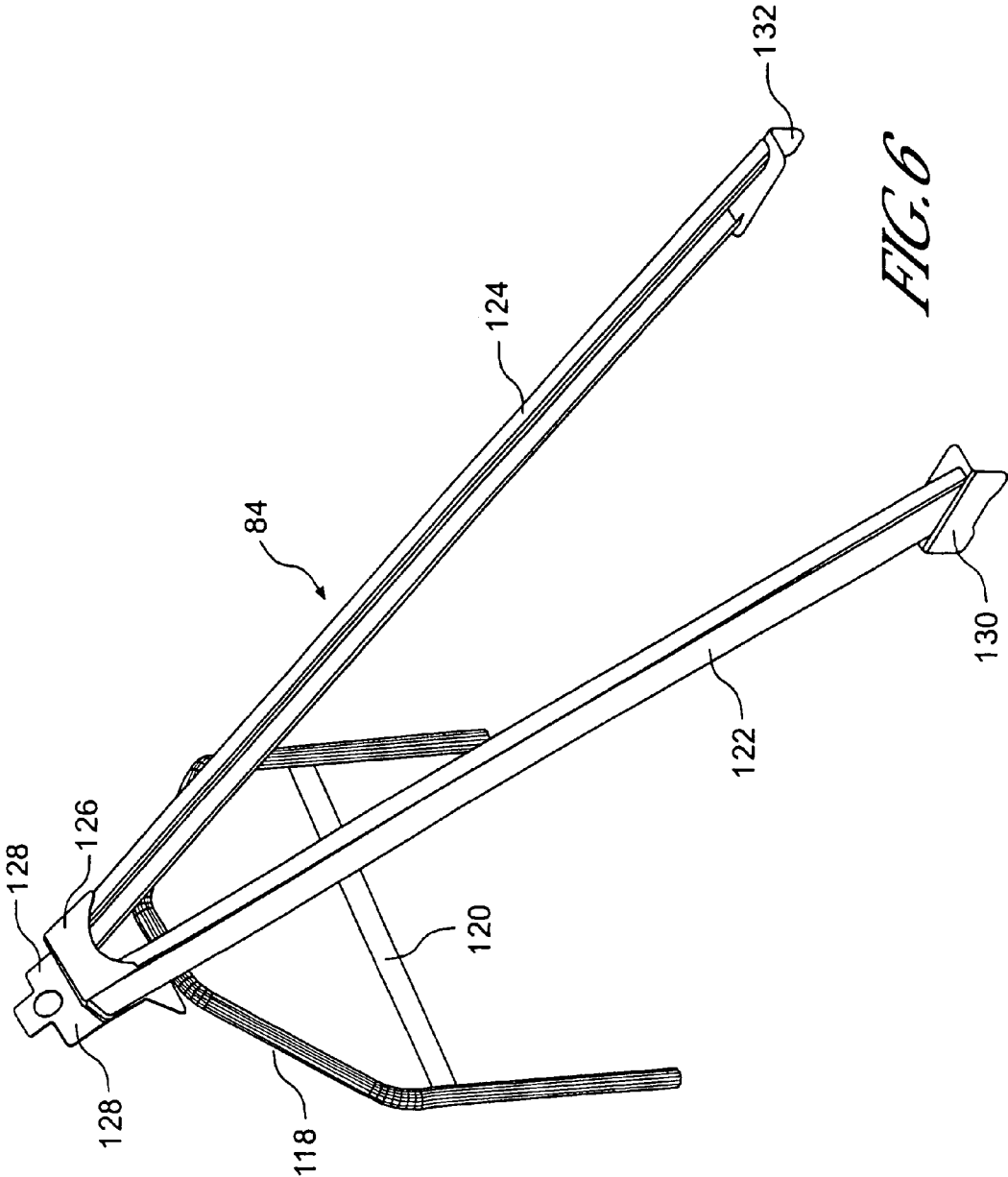

FIG. 6

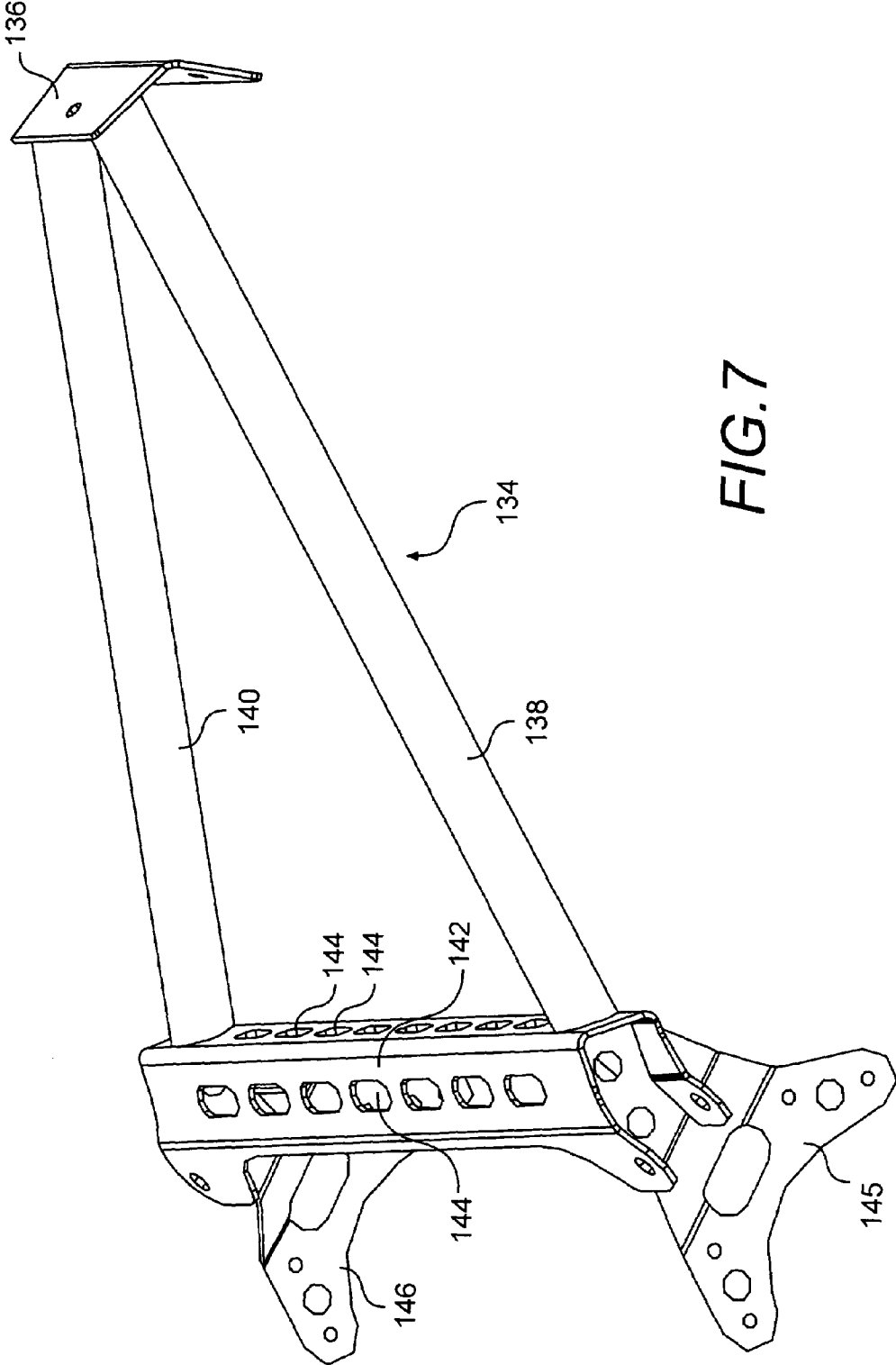
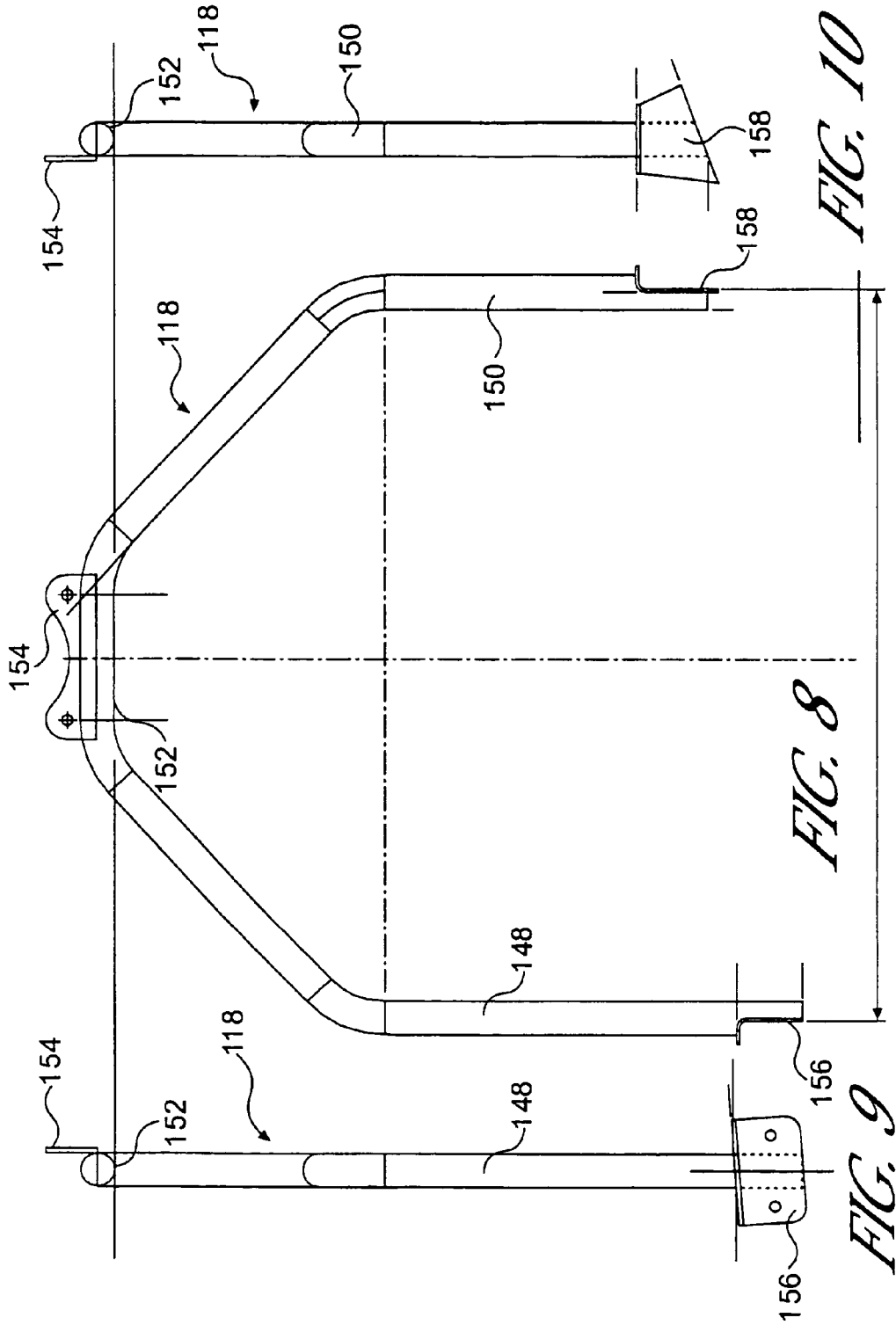

FIG. 7



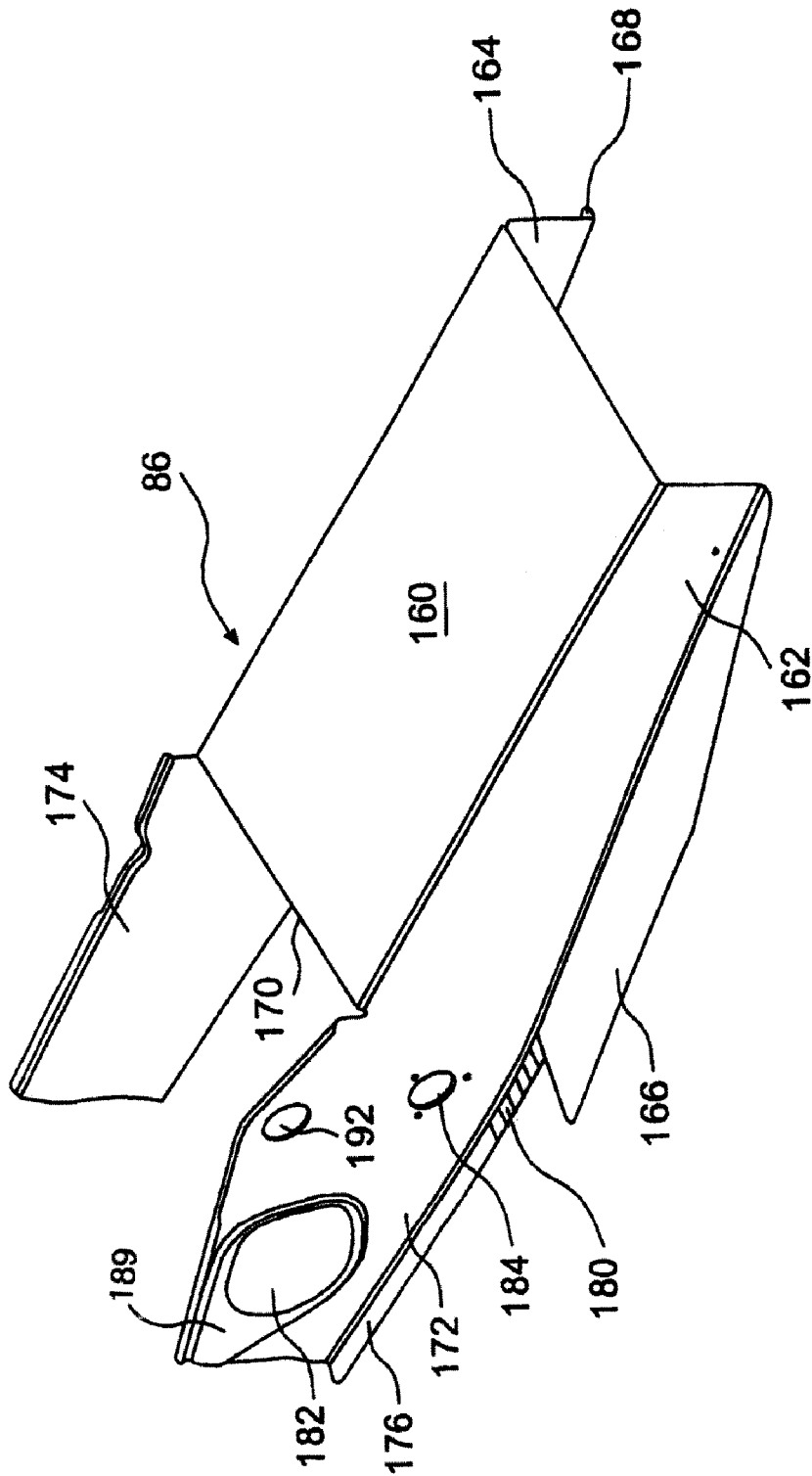
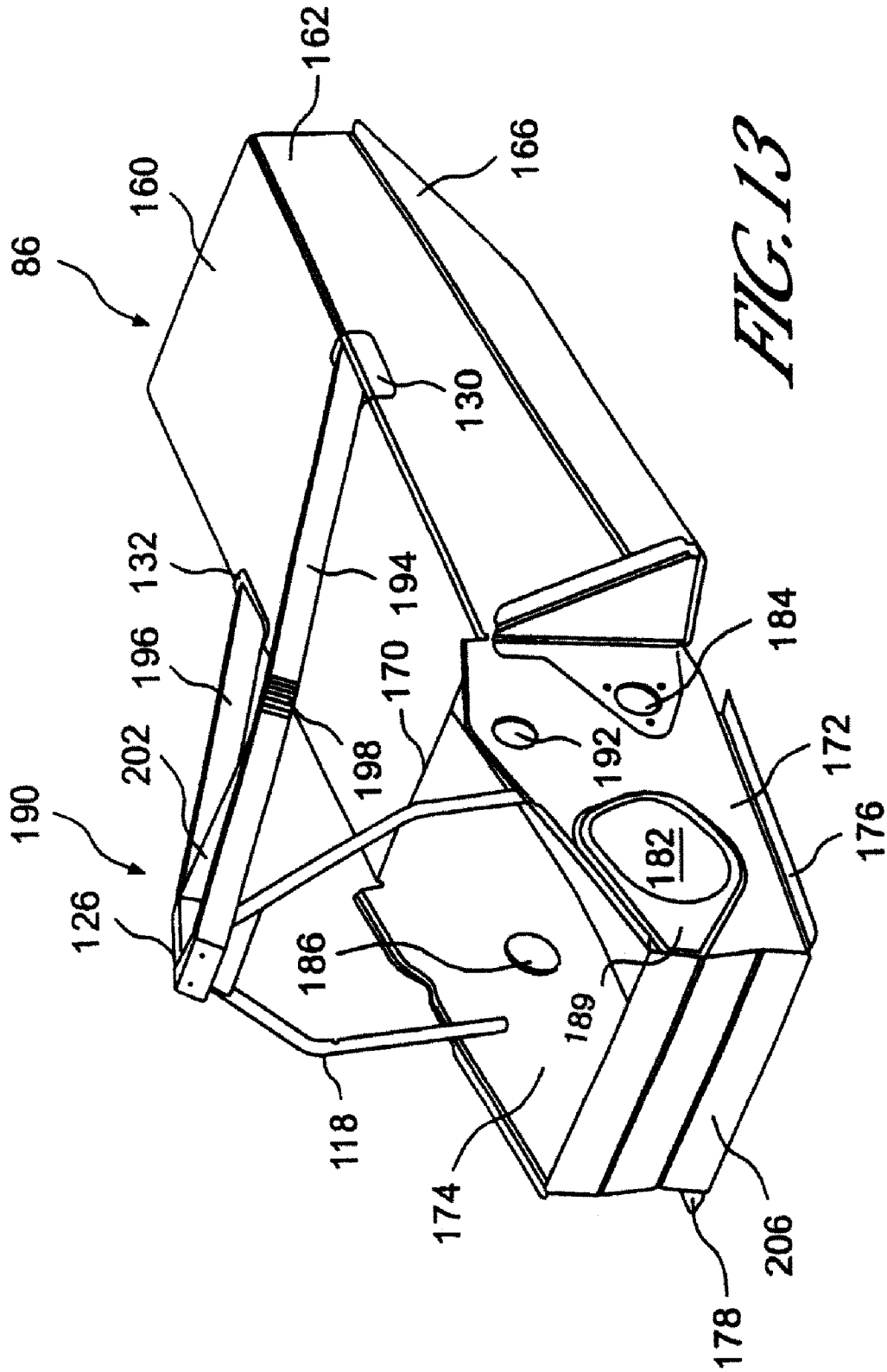

FIG. 12



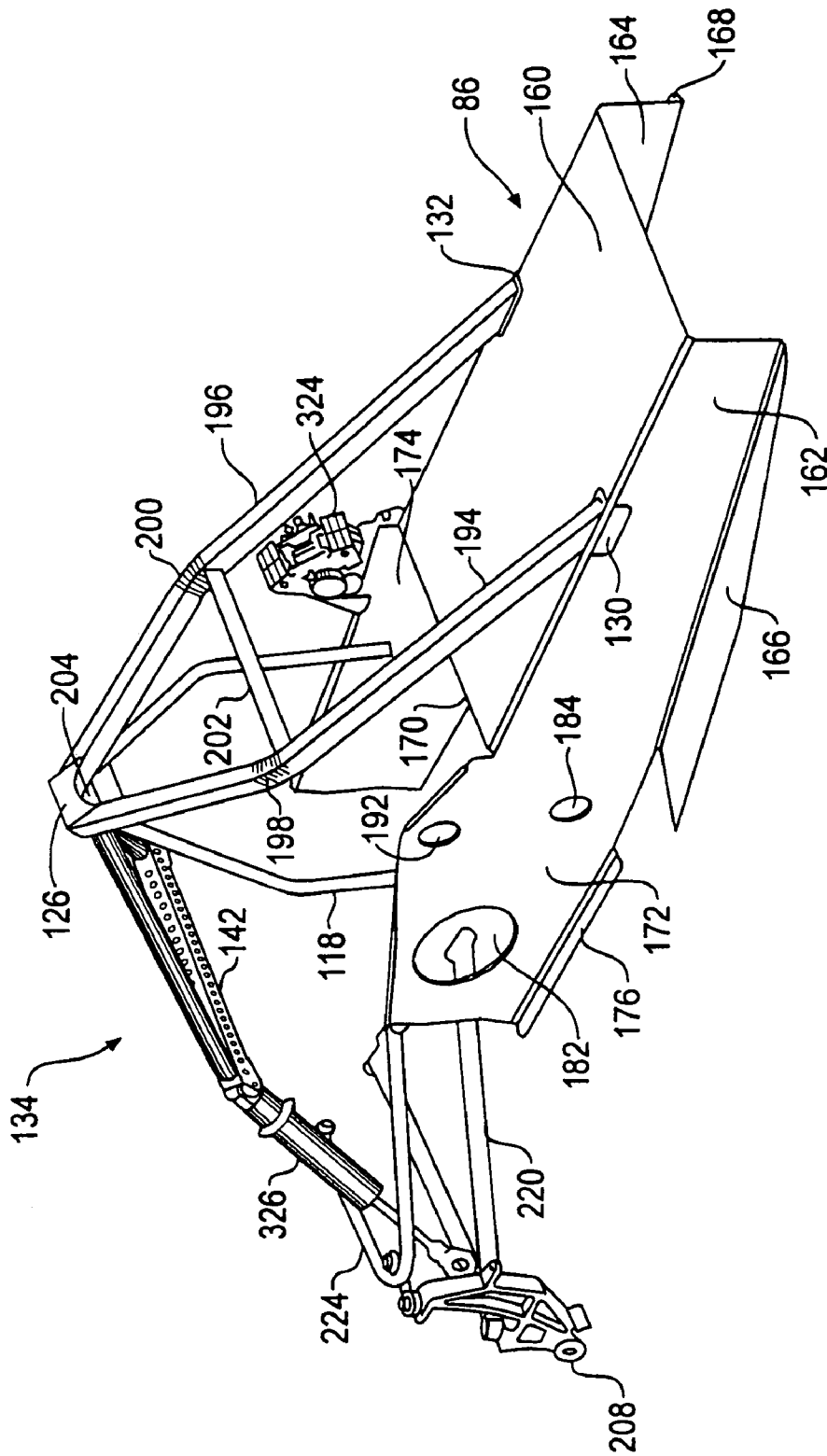

FIG. 14

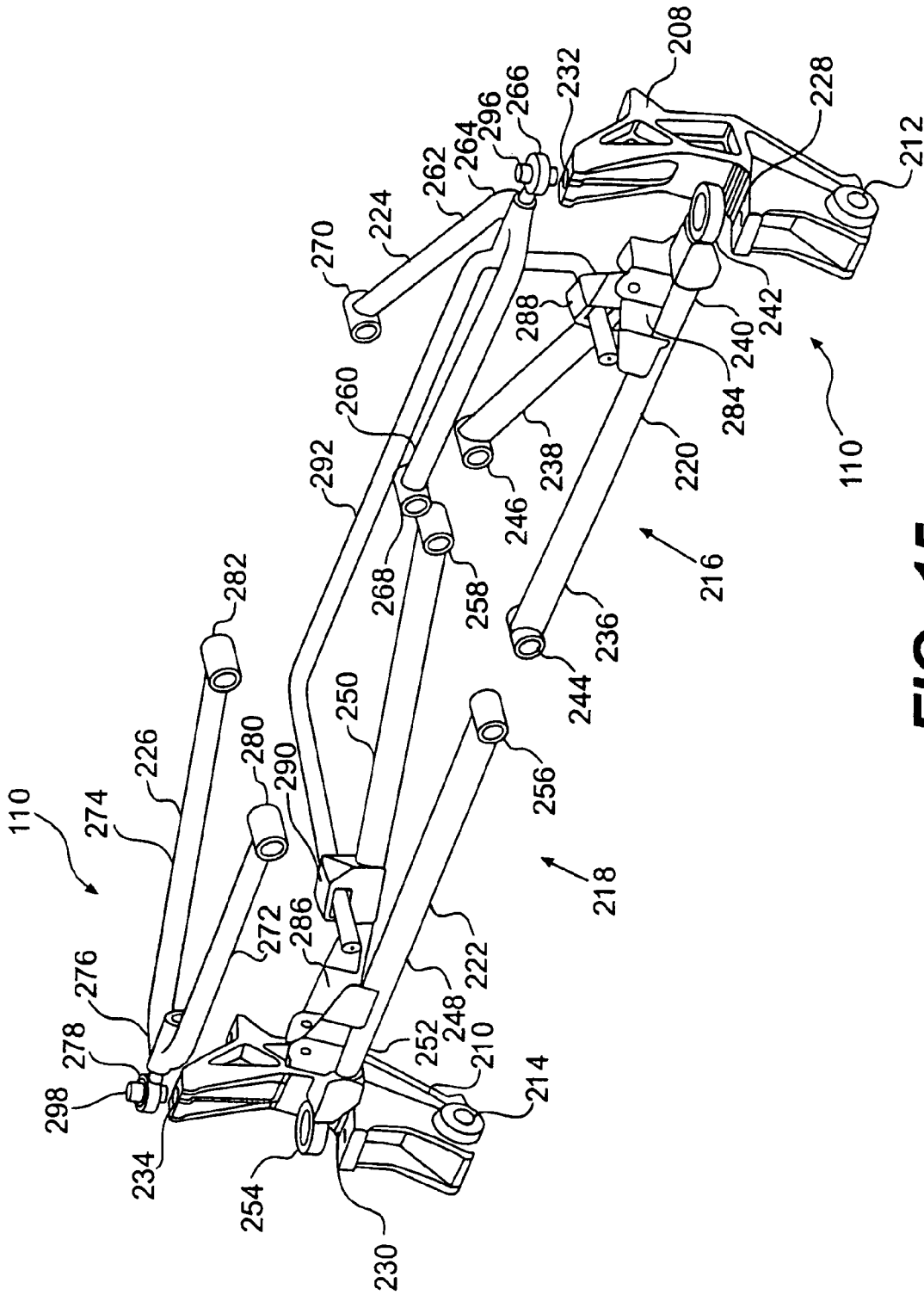

FIG. 15

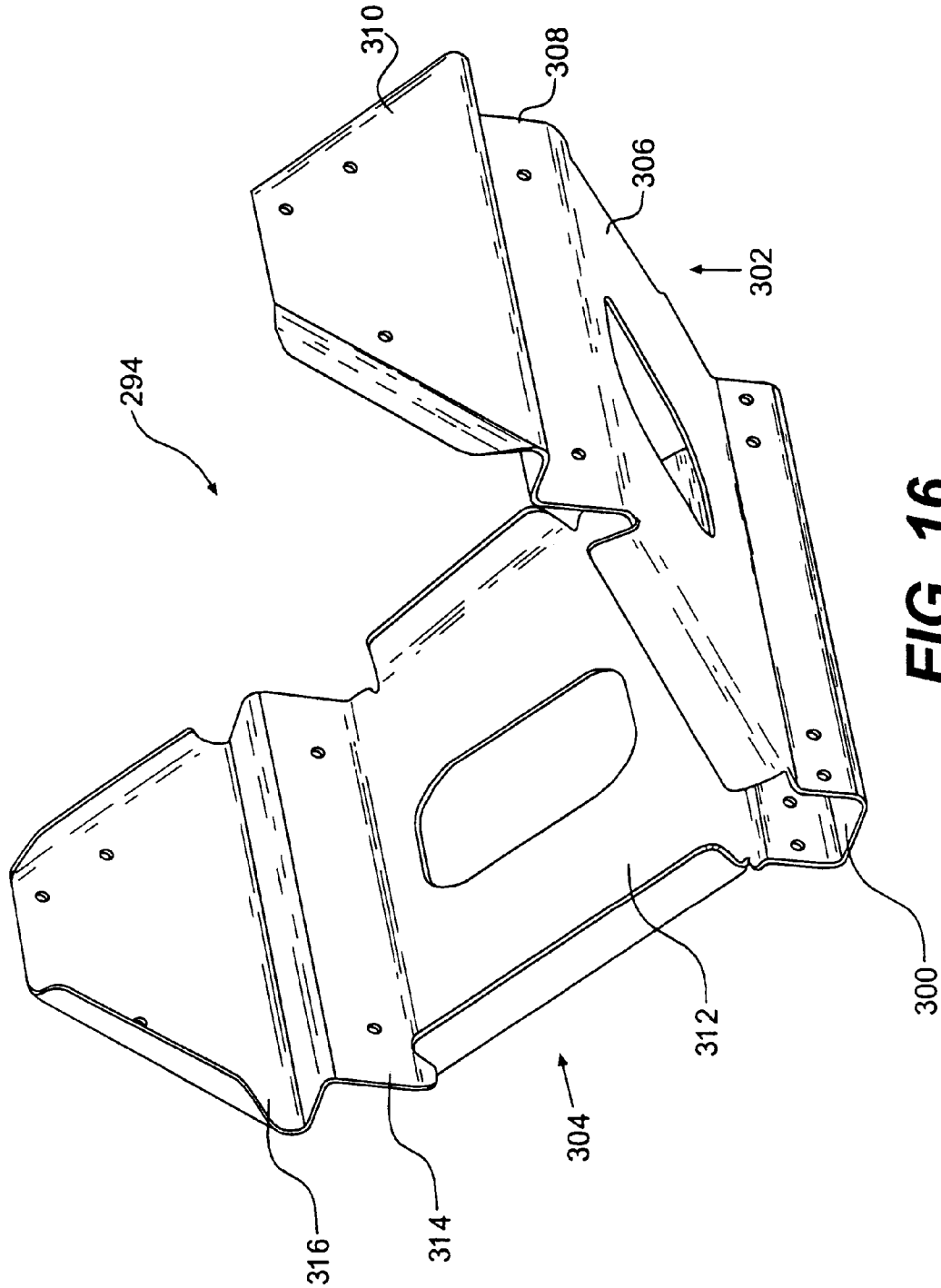

FIG. 16

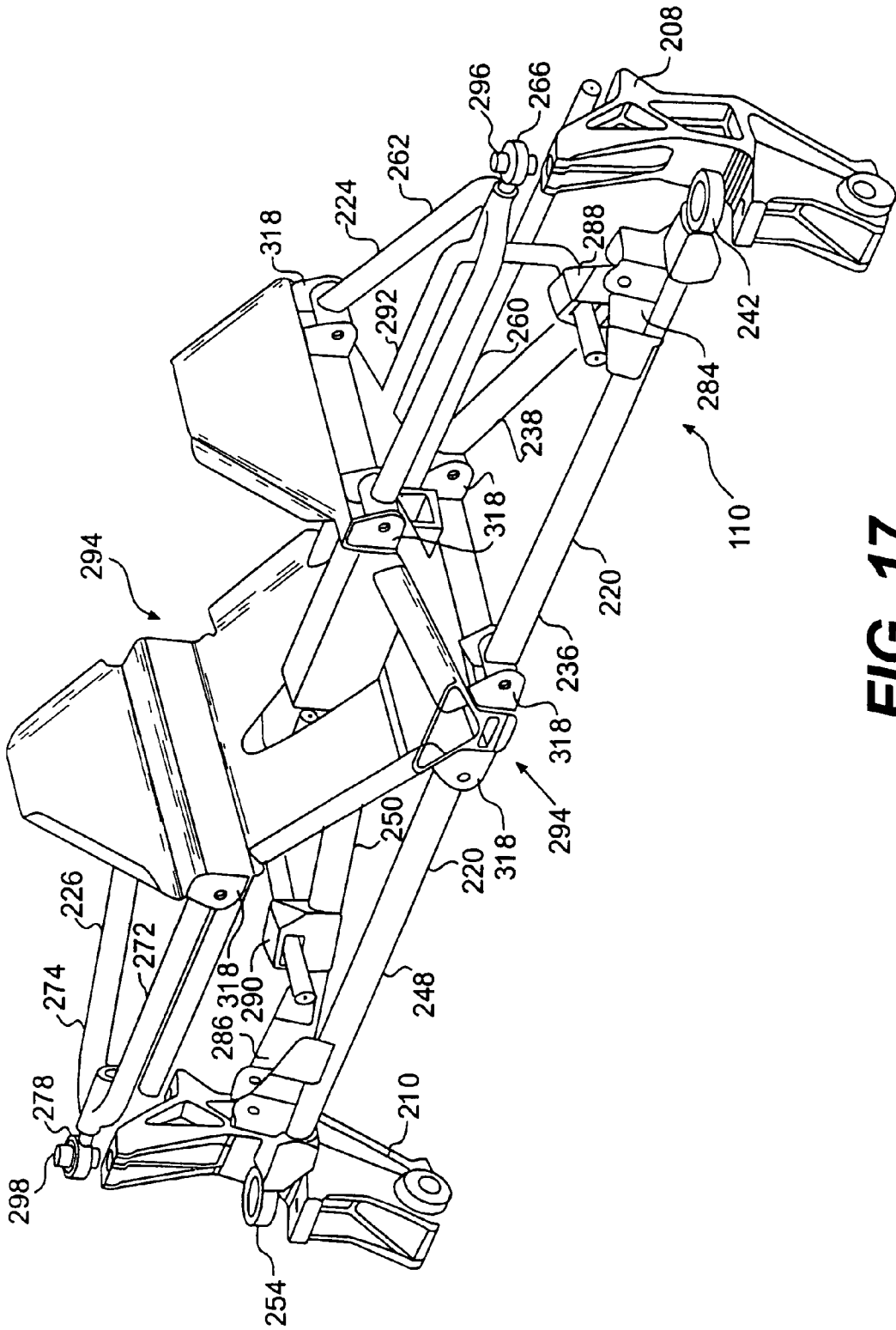

FIG. 17

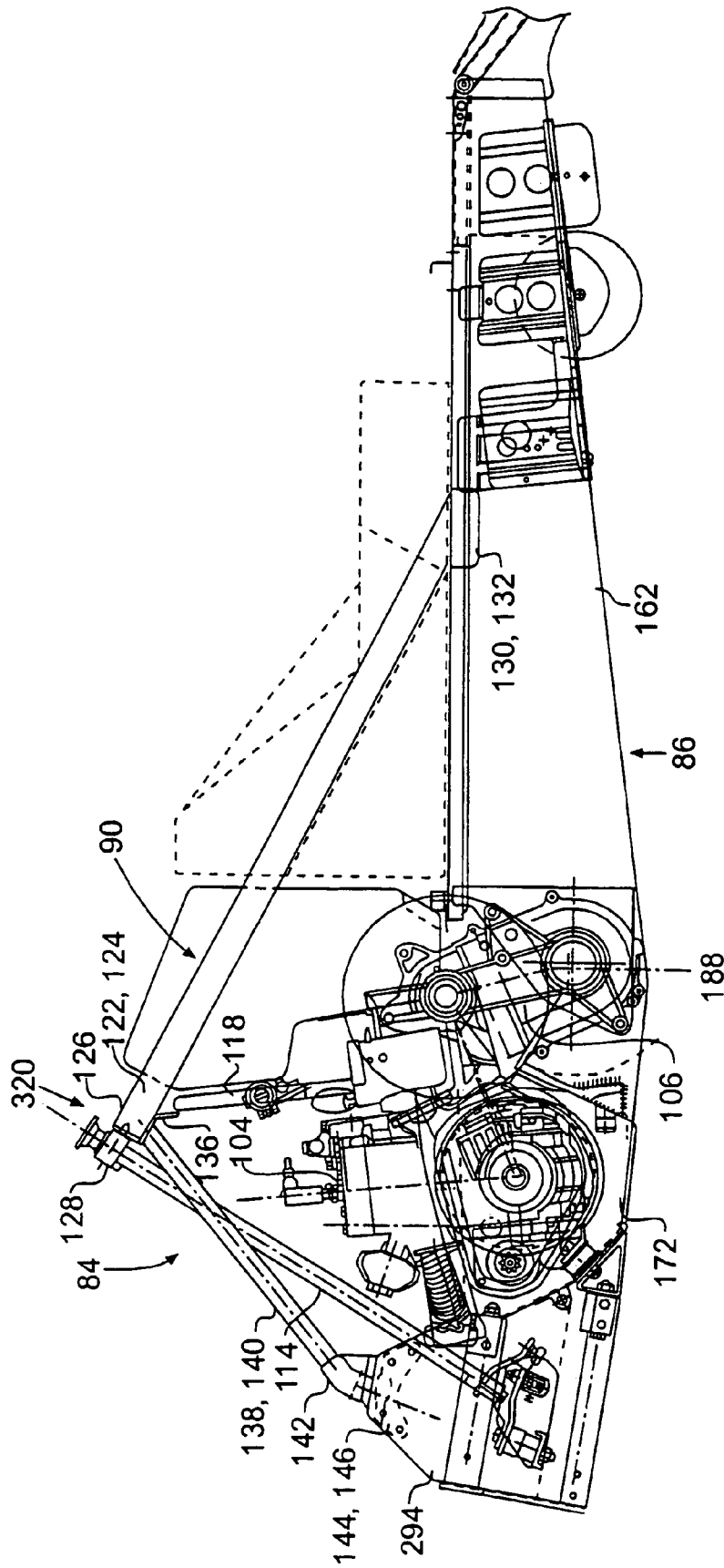

FIG. 18

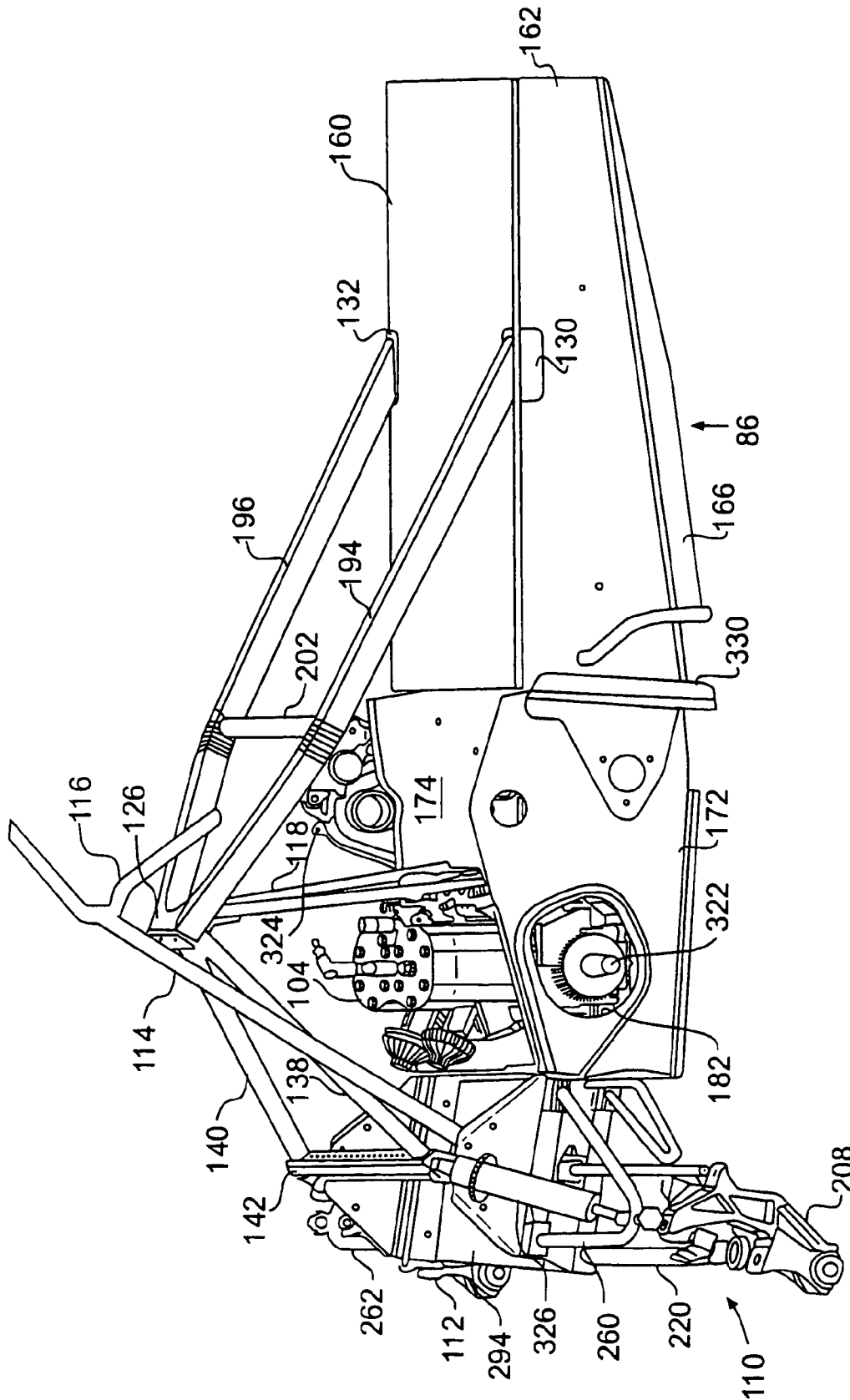

FIG. 19

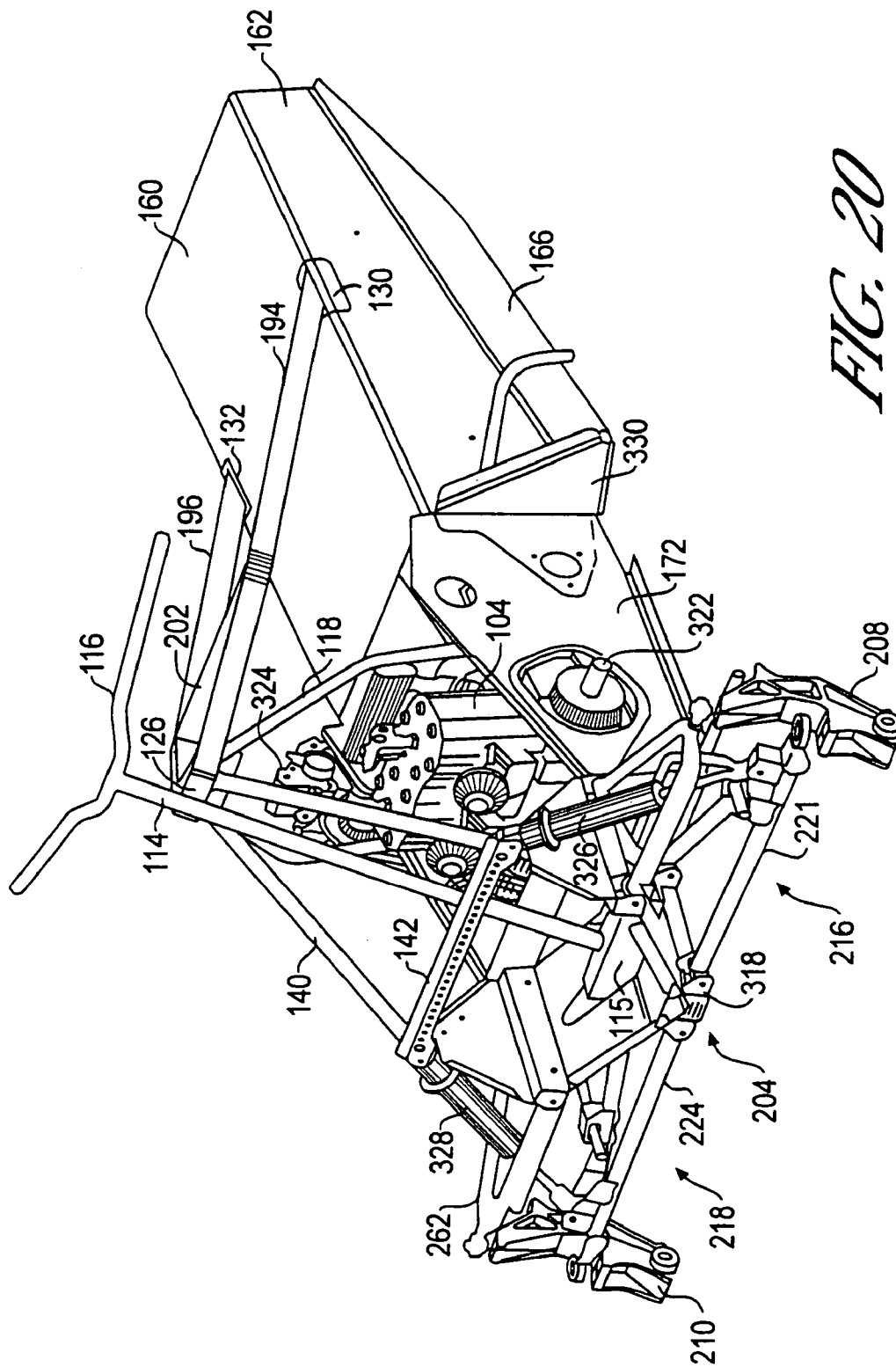

FIG. 20

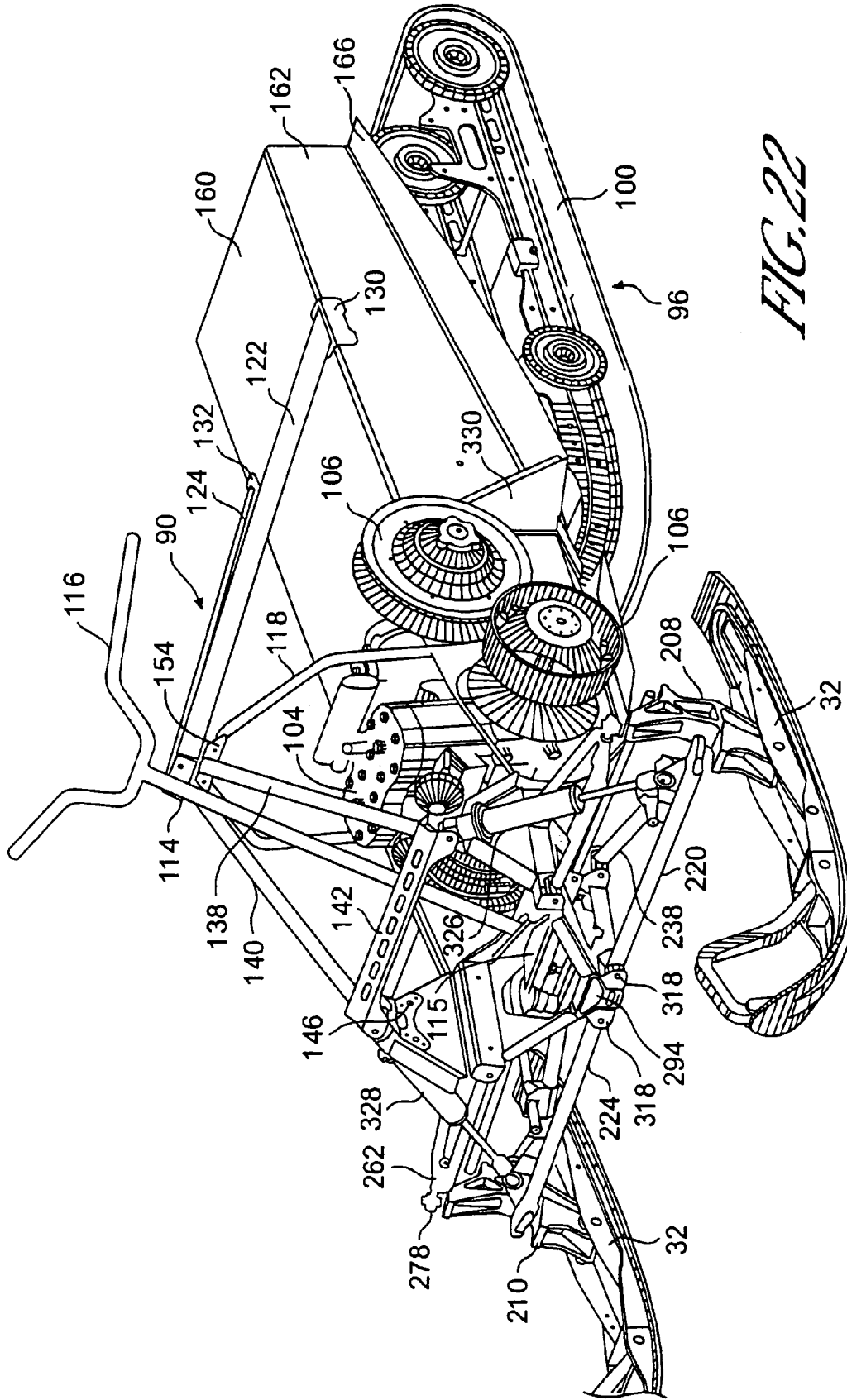

FIG. 22

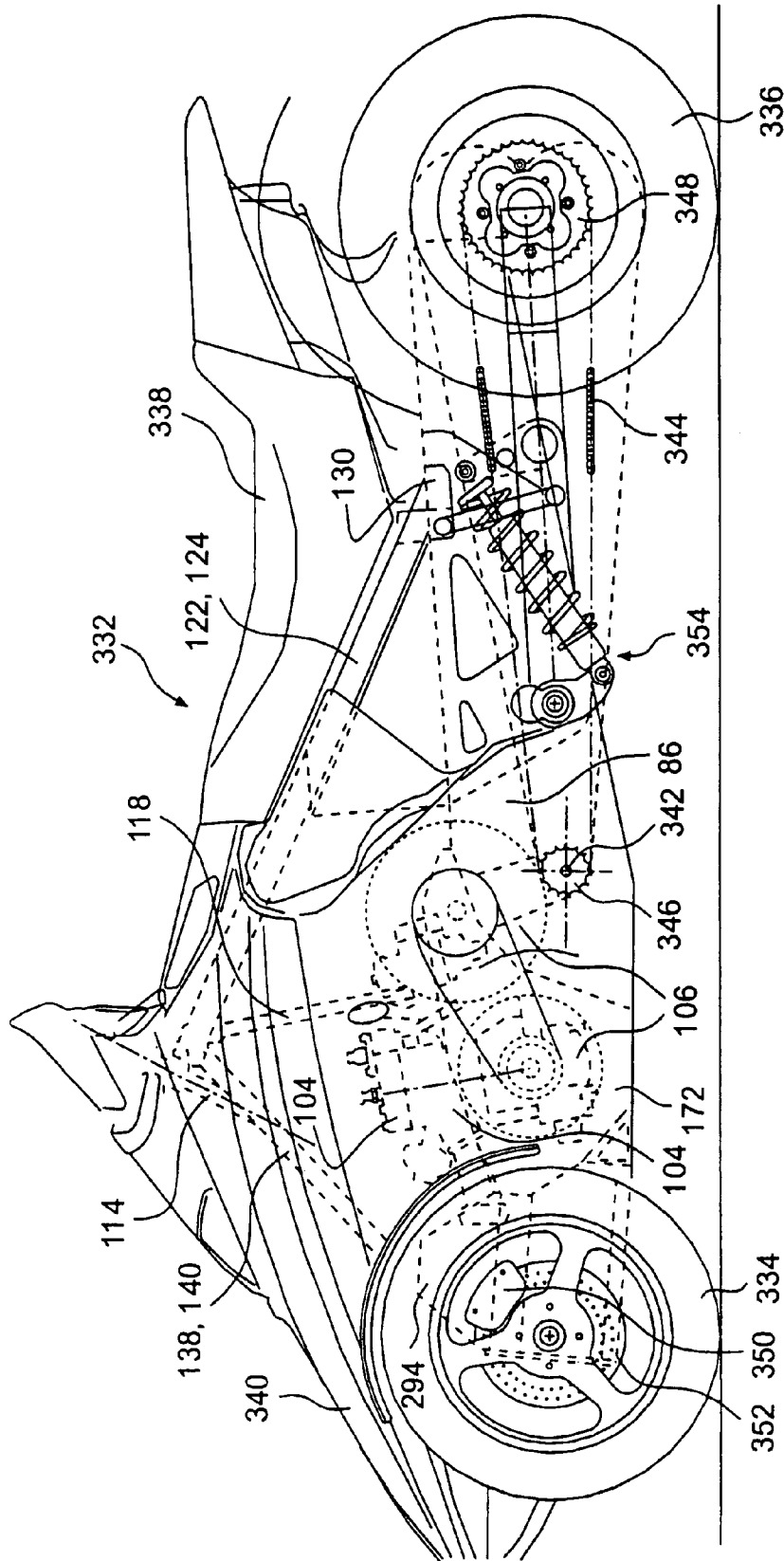

FIG. 23

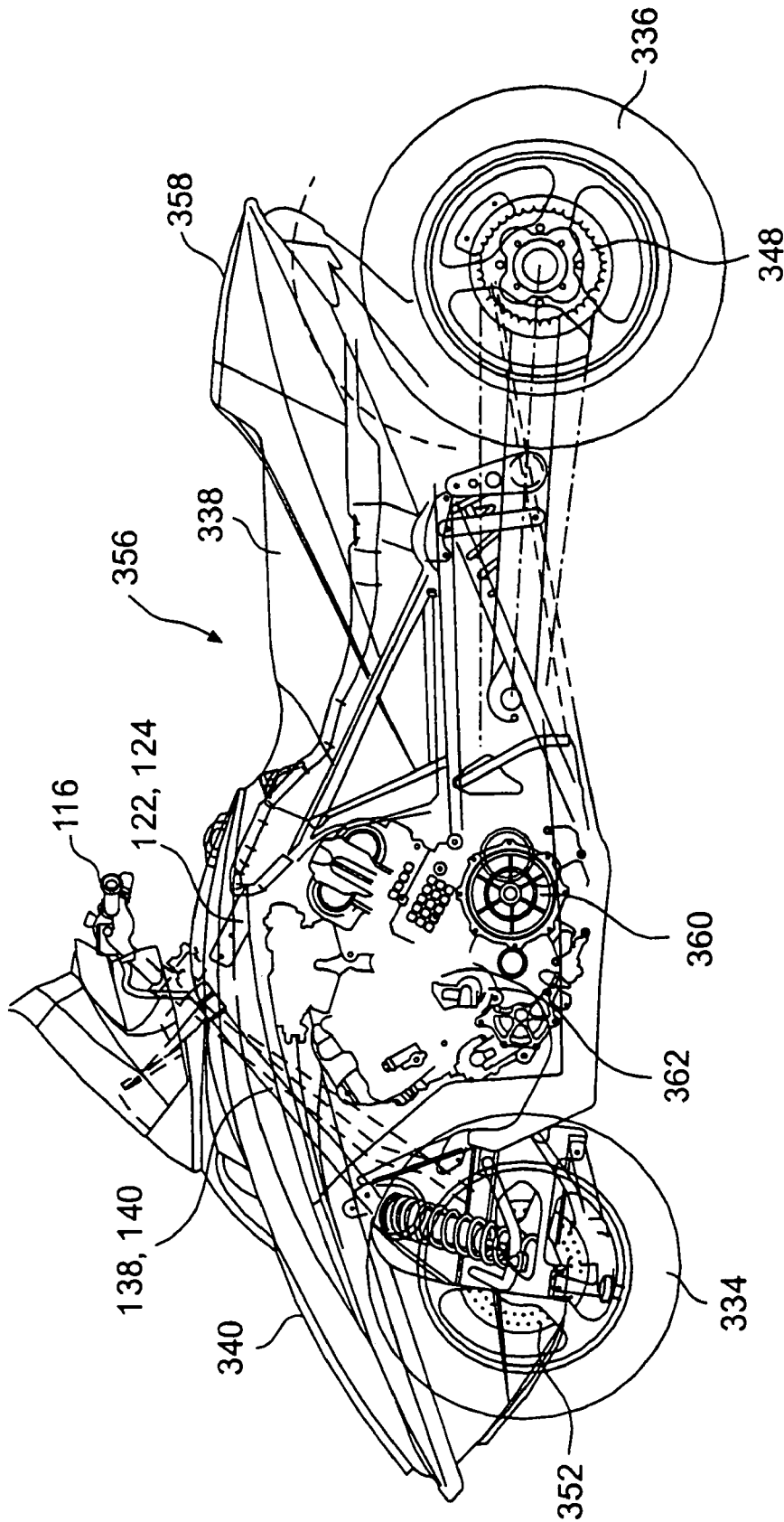

FIG. 24

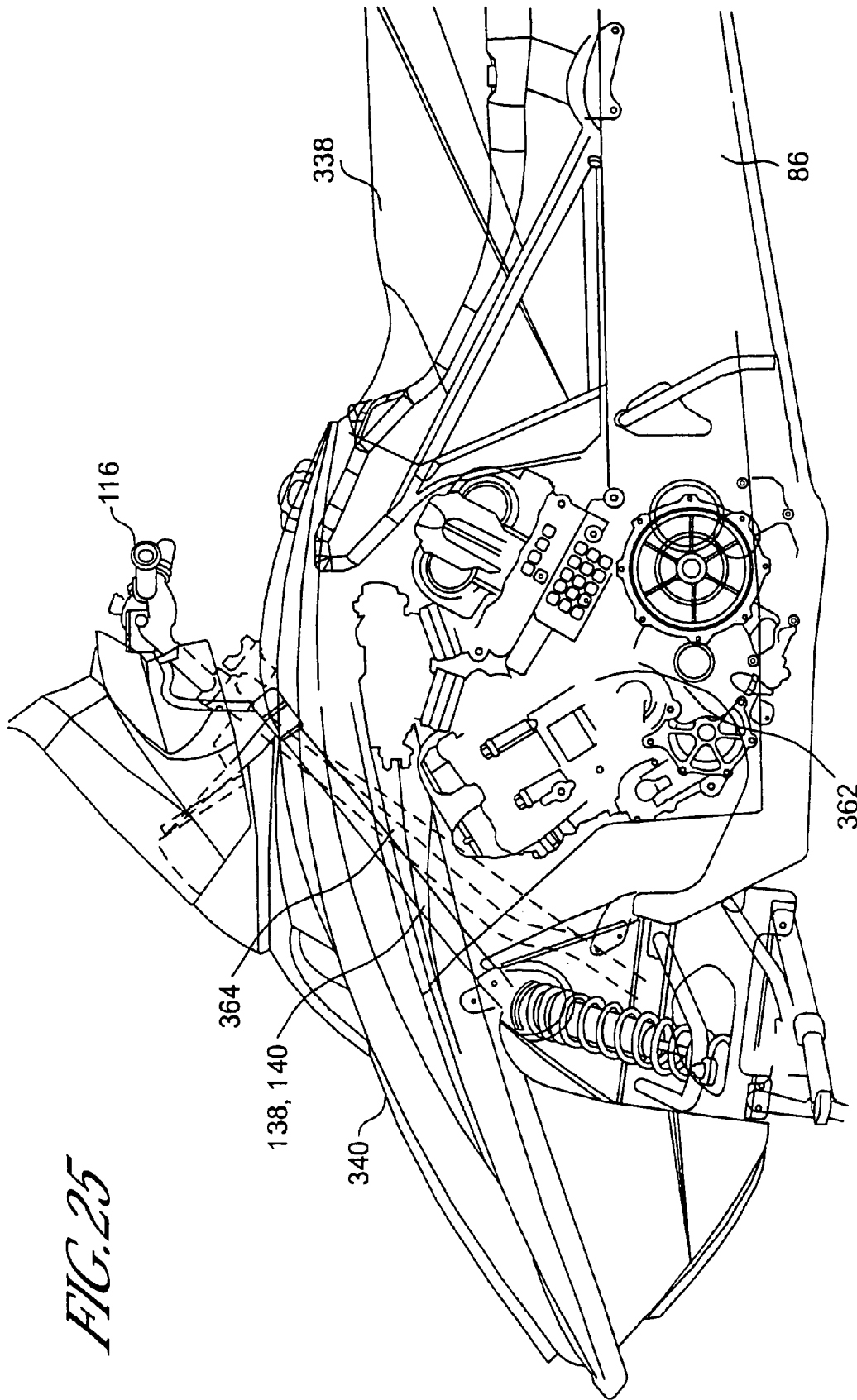

FIG. 25

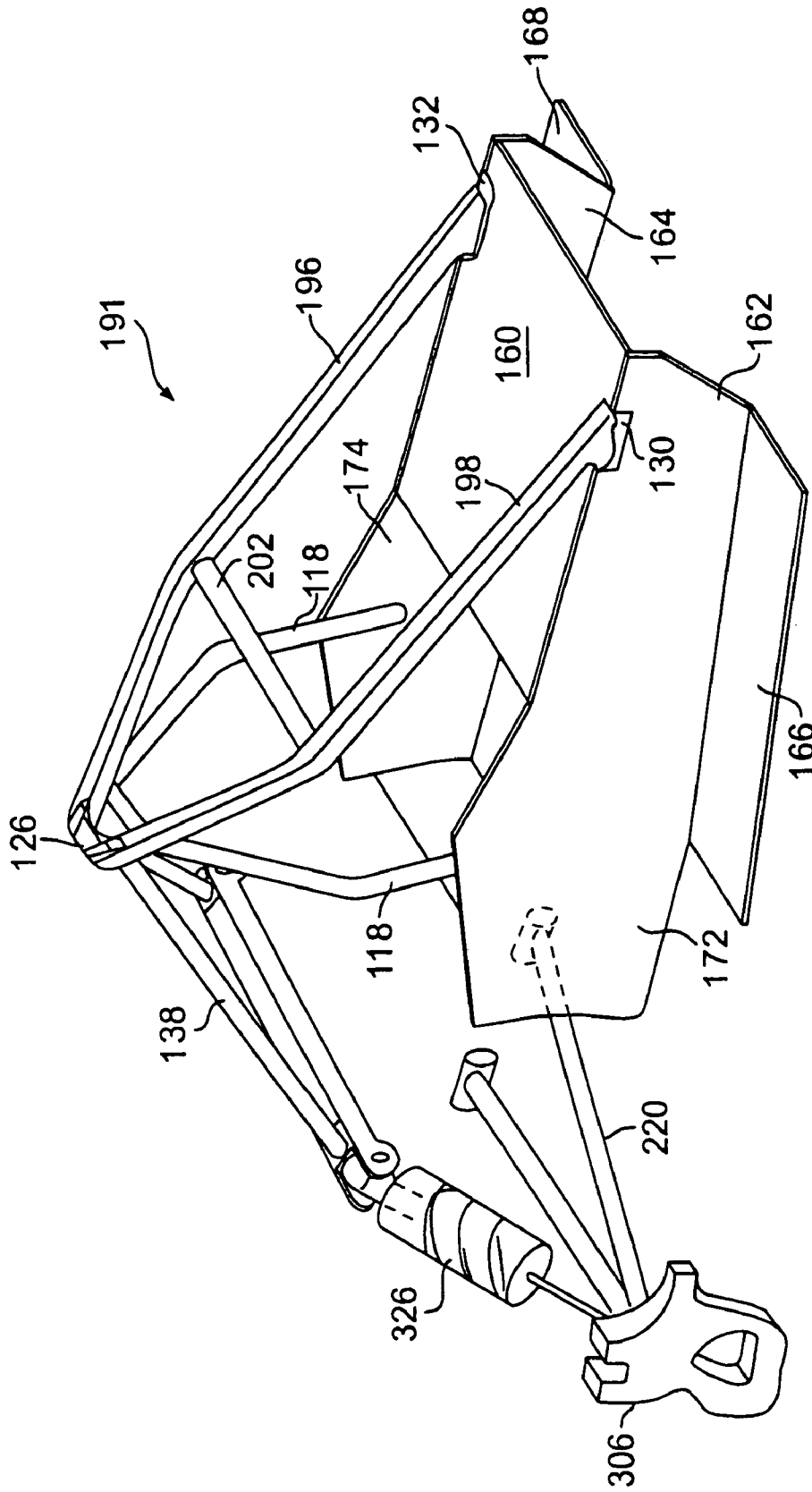

FIG. 26

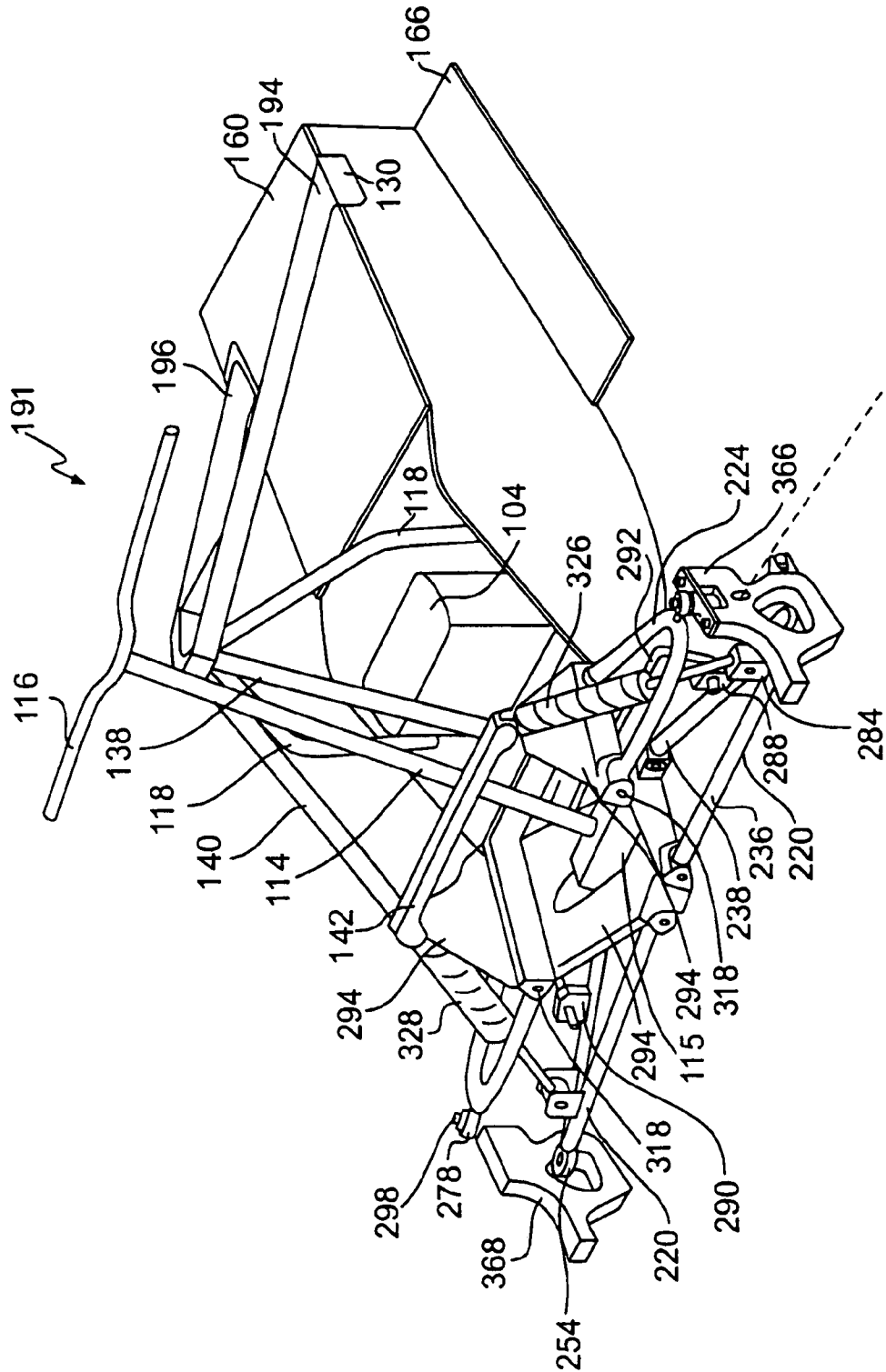

FIG. 27

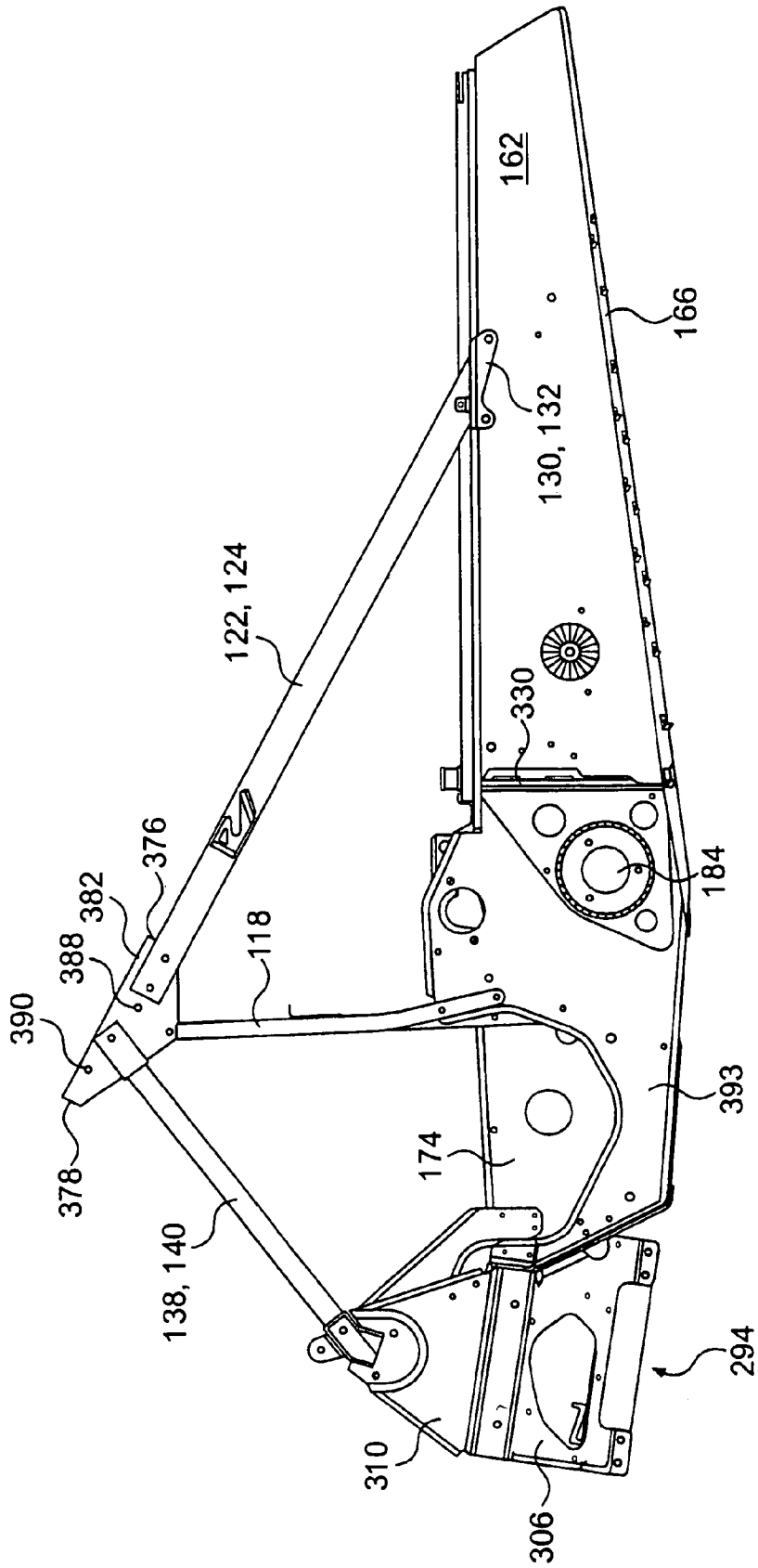

FIG. 29

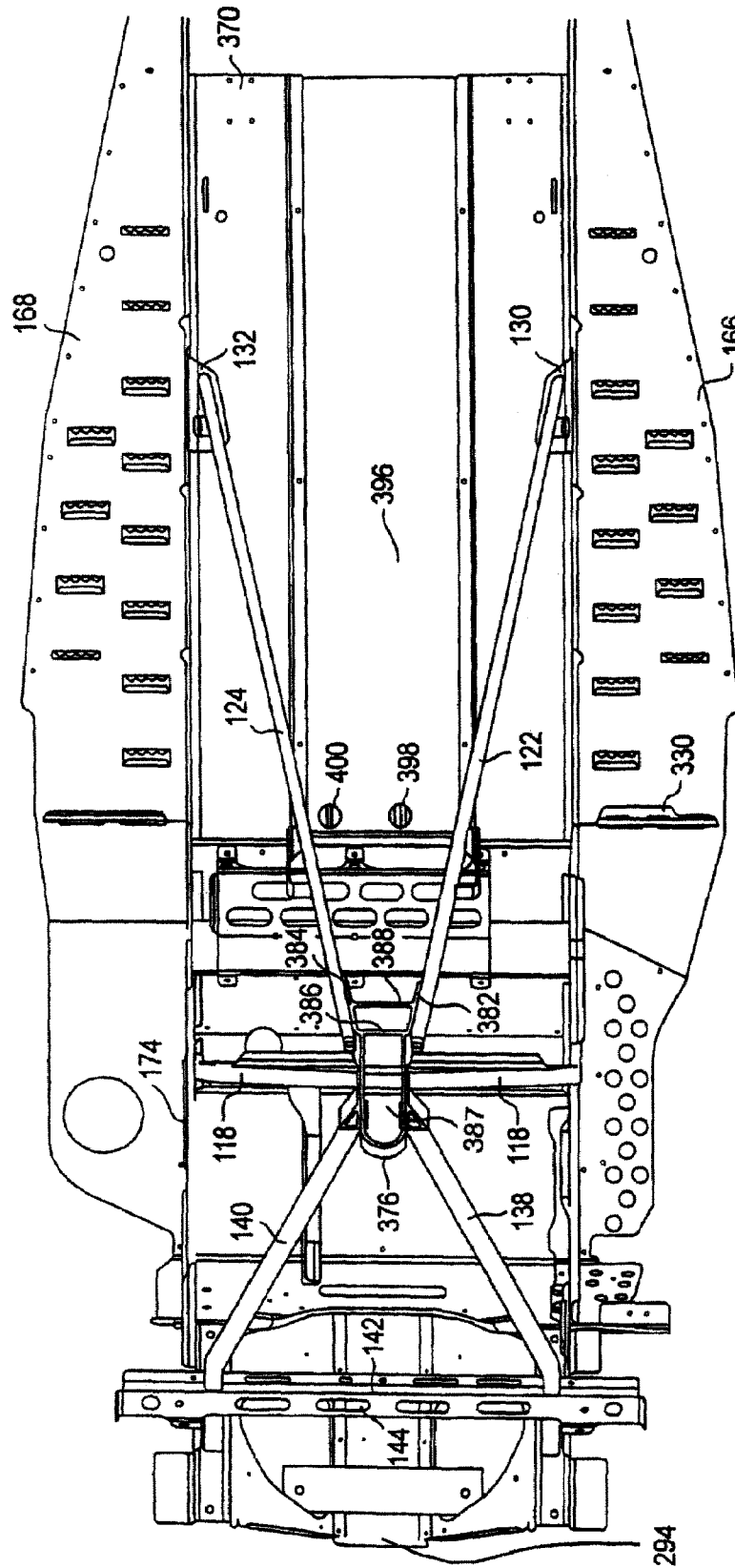

FIG. 30

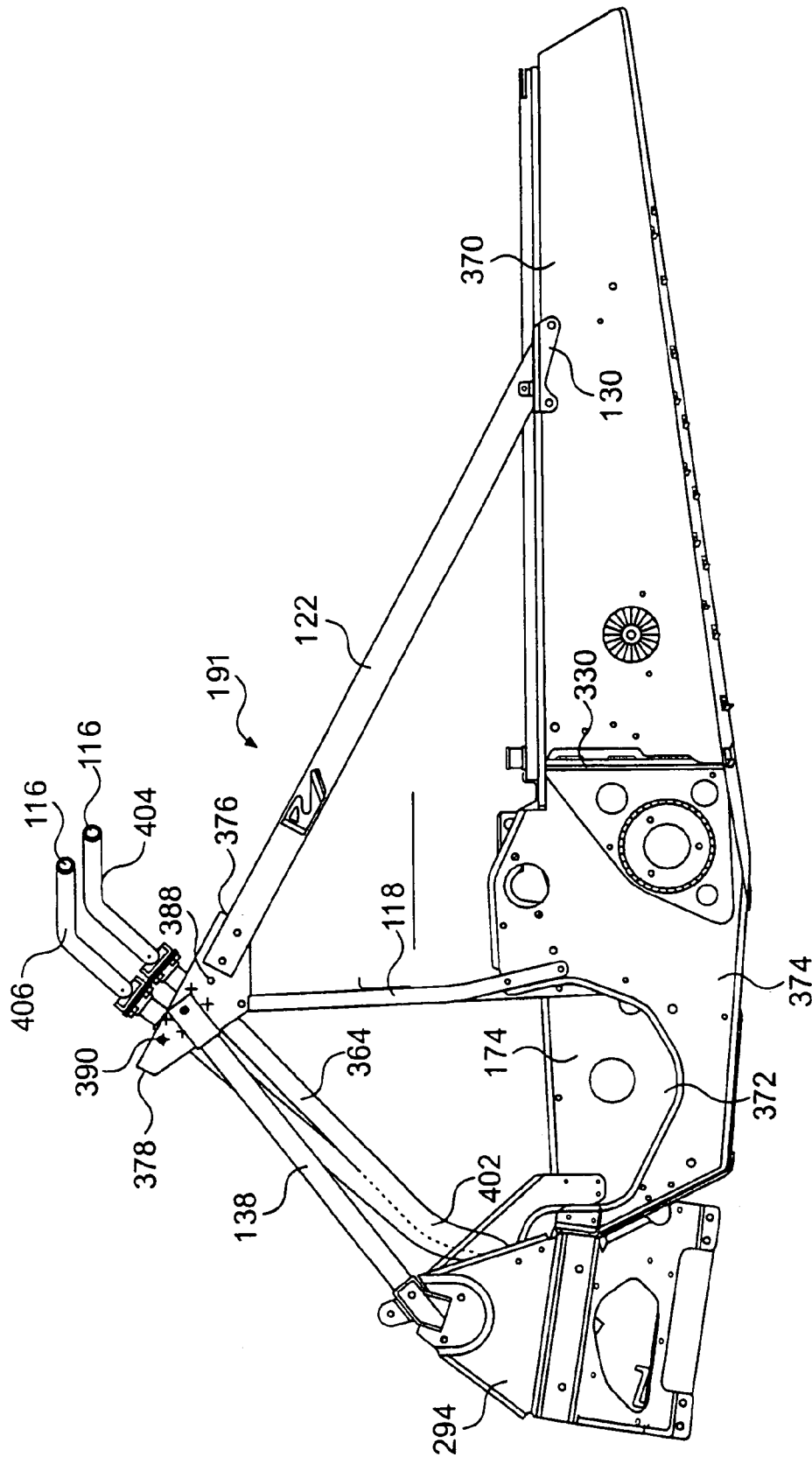
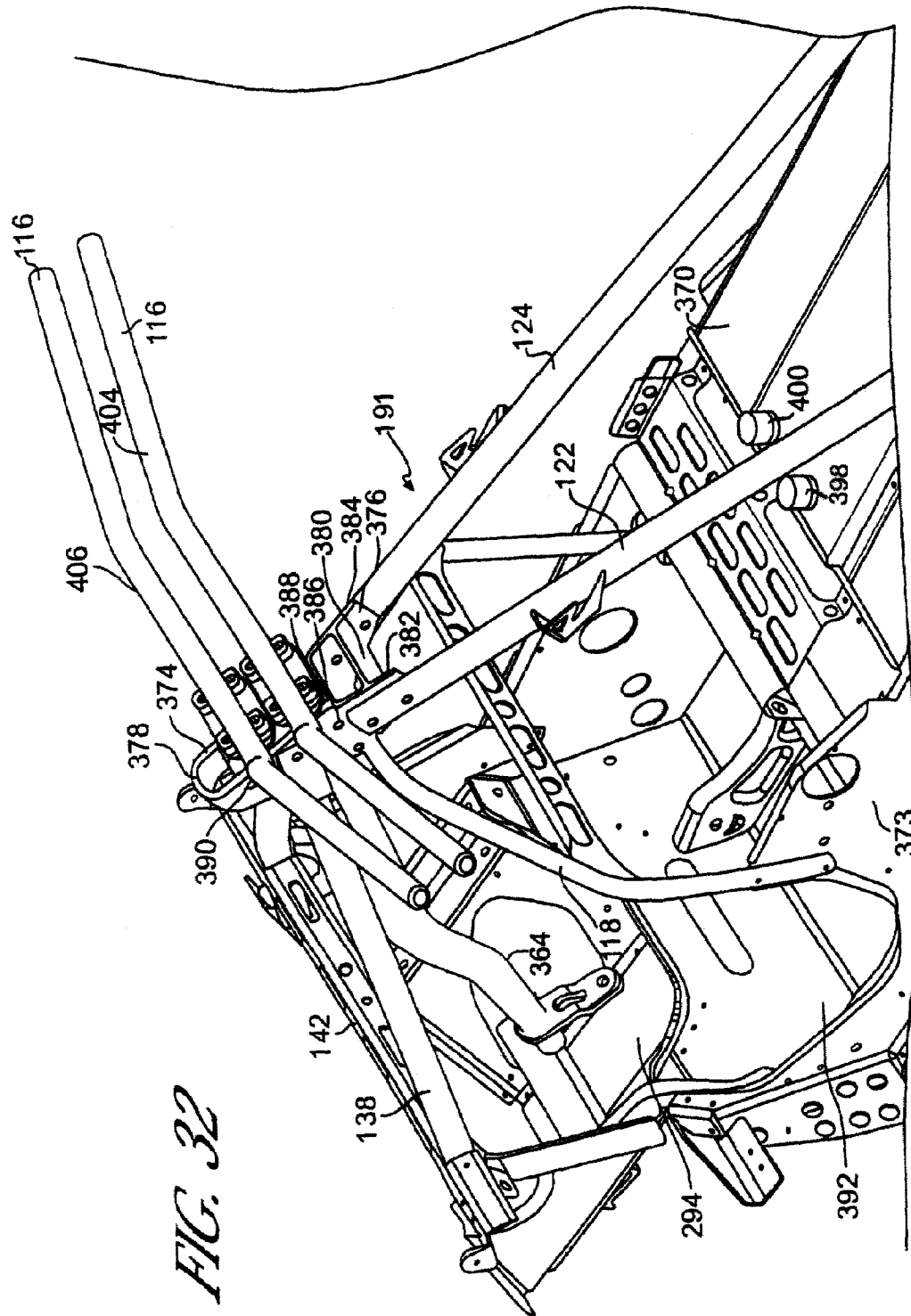
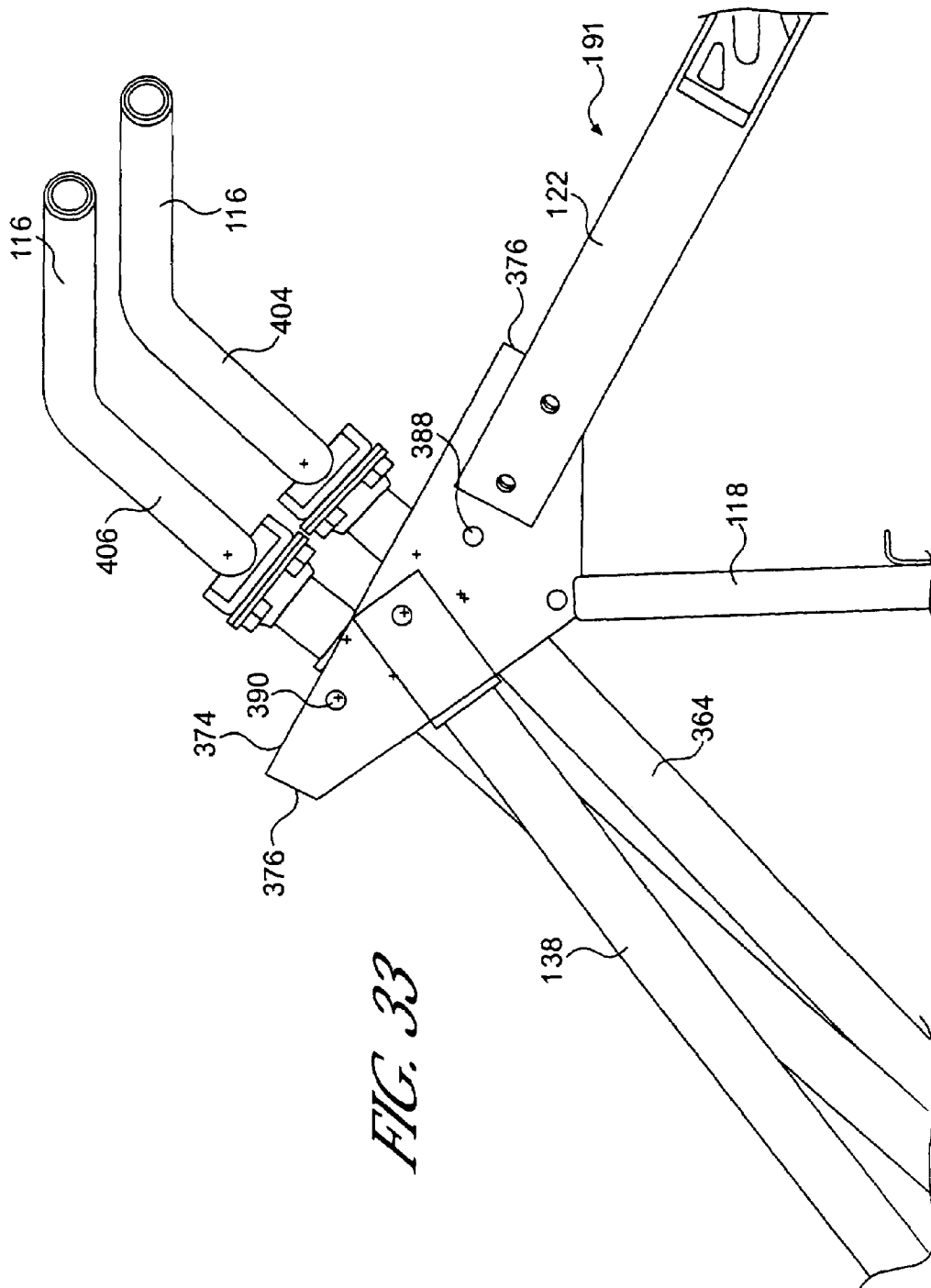

FIG. 31





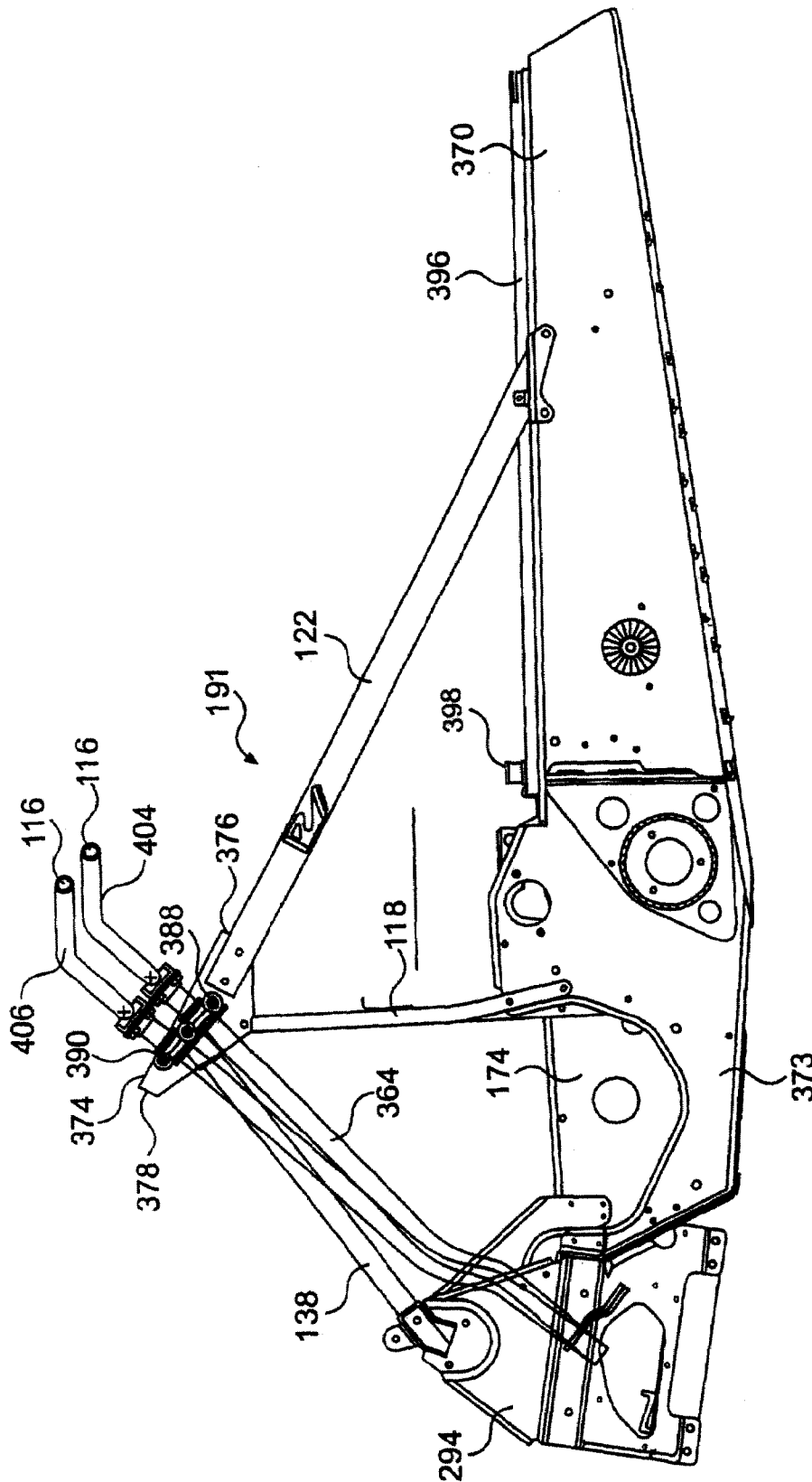

FIG. 34

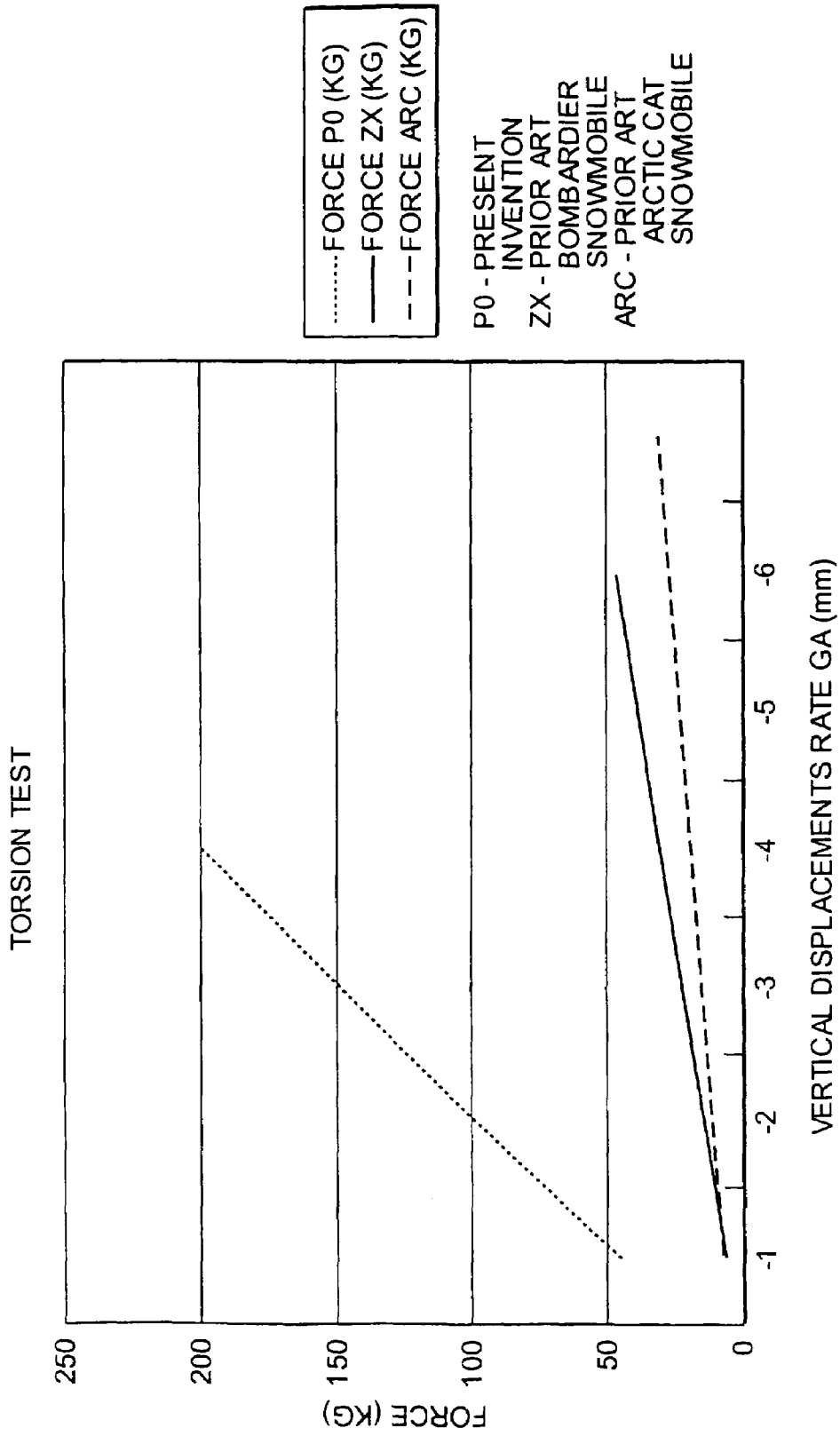

FIG. 35

FRAME CONSTRUCTION FOR A VEHICLE

This application is a continuation application of U.S. application Ser. No. 09/877,212, filed on Jun. 11, 2001, which is incorporated herein by reference. Through Ser. No. 09/877,212, this application claims priority to U.S. application Ser. No. 60/237,384, filed Oct. 4, 2000, and is a continuation-in-part of U.S. application Ser. No. 09/472,133, entitled "IMPROVED VEHICLE" filed on Dec. 23, 1999, now abandoned, the entire contents of both applications are incorporated herein by reference. Through U.S. application Ser. No. 09/472,133, this application claims priority to Canadian Patent Application No. 2,256,944, filed Dec. 23, 1998, the entire contents of which are incorporated herein by reference. The present application also incorporates by reference U.S. application Ser. No. 09/472,134, entitled "SNOWMOBILE," filed Dec. 23, 1999, and U.S. patent application Ser. No. 60/230,432, entitled "A NOVEL THREE-WHEELED VEHICLE," filed Sep. 6, 2000.

FIELD OF THE INVENTION

The present invention relates to the construction of vehicles such as snowmobiles, all terrain vehicles ("ATVs"), and other similar vehicles. More specifically, the present invention concerns the construction of a frame and related structural elements that enhance the ruggedness and ability of such vehicles to operate across a wide variety of different terrains and under a wide variety of conditions. In addition, the present invention concerns the design and construction of a frame for snowmobiles, ATVs, and related vehicles that facilitate the construction of such vehicles with an improved rider positioning.

DESCRIPTION OF RELATED ART AND GENERAL BACKGROUND

Snowmobiles, ATVs, and related vehicles (hereinafter, "recreational vehicles," although the appellation should not be construed to be limited only to the vehicles or type of vehicles described herein) often function under similar operating conditions. Despite this, snowmobiles, ATVs, and other recreational vehicles often do not share a common design approach or a commonality of components. This is due, in large part, to the different stresses and strains (mainly at the extremes) that the different vehicles experience during routine operation.

Specifically, snowmobiles are designed with frame assemblies and suspensions that easily absorb the shock of obstacles encountered on groomed trails and in deep snow. They are also designed to handle the forces generated when the snowmobile is driven aggressively (e.g., under racing conditions). In addition, their frame assemblies are designed to provide optimum steering and performance in snow, whether on groomed snowmobile trails (packed snow) or in ungroomed, off-trail areas (powder or natural snow).

ATVs, on the other hand, are designed with suspensions and frame assemblies that are expected to absorb the type of momentarily intense forces associated with more rugged terrain, specifically of the type encountered in forests and woodland environments. In addition, an ATV frame is designed to withstand forces associated with significant torsional stresses that are typical when an ATV straddles large objects or when the wheels are disposed at different elevations because of the extreme terrain in which the ATV often operates.

It should be kept in mind that the design parameters of the frame assemblies for these two vehicles are also different. In a snowmobile, the frame at the rear of the vehicle is only about 15 inches wide. This is sufficient to cover the endless track that propels the vehicle and to provide a seating area for the driver. The narrow width, however, imposes certain design restrictions on the vehicle. ATVs, on the other hand, are designed with a significantly wider base, which is typically 50 inches or more. This width also imposes certain design restrictions on the ATV.

Snowmobiles and ATVs are also designed with different centers of gravity. In the typical snowmobile, the center of gravity is very low. This assists the snowmobile rider when he or she is on a slope or in a turn because the snowmobile will naturally resist the tendency to lean or tip. ATVs, on the other hand, like off-road trucks and the like, are expected to traverse taller objects. Accordingly, their frames are designed so that the engine and seating area is further from the ground than a snowmobile. Thus, ATVs have higher centers of gravity.

Naturally, since both vehicles are designed with off-road use in mind, there are similarities between the two. Both are provided with rugged frames. Moreover, both are provided with strong suspensions. Despite this, there have been few vehicles designed that capitalize on these similarities.

Recognizing this basic similarity between the two vehicles, some after-market designers have developed kits that permit snowmobiles to be converted to ATVs and vice-versa. However, such kits are limited in their effectiveness because the two vehicles are so completely different from one another in their basic designs. The resulting, converted vehicles suffer from drawbacks that are associated with the purpose for which the primary vehicle was designed. For example, a snowmobile converted to an ATV is not expected to be able to traverse the same type of terrain as a pure ATV. Similarly, an ATV that has been converted to a snowmobile is not expected to be able to traverse the same terrain that a pure snowmobile can.

Partly due to the consumer's use of snowmobiles in the winter and ATVs in the summer, the evolution of both snowmobiles and ATVs has converged in recent years. Also, in recent years, designers have begun to apply the same basic design concepts to both vehicle types. What has resulted is a recognition that vehicles may be designed that incorporate many of the same structural elements and follow very similar design approaches.

The basis for the present invention stems from this basic recognition.

SUMMARY OF THE INVENTION

It is, therefore, an object of the present invention to provide a frame assembly with a tunnel, an engine cradle disposed forward of the tunnel and connected thereto, and a sub-frame disposed forward of the engine cradle and connected thereto. The frame assembly further includes a forward support assembly extending upwardly from the sub-frame, an upper column extending upwardly from the engine cradle to connect with the forward support assembly, and a rear brace assembly extending upwardly from the tunnel to connect with the forward support assembly and the upper column.

It is another object of the present invention to provide a frame assembly wherein the forward support assembly, the upper column, and the rear brace assembly connect at an apex above the upper column.

3

Another object of the present invention is to provide a frame assembly where the forward support assembly and the rear brace assembly form a pyramidal construction.

A further object of the present invention is to provide a frame assembly further including a steering bracket connected at the apex for supporting a steering shaft at its upper end. In an alternate embodiment, the steering bracket may include a plurality of pairs of holes for positioning of the steering shaft in a plurality of positions.

One other object of the present invention is to provide a frame assembly that also includes an engine disposed in the engine cradle and an endless track operatively connected to the engine and disposed beneath the tunnel for propulsion. In this embodiment, a pair of skis are operatively connected to a steering device for steering.

Still another object of the present invention is to provide a frame assembly with an engine disposed in the engine cradle and a rear wheel operatively connected to the engine and disposed beneath the tunnel for propulsion. In this embodiment, two front wheels operatively connected to a steering device for steering.

It is yet another object of the present invention to provide a frame assembly for a vehicle that includes a tunnel and an engine cradle adapted to receive an engine therein. A rear brace assembly is attached to the tunnel at a point between its front and rear ends and extends upwardly therefrom. A forward support assembly is attached to the rear brace assembly and extends forwardly and downwardly therefrom. In a further variation of this frame assembly, the rear brace assembly comprises a left and a right leg and the forward support assembly comprises a left and a right leg. The left and right legs of the rear brace assembly and the forward support assembly connect to one another at an apex to form a pyramidal structure above the tunnel and engine cradle.

Still other objects of the present invention will be made apparent by the discussion that follows.

BRIEF DESCRIPTION OF THE DRAWINGS

The invention will be more fully described in conjunction with the following drawings wherein:

FIG. 1 is a side-view schematic illustration of a prior art snowmobile, showing the prior art positioning of a rider thereon;

FIG. 2 is a side view illustration of the exterior of a snowmobile constructed according to the teachings of the present invention, also showing the positioning of a rider thereon;

FIG. 3 is an overlay comparison between the a prior art snowmobile (of the type depicted in FIG. 1) and a snowmobile constructed according to the teachings of the present invention (as shown in FIG. 2), illustrating the difference in passenger positioning, among other features;

FIG. 4 is an exploded view of a frame assembly representative of the type of construction typical of a snowmobile assembled according to the teachings of the prior art (specifically, the view illustrates the components of a 2000 model year Ski-Doo® Mach™ Z made by Bombardier Inc. of Montréal, Québec, Canada);

FIG. 5 is a side view schematic illustration of the snowmobile illustrated in FIG. 2, with the fairings and external details removed to show some of the internal components of the snowmobile and their positional relationship to one another;

FIG. 6 is a perspective illustration of a portion of the frame assembly of the present invention, specifically the portion disposed toward the rear of the vehicle;

4

FIG. 7 is a perspective illustration of a forward support frame, which connects with the portion of the frame assembly depicted in FIG. 6;

FIG. 8 is a front view illustration of an upper column of the frame assembly shown in FIG. 6;

FIG. 9 is a left side view illustration of the upper column depicted in FIG. 8;

FIG. 10 is a right side view illustration of the upper column shown in FIG. 8;

FIG. 11 is a perspective illustration, from the front left side, of a tunnel portion of the frame assembly of the present invention;

FIG. 12 is another perspective illustration, from the rear left side, of the tunnel portion of the present invention shown in FIG. 11;

FIG. 13 is a perspective illustration, from the front left side, showing the combination of the frame assembly depicted in FIG. 6 connected to the tunnel portion depicted in FIGS. 11 and 12;

FIG. 14 is a perspective illustration, from the rear left side, showing the combination of the frame assembly depicted in FIG. 6 connected to the tunnel portion depicted in FIGS. 11 and 12 and also showing a portion of a front suspension assembly;

FIG. 15 is a perspective illustration, from the front left side, of some of the components that are part of the front suspension assembly depicted in FIG. 14;

FIG. 16 is a perspective illustration, from the front left side, of a portion of a sub-frame that is part of the front suspension assembly illustrated in FIG. 15;

FIG. 17 is another perspective illustration, from the front left side, of the front suspension assembly for a snowmobile, constructed according to the teachings of the present invention, showing the positional relationship between the parts illustrated in FIG. 15 and the sub-frame illustrated in FIG. 16;

FIG. 18 is a side view schematic of the frame assembly of the present invention showing the positional relationship between the frame assembly and the engine, among other components;

FIG. 19 is a perspective illustration, from the left side, of the frame assembly according to the teachings of the present invention, also showing the positional relationship between the frame assembly, the engine, and the front suspension;

FIG. 20 is another perspective illustration, from the front left side, of the combined frame assembly and tunnel portion constructed according to the teachings of the present invention, also showing the positional relationship between the frame assembly, the engine, and the front suspension;

FIG. 21 is a front perspective illustration of the embodiment depicted in FIG. 20;

FIG. 22 is a perspective illustration of a slightly different embodiment from the one depicted in FIG. 20;

FIG. 23 is a schematic side view illustration of the frame assembly of the present invention as embodied in a wheeled vehicle;

FIG. 24 is a schematic side view illustration of the frame assembly of the present invention as embodied in a slightly modified version of a wheeled vehicle;

FIG. 25 is an enlarged side view illustration of the frame assembly of the present invention as embodied in the wheeled vehicle shown in FIG. 24;

FIG. 26 is a perspective illustration, from the left rear, of the frame assembly of the present invention, showing some of the detail of the front suspension incorporated into the wheeled vehicle shown in FIGS. 23 and 24;

FIG. 27 is a perspective illustration, from the front left, showing the frame assembly of the present invention as depicted in FIG. 26;

FIG. 28 is a perspective illustration, from the rear left side of an alternate embodiment of the frame assembly of the present invention;

FIG. 29 is a side view illustration of the frame assembly shown in FIG. 28;

FIG. 30 is a top view of the frame assembly depicted in FIG. 28;

FIG. 31 is a side view illustration of the frame assembly shown in FIG. 29, illustrating the variable positioning of the handlebars that is possible with this embodiment of the present invention;

FIG. 32 is a perspective illustration of the embodiment shown in FIG. 31, showing in greater detail the variations in positioning of the handlebars that is made possible by the construction of the present invention;

FIG. 33 is a close-up side-view detail of the connection point between the handlebars and the frame assembly of the present invention, illustrating the variable positioning of the handlebars;

FIG. 34 is a further illustration of the variable positioning feature of the present invention; and

FIG. 35 is a graph showing the vertical displacement rate of the frame of the present invention in comparison with a prior art Bombardier snowmobile (the ZX™ series) and a prior art snowmobile made by Arctic Cat.

DESCRIPTION OF THE PREFERRED EMBODIMENTS

Before delving into the specific details of the present invention, it should be noted that the conventions “left,” “right,” “front,” and “rear” are defined according to the normal, forward travel direction of the vehicle being discussed. As a result, the “left” side of a snowmobile is the same as the left side of the rider seated in a forward-facing position on the vehicle (or travelling in a forward direction on the vehicle).

FIG. 1 illustrates a rider operator 10 sitting on a prior art snowmobile 12. Rider 10 is positioned on seat 14, with his weight distributed over endless track 16. Motor 18 (shown in general detail) is located over skis 20. As with any snowmobile, endless track 16 is operatively connected to motor (or engine) 18 to propel snowmobile 12 over the snow. Motor or engine 18 typically is a two-stroke internal combustion engine. Alternatively, a 4-stroke internal combustion engine may be substituted therefor. In addition, any suitable engine may be substituted therefor.

FIG. 2 provides a side view of a snowmobile 22 constructed according to the teachings of the present invention. Here, rider/operator 24 is shown in a more forward, motor cross racing-like position, which is one of the aspects of the present invention. In this position, the weight of operator 24 is forward of the position of rider 10 in the prior art example.

The positioning of rider 24 closer to motor 36 offers several advantages that are not achieved by the prior art. For example, since rider 24 is positioned closer to the engine 36, the center of gravity of rider 24 is closer to the center of gravity of the vehicle, which is often at the drive axle of the vehicle or near thereto. In other words, rider 24 has his weight distributed more evenly over the center of gravity of the vehicle. As a result, when the vehicle traverses rough terrain, rider 24 is better positioned so that he does not experience the same impact from an obstacle as rider 10 on

snowmobile 12. The improved rider positioning illustrated in FIG. 2 also improves the rider's ability to handle the vehicle.

FIG. 2 illustrates the basic elements of snowmobile 22. Snowmobile 22 includes an endless track 26 at its rear for propulsion. A rear suspension 28 connects endless track 26 to the vehicle frame. Snowmobile 22 also includes a front suspension 30. Skis 32, which are operatively connected to handlebars 34, are suspended from the front suspension 30 for steering the vehicle. A motor or engine (preferably, an internal combustion engine) 36 is located at the front of snowmobile 22, above skis 32. Operator 24 is seated on a seat 38, which is positioned above the endless track 26.

Three positional points of particular relevance to the present invention are also shown in FIG. 2. Specifically, seat position 40, foot position 42, and hand position 44 of operator 24 are shown. In the modified seating position of operator 24, which is made possible by the teachings of the present invention, hand position 44 is forward of foot position 42, which is forward of seat position 40. The three positions define three angles, a, b, and c between them that help to define the seating position of operator 24, which permits rider 24 to be closer to center of gravity 45 of the vehicle. Moreover, hand position 44 is forward of center of gravity 45 of snowmobile 22.

FIG. 3 provides an overlay between prior art snowmobile 12 and snowmobile 22 constructed according to the teachings of the present invention. Rider 10 (of prior art snowmobile 12) is shown in solid lines while operator 24 (of snowmobile 22) is shown in dotted lines for comparison. The comparative body positions of rider 10 and operator 24 are shown. As is apparent, the present invention permits the construction of a snowmobile 22 where the rider 24 is in a more forward position. Moreover seat position 40, foot position 42, and hand position 44 differ considerably from seat position 46, foot position 48, and hand position 50 in the prior art snowmobile 12. In this position, the center of gravity of operator 24 is closer to center of gravity 45 of snowmobile 22 than in the prior art example.

As a basis for comparison with the figures that provide the details of the present invention, FIG. 4 provides an exploded view of a frame assembly 52 for a snowmobile constructed according to the teachings of the prior art. Frame assembly 52 includes, as its major components, a tunnel 54 and an engine cradle 56. As illustrated, engine cradle 56 is positioned in front of tunnel 54. Engine cradle 56 receives motor 18.

As shown in FIG. 4, tunnel 54 is basically an inverted U-shaped structure with a top plate 58 integrally formed with left and right side plates 60, 62, respectively. Top plate 58 provides the surface onto which seat 14 is mounted, as would be known to those skilled in the art. Foot boards 64 (of which only the left foot board is visible in FIG. 4) are integrally formed with the side plates 60, 62 and extend outwardly, perpendicular to the plane of side plates 60, 62. Foot boards 64 provide a location on which rider 10 may place his feet during operation of snowmobile 12. While top plate 58, side plates 60, 62, and foot boards 64 are preferably formed from aluminum, any suitable alternative material may be used, as would be recognized by those skilled in the art. Moreover, while top plate 58, side plates 60, 62 and footboards 64 are shown as an integral structure, an integral construction is not required. Instead, top plate 58, side plates 60, 62, and foot boards 64 may be separately manufactured and connected to one another by any suitable means known in the art.

FIG. 4 also shows that engine cradle 56 is connected to tunnel 54 by any suitable means known to those skilled in the art. For example, engine cradle 56 may be welded or bolted to tunnel 54. Engine cradle includes a bottom plate 66 and left and right side walls 68, 70, which are provided with left and right openings 72, 74, respectively. Left opening 72 is provided so that the shafts for the transmission (typically a continuously variable transmission or CVT) may extend outwardly from left wall 68. The shafts that connect the engine 18 to the transmission pass through left opening 72. A gearbox (not shown) typically is provided on the right side of snowmobile 10. The shafts that connect engine 18 to the gearbox pass through right opening 74. Left and right openings 72, 74 also allow heat from engine 18 to be radiated from engine cradle 56, which assists in cooling engine 18.

As FIG. 4 illustrates, left side wall 68 is provided with a beam 76 that is removably connected thereto. Beam 76 may be removed during servicing, for example, to facilitate access to the engine components and peripheral elements disposed within left opening 72.

FIG. 4 also illustrates the placement of a handlebar support element 78, which connects to the rear of engine cradle 56. Handlebar support element 78 is generally an inverted U-shaped structure that extends upwardly from the combined engine cradle 56 and tunnel 54. A bracket 80 is positioned at the midpoint of handlebar support element 78 and provides structural support for handlebars 82, which is used to steer snowmobile 12.

To provide an improved driver positioning, as described above, the inventors of the present invention appreciated the advantages of moving handlebars 82 forward of the position shown in FIG. 1. To do this, however, required a novel approach to the construction of frame assembly 52 of snowmobile 12. The redesign resulted in the present invention, which is described in detail below.

As illustrated in FIG. 5, snowmobile 22 incorporates a completely redesigned frame assembly 84. Frame assembly 84 includes, among other elements, tunnel 86, engine cradle 88, and over-arching frame elements 90. As with snowmobile 12, snowmobile 22 includes a seat 94 on which rider 24 sits while operating snowmobile 22. Tunnel 86 is connected to a rear suspension 96 that contains a number of wheels 98 disposed on a slide frame 100 around which an endless track 102 rotates to propel snowmobile 22 across the snow.

Endless track 102 is connected to engine 104 (preferably a two or four stroke internal combustion engine) positioned within engine cradle 88. Endless track 102 is connected to engine 104 through a transmission 106, which is preferably a continuously variable transmission (or "CVT"), as is known in the art.

Two skis 108 are provided at the front of snowmobile 22 for steering. Skis 108 are connected to engine cradle 88 through a front suspension 110. Front suspension 110 connects to skis 108 through a pivot joint 112 on the top of skis 108. Skis 108 are operatively connected to a steering shaft 114 that extends over engine 104. Steering shaft 114 is connected, in turn, to handlebars 116, which are used by operator 24 to steer snowmobile 22.

FIG. 6 illustrates the individual elements of rear frame assembly 84 in greater detail. Rear frame assembly 84 includes an upper column 118, which is an inverted U-shaped structural element. If necessary, upper column 118 may be reinforced with a cross-member 120, but this is not needed to practice the present invention. A left brace 122 and a right brace 124 are connected to a bracket 126 above upper column 118. A bushing or bearing (or other similar element)

128 is attached to bracket 126 and accepts steering shaft 114 therethrough. It also secures steering shaft 114 to rear frame assembly 84. Left and right braces 122, 124 include left and right brackets 130, 132 at their lower portions. Left and right brackets 130, 132 secure left and right braces 122, 124 to tunnel 86 of snowmobile 22.

It should be noted that, while the construction of frame assembly 84 is illustrated involves the use of tubular members, frame assembly 84 may also be constructed according to a monocoque or pseudo-monocoque technique. A monocoque construction is one where a single sheet of material is attached to an underlying frame (such as with the construction of an aircraft). The skin applied to the frame adds rigidity to the underlying frame structure. In a similar manner, a pseudo-monocoque technique provides a rigid structure by providing a frame constructed from a single sheet of material.

Instead of constructing frame assembly 84 from a number of tubular members, frame assembly 84 may be constructed from a single sheet of material (such as aluminum) that has been pressed or molded into the appropriate shape using a pseudo-monocoque manufacturing technique. As would be understood by those skilled in the art, this would result in a construction that has a high strength with a low weight.

FIG. 7 illustrates a forward support assembly 134 (also called front triangle 134), which connects to bracket 126 and extends forwardly of bracket 126. Forward support assembly 134 includes a bracket 136 at its rear end that connects to bracket 126 of frame assembly 84 (preferably bolted). Forward support assembly 134 also has left and right braces 138, 140 that extend forwardly and downwardly from bracket 136 and are connected thereto preferably by welding. Left and right braces 138, 140 are connected at their forward ends by a cross-member 142, which includes a plurality of holes 144 therein to lighten the weight thereof. Left and right connecting brackets 145, 146 are connected to cross-member 142. The left and right connecting brackets 145, 146 connect, in turn, to front suspension 110.

FIGS. 8, 9, and 10 illustrate upper column 118 in greater detail. As described above, upper column 118 is essentially an inverted U-shaped member that is preferably tubular in shape to facilitate its construction. Upper column 118 preferably is bent into the appropriate shape from a straight tube with the dimensions shown. As would be understood by those skilled in the art, however, upper column 118 need not be made as a tubular member.

Upper column 118 has left and right legs 148, 150 that extend downwardly from an apex 152. A bracket 154 is disposed at apex 152 for connection to bracket 126 of frame assembly 84. Preferably, bracket 154 is welded at the apex of upper column 118 (however any other suitable attachment means is possible). Left leg 148 includes a bracket 156 at its lower-most portion that connects left leg 148 to engine cradle 88. Similarly, right leg 150 includes a bracket 158 at its lower-most portion to connect right leg 150 to engine cradle 88. Preferably, brackets 156, 158 are welded to upper column 118. Left and right legs 148, 150 preferably attach to engine cradle 88 via bolts or other suitable fasteners.

FIGS. 11 and 12 illustrate tunnel 86 in greater detail. Tunnel 86 includes a top plate 160 with left and right downwardly extending side plates 162, 164. A left foot rest 166 extends outwardly from the bottom of left side plate 162. Similarly, a right foot rest 168 extends outwardly from the bottom portion of right side plate 164. Left and right foot rests 166, 168 provide a location along tunnel 86 onto which rider 24 may place his or her feet while operating snowmobile 22.

Left side plate **162** extends forwardly beyond the front portion **170** of tunnel **86** to form a left engine cradle wall **172**. Similarly, right side plate **164** extends forwardly of front end **170** of tunnel **86** to form right engine cradle wall **174**. At the lower edge of left and right engine cradle walls **172**, **174**, there are laterally extending portions **176**, **178**, which serve to strengthen left and right engine cradle walls **172**, **174**. Removable elements **180** extend between left foot rest **166** and left laterally extending portion **176**. Removable portions **180** may or may not be removed between left foot rest **166** and left laterally extending portion **176**. FIG. **11** shows removable portions **180** removed, while FIG. **12** shows removable portions **180** not removed. It should be noted that the same removable portions **180** may or may not extend between right foot rest **168** and right laterally extending portion **178**.

Left engine cradle wall **172** preferably includes an opening **182** therethrough. Opening **182** permits the shafts from transmission **106** to pass therethrough. Unlike left engine cradle wall **172**, right engine cradle wall **174** does not include such an opening. Instead, right engine cradle wall **174** is essentially solid. Due to its construction, right engine cradle wall **174** reflects radiant heat from engine **104** back to engine **104** to assist in minimizing heat dissipation from engine **104**. Left and right openings **184**, **186** are provided through left and right engine cradle walls **172**, **174** so that a drive shaft **188** may pass therethrough. Drive shaft **186** connects to endless track **102** for propulsion of snowmobile **22**. Opening **182** may include a member **189** about its periphery, also as illustrated in FIGS. **11** and **12**, that provides clearance for the engine. Left engine cradle wall **172** also includes an opening **192** above opening **184** through which a shaft passes for part of transmission **106**.

FIGS. **13** and **14** illustrate a combination of a variation of frame assembly **190** connected to tunnel **86**. Frame assembly **190** includes upper column **118** as illustrated in FIGS. **8**–**10**. However, frame assembly **190** differs somewhat from frame assembly **84**. For example, left and right braces **194**, **196** are shaped so that they extend outwardly from the positions defined by left and right braces **122**, **124**. As illustrated, left and right braces **194**, **196** include elbows **198**, **200**. A cross-brace **202** optionally may be placed between left and right braces **194**, **196** to add structural rigidity to frame assembly **190**. As with frame assembly **84**, a bracket **126** is provided at apex **204** where left and right braces **194**, **196** meet one another. Forward support assembly **134** is the same as depicted in FIG. **7**. A front engine cradle wall **206** is also shown in FIG. **13**.

FIGS. **15**–**17** illustrate various aspects of front suspension **110** and associated structures. While the figures illustrate the embodiment preferably used in combination with snowmobile **22**, it should be recognized that front suspension **110** may also be used in combination with a wheeled Vehicle, as will be discussed in connection with FIGS. **23**–**27**.

Front suspension **110** includes left and right ski legs **208**, **210**. Left and right ski legs **208**, **210** are preferably made from aluminum and are preferably formed as extrusions. While an aluminum extrusion is preferred for left and right ski legs **208**, **210**, those skilled in the art would appreciate that ski legs could be made from any suitable material and in any acceptable manner that would provide similar strength and low weight characteristics. Left and right ski legs **208**, **210** include holes **212**, **214** through which a fastener (not shown) is disposed to pivotally connect skis **32** to snowmobile **22**, as shown in FIG. **2**.

Left and right ski legs **208**, **210** are movably connected to left and right support arms **216**, **218**. Left and right suspen-

sion arms **216**, **218** include lower left and right suspension support arms **220**, **222** and upper left and right suspension support arms **224**, **226**.

As shown in FIGS. **15** and **17**, lower left suspension support arm **220** connects to left ski leg at lower left attachment point **228** preferably through a ball joint (not shown) so that left ski leg **208** may pivot and rotate with respect to lower left suspension support arm **220**. Similarly, lower right suspension support arm **222** connects to right ski leg **210** at lower right attachment point **230**, preferably through a ball joint. Upper left suspension support arm **224** preferably attaches to left ski leg **208** at upper left attachment point **232**, preferably through a ball joint or other suitable means. In addition, upper right suspension support arm **226** connects to right ski leg **210** at upper right attachment point **234** through a ball joint or other suitable means.

Lower left suspension support arm **220** includes front and rear members **236**, **238**, which meet at apex **240** where they connect with left lower eyelet **242**. Front member **236** includes a joint **244** at an inner end, and rear member **238** includes a joint **246** also at an inner end. Similarly, lower right suspension support arm **222** includes front and rear members **248**, **250**, which meet at apex **252** where they connect with right lower eyelet **254**. Front member **248** includes a joint **256** at an inner end and rear member **250** includes a joint **258** also at an inner end.

Upper left suspension support arm **224** includes front and rear members **260**, **262**, which meet at apex **264** where they connect with upper left eyelet **266**. Front member **260** includes a joint **268** at an inner end, and rear member **262** includes a joint **270** also at an inner end. Similarly, upper right suspension support arm **226** includes front and rear members **272**, **274**, which meet at apex **276** where they connect with upper right eyelet **278**. Front member **272** includes a joint **280** at an inner end and rear member **274** includes a joint **282** also at an inner end.

At a point inward from apex **240**, lower left suspension support arm **220** includes a left bracket **284** that is connected to and extends partially along front and rear members **236**, **238**. Similarly, lower right suspension support arm **222** includes a right bracket **286** that is connected to and extends partially along front and rear members **248**, **250**. Slidably attached to rear member **238** of lower left suspension arm **220** is a left pivot block **288**. A right pivot block **290** is slidably attached to rear member **250** of lower right suspension support arm **222**. A stabilizer bar **292** is connected between left and right pivot blocks **288**, **290**. Stabilizer bar **292** is adapted to slide and pivot by way of left and right pivot blocks **288**, **290**. These blocks **288**, **290** slide relative to left and right lower suspension support arms **220**, **222**. Left and right bushings **296**, **298** are provided to allow some rotation of the components of front suspension **110**. Left and right ski legs **208**, **210** rotatably connect to front suspension **110** for facilitating movement of skis **32**.

FIG. **16** illustrates sub-frame **294**, which is essentially a unitary, V-shaped structure. Sub-frame **294**, which forms a part of front suspension **110**, includes a central channel **300** flanked on either side by left and right upwardly extending panels **302**, **304**. Left upwardly extending panel **302** includes a left lower panel **306** connected to left transition structure **308** and left triangular panel **310**. Similarly, right upwardly extending panel **304** includes a right lower panel **312** connected to right transition structure **314** and right triangular panel **316**. While sub-frame **294** preferably is a unitary structure (an integrally-formed structure), sub-frame **294** need not be constructed in this manner. As would be understood by those skilled in the art, sub-frame **294** may be

assembled from a number of separate elements that are connected together by any suitable means such as by welding or by fasteners.

As illustrated in FIG. 17, sub-frame 294 is an integral part of front suspension 110 and connects to left support arm 216 and right support arm 218 through a number of brackets 318 connected at various locations on sub-frame 294.

FIG. 18 is a side view of one embodiment of the completed frame assembly 84 of the present invention. As shown, over-arching frame elements 90 are connected between tunnel 86 and sub-frame 294 to establish an apex 320 to which steering shaft 114 is connected.

FIG. 19 is a perspective illustration of the embodiment of the present invention shown in FIGS. 13 and 14 to assist in understanding the scope and content of the present invention. As illustrated, drive shaft 322 extends through left opening 182 in left engine cradle wall 172. A portion of gearbox 324 is also visible. In addition, left shock absorber 326, which is connected between cross-member 142 and left support arm 216, is illustrated. Right shock absorber, which extends between cross-member 142 and right support arm 218 is visible in FIG. 20. Furthermore, left forward foot wall 330 is shown at the forward end of left foot rest 166. A similar forward foot wall may be provided on the right side of snowmobile 22 (but is not illustrated herein).

FIGS. 20 and 21 illustrate further details of the present invention by showing the various elements from slightly different perspective views. FIG. 22 illustrates the modified version of the elements of the present invention shown in FIGS. 6 and 7. Here, left and right braces 122, 124 are illustrated instead of left and right braces 194, 196. As discussed previously, left and right braces 122, 124 differ from left and right braces 194, 196 in that they are not bent but, instead, are straight elements of overarching frame 90. The same left and right braces 122, 124 are shown in FIG. 18. As would be understood by those skilled in the art, the two different embodiments of these braces are interchangeable. In addition, their shape may be altered depending on the requirements of the particular vehicle design, as would be understood by those skilled in the art.

Left and right braces 194, 196 are bent to accommodate an airbox (not shown) between them. Left and right braces 122, 124 are not bent because they do not need to accommodate an airbox.

FIG. 20 also illustrates steering gear box 115 at the bottom end of steering shaft 114 that translates the movement of handlebars 116 into a steering motion of skis 32.

FIGS. 23–27 illustrate alternate embodiments of the present invention that are designed for a wheeled vehicle 332, rather than a snowmobile 22. For the most part, the elements designed for wheeled vehicle 332 are the same as those for snowmobile 22, except for those elements required to attach wheels 334 to wheeled vehicle 332.

In the preferred embodiment of wheeled vehicle 332, the vehicle includes two front wheels 334 and a single rear wheel 336. As would be understood by those skilled in the art, however, wheeled vehicle 332 may be constructed with two rear wheels rather than one. If so, wheeled vehicle 332 would be a four-wheeled vehicle rather than the three-wheeled vehicle shown.

Wheeled vehicle 332 includes a seat 338 disposed over tunnel 86 in the same manner as snowmobile 22. The vehicle includes engine 104 at its forward end, encased by fairings 340. Fairings 340 protect engine 104 and provide wheeled vehicle 332 with an aesthetically pleasing appearance.

Engine 104 is connected to CVT 106, which translates the power from engine 104 into motive power for wheeled vehicle 332.

As shown in FIG. 23, CVT 106 is connected by suitable means to drive shaft 342, which is connected to rear wheel 336 by a drive chain 344. A sprocket 346 is connected to drive shaft 342. A similar sprocket 348 is provided on the shaft connected to rear wheel 336. Drive chain 344 is an endless chain that connects sprockets 346, 348 to one another. To stop wheeled vehicle 332 during operation, disc brakes 350 are connected to front wheels 334. Disc brakes 350 clamp onto discs 352 to slow or stop wheeled vehicle 332 in a manner known to those skilled in the art.

A rear suspension 354 is provided under tunnel 86. Rear suspension 354 absorbs shocks associated with the terrain over which wheeled vehicle 332 travels. Rear suspension 354 replaces rear suspension 28 on snowmobile 22.

FIG. 24 illustrates an alternate embodiment of wheeled vehicle 356. Wheeled vehicle 356 differs in its construction at the rear. Specifically, rear end 358 is shorter than that shown for wheeled vehicle 332. In addition, wheeled vehicle 356 includes a four stroke engine, rather than the two stroke engine 104 illustrated for wheeled vehicle 332. Also, wheeled vehicle 356 includes a manual speed transmission 360 (with a clutch) rather than continuously variable transmission 106, as illustrated with other embodiments of the present invention. Both constructions of the wheeled vehicle, as well as many other variations, are contemplated within the scope of the present invention. In addition, as discussed above, the present invention may be used with a two or four stroke engine (or any other type of engine that provides the motive power for the vehicle).

FIG. 25 illustrates in greater detail the embodiment of the present invention shown in FIG. 24.

FIGS. 26–27 illustrate the basic frame assembly contemplated for wheeled vehicles 332, 356. For either vehicle, the construction of frame assembly 191 is similar to that previously described. This embodiment differs in that left and right wheel knuckles 366, 368 are provided so that wheels 334 may be attached thereto. In most other respects, the construction of frame assembly 191 is the same as that previously described.

The variable geometry of steering shaft 364 will now be described in connection with FIGS. 28–34.

As illustrated in FIG. 28, left brace 122 and right brace 124 extend upwardly from tunnel 370 to apex 372 where they connect to variable geometry steering bracket 374. Upper column 118 extends from left engine cradle wall 393 and right engine cradle wall 174 and also connects to variable geometry steering bracket 374. Forward support assembly 134 extends from sub-frame 294 to variable geometry steering bracket 374.

Variable geometry steering bracket 374 is essentially a U-shaped element with a rear end 376 and a forward end 378. At rear end 376, a first cross-member 380 extends between left and right legs 382, 384 of variable geometry steering bracket 374 to define a closed structure. A second cross member 386 extends between left and right legs 382, 384 forward of first cross member 380 and defines a U-shaped opening 387 toward forward end 378 of variable geometry steering bracket 374. A first pair of holes 388 and a second pair of holes 390 are disposed through left and right legs 382, 382 of variable geometry steering bracket 374 and provide separate attachment points for steering shaft 364. FIG. 29 illustrates the same structures in side view and FIG. 30 illustrates the same structures in top view.

This embodiment of the frame assembly of the present invention differs from the previous embodiments in a few respects. First, left engine cradle wall **393** includes a C-shaped opening **392** instead of opening **182**. C-shaped opening **392** facilitates maintenance of an engine (not shown) in engine cradle **394**. Second, an elongated radiator **396** is integrated into tunnel **370**. Radiator **396** includes an inlet **398** and an outlet **400** that are connected to the cooling system of the engine to assist in reducing the temperature of the coolant therein. To facilitate dissipation of heat, radiator **396** includes fins **402** on its underside.

FIG. **31** provides another side view of the frame assembly of the present invention and illustrates the two positions of steering shaft **364** made possible by the construction of variable geometry steering bracket **374**. To accommodate the variable geometry of steering shaft **362** and handlebars **116**, steering shaft **364** includes a bend **402** at its lower end. Steering shaft **364** passes through a bearing or bushing (not shown) at its upper end that is connected to variable geometry steering bracket **374** at either of first or second pairs of holes **388**, **390**. By selecting either first or second pairs of holes **388**, **390**, first and second handlebar positions **404**, **406** are selectable. As would be recognized by those skilled in the art, however, variable geometry steering bracket **374** may be provided with greater than two pairs of holes **388**, **390** to further increase the variability handlebars **116**. Also, variable geometry steering bracket **374** may be provided with a construction that permits infinite variation of the position of handlebars, as would be understood by those skilled in the art, should such a construction be desired.

FIGS. **32-34** provide additional views of the variable positioning of the handlebars **116** to facilitate an understanding of the scope of the present invention.

Frame assembly **84**, **190**, **191** of the present invention uniquely distributes the weight loaded onto the vehicle, whether it is snowmobile **22** or one of wheeled vehicles **332**, **356**. Each of the main components of the frame assembly **84**, **190**, **191** forms a triangular or pyramidal configuration. All of the bars of the frame assembly **84**, **190**, **191** work only in tension and compression, without bending. Therefore, each bar of frame assembly **84**, **190**, **191** intersects at a common point, the bracket **126** (in the non-variable steering geometry) or variable geometry steering bracket **374**. With this pyramidal shape, the present invention creates a very stable geometry.

Specifically, the structure of frame assembly **84**, **190**, **191** enhances the torsional and structural rigidity of the frame of the vehicle. This improves handling. Usually, with a snowmobile, there is only a small torsional moment because the width of the snowmobile is only about 15 inches. An ATV, on the other hand, has a width of about 50 inches and, as a result, experiences a significant torsional moment. Therefore, to construct a frame assembly that is useable in either a snowmobile or an ATV, the frame must be able to withstand the torsional forces associated with an ATV.

Not only does frame assembly **84**, **190**, **191** reduce torsional bending, it also reduces the bending moment from front to rear. The increased rigidity in both directions further improves handling.

In addition, the creation of frame assembly **84**, **190**, **191** has at least one further advantage in that the frame can be made lighter and stronger than prior art frame assemblies (such as frame assembly **52**, which is illustrated in FIG. **4**). In the conventional snowmobile, frame assembly **52** included a tunnel **54** and an engine cradle **56** that were riveted together. Because frame assembly **84**, **190**, **191** adds strength and rigidity to the overall construction and absorbs

and redistributes many of the forces encountered by the frame of the vehicle, the panels that make up the tunnel **86** and the engine cradle **88** need not be as strong or as thick as was required for the construction of frame assembly **52**.

In the front of the vehicle, left and right shock absorbers **326**, **328** are connected to forward support assembly **134** so that the forces experienced by left and right shock absorbers **326**, **328** are transmitted to frame assembly **84**, **190**, **191**. In the rear of the vehicle, the left and right braces **122**, **124** are orientated with respect to the rear suspension. Upper column **118** is positioned close to the center of gravity of the vehicle's sprung weight. The sprung weight equals all of the weight loaded onto the vehicle's entire suspension. The positioning of these elements such that they transmit forces encountered at the front, middle and rear of the vehicle to an apex creates a very stable vehicle that is capable of withstanding virtually any forces that the vehicle may encounter during operation without sacrificing vehicle performance.

FIG. **35** illustrates the degree to which the rigidity of a frame constructed according to the teachings of the present invention is improved. The highest line on the graph shows that for a 100 kg load, the vertical displacement of the frame of the present invention is only -2 mm. However, in the prior art Bombardier ZX™ model snowmobile, a load of only 50 kg produced a vertical displacement of -6 mm. In addition, a load of about 30 kg on the frame for the prior art Arctic Cat® snowmobile produced a vertical displacement of -6 mm. In other words, the structural rigidity of the frame assembly of the present invention is greatly improved.

While the invention has been described by way of example embodiments, it is understood that the words which have been used herein are words of description, rather than words of limitation. Changes may be made, within the purview of the appended claims without departing from the scope and the spirit of the invention in its broader aspects. Although the invention has been described herein with reference to particular structures, materials, and embodiments, it is understood that the invention is not limited to the particulars disclosed.

What is claimed is:

1. A snowmobile, comprising:

a frame including a tunnel and an engine cradle forward of the tunnel;

an engine mounted in the engine cradle such that the engine cradle extends under the engine;

a drive track disposed below and supported by the tunnel and connected operatively to the engine for propulsion of the snowmobile;

left and right skis disposed on the frame;

a straddle seat disposed on the tunnel above the drive track and rearward of the engine;

a pair of footrests supported by the frame;

a steering column movably connected to the frame and operatively connected to the two skis;

a handlebar connected to the steering column;

a rear brace assembly including:

left and right rear legs extending forwardly and upwardly from the tunnel, each of the left and right rear legs having a front end and a rear end, the rear ends of the rear legs being spaced further from each other than the front ends of the rear legs.

2. The snowmobile of claim **1**, further comprising a front support assembly including left and right front legs extending rearwardly and upwardly from the frame forward of the tunnel, each of the left and right front legs having a front end and rear end, the front ends of the front legs being spaced further from each other than the rear ends of the front legs.

15

3. The snowmobile of claim 2, wherein a pyramidal structure is formed by the front support assembly and the rear brace assembly.

4. The snowmobile of claim 3, wherein the pyramidal structure has an apex located above the tunnel.

5. The snowmobile of claim 4, wherein the legs of the front support assembly extend rearwardly and upwardly from the engine cradle.

6. The snowmobile of claim 5, further comprising an upper column extending upwardly from the frame and adjoining the pyramidal structure.

7. The snowmobile of claim 5, further comprising a steering bracket mounted on the pyramidal structure and supporting the steering column.

8. The snowmobile of claim 4, wherein the frame further includes a sub-frame forward of the engine cradle, and the legs of the front support assembly extend rearwardly and upwardly from the sub-frame.

9. The snowmobile of claim 8, further comprising an upper column extending upwardly from the frame and adjoining the pyramidal structure.

10. The snowmobile of claim 8, further comprising a steering bracket mounted on the pyramidal structure and supporting the steering column.

11. The snowmobile of claim 3, wherein the pyramidal structure has an apex located above the engine cradle.

12. The snowmobile of claim 11, wherein the legs of the front support assembly extend rearwardly and upwardly from the engine cradle.

16

13. The snowmobile of claim 12, further comprising an upper column extending upwardly from the frame and adjoining the pyramidal structure.

14. The snowmobile of claim 12, further comprising a steering bracket mounted on the pyramidal structure and supporting the steering column.

15. The snowmobile of claim 11, wherein the frame further includes a sub-frame forward of the engine cradle, and the legs of the front support assembly extend rearwardly and upwardly from the sub-frame.

16. The snowmobile of claim 15, further comprising an upper column extending upwardly from the frame and adjoining the pyramidal structure.

17. The snowmobile of claim 15, further comprising a steering bracket mounted on the pyramidal structure and supporting the steering column.

18. The snowmobile of claim 3, further comprising a cross-member interconnecting the legs of the front support assembly.

19. The snowmobile of claim 18, wherein the steering column extends through a triangular structure formed by the legs of the front support assembly and the cross-member.

20. The snowmobile of claim 3, wherein the steering column extends through a V-shaped structure formed by the legs of the front support assembly.

* * * * *